

5/28/99

W RALPH WHITEHEAD ASSOCIATES
CONSULTING ENGINEERS
P.O. BOX 35624
CHARLOTTE, NORTH CAROLINA 28235

25	0	50	HORIZ.
5	0	10	
			VERT.
CONST. REV.			
R/W REV.			

PROJECT REFERENCE NO. 37619, ETC.	SHEET NO. 25
ROADWAY DESIGN ENGINEER	HYDRAULICS ENGINEER

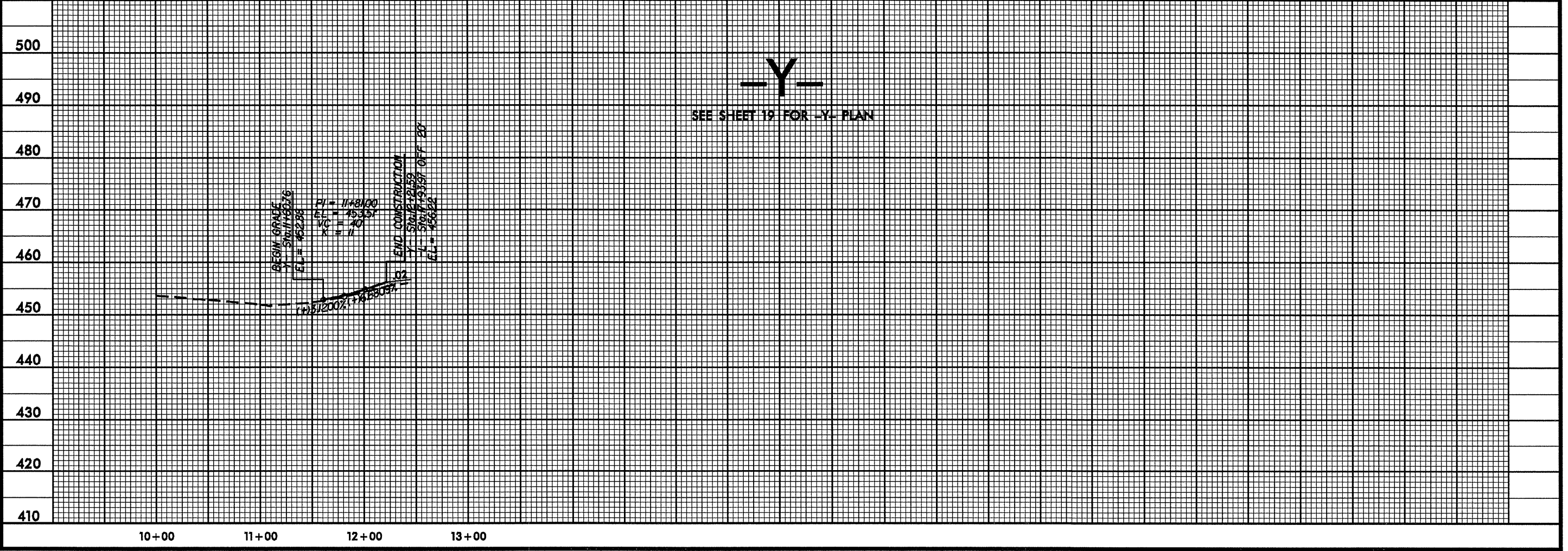
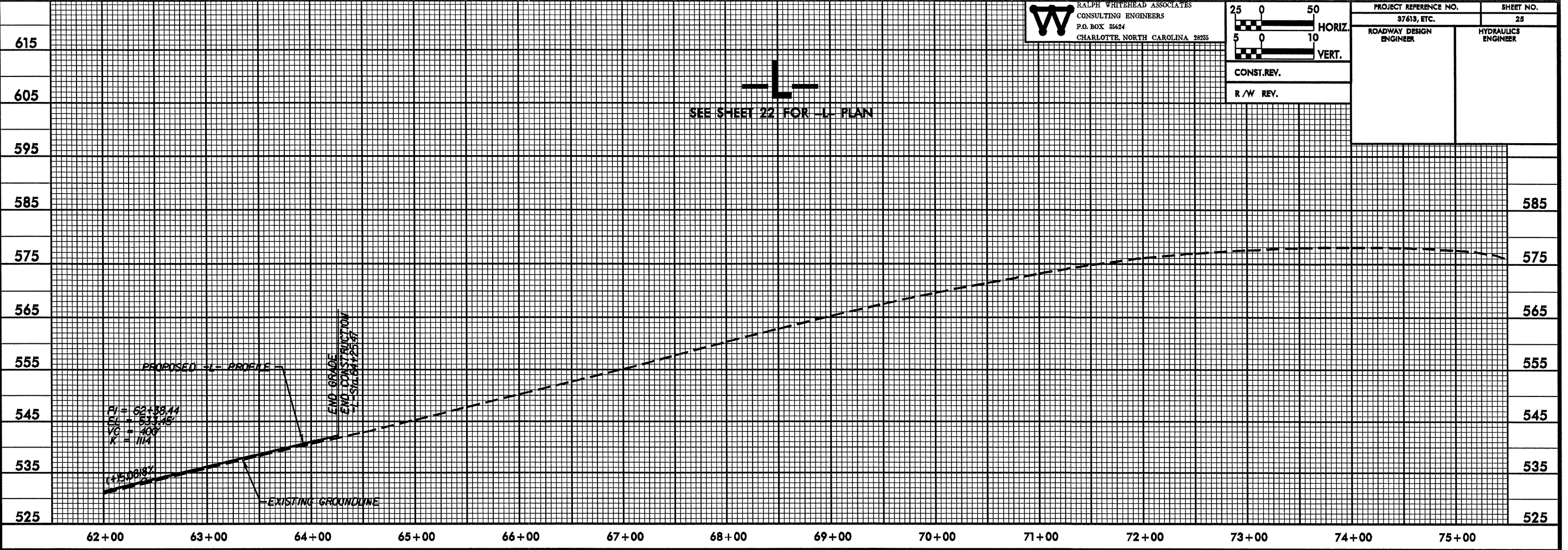

\$\$\$SYTIME\$\$\$\$\$
\$\$\$\$\$DGN\$\$\$\$\$
\$\$\$\$\$EN\$\$\$\$\$
\$\$\$\$\$LE\$\$\$\$\$