

8/17/99

REVISIONS

W RALPH WHITEHEAD ASSOCIATES
CONSULTING ENGINEERS
P.O. BOX 35634
CHARLOTTE, NORTH CAROLINA 28235

PROJECT REFERENCE NO. 37613, ETC.	SHEET NO. PMP-14
R/W SHEET NO.	HYDRAULICS ENGINEER
ROADWAY DESIGN ENGINEER	

MAP #8 US 64 / SR 1418

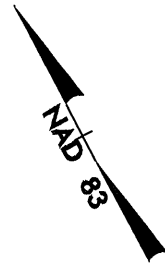

NOTE: PAVEMENT MARKINGS MAY BE MODIFIED IN THE FIELD AS DIRECTED BY THE ENGINEER.

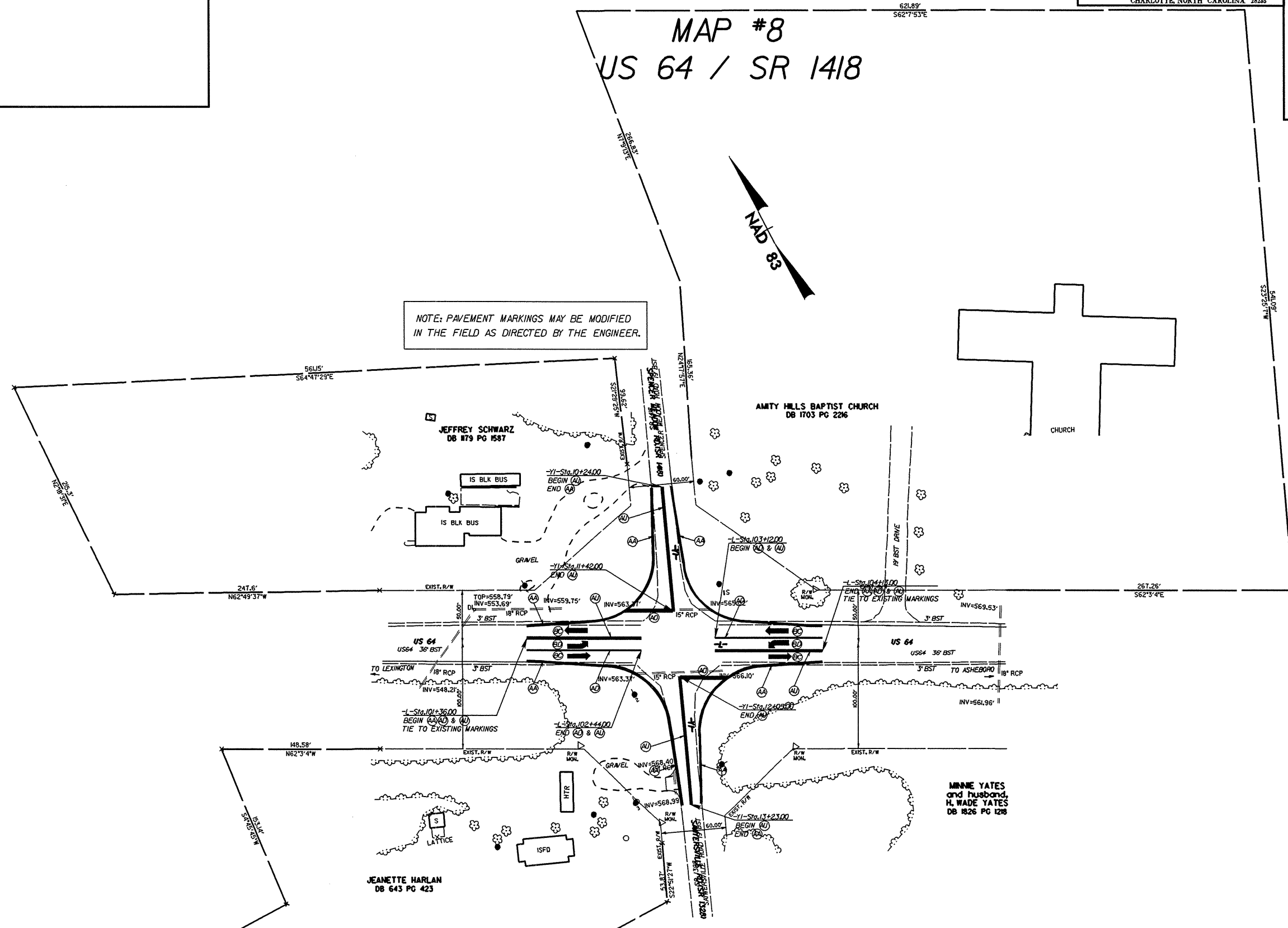

PAVEMENT MARKING SCHEDULE

ITEM	DESCRIPTION
AA - THERMOPLASTIC (4# WHITE, 90 MILS)	EDGE LINE
AB - THERMOPLASTIC (4# YELLOW, 120 MILS)	4" x 10' SKIP
AC - THERMOPLASTIC (4# WHITE, 120 MILS)	4" x 2' MINI-SKIP
AD - THERMOPLASTIC (4# WHITE, 120 MILS)	SOLID LANE LINE
AE - THERMOPLASTIC (2# WHITE, 120 MILS)	STOP BAR
AF - THERMOPLASTIC (4# YELLOW, 120 MILS)	EDGE LINE
AG - THERMOPLASTIC (4# YELLOW, 120 MILS)	DOUBLE CENTER LINE
AH - THERMOPLASTIC (8# YELLOW, 120 MILS)	DIAGONALS

PAVEMENT MARKING SCHEDULE

BC - THERMOPLASTIC (STRAIGHT THRU ARROW, 90 MILS)
BD - THERMOPLASTIC (LEFT TURN ARROW, 90 MILS)
BE - THERMOPLASTIC (RIGHT TURN ARROW, 90 MILS)

SYTIME
L
C
S
E
R
V
I
C
E
S