

NOTE:
PERIMETER EROSION CONTROL MEASURES SHALL BE INSTALLED DURING CLEARING AND GRUBBING PHASE.

NOTE:
TEMPORARY SILT FENCE SHALL BE INSTALLED A MINIMUM OF 3 FEET FROM TOE OF FILL IN WETLAND AREAS

NOTE:

1. NCDOT HAS AGREED TO THE SPECIAL COMMITMENT THAT NO IN-WATER WORK WILL BE CONDUCTED BETWEEN MARCH 31 AND SEPTEMBER 30 IN ORDER TO AVOID NEGATIVE IMPACTS TO SPANNING POPULATIONS OF FISH SPECIES AT THIS PROJECT SITE.
2. SEE SHEET 2 FOR ROCK PLATING DETAIL.
3. SEE SHEET 2B FOR UNDERCUT LIMITS AND DETAIL.
4. ANY RELOCATION OF EXISTING UTILITIES WILL BE ACCOMPLISHED BY OTHERS.
5. UNDERCUT LIMITS SHOULD NOT EXTEND BEYOND THE PROJECT TEMPORARY CONSTRUCTION EASEMENT LIMITS.

UNITED STATES DEPARTMENT OF THE INTERIOR
FISH AND WILDLIFE SERVICE
DB 96 PG 228
MB 2 PG41

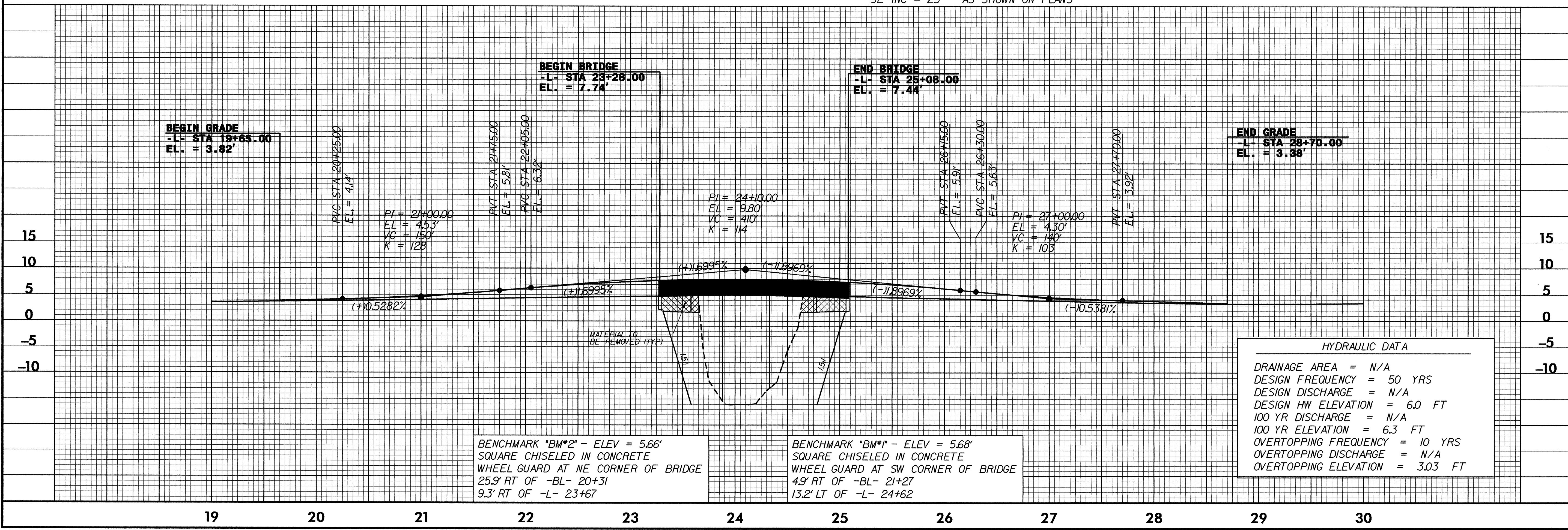
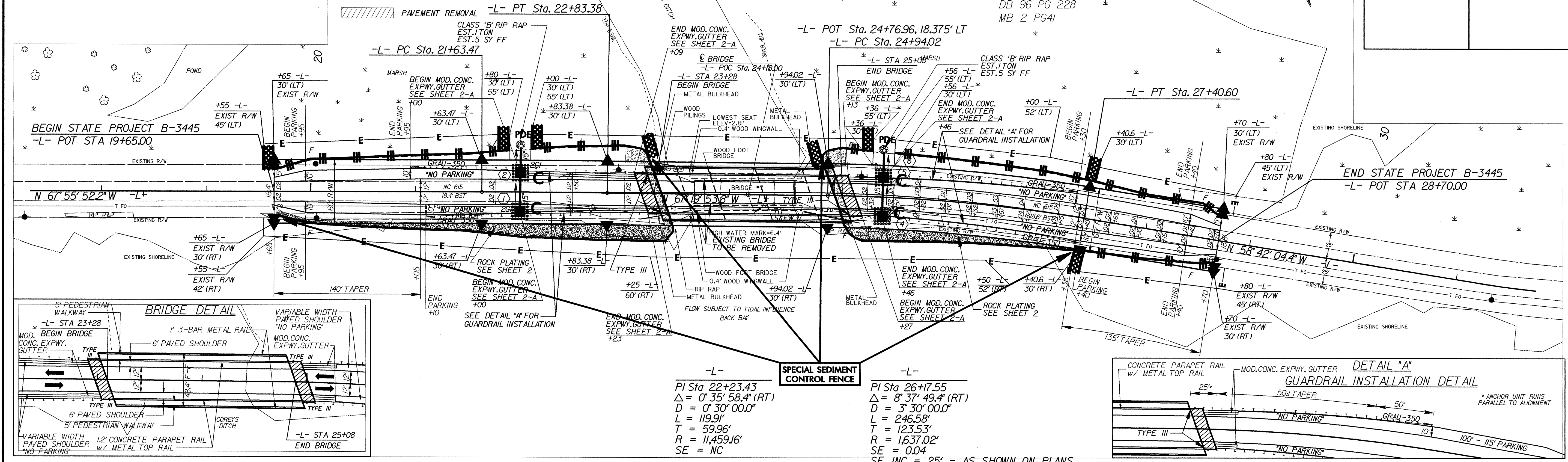

7/2/99
USER: JAMES...
DATE: 7/2/99
TIME: 10:00 AM
DRAWN BY: JAMES...
CHECKED BY: JAMES...
SCALE: AS SHOWN
SHEET NO.: EC-3'CONST.4