

SURVEY CONTROL SHEET B-4027

CONTROL DATA

BL	POINT	DESC.	NORTH	EAST	ELEVATION	L STATION	OFFSET
BL1	GPS B4027-1		868538.7650	2554185.9970	48.60	OUTSIDE PROJECT LIMITS	
BL3	BL-3		869255.1770	2554821.9690	45.28	17+70.27	12.30 LT
BL2	GPS B4027-2		869733.0080	2555221.9200	46.07	23+92.61	12.35 RT

BENCHMARK DATA

.....
 BM6 ELEVATION = 47.51
 N 868618 E 2554182
 L STATION 10+00
 S 57° 06' 14.3" W DIST 137.40
 R/R SPIKE IN BASE OF 16" GUM

 BM7 ELEVATION = 44.31
 N 869866 E 2555206
 L STATION 24+58
 N 29° 14' 13.7" W DIST 79.38
 R/R SPIKE IN BASE OF 16" OAK

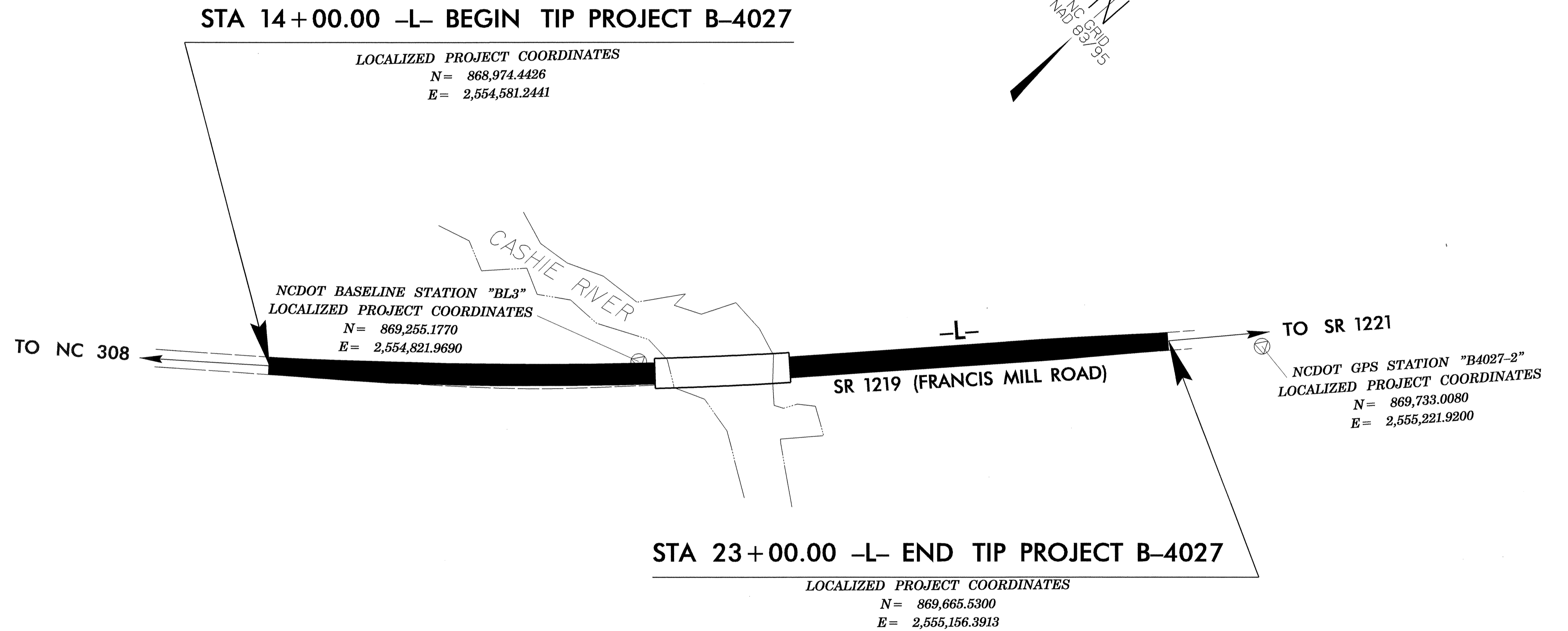

DATUM DESCRIPTION

THE LOCALIZED COORDINATE SYSTEM DEVELOPED FOR THIS PROJECT IS BASED ON THE STATE PLANE COORDINATES ESTABLISHED BY NCDOT FOR MONUMENT "B4027-1" WITH NAD 1983/95 STATE PLANE GRID COORDINATES OF NORTHING: 868538.765(ff) EASTING: 2554185.997(ff) THE AVERAGE COMBINED GRID FACTOR USED ON THIS PROJECT (GROUND TO GRID) IS: 0.99999200 THE N.C. LAMBERT GRID BEARING AND LOCALIZED HORIZONTAL GROUND DISTANCE FROM "B4027-1" TO -L- STATION 14+00.00 IS N 42° 12' 51.6" E 588.2476 ff ALL LINEAR DIMENSIONS ARE LOCALIZED HORIZONTAL DISTANCES VERTICAL DATUM USED IS NAVD 88

NOTES:

THE CONTROL DATA FOR THIS PROJECT CAN BE FOUND ELECTRONICALLY BY SELECTING [HTTP://WWW.DOH.DOT.STATE.NC.US/PRECONSTRUCT/HIGHWAY/LOCATION/PROJECT](http://www.doh.dot.state.nc.us/preconstruct/highway/location/project)

FILE: b4027_ls_control_040922.txt

SITE CALIBRATION PARAMETERS HAVE NOT BEEN DETERMINED FOR THIS PROJECT. IF FURTHER INFORMATION IS NEEDED, PLEASE CONTACT THE LOCATION AND SURVEYS UNIT.

⊙ INDICATES GEODETIC CONTROL MONUMENTS USED OR SET FOR HORIZONTAL PROJECT CONTROL BY THE NCDOT LOCATION AND SURVEYS UNIT.

PROJECT CONTROL ESTABLISHED UTILIZING GLOBAL POSITIONING SYSTEM.

NETWORK FOR GPS "B4027-1" ESTABLISHED FROM NGS ONLINE POSITIONING USER SERVICE (OPUS)

NOTE: DRAWING NOT TO SCALE