

09/08/09

TIP PROJECT: B-4152

WBS: 33501

STATE OF NORTH CAROLINA
DIVISION OF HIGHWAYS

T.I.P. NO.	SHEET NO.
B-4152	UC-1

UTILITY CONSTRUCTION PLANS HOKE COUNTY

LOCATION: BRIDGE NO. 53 OVER PUPPY CREEK ON SR 1422
TYPE OF WORK: WATER LINE RELOCATION

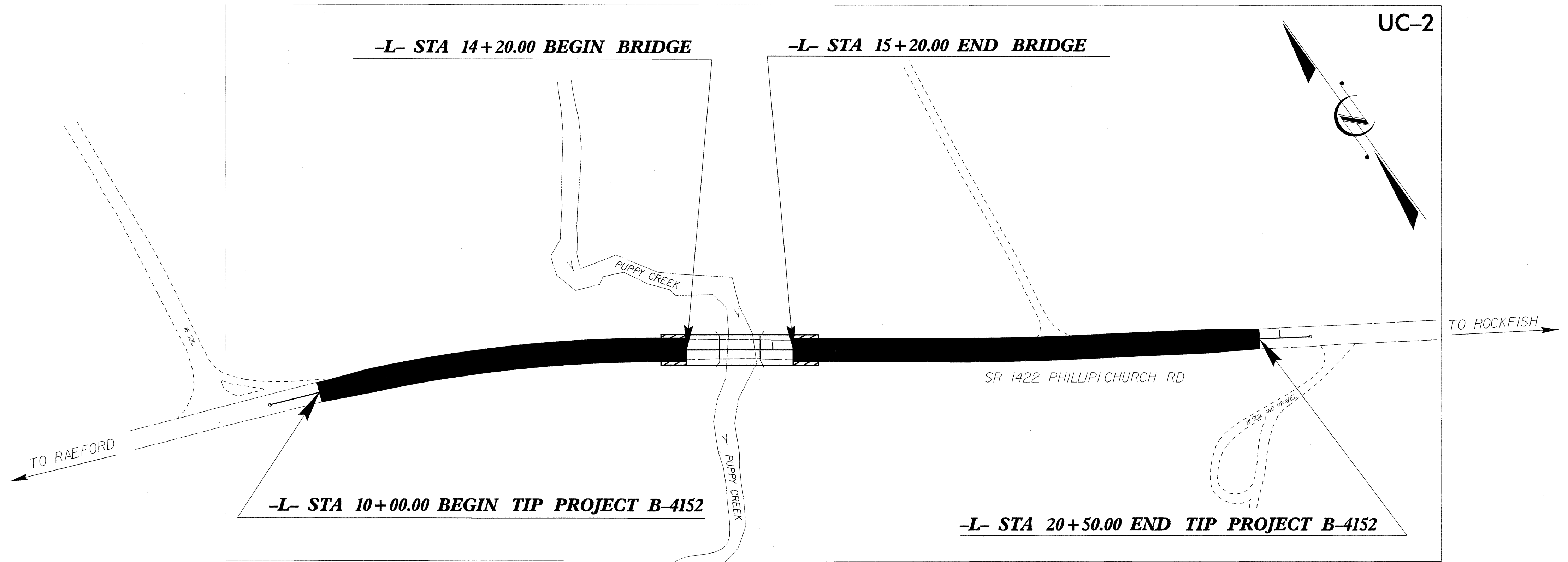
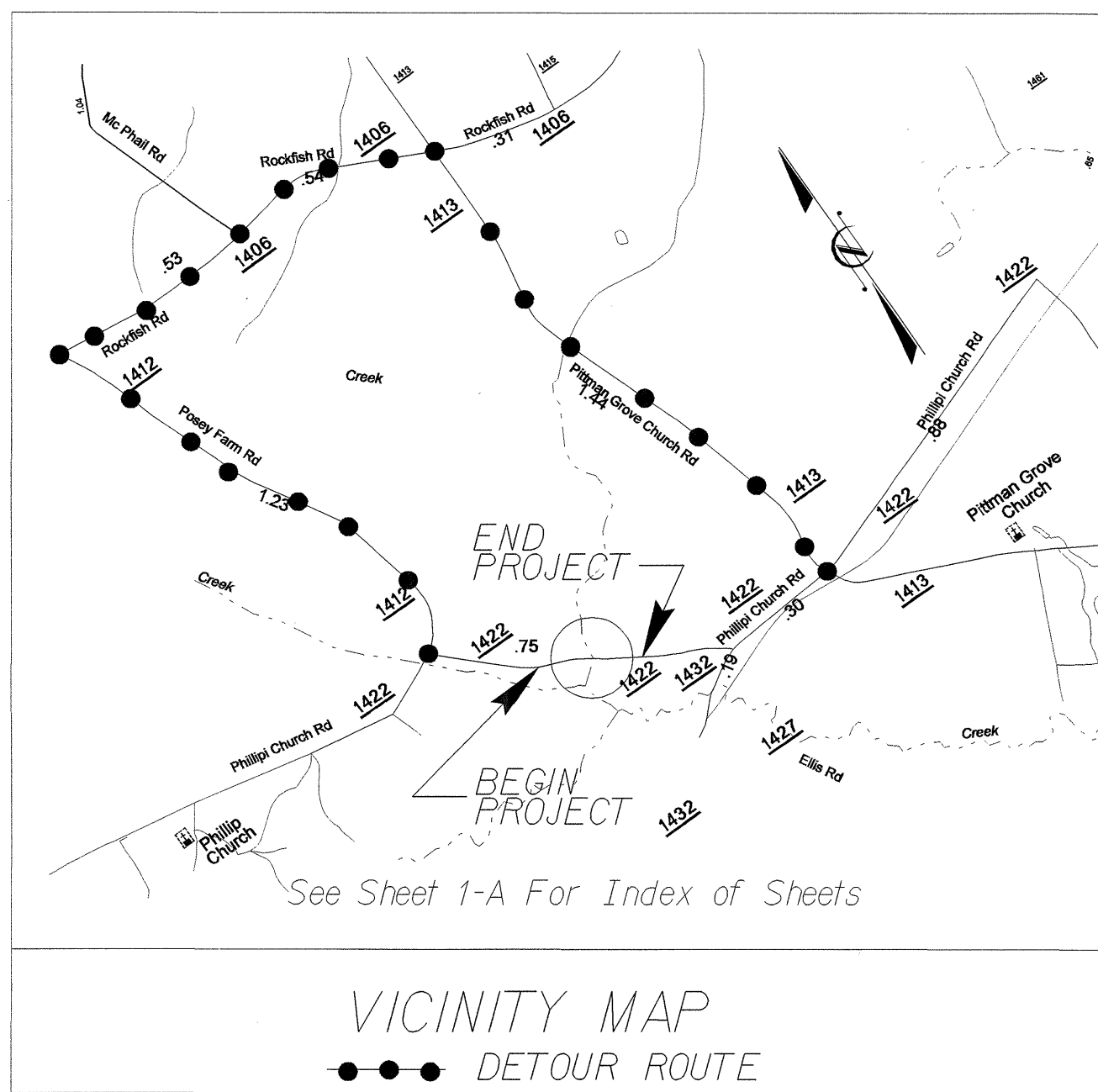

THERE IS NO CONTROL OF ACCESS WITH THIS PROJECT

**** EXCEPTION FOR THE K VALUES OF THE SAG VERTICAL CURVES AND VERTICAL STOPPING SIGHT DISTANCES.**

INDEX OF SHEETS	
SHEET NO.	DESCRIPTION
UC-1	TITLE SHEET
UC-2	UTILITY CONSTRUCTION PLAN SHEETS
UC-3	DETAILS SHEET

UTILITY OWNER ON PROJECT
(1) WATER - HOKE COUNTY

SEAL

PREPARED IN THE OFFICE OF:
**DIVISION OF HIGHWAYS
PROJECT SERVICES
UTILITY SECTION**

1591 MAIL SERVICES CENTER
RALEIGH NC 27699-1591
PHONE (919) 250-4128
FAX (919) 250-4119

Roger Worthington, P.E. UTILITIES SECTION ENGINEER
Greg Stevens, P.E. UTILITIES SQUAD LEADER PROJECT ENGINEER
Donald Proper UTILITIES PROJECT DESIGNER

SYSTEMTIME: 09/08/09 10:00:00 AM
D:\WORK\PROJECTS\B-4152\UC-1.DWG
USER: GREGY