

CONTRACT: C201293 TIP PROJECT: B-4152

STATE	STATE PROJECT REFERENCE NO.	SHEET NO.	TOTAL SHEETS
N.C.	B-4152		
STATE PROJ. NO.	F.A. PROJ. NO.	DESCRIPTION	
33501.1.1	BRZ-1422(5)	PE, UTL	
33501.2.1	BRZ-1422(9)	RW	
33501.3.1	BRZ-1422(9)	CONST	

STATE OF NORTH CAROLINA
 DIVISION OF HIGHWAYS

HOKE COUNTY

LOCATION: BRIDGE NO. 53 OVER PUPPY CREEK ON SR 1422
TYPE OF WORK: GRADING, PAVING, DRAINAGE & STRUCTURE

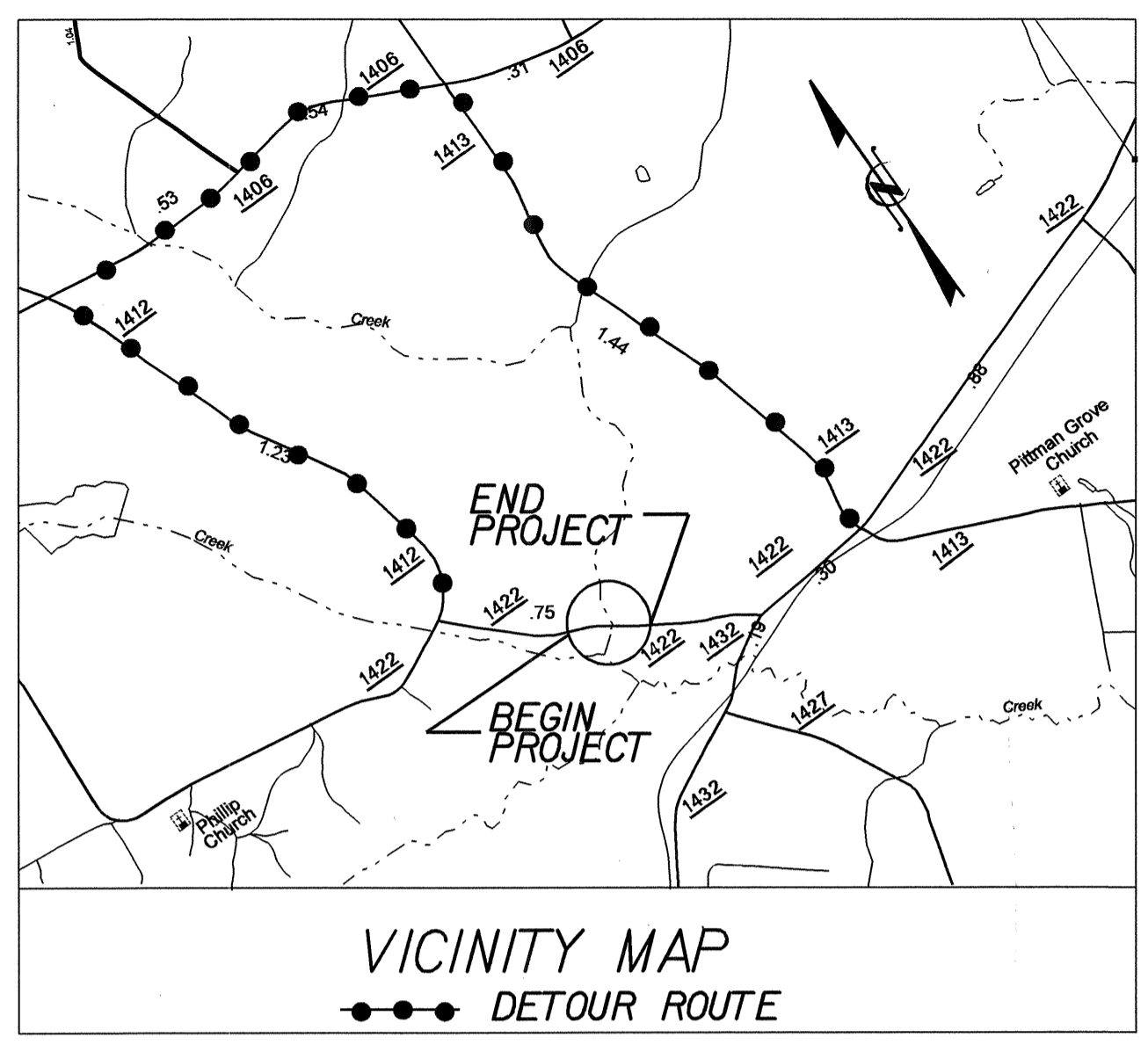

STRUCTURE

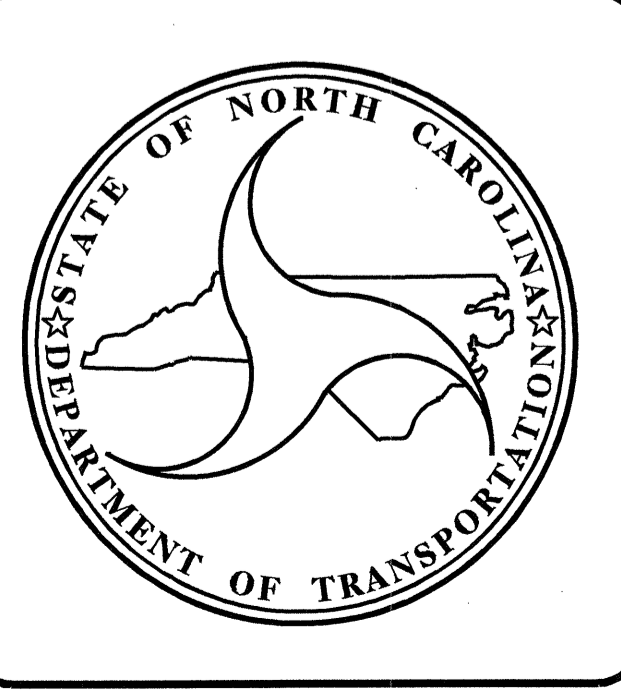
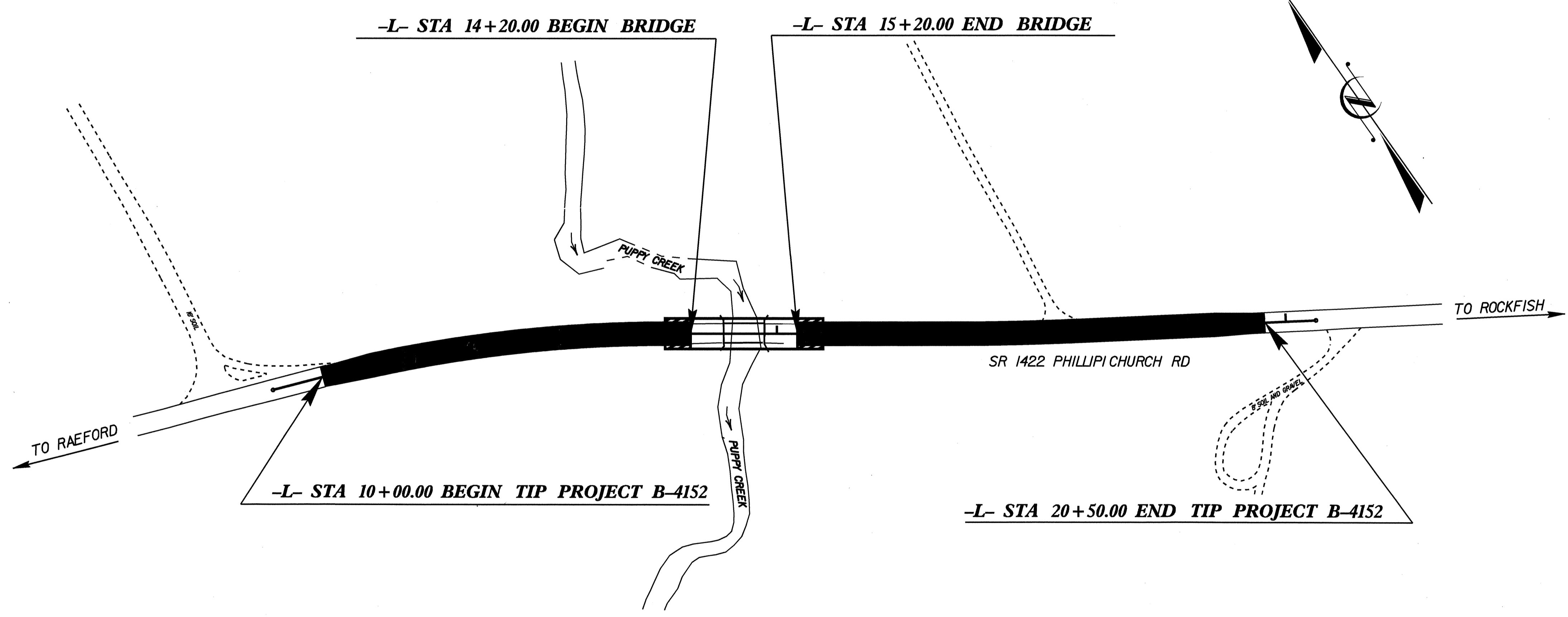

DESIGN DATA

ADT 2005 =	1600
ADT 2025 =	2600
DHV =	13 %
D =	60 %
T =	3 % *
V =	55 MPH**
FUNC CLASS =	LOCAL
* TTST 1% DUAL 2%	

PROJECT LENGTH

LENGTH OF ROADWAY TIP PROJECT B-4152 =	0.180 MI
LENGTH OF STRUCTURE TIP PROJECT B-4152 =	0.019 MI
TOTAL LENGTH OF TIP PROJECT B-4152 =	0.199 MI

Prepared In the Office of:
DIVISION OF HIGHWAYS
 1000 Birch Ridge Dr., Raleigh NC, 27610

2002 STANDARD SPECIFICATIONS LETTING DATE: FEBRUARY 21, 2006	JOHN C. FYRE, PE PROJECT ENGINEER W. A. DAVIS, PE PROJECT DESIGN ENGINEER
---	--

STRUCTURE DESIGN UNIT
 1000 Birch Ridge Dr., NC, 27610

APPROVED
 DIVISION ADMINISTRATOR DATE

DIVISION OF HIGHWAYS
 STATE OF NORTH CAROLINA

STATE DESIGN ENGINEER
 DEPARTMENT OF TRANSPORTATION
 FEDERAL HIGHWAY ADMINISTRATION

12-OCT-2005 11:45
 *****DCN*****
 jkharva