

8/17/99

PROJECT REFERENCE NO.	SHEET NO.
B-3847	EC-3/CONST.4
R/W SHEET NO.	
ROADWAY DESIGN ENGINEER	HYDRAULICS ENGINEER

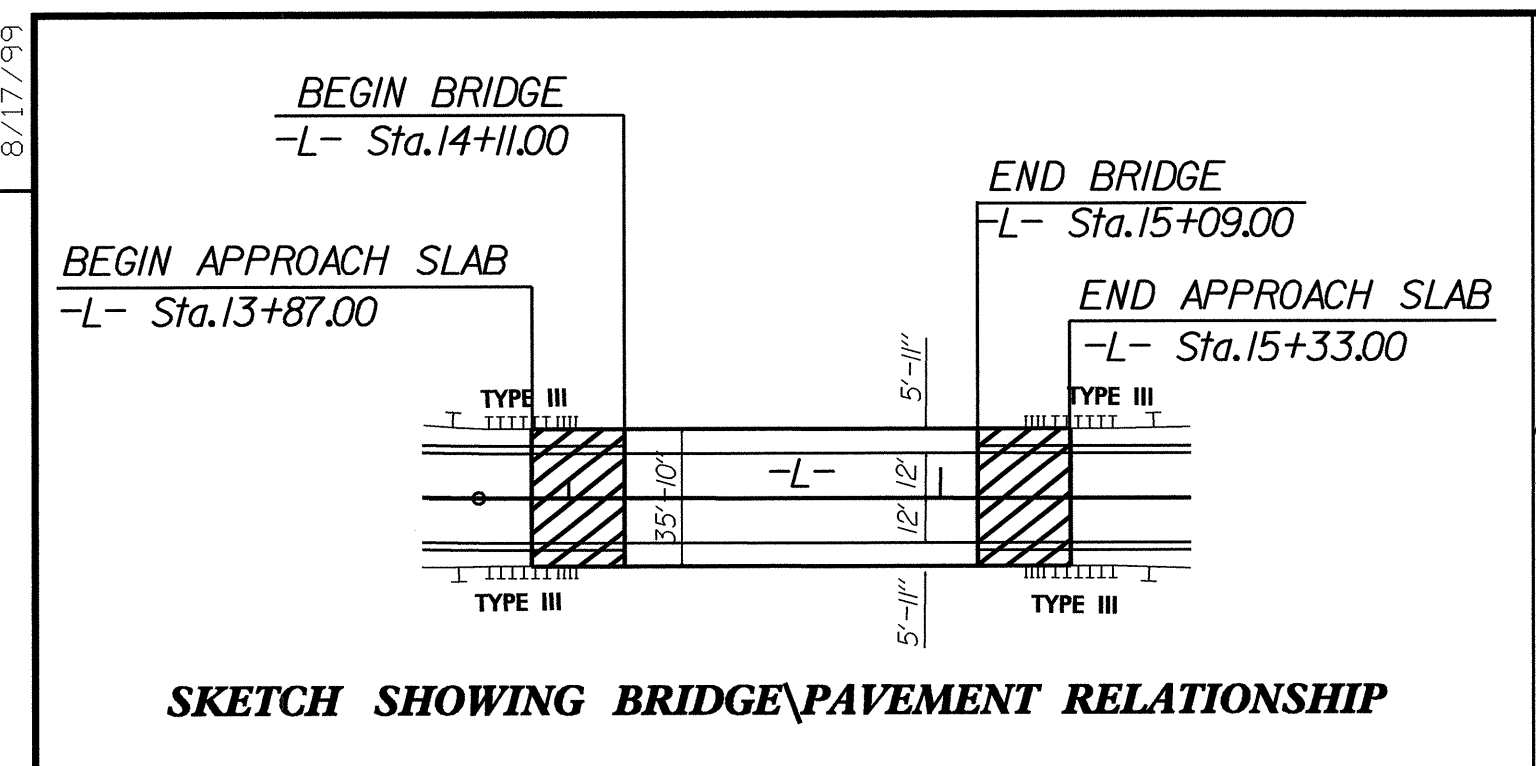

Environmental Commitments

- No fill material is to be placed on the mitigation property (R-609 D) located to the northeast of Bridge No. 63.
- NCDOT will consider alternative methods of construction with an aggressive construction schedule to minimize time of the road closure.

CLEARING AND GRUBBING
EROSION CONTROL FOR
CONSTRUCTION SHEET 3

NOTE:
UTILIZE TEMPORARY ROCK SEDIMENT DAM TYPE - B
AS STILLING BASIN WHERE APPLICABLE.

NOTE:
PLACE TEMPORARY ROCK SEDIMENT DAMS TYPE - B
AND TEMPORARY ROCK SILT CHECKS TYPE - A AT
DRAINAGE OUTLETS.

END STATE PROJECT TIP B-3847
-L- STA. 18 + 80.00

SKETCH SHOWING BRIDGE PAVEMENT RELATIONSHIP

BEGIN STATE PROJECT TIP B-3847
-L- STA. 10 + 00.00

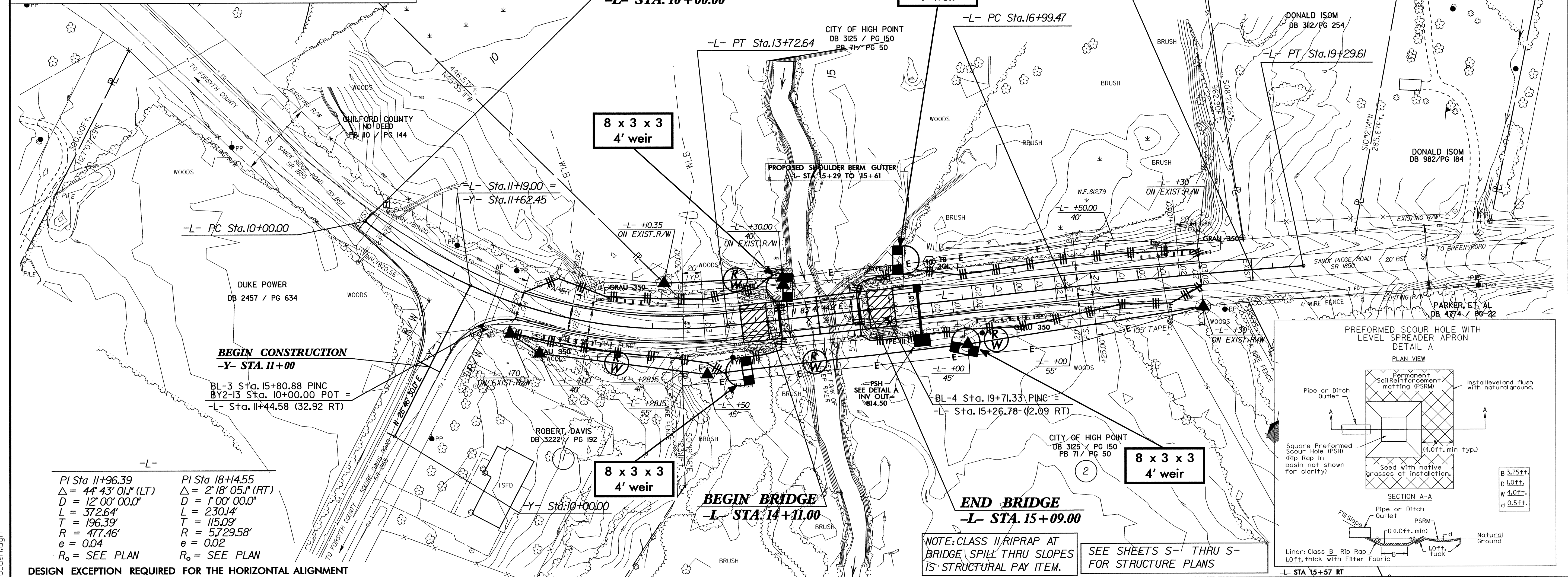

BEGIN CONSTRUCTION
-Y- STA. 11+00
BL-3 Sta. 15+80.88 PINC
BY2-13 Sta. 10+00.00 POT =
-L- Sta. 11+44.58 (32.92 RT)

-L-	-L-
PI Sta 11+96.39	PI Sta 18+4.55
Δ = 44° 43' 01.1" (LT)	Δ = 2° 18' 05.1" (RT)
D = 12° 00' 00.0"	D = 1° 00' 00.0"
L = 372.64'	L = 230.14'
T = 196.39'	T = 115.09'
R = 477.46'	R = 5729.58'
e = 0.04	e = 0.02
R ₀ = SEE PLAN	R ₀ = SEE PLAN

DESIGN EXCEPTION REQUIRED FOR THE HORIZONTAL ALIGNMENT

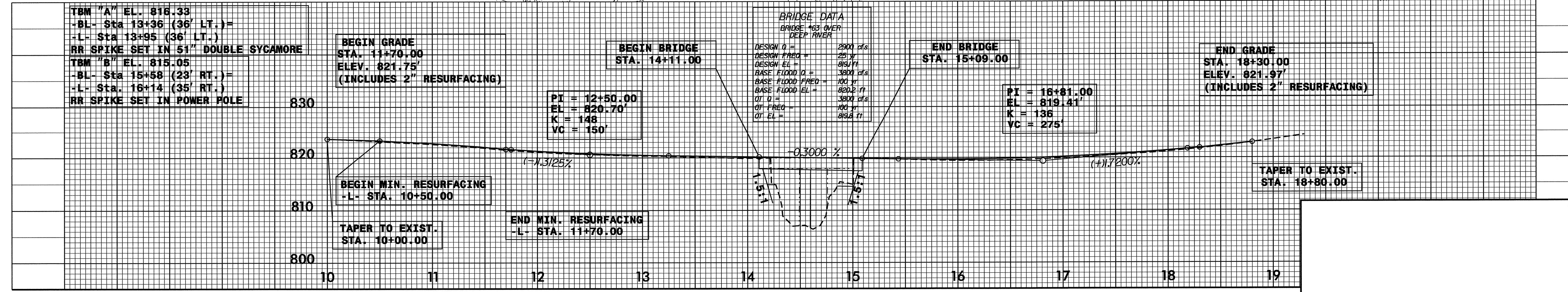

BRIDGE DATA
BRIDGE #63 OVER
DEEP RIVER

DESIGN Q =	2800 cfs
DESIGN FREQ =	25 yr
DESIGN EL =	819.11'
BASE FLOOD Q =	3800 cfs
BASE FLOOD FREQ =	100 yr
BASE FLOOD EL =	820.6'
OT Q =	3800 cfs
OT FREQ =	100 yr
OT EL =	819.6'

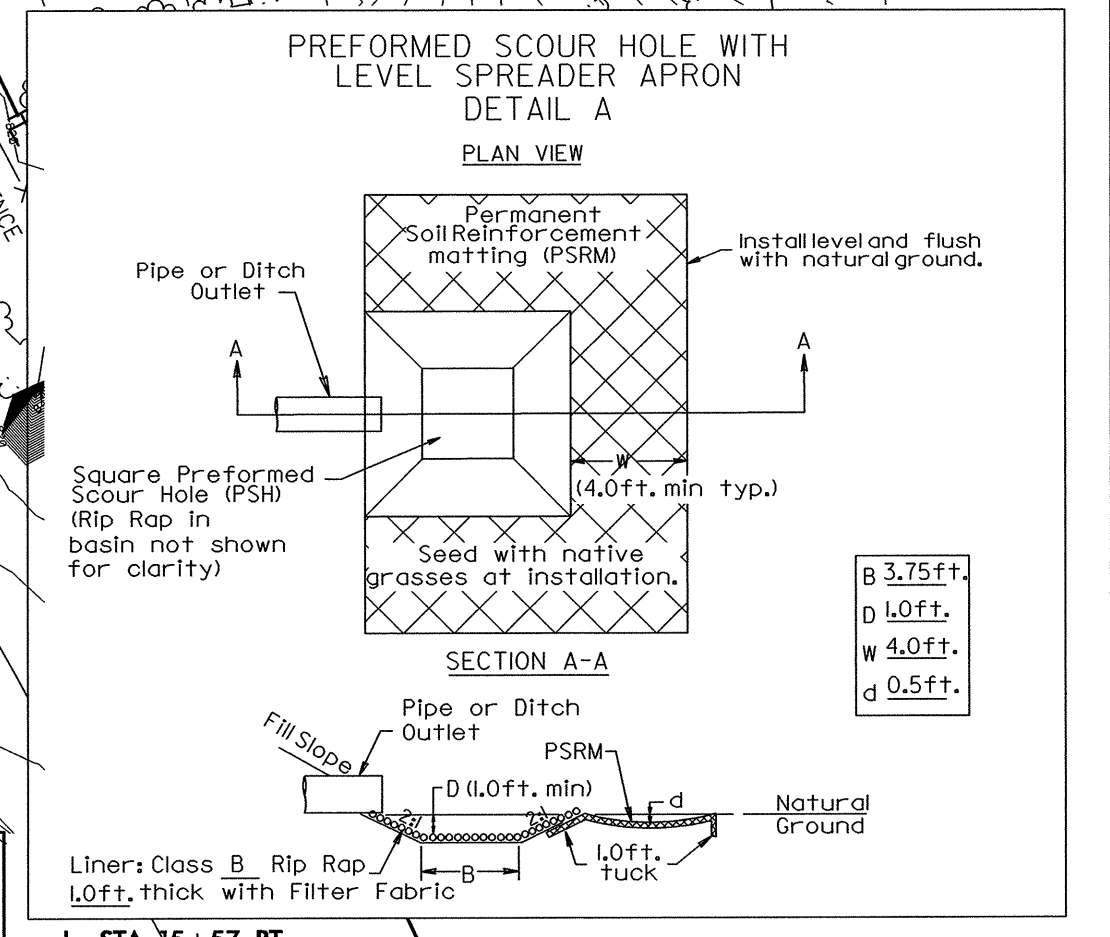

NOTE: CLASS II RIPRAP AT
BRIDGE SPILL THRU SLOPES
IS STRUCTURAL PAY ITEM.

SEE SHEETS S-1 THRU S-4
FOR STRUCTURE PLANS

REVISIONS

08-SEP-2005 14:01
c:\documents_and_settings\nchan\desktop\b-3847\design\b-3847_ec_dsn.dgn
chan