

PROJECT REFERENCE NO. B-1303	SHEET NO. EC-4/CONST.4
RW SHEET NO.	
ROADWAY DESIGN ENGINEER	HYDRAULICS ENGINEER

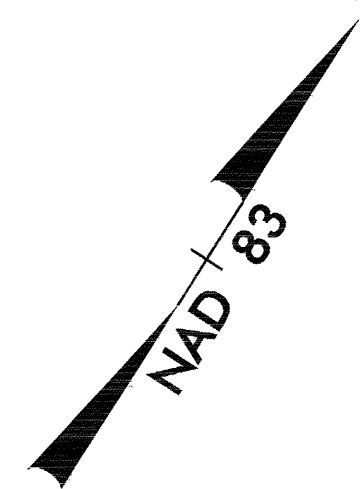

MICHAEL S. COOKE, et al
DB 576 PG 896
DB 390 PG 302

STA. 13+00.00 -L- BEGIN STATE PROJECT B-1303

STA. 24+44.63 -L- END STATE PROJECT B-1303

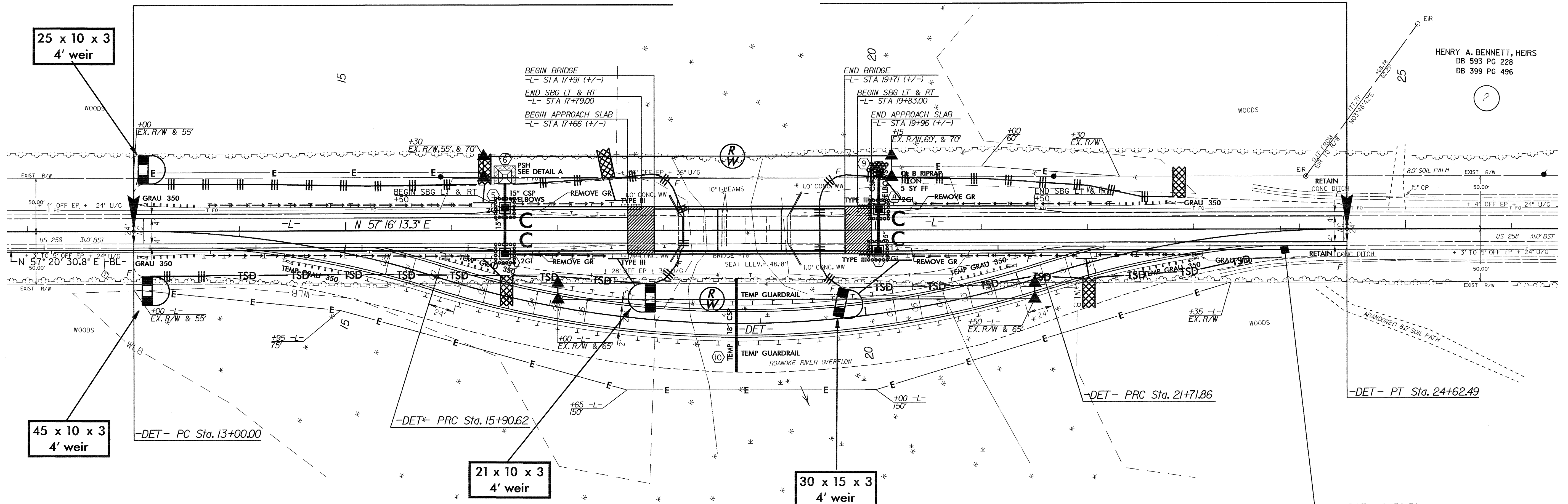

25 x 10 x 3
4' weir

45 x 10 x 3
4' weir

21 x 10 x 3
4' weir

30 x 15 x 3
4' weir

HENRY A. BENNETT, HEIRS
DB 593 PG 228
DB 399 PG 496

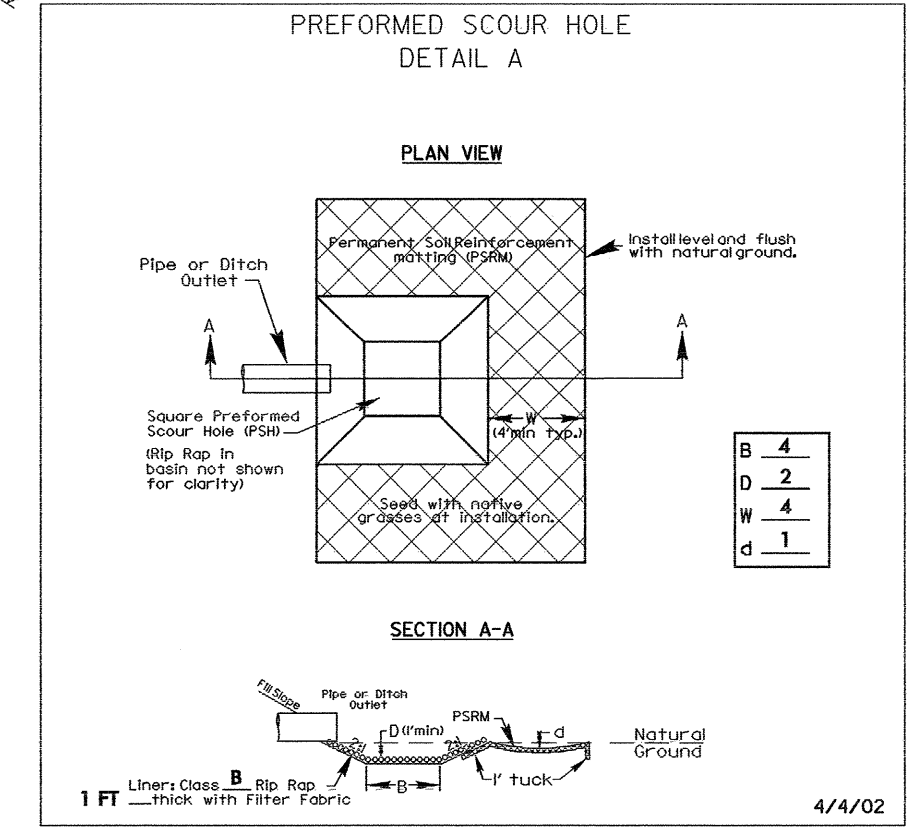
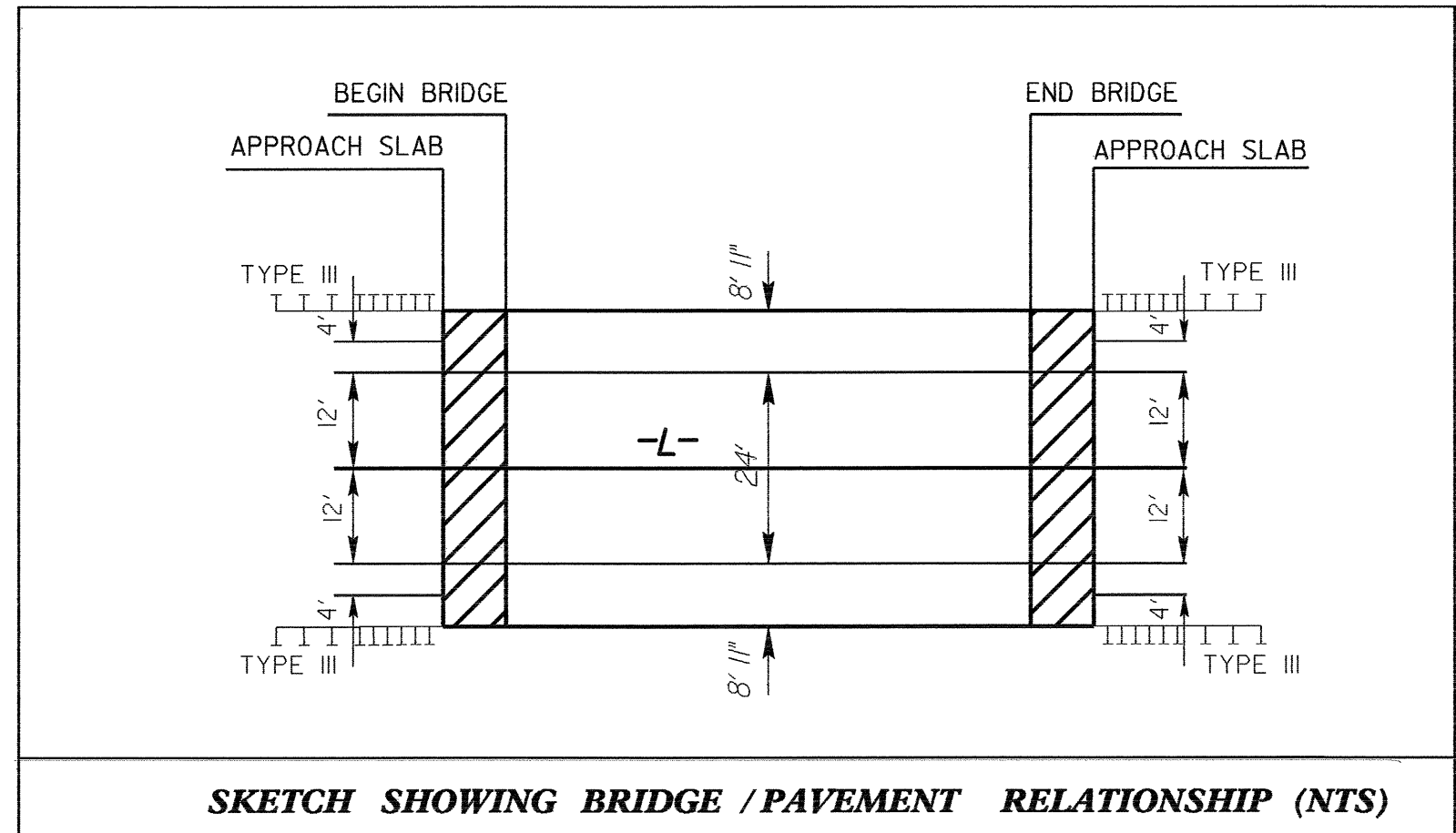

C.R. TURNER, et al
DB 341 PG 288

-DET-

PI Sta 14+46.44	PI Sta 18+90.56	PI Sta 23+18.31
$\Delta = 17' 26' 09.6''$ (RT)	$\Delta = 34' 52' 19.2''$ (LT)	$\Delta = 17' 26' 09.6''$ (RT)
$D = 5' 59' 58.4''$	$D = 5' 59' 58.4''$	$D = 5' 59' 58.4''$
$L = 290.62'$	$L = 581.24'$	$L = 290.62'$
$T = 146.44'$	$T = 299.94'$	$T = 146.44'$
$R = 955.00'$	$R = 955.00'$	$R = 955.00'$
$SE = .02$	$SE = .06$	$SE = .02$
$RO = 48'$	$RO = 144'$	$RO = 48'$

SBG: SHOULDER BERM GUTTER
PSH: PREFORMED SCOUR HOLE
FOR -L- PROFILE SEE SHEET 5
FOR -DET- PROFILE SEE SHEET 5

-L- STA. 16+50.20