

# -L- TRAFFIC SHIFT AND NB CONSTRUCTION

PROJ. REFERENCE NO. U-3837	SHEET NO. TCP-15
-------------------------------	---------------------

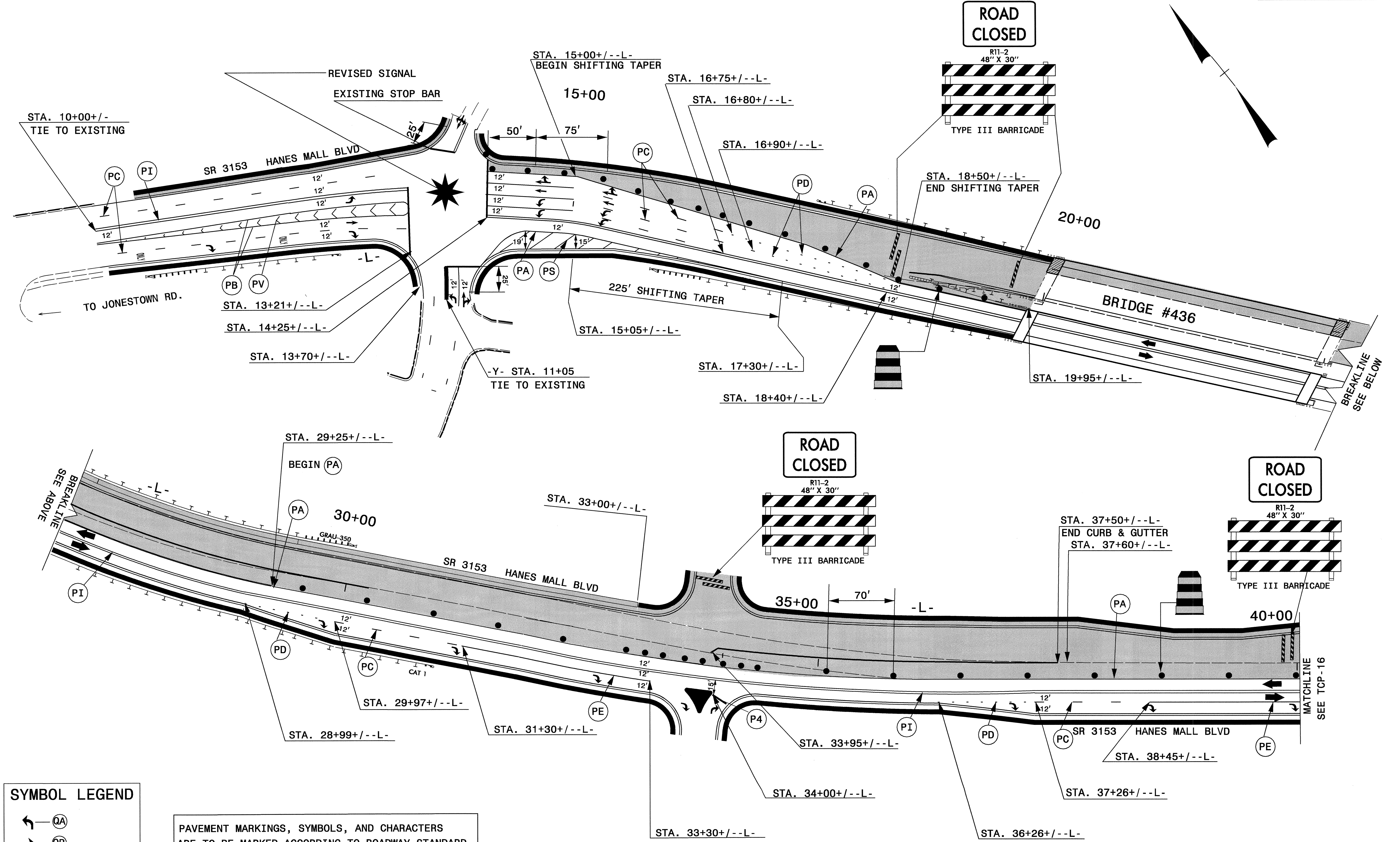

**SYMBOL LEGEND**

↖	QA
↗	QB
↕	QE
↑	QC
↔	QG

PAVEMENT MARKINGS, SYMBOLS, AND CHARACTERS ARE TO BE MARKED ACCORDING TO ROADWAY STANDARD DRAWINGS UNLESS OTHERWISE NOTED IN THE PLANS.

TEMPORARY PAVEMENT MARKERS ARE TO BE SPACED ACCORDING TO THE ROADWAY STANDARD DRAWINGS.

★  
REVISED EXISTING SIGNAL FOR TEMPORARY TRAFFIC PATTERN

APPROVED: *[Signature]* DATE: 11/26/04

SEAL

NORTH CAROLINA  
PROFESSIONAL  
ENGINEER  
JOSEPH H. SHANK

SEAL  
028380

## PHASE II, DETAIL 2

SCALE: NONE		REVISIONS
DATE: NOV 04		
DESIGN BY: MM		
REVIEWED BY: JI		

26-JAN-2005 07:32 \\efs-cc\fs01\3837\TCP\TCP\15\PhaseII\Detail.dgn mmckoy AT 11/26/04