

-L- TRAFFIC SHIFT AND NB CONSTRUCTION

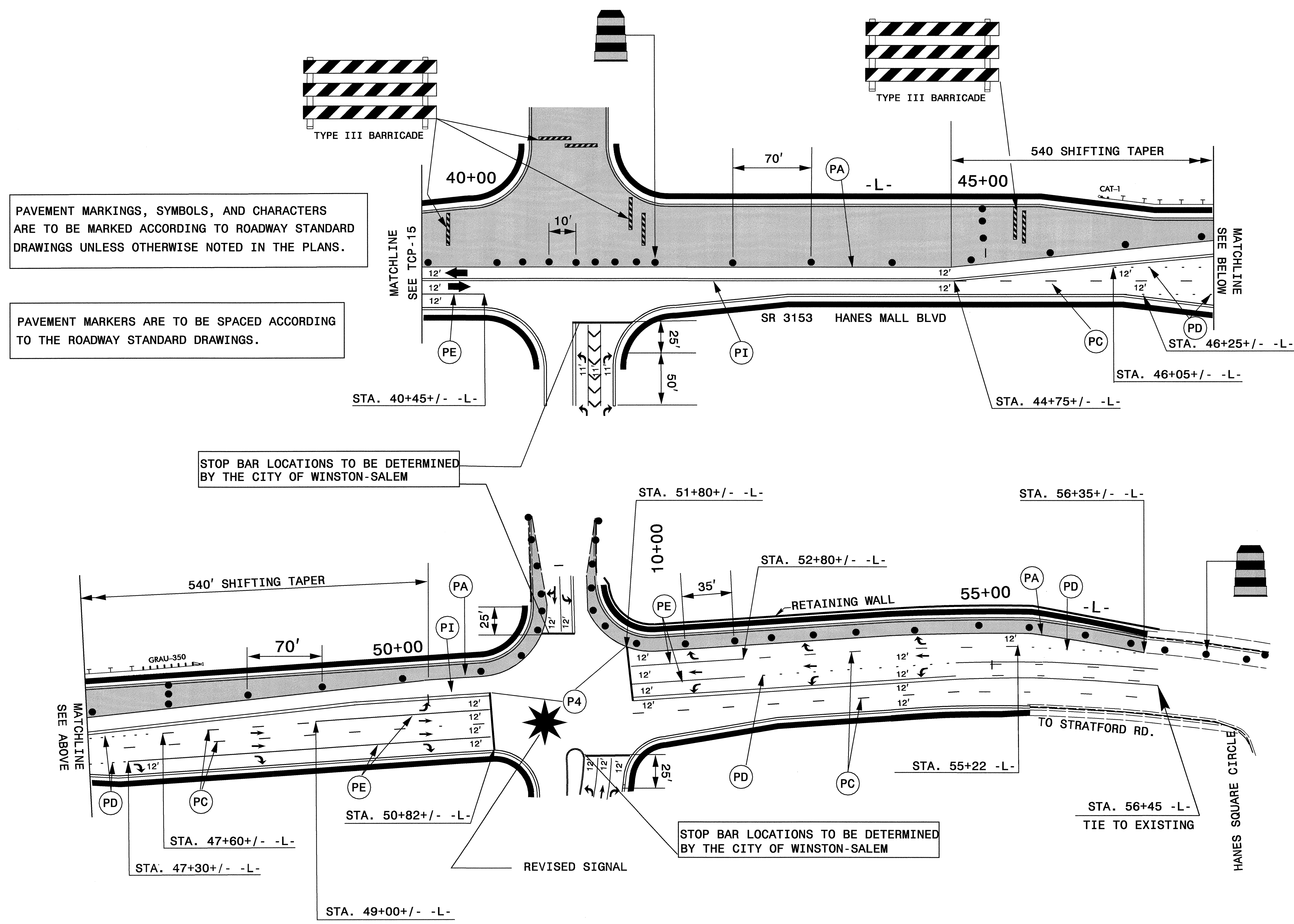

PAVEMENT MARKINGS, SYMBOLS, AND CHARACTERS ARE TO BE MARKED ACCORDING TO ROADWAY STANDARD DRAWINGS UNLESS OTHERWISE NOTED IN THE PLANS.

PAVEMENT MARKERS ARE TO BE SPACED ACCORDING TO THE ROADWAY STANDARD DRAWINGS.

STOP BAR LOCATIONS TO BE DETERMINED BY THE CITY OF WINSTON-SALEM

STOP BAR LOCATIONS TO BE DETERMINED BY THE CITY OF WINSTON-SALEM

REVISED EXISTING SIGNAL FOR TEMPORARY TRAFFIC PATTERN

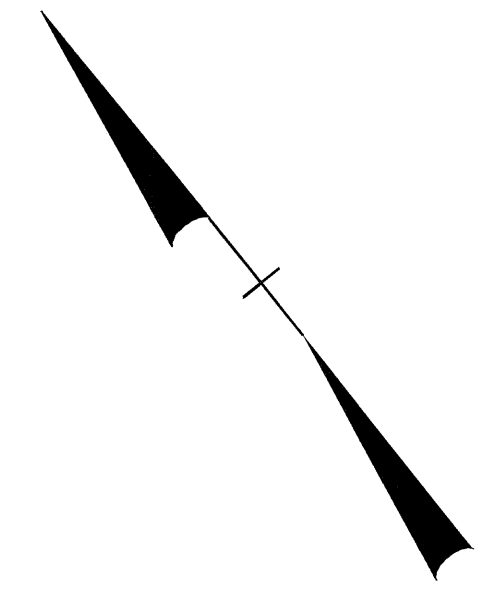

SYMBOL LEGEND	
	QA
	QB
	QE
	QC
	QG

25-JAN-2005 16:44 \\ets-ccf50\j3837\TCP\TCP-16\PhaseII\Detail2.dgn mmckoy AT TETC93445

APPROVED: *Joseph Ishak* DATE: 1/26/05

SEAL

PHASE II, DETAIL 3

SCALE: NONE		<table border="1"> <thead> <tr> <th colspan="2">REVISIONS</th> </tr> </thead> <tbody> <tr> <td> </td> <td> </td> </tr> <tr> <td> </td> <td> </td> </tr> <tr> <td> </td> <td> </td> </tr> <tr> <td> </td> <td> </td> </tr> </tbody> </table>	REVISIONS									
REVISIONS												
DATE: NOV 03												
DWG. BY: MM												
DESIGN BY: MM												
REVIEWED BY: JI												