

**CONTRACT: C201143 TIP PROJECT: R-4404**

STATE OF NORTH CAROLINA  
DIVISION OF HIGHWAYS

STATE	STATE PROJECT REFERENCE NO.	SHEET NO.	TOTAL SHEETS
N.C.	R-4404	1	
STATE PROJ. NO.	F.A. PROJ. NO.	DESCRIPTION	
37697.3.1	NHS-000S(389)	P.E. & CONST.	

# DURHAM, GRANVILLE, PERSON, & WAKE COUNTIES

(PART 1 OF 2)

**LOCATION:** NC 147, FROM I-85 TO TW ALEXANDER DRIVE SOUTH OF I-40; US 158 (PERSON COUNTY); US 158, FROM THE PERSON COUNTY LINE TO EXIT 206 IN GRANVILLE COUNTY; US 70, FROM EAST OF I-540 TO NC 50 (CREEDMOOR ROAD) IN WAKE COUNTY AND FROM VANDORA SPRINGS ROAD INTERCHANGE IN WAKE COUNTY TO THE JOHNSTON COUNTY LINE; US 64, EAST OF NEW HOPE ROAD TO NEUSE RIVER BRIDGE

**TYPE OF WORK:** NATIONAL HIGHWAY SYSTEM GUARDRAIL REHABILITATION AND SAFETY IMPROVEMENTS-INSTALL MEDIAN GUARDRAIL, REPLACE EXISTING GUARDRAIL, GUARDRAIL END TREATMENTS, BRIDGE ANCHOR UNITS, CONCRETE BARRIER, AND INSTALL WIRE ROPE SAFETY FENCE

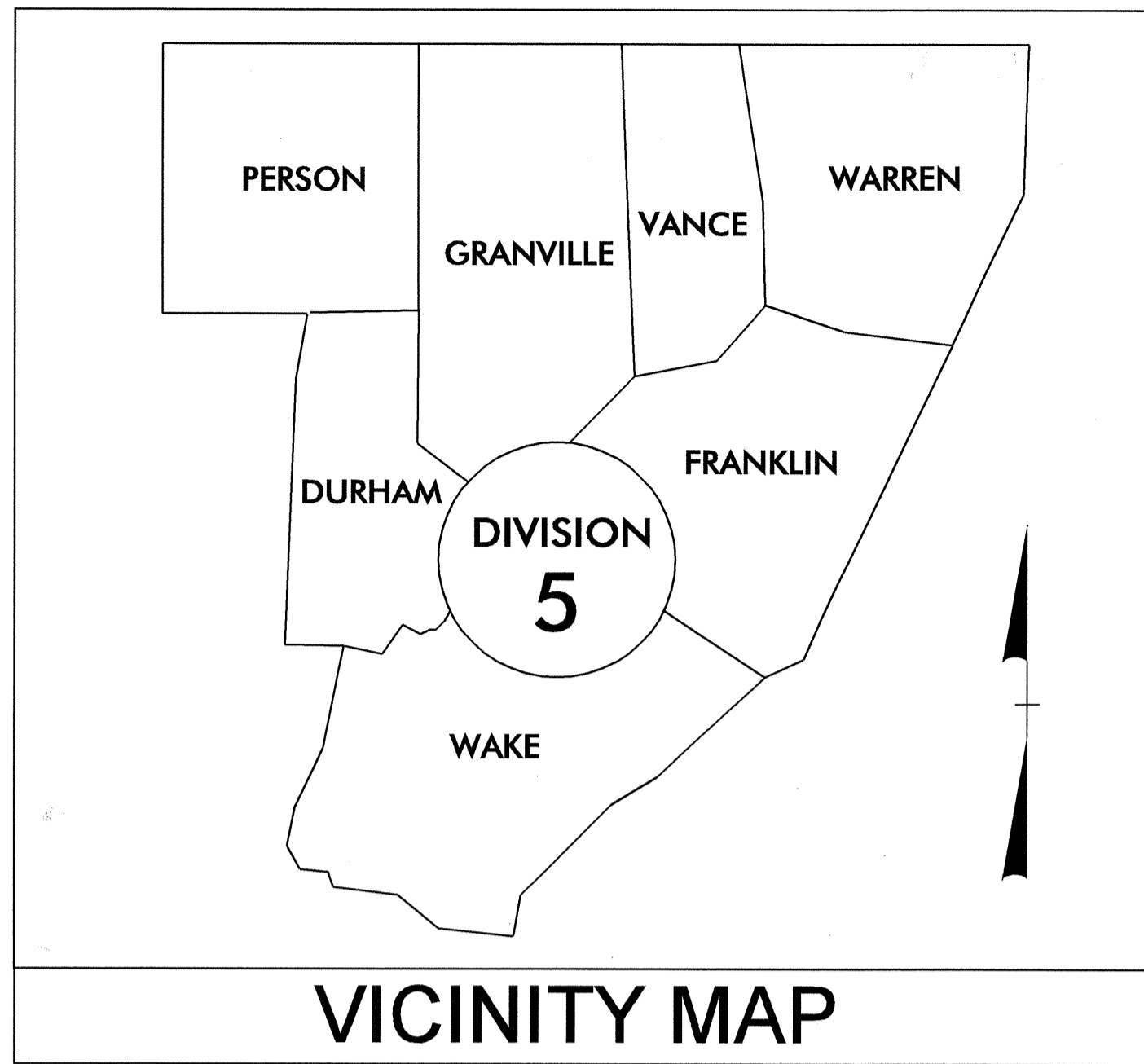

See Sheet 1-A For Index of Sheets  
See Sheet 1-B For Conventional Symbols

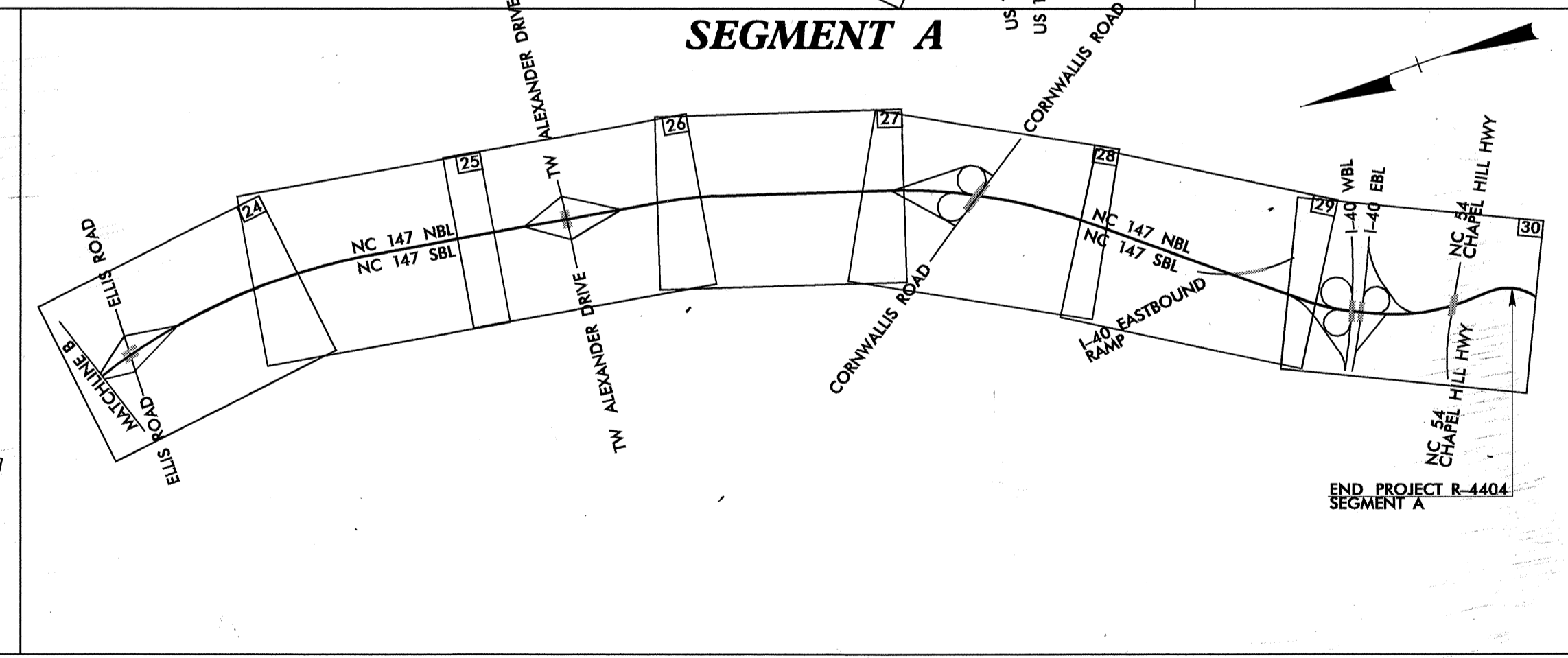
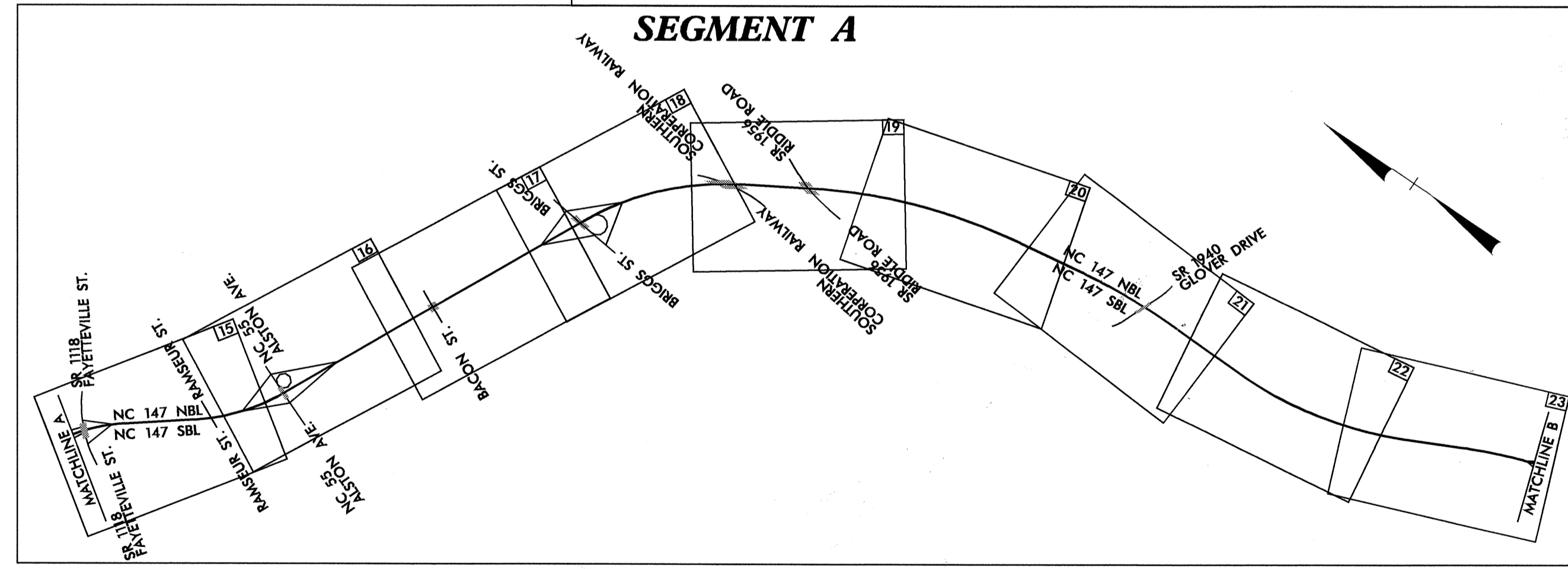
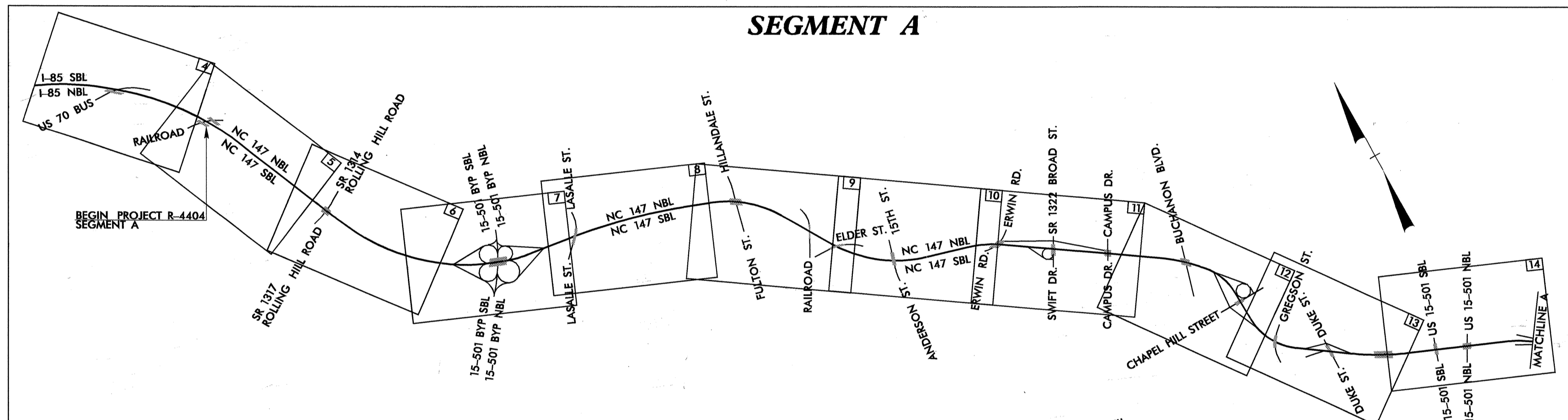

**GRAPHIC SCALES**

SEGMENTS A, B, C, D, E, & F  
NOT TO SCALE

**DESIGN DATA**

NA

**PROJECT LENGTH**

TOTAL LENGTH TIP PROJECT R-4404= 28.5 Miles  
(TOTAL LENGTH FOR SEGMENTS A, B, C, D, E, AND F)

Prepared in the Office of:  
**DIVISION OF HIGHWAYS**  
1000 Birch Ridge Dr., Raleigh, NC 27610

2002 STANDARD SPECIFICATIONS

RIGHT OF WAY DATE:  
NA

LETTING DATE:  
SEPTEMBER 20, 2005

**JAMES A. SPEER PE**  
PROJECT ENGINEER

**DANNY GARDNER**  
PROJECT DESIGN ENGINEER

**HYDRAULICS ENGINEER**

SIGNATURE: NA P.E.

ROADWAY DESIGN  
ENGINEER  
SEAL  
JAMES A. SPEER  
5/11/05 P.E.

**DIVISION OF HIGHWAYS  
STATE OF NORTH CAROLINA**

*Ant McMillan* P.E.  
STATE DESIGN ENGINEER  
DEPARTMENT OF TRANSPORTATION  
FEDERAL HIGHWAY ADMINISTRATION

APPROVED  
DIVISION ADMINISTRATOR DATE