

SEGMENT E: US 70 VANDORA SPRINGS ROAD INTERCHANGE TO JOHNSTON COUNTY LINE

PROJECT REFERENCE NO. R-4404	SHEET NO. 36
RW SHEET NO.	

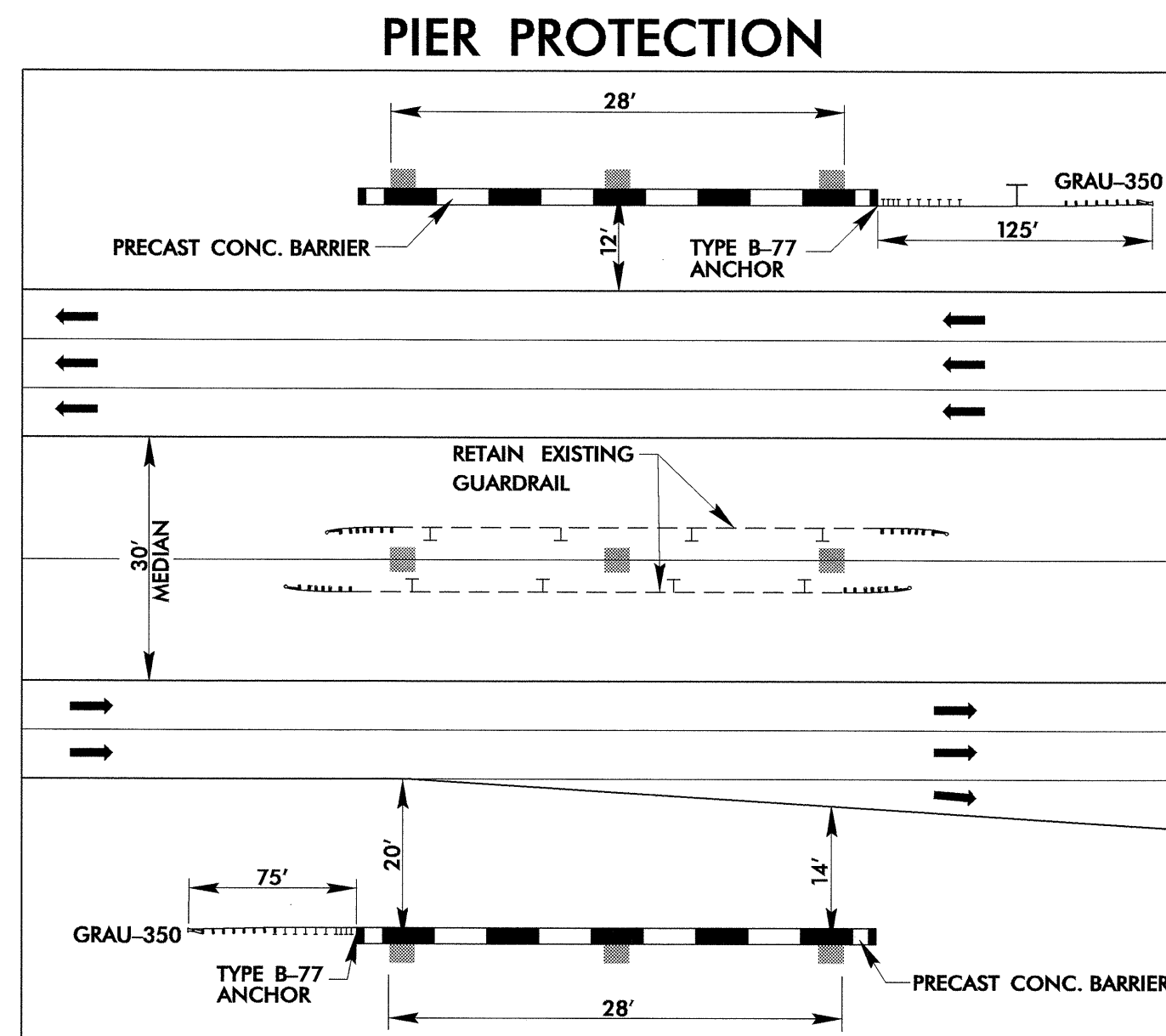

NOTE: ONCE THE CONTRACTOR HAS COMPLETED THE BARRIER INSTALLATION, STATE FORCES WILL GRADE AND PAVE THE SHOULDER UP TO THE FACE OF THE BARRIER.

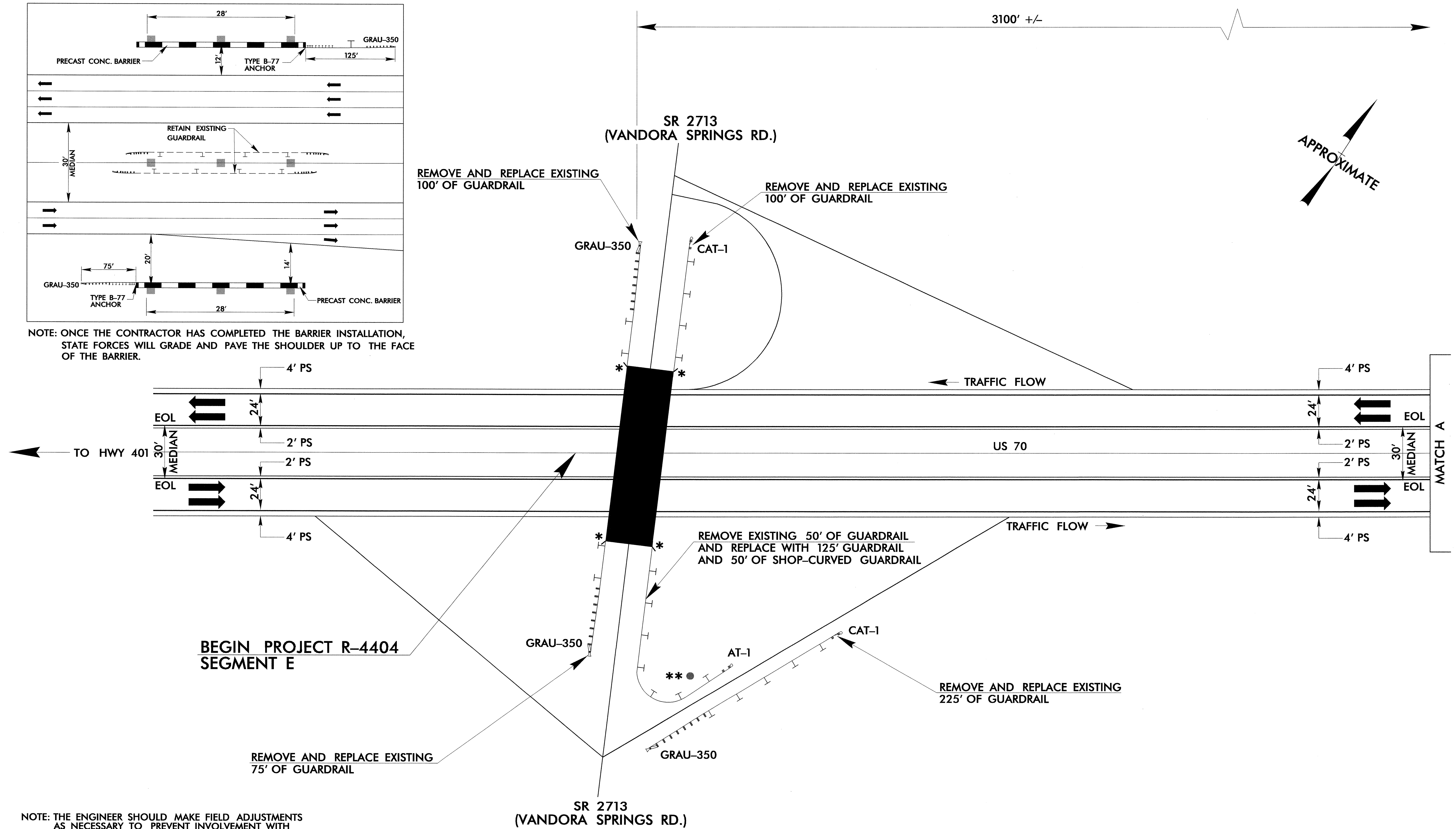

NOTE: THE ENGINEER SHOULD MAKE FIELD ADJUSTMENTS AS NECESSARY TO PREVENT INVOLVEMENT WITH DRAINAGE STRUCTURES, PIPES, ETC.

NOTE: FIELD DRILLING OR PUNCHING AND SPLICING OF GUARDRAIL MAY BE REQUIRED FOR THE ATTACHMENT OF PROPOSED GUARDRAIL TO EXISTING GUARDRAIL

* NOTE: SPECIAL ANCHOR UNIT TYPE BP III ON ALL 4 CORNERS SEE DETAIL SHEET 2-D THRU 2-E

** NOTE: SHOP CURVE GUARDRAIL AROUND RADIUS OF EAST BOUND RAMP FOR PROTECTION OF POWER POLE THAT IS LOCATED 9' FROM RAMP EOP

NOT TO SCALE

5/14/03
18-APR-2005 12:08
EADouglas