

09/08/09

SEE SHEET 1-A FOR INDEX OF SHEETS
SEE SHEET 1-B FOR CONVENTIONAL SYMBOLS

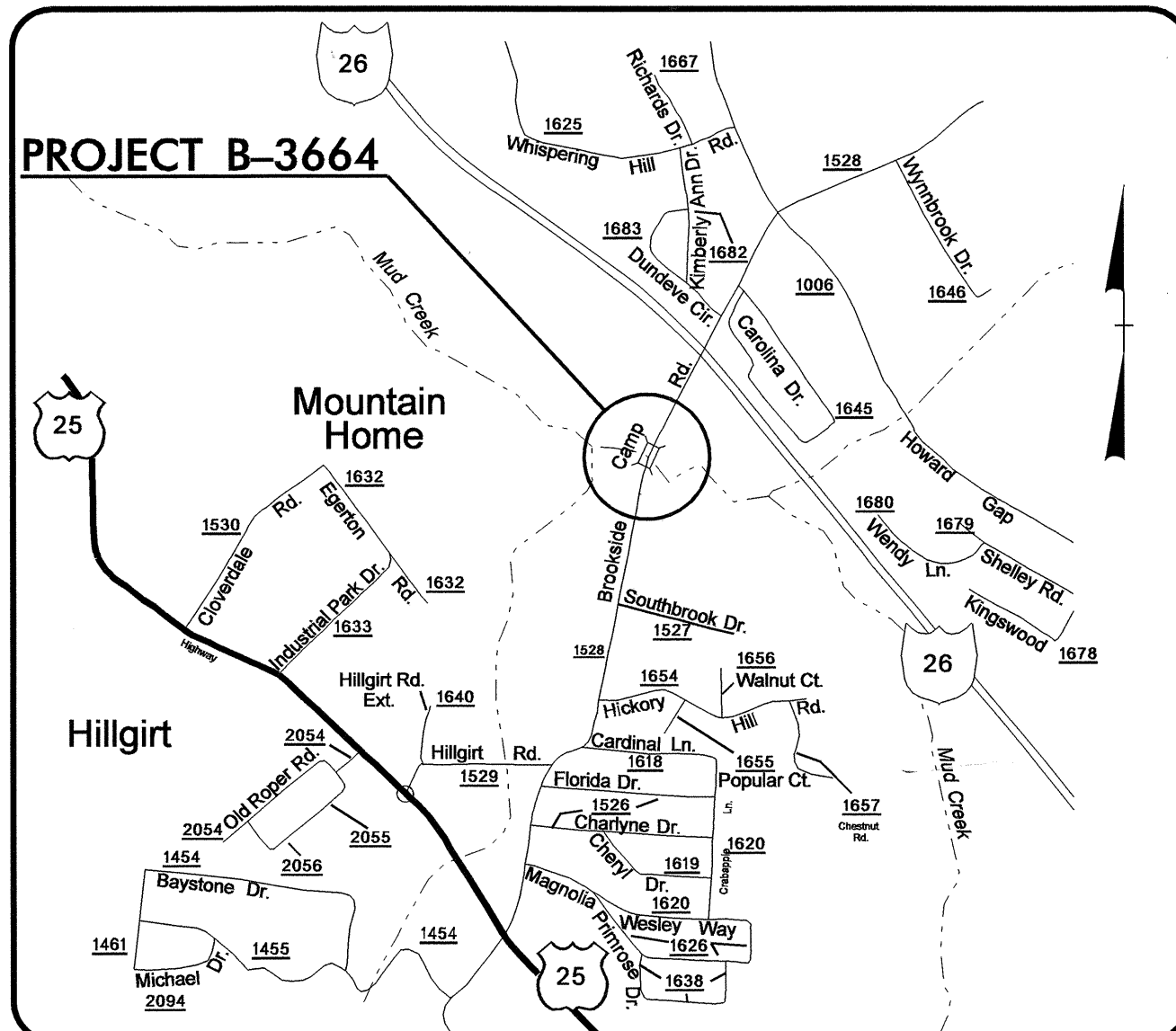

VICINITY MAP
TEMPORARY OFFSITE DETOUR USED DURING CONSTRUCTION.
SEE TRAFFIC CONTROL PLANS; SHEET TCP-10

STATE OF NORTH CAROLINA
DIVISION OF HIGHWAYS

HENDERSON COUNTY

LOCATION: BRIDGE NO. 21 OVER MUD CREEK ON SR 1528

TYPE OF WORK: GRADING, PAVING, DRAINAGE, AND STRUCTURE

STATE	STATE PROJECT REFERENCE NO.	SHEET NO.	TOTAL SHEETS
N.C.	B-3664	1	
STATE PROJ. NO.	F.A. PROJ. NO.	DESCRIPTION	
33209.1.1	BRZ-1528(2)	P.E.	
33209.2.1	BRZ-1528(2)	R/W, UTILITIES	
33209.3.1	BRZ-1528(3)	CONST.	

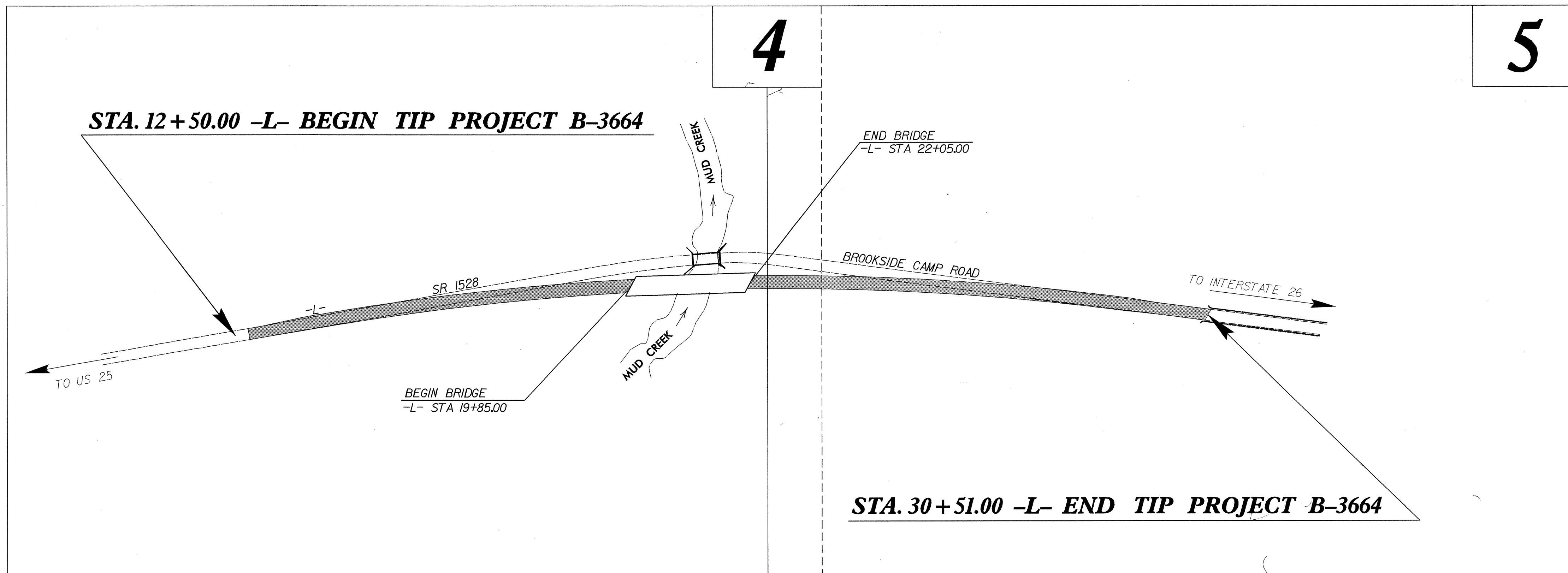
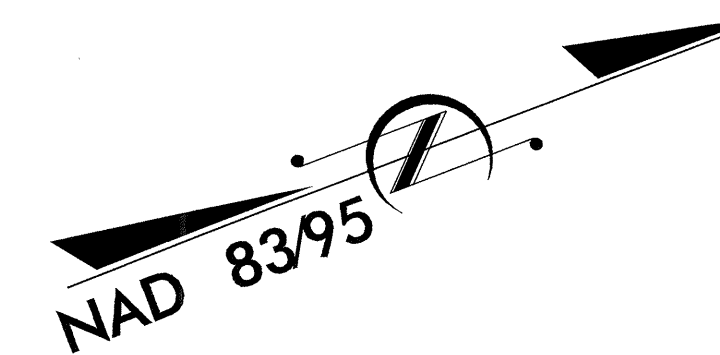

GRAPHIC SCALES

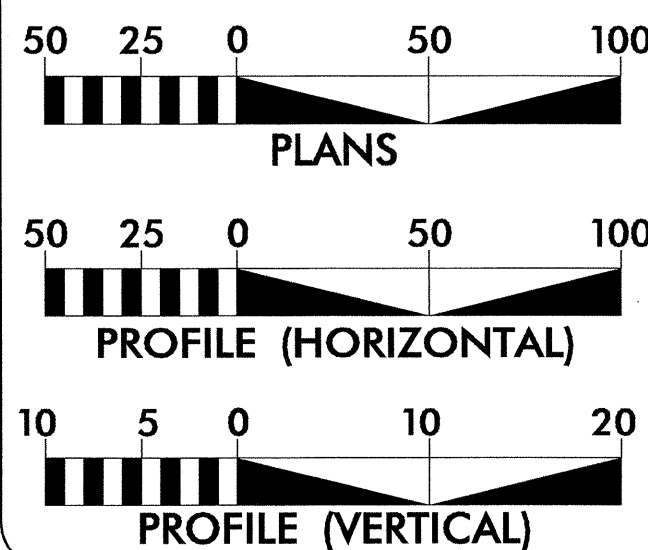

DESIGN DATA

ADT 2005 = 5826
 ADT 2025 = 10000
 DHV = 10 %
 D = 60 %
 T = 3 % *
 V = 40 MPH
 FUNC CLASS : RURAL MINOR COLLECTOR
 * TTST 1 % DUAL 2 %

PROJECT LENGTH

LENGTH ROADWAY TIP PROJECT B-3664 = 0.299 MILES
 LENGTH STRUCTURE TIP PROJECT B-3664 = 0.042 MILES
 TOTAL LENGTH OF TIP PROJECT B-3664 = 0.341 MILES

Prepared in the Office of:
DIVISION OF HIGHWAYS
 1000 Birch Ridge Dr., NC, 27610

2002 STANDARD SPECIFICATIONS

RIGHT OF WAY DATE:
JULY 16, 2004

LETTING DATE:
JULY 19, 2005

GARY LOVERING, P.E.
PROJECT ENGINEER

RON McCOLLUM, P.E.
PROJECT DESIGN ENGINEER

HYDRAULICS ENGINEER

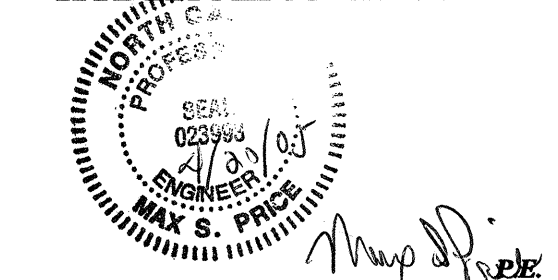

SIGNATURE: *[Signature]*
 NORTH CAROLINA
 PROFESSIONAL ENGINEER
 SEAL 024826
 ENGINEER
 RONALD E. McCOLLUM
 SIGNATURE: *[Signature]* P.E.

DIVISION OF HIGHWAYS STATE OF NORTH CAROLINA

ant millan P.E.
 STATE DESIGN ENGINEER
 DEPARTMENT OF TRANSPORTATION
 FEDERAL HIGHWAY ADMINISTRATION
 APPROVED
 DIVISION ADMINISTRATOR
 DATE

20 APR 2005 09:30 B-3664.tsh
H:\Sweat\work\AT\RD\23246

CONTRACT: C201254 TIP PROJECT: B-3664