

## B-3664 SURVEY CONTROL SHEET

### CONTROL DATA

BL	POINT	DESC.	NORTH	EAST	ELEVATION	L STATION	OFFSET
1		BL1	607939.0720	963411.9060	2076.57	11+73.73	20.76 LT
2		BL2	608329.2970	963489.9550	2062.99	15+70.90	21.70 LT
3		BL3	608844.1300	963604.4560	2067.38	20+93.58	54.30 LT
4		BL4	609477.4330	963953.3910	2093.26	28+11.07	17.33 RT

### NOTES

1. THE CONTROL DATA FOR THIS PROJECT CAN BE FOUND ELECTRONICALLY BY SELECTING PROJECT CONTROL DATA AT:

HTTP://WWW.DOH.DOT.STATE.NC.US/PRECONSTRUCT/HIGHWAY/LOCATION/PROJECT/

FILE: B3664.LS\_CONTROL\_040513.TXT

SITE CALIBRATION INFORMATION HAS NOT BEEN PROVIDED FOR THIS PROJECT. IF FURTHER INFORMATION IS NEEDED, PLEASE CONTACT THE LOCATION AND SURVEYS UNIT.

..... ELEVATION = 2092.36  
 BM1 607538 E 963392  
 L STATION 10+00  
 S 1° 46' 41.8" W DIST 227.05  
 8" SPIKE SET IN 18" WALNUT  
 .....

..... ELEVATION = 2069.43  
 BM2 608174 E 963501  
 L STATION 14+22 22 RIGHT  
 8" SPIKE SET IN 18" WHITE PINE  
 .....

..... ELEVATION = 2063.82  
 BM3 608933 E 963584  
 L STATION 21+70 104 LEFT  
 8" SPIKE SET IN 12" HICKORY  
 .....

..... ELEVATION = 2085.23  
 BM4 609455 E 963807  
 L STATION 27+61 32 LEFT  
 8" SPIKE SET IN 12" HICKORY  
 .....

..... ELEVATION = 2108.70  
 BM5 609876 E 964165  
 L STATION 32+52  
 N 83° 43' 59.8" E DIST 19.33  
 NCGS MONUMENT "HOOPER"  
 .....

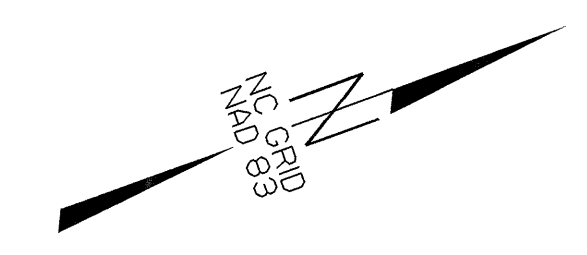

NCDOT BASELINE STATION 14400-BL4  
 LOCALIZED PROJECT COORDINATES  
 N = 610085.542  
 E = 963809.672

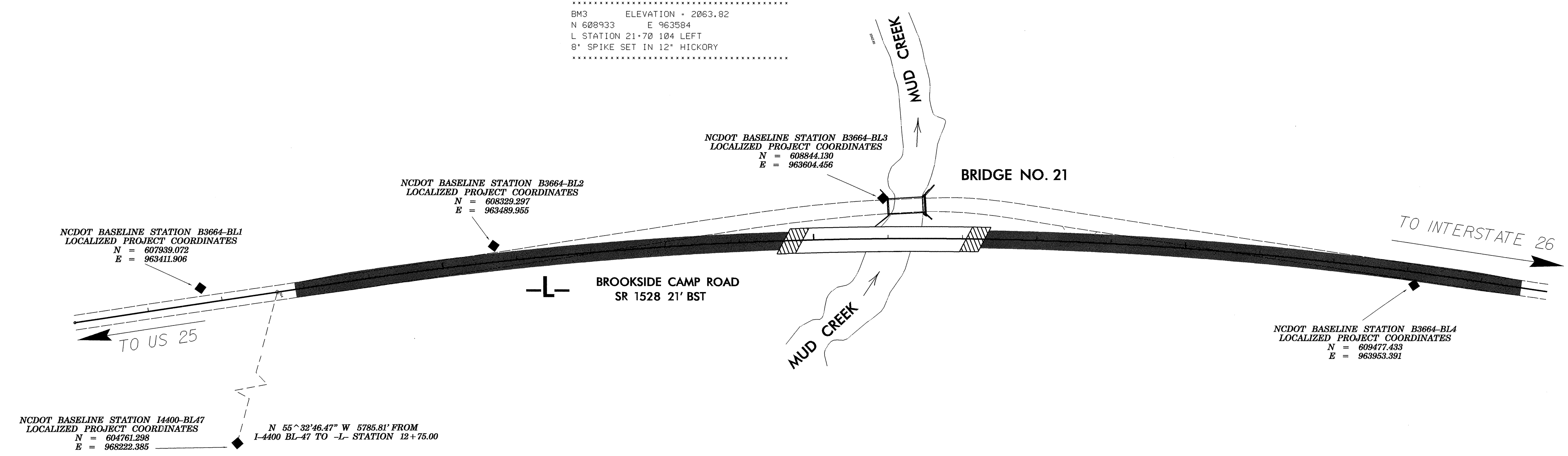

### DATUM DESCRIPTION

THE LOCALIZED COORDINATE SYSTEM DEVELOPED FOR THIS PROJECT IS BASED ON THE STATE PLANE COORDINATES ESTABLISHED BY NCDOT FOR MONUMENT "I-4400, BL47"

WITH HARN-NAD 1983/95 STATE PLANE GRID COORDINATES OF NORTHING: 604761.2980(1) EASTING: 968222.3850(1)

THE AVERAGE COMBINED GRID FACTOR USED ON THIS PROJECT (GROUND TO GRID) IS: 99977884

THE N.C. LAMBERT GRID BEARING AND LOCALIZED HORIZONTAL GROUND DISTANCE FROM "I-4400, BL47" TO -L- STATION 12+75.00 IS

N 55° 32' 46.47" W DISTANCE 5785.81'

ALL LINEAR DIMENSIONS ARE LOCALIZED HORIZONTAL DISTANCES

VERTICAL DATUM USED IS NAVD 88

◆ INDICATES GEODETIC CONTROL MONUMENTS USED OR SET FOR HORIZONTAL PROJECT CONTROL BY THE NCDOT LOCATION AND SURVEYS UNIT.

PROJECT CONTROL ESTABLISHED UTILIZING GLOBAL POSITIONING SYSTEM FOR PROJECT I-4400.

NCDOT BASELINE STATION 14400-BL53  
 LOCALIZED PROJECT COORDINATES  
 N = 609353.615  
 E = 964480.069

NOTE: DRAWING NOT TO SCALE