

PROJECT REFERENCE NO.	SHEET NO.
B-3664	EC-6/CONST.4
RW SHEET NO.	
ROADWAY DESIGN ENGINEER	HYDRAULICS ENGINEER

SEE SHEET 6 FOR -L- PROFILE
 SEE SHEET 8 FOR -DRI- PROFILE
 BRIDGE APPROACH SLAB

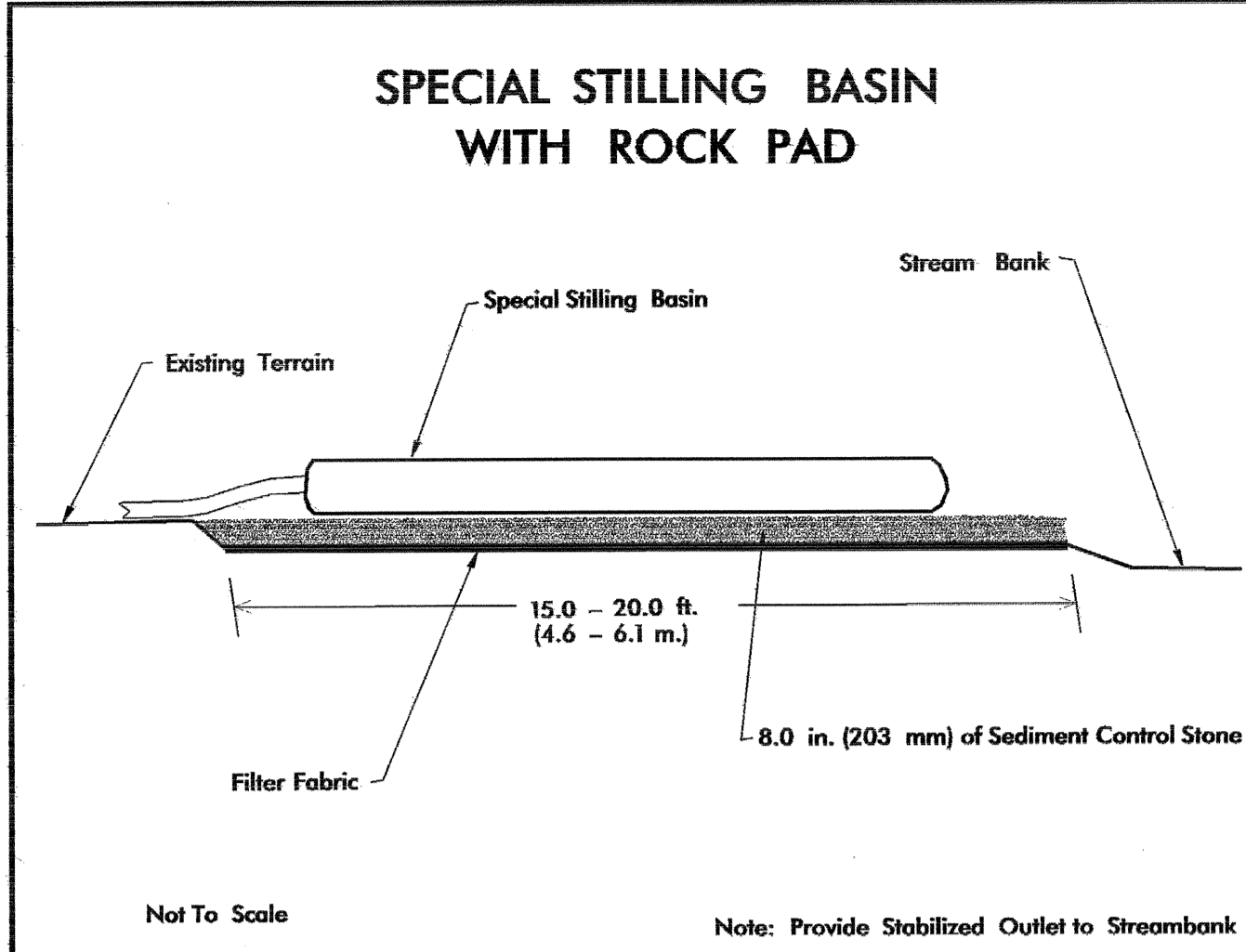

NOTE:
 UTILIZE SPECIAL STILLING BASIN
 AS STILLING BASIN WHERE APPLICABLE.

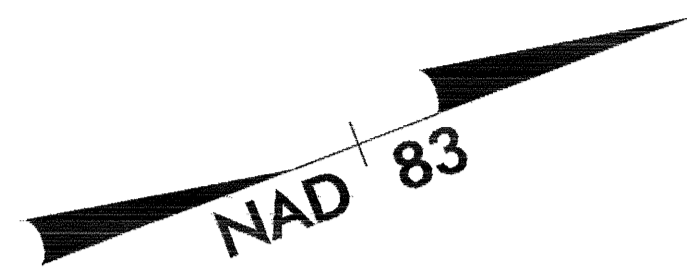
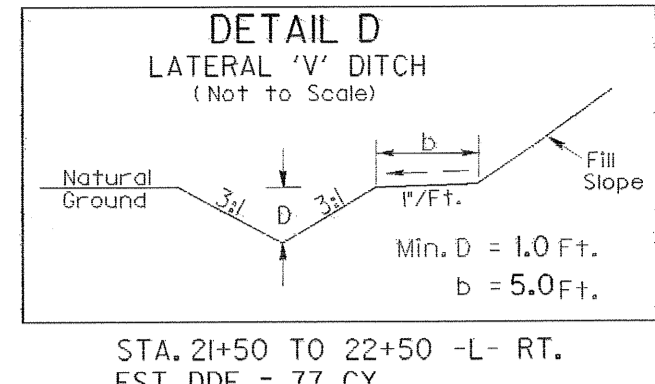
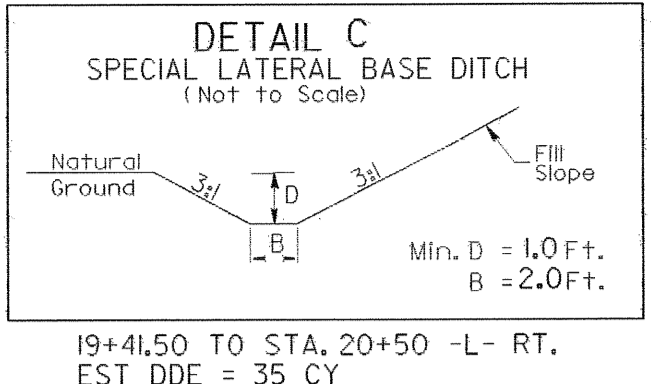
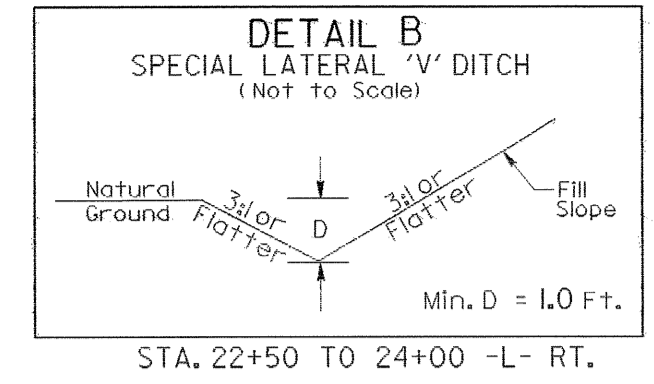

-L-
 PI Sta 21+40.23
 $\Delta = 17' 12' 04.8''$ (RT)
 $D = 1' 08' 45.3''$
 $L = 1,501.10'$
 $T = 756.24'$
 $R = 5,000.00'$
 $SE = .02$ FT/FT
 $RUNOFF = 41.38'$
 $INCR = 20.69'$ PER .01 SE

-DRI-
 PI Sta 10+49.03
 $\Delta = 17' 29' 11.4''$ (RT)
 $D = 22' 28' 08.2''$
 $L = 511.2'$
 $T = 25.65'$
 $R = 255.00'$

PI Sta 11+7.50
 $\Delta = 81' 23' 10.3''$ (LT)
 $D = 114' 35' 29.6''$
 $L = 71.02'$
 $T = 43.00'$
 $R = 50.00'$

STA. 12+50.00 -L- BEGIN TIP PROJECT B-3664

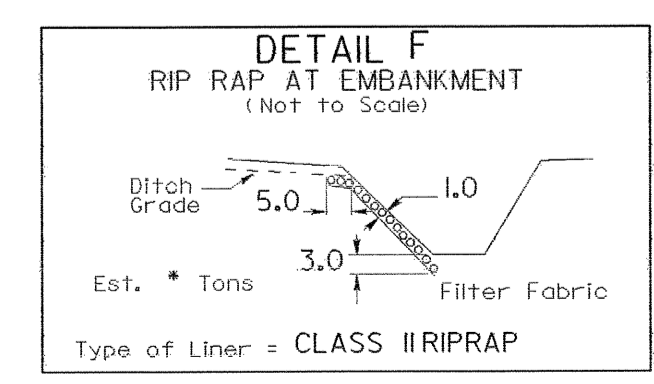
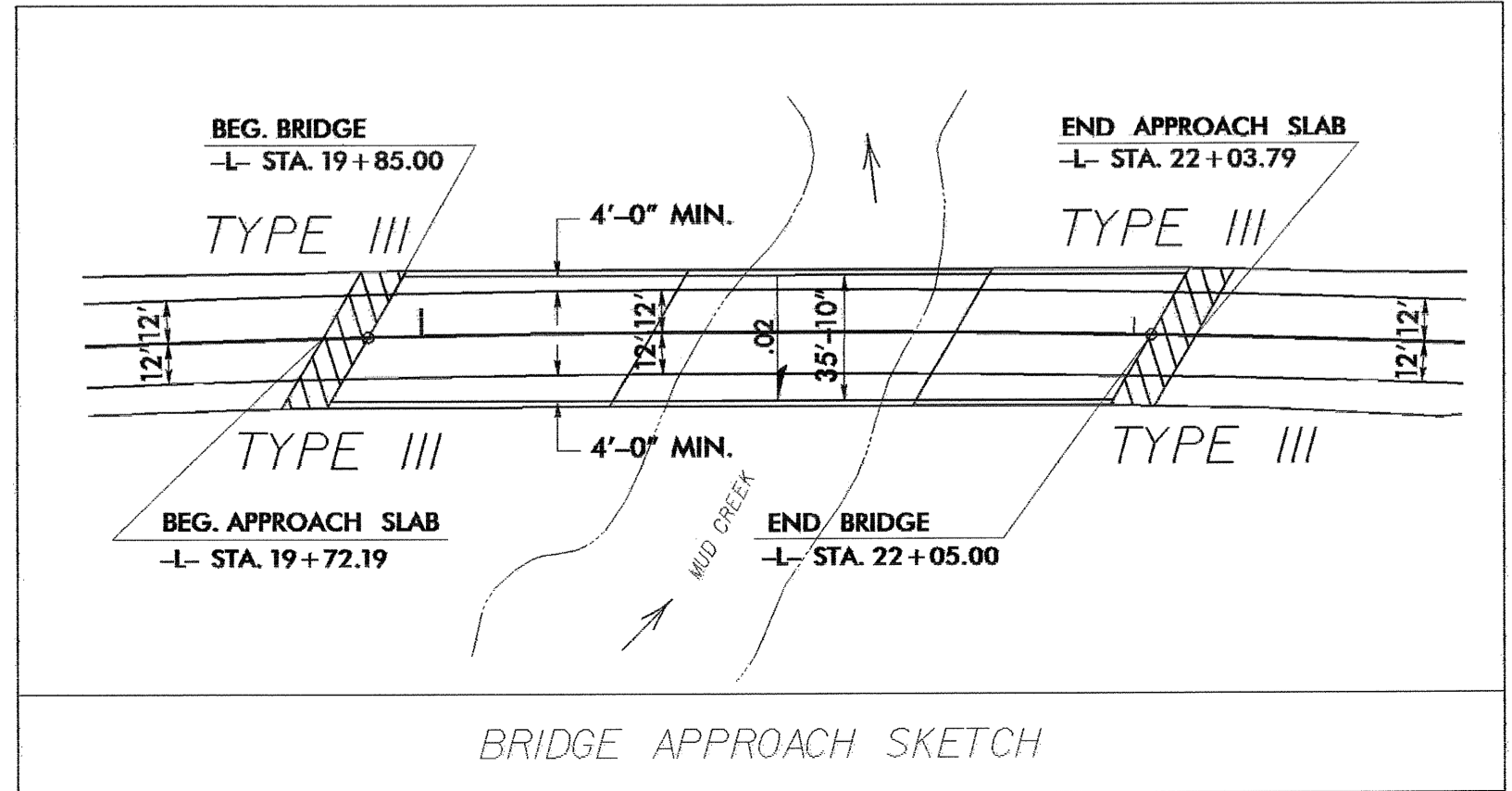
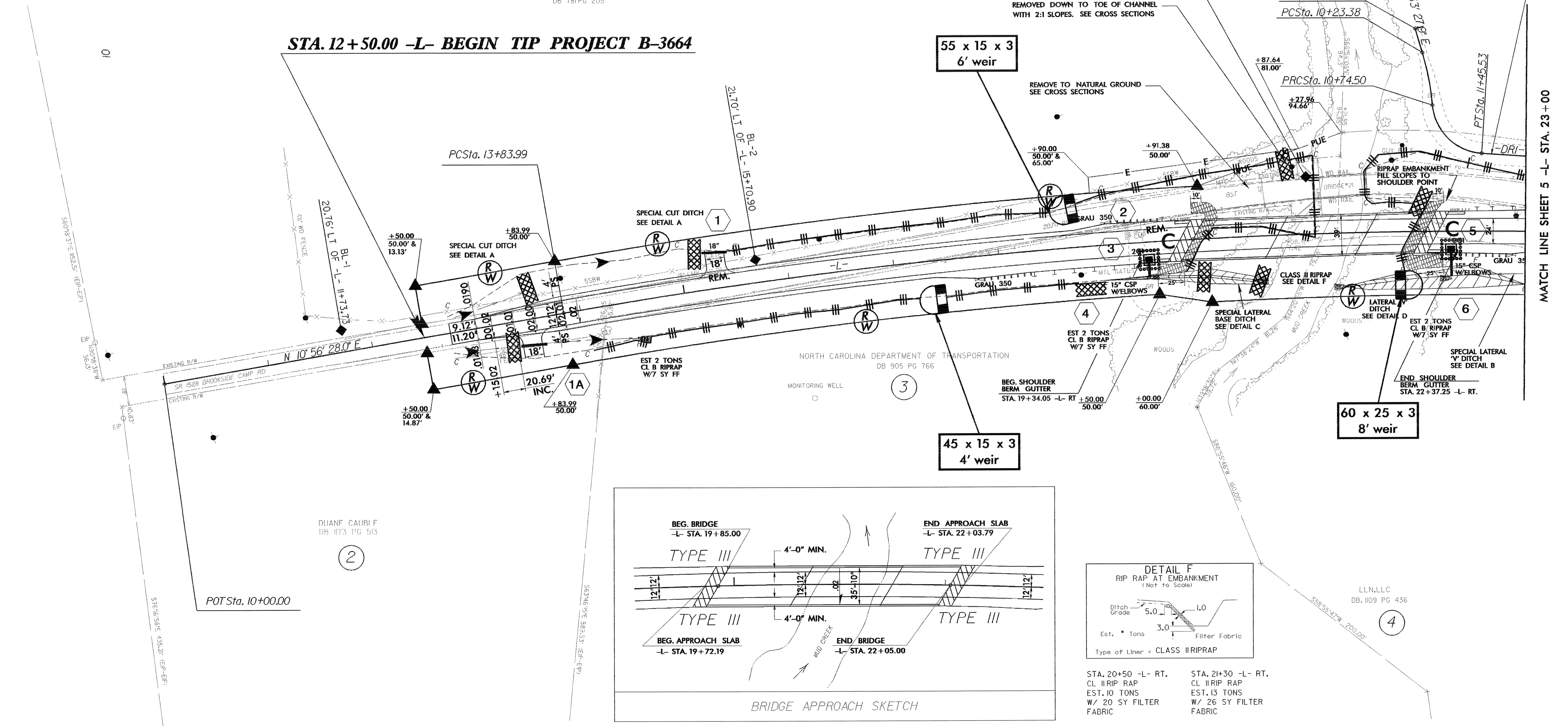

STA. 21+30 -L- RT.
 CL II RIP RAP
 EST. 13 TONS
 W/ 26 SY FILTER FABRIC

ROBERT F. DINI AP
 LOUISE E. DUNLAP
 DB 781 PG 205

NORTH CAROLINA DEPARTMENT OF TRANSPORTATION
 DB 905 PG 766

McBUZ INVESTMENTS, LLC
 DB. 1047 PG 321

LLN, LLC
 DB. 1109 PG 436

MATCH LINE SHEET 5 -L- STA. 23+00