

CONTRACT: C201256 TIP PROJECT: B-3839

STRUCTURE

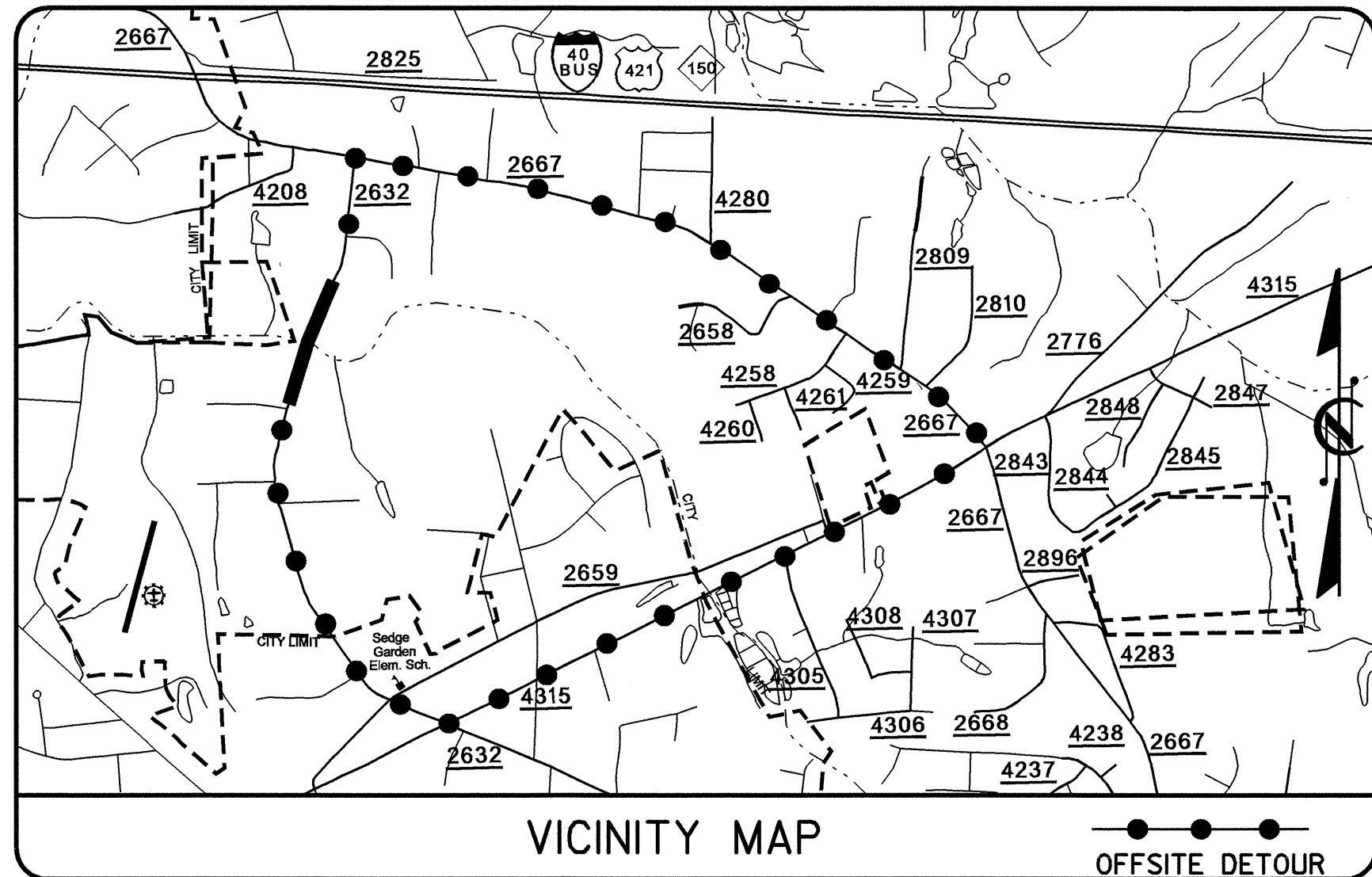

VICINITY MAP

OFFSITE DETOUR

STATE OF NORTH CAROLINA
DIVISION OF HIGHWAYS

FORSYTH COUNTY

LOCATION: BRIDGE NO. 139 OVER FISHERS BRANCH ON
SR 2632 (SEDE GARDEN RD)

TYPE OF WORK: GRADING, DRAINAGE, PAVING, AND STRUCTURE

STATE	STATE PROJECT REFERENCE NO.	SHEET NO.	TOTAL SHEETS
N.C.	B-3839		
STATE PROJ. NO.	F.A. PROJ. NO.	DESCRIPTION	
33287.1.1	BRZ-2632(2)	PE	
33287.2.1	BRZ-2632(2)	R/W	
33287.3.1	BRZ-2632(2)	UTIL./CONST.	

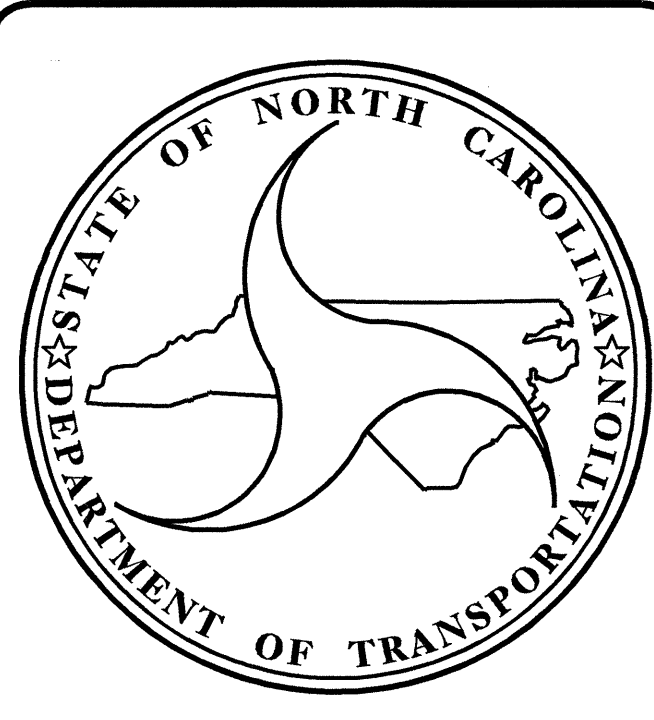
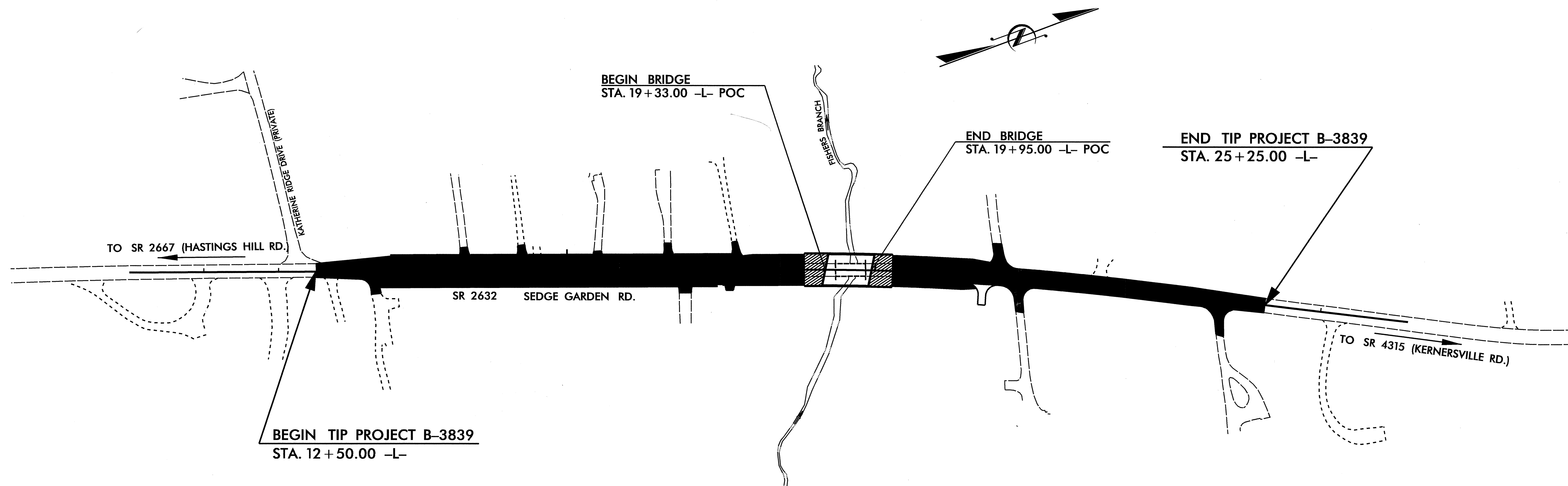

DESIGN DATA

ADT 2005 = 1,900
ADT 2025 = 2,800
DHV = 11 %
D = 60 %
T = 3 % *
V = 50 MPH
* (TTST 1 % + DUAL 2 %)

DESIGN EXCEPTION REQ'D FOR VERTICAL CURVATURE AND VERTICAL STOPPING SIGHT DISTANCE.

PROJECT LENGTH

LENGTH ROADWAY OF TIP PROJECT B-3839 = 0.229 MI
LENGTH STRUCTURE OF TIP PROJECT B-3839 = 0.012 MI
TOTAL LENGTH OF TIP PROJECT B-3839 = 0.241 MI

Prepared In the Office of:

DIVISION OF HIGHWAYS

2002 STANDARD SPECIFICATIONS

LETTING DATE :
JULY 19, 2005

Q.H. NGUYEN, P.E.
PROJECT ENGINEER

MARC G. CHEEK, P.E.
PROJECT DESIGN ENGINEER

STRUCTURE DESIGN UNIT
1000 BIRCH RIDGE DR.
RALEIGH, N.C. 27610

6-7-05

DIVISION OF HIGHWAYS
STATE OF NORTH CAROLINA

P.E.

STATE DESIGN ENGINEER

DEPARTMENT OF TRANSPORTATION
FEDERAL HIGHWAY ADMINISTRATION

APPROVED
DIVISION ADMINISTRATOR

DATE