

PROJECT REFERENCE NO.	SHEET NO.
B-3839	EC-4/CONST.4
RW SHEET NO.	
ROADWAY DESIGN ENGINEER	HYDRAULICS ENGINEER

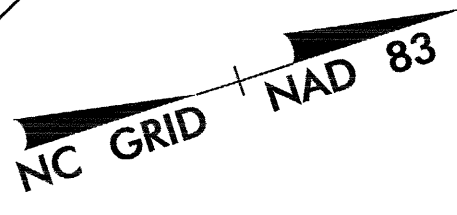

NOTE: ALL DRIVES HAVE 15' RADII UNLESS OTHERWISE LABELED

NOTE: UTILIZE TEMPORARY ROCK SEDIMENT DAM TYPE - B AS STILLING BASIN WHERE APPLICABLE.

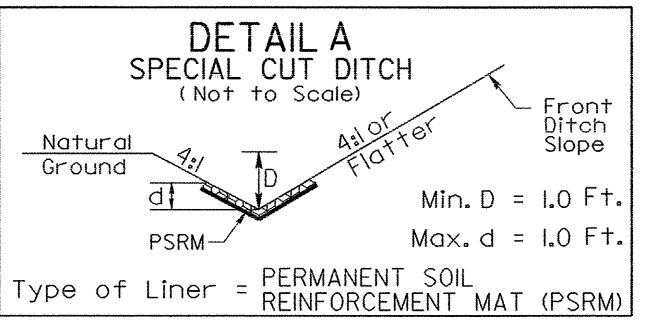

- L- STA. 18+30 TO 19+30, LT: PSRM: EST. 126 SY
- L- STA. 18+50 TO 19+13, RT: PSRM: EST. 86 SY
- L- STA. 20+07 TO 21+00, LT: PSRM: EST. 114 SY
- L- STA. 19+88 TO 21+00, RT: PSRM: EST. 132 SY

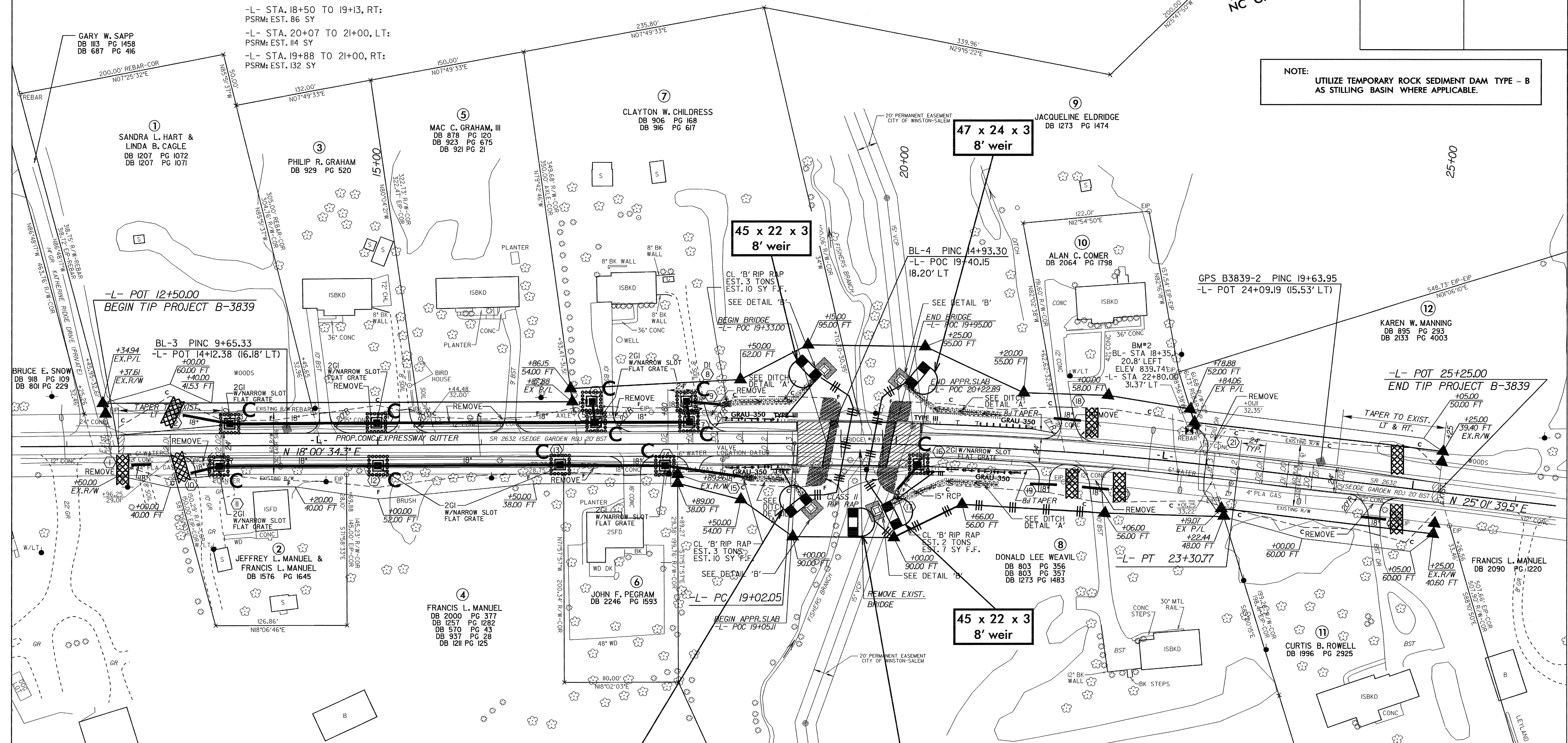

DATUM DESCRIPTION
 THE LOCALIZED COORDINATE SYSTEM DEVELOPED FOR THIS PROJECT IS BASED ON THE STATE PLANE COORDINATES ESTABLISHED BY NCDOT FOR MONUMENT "B3839-1" WITH NAD 83 STATE PLANE GRID COORDINATES OF NORTHING: 858245.016(11) EASTING: 1663411.152(11) THE AVERAGE COMBINED GRID FACTOR USED ON THIS PROJECT (GROUND TO GRID) IS: 0.9999447 THE N.C. LAMBERT GRID BEARING AND LOCALIZED HORIZONTAL GROUND DISTANCE FROM "B3839-1" TO -L- STATION 12+50.00 IS N 21° 34' 31.9" E 30353 FT ALL LINEAR DIMENSIONS ARE LOCALIZED HORIZONTAL DISTANCES VERTICAL DATUM USED IS NGVD 29

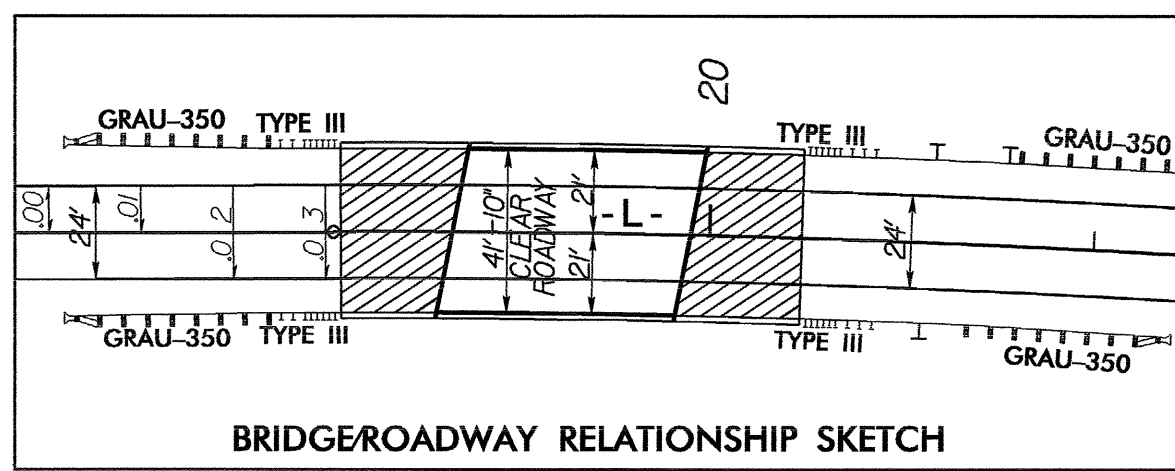

-L- Curve * 1
 PI Sta 21+16.68
 $\Delta = 7^\circ 0' 05.1''$ (RT)
 $D = 138' 13.3''$
 $L = 428.71'$
 $T = 214.62'$
 $R = 3500.00'$
 $e = 0.03$
 $V_d = 50$ mph

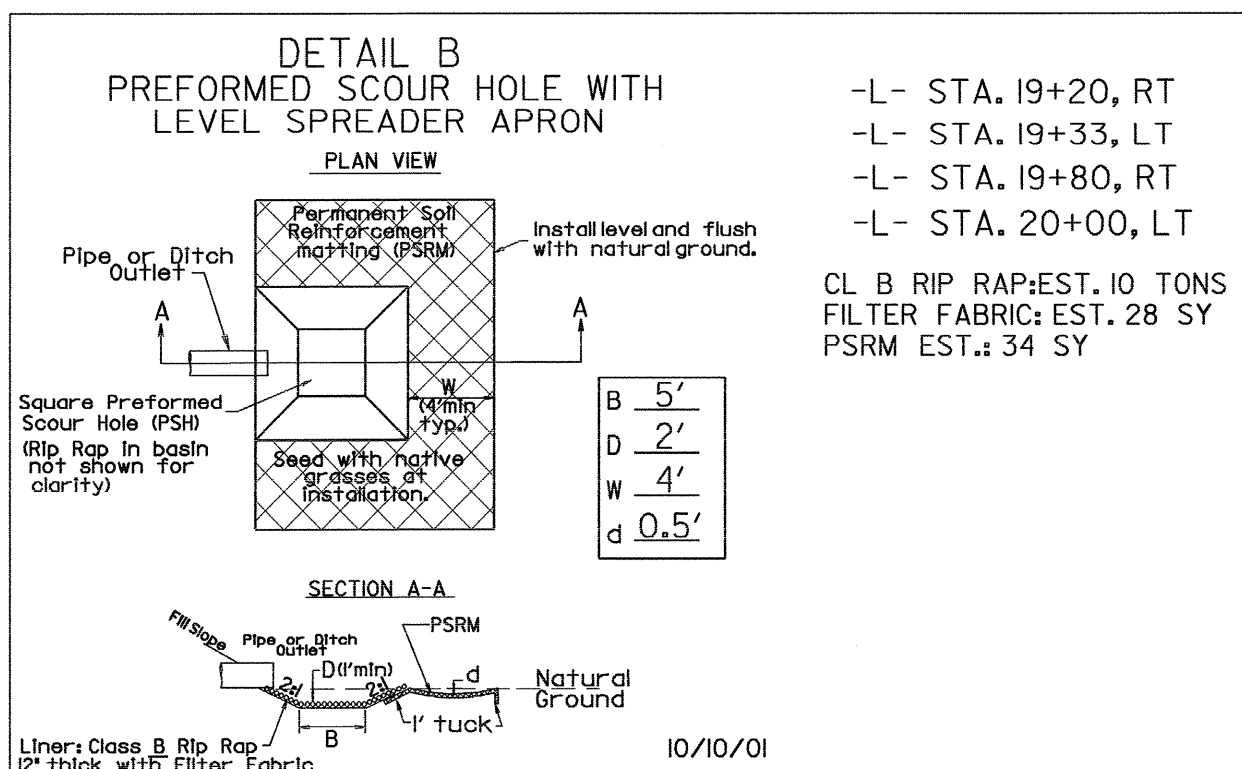

SEE SHEET 5 FOR LINE -L- PROFILE AND GRADE