

PLAN - END BENT 1 WITH SWEEP BACK WINGS - SKEWED  
(2:1 SLOPE)

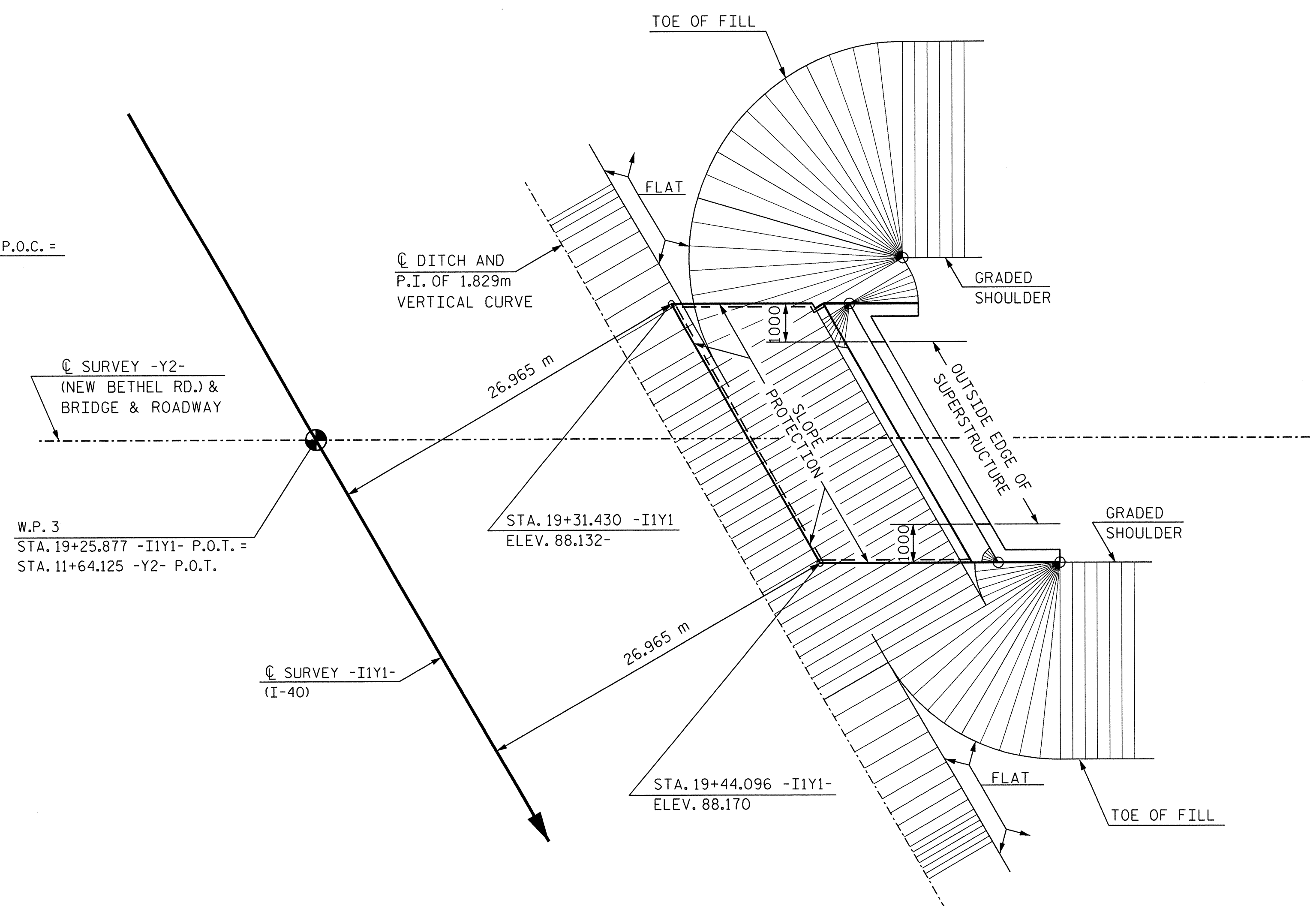

PLAN - END BENT 2 WITH SWEEP BACK WINGS - SKEWED  
(2:1 SLOPE)

G:\COMNUS\304046\BRIDGE\STEINDGN\FINAL\ R-2552AA.SD.SP2.01.DGN

PROJECT NO. R-2552AA  
WAKE / JOHNSTON COUNTY  
 STATION: 19+25.877 -I1Y1- P.O.T.

SHEET 2 OF 2

ASSEMBLED BY :	F.D. WEEDEN	DATE :	01/05
CHECKED BY :	R.D. FAUTEUX	DATE :	01/05
DRAWN BY :	ELR	5/92	REV. 10/17/00 RWW/LES
CHECKED BY :	GRP	6/92	REV. 7/10/01 LES/RDR
			REV. 5/1/03 RWW/JTE

**R&K**  
**RUMMELKLEPPER & KAHL, LLP**  
 consulting engineers  
 5800 FARINGDON PLACE - SUITE 105  
 RALEIGH, NORTH CAROLINA 27609-3960

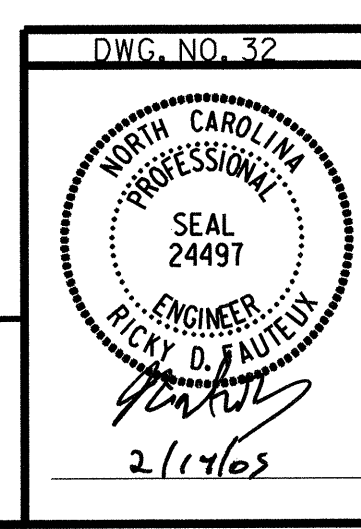

STATE OF NORTH CAROLINA DEPARTMENT OF TRANSPORTATION RALEIGH					
STANDARD SLOPE PROTECTION DETAILS					
JANUARY					2005
REVISIONS					
NO.	BY:	DATE:	NO.	BY:	DATE:
1			3		
2			4		
					SHEET NO. 5-32 TOTAL SHEETS 429