

SECTION A-A

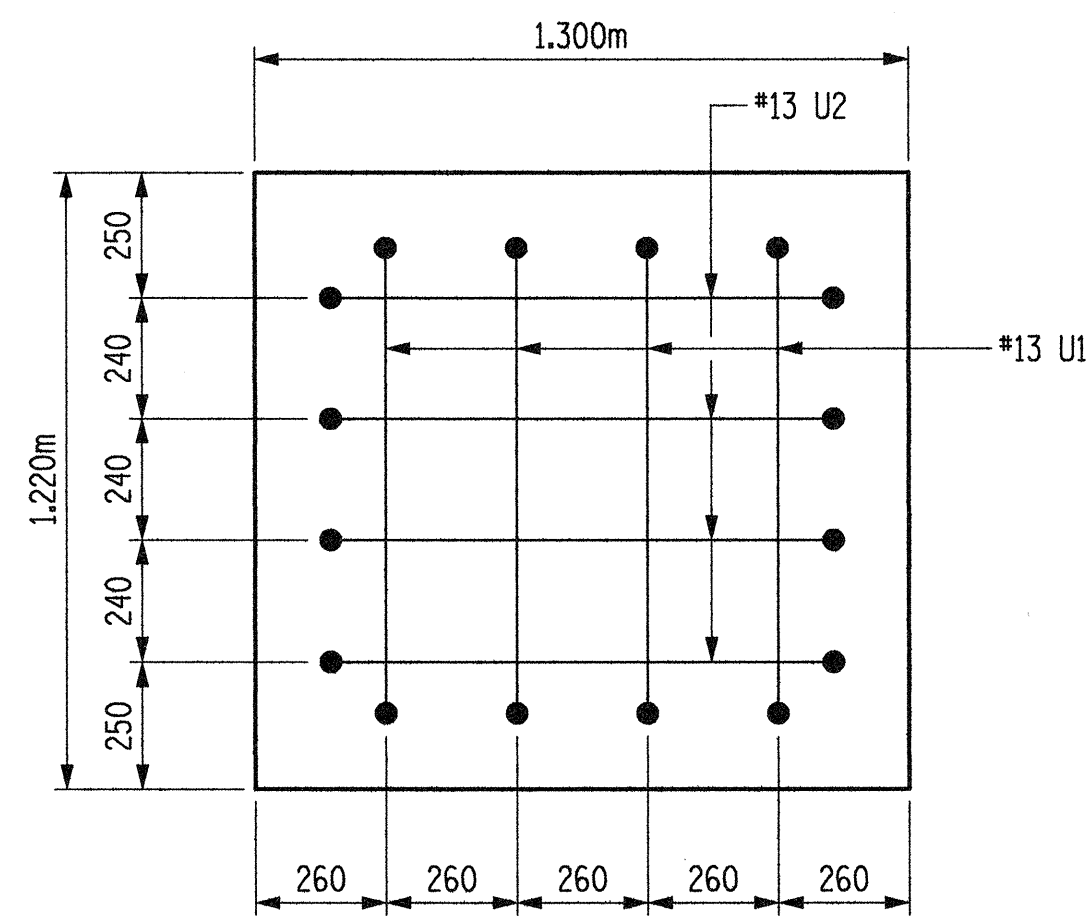

VIEW B-B

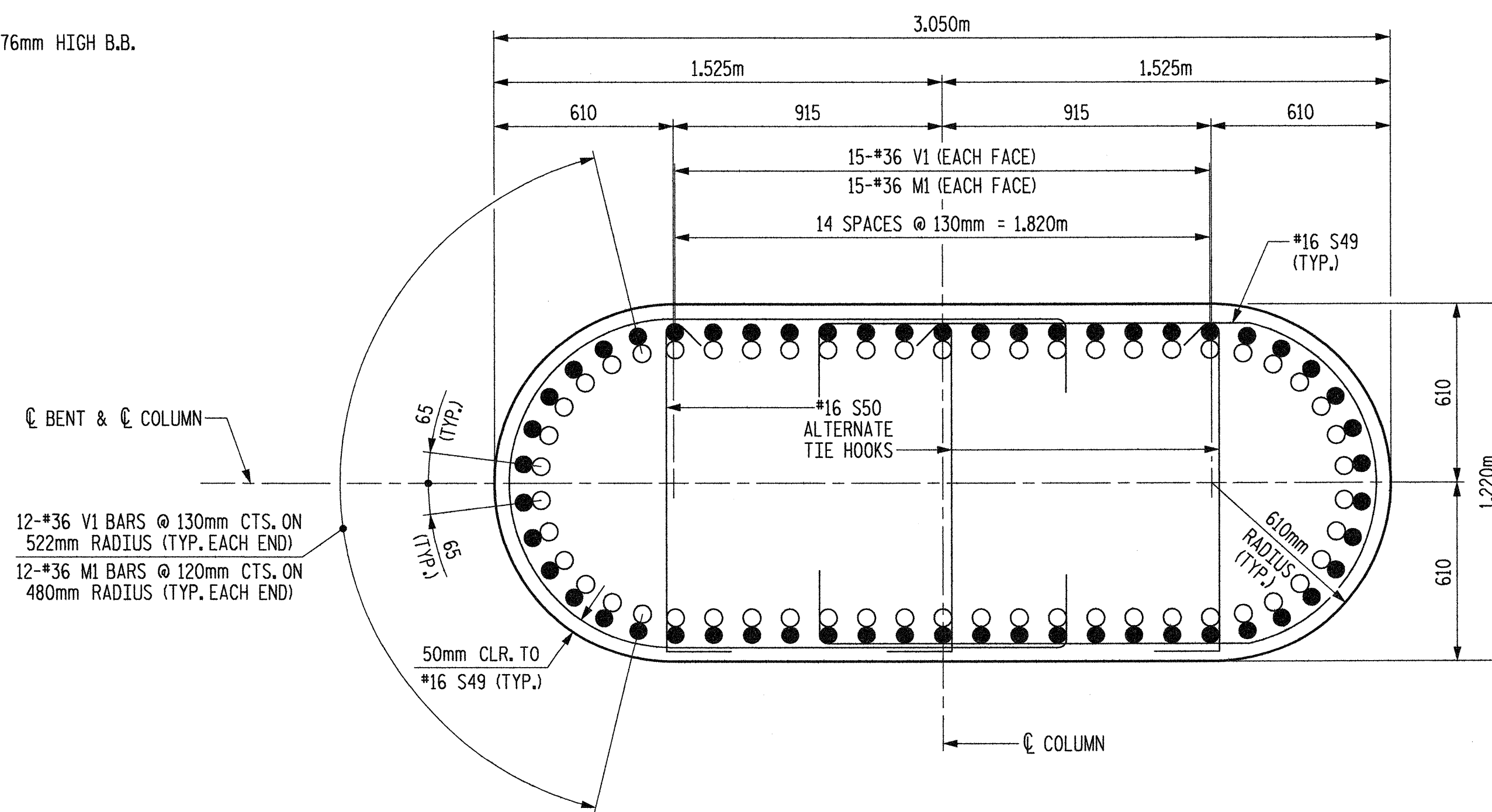

SECTION C-C

○ #36 M1  
● #36 V1

12-#36 V1 BARS @ 130mm CTS. ON 522mm RADIUS (TYP. EACH END)  
12-#36 M1 BARS @ 120mm CTS. ON 480mm RADIUS (TYP. EACH END)

PROJECT NO. R-2552AA  
WAKE-JOHNSTON COUNTY  
STATION: 27+51.601 -I1Y1-

SHEET 2 OF 3

STATE OF NORTH CAROLINA  
DEPARTMENT OF TRANSPORTATION  
RALEIGH

SUBSTRUCTURE  
BENT #3

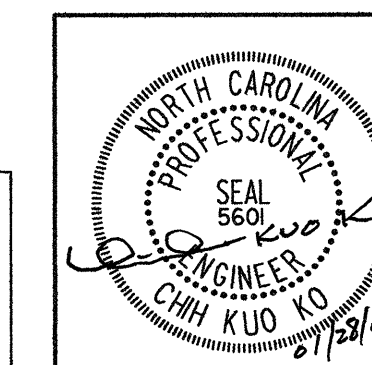
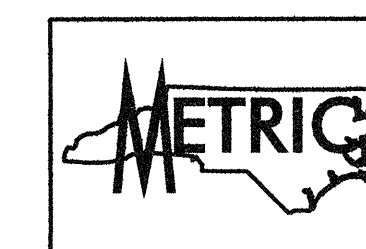

Plans prepared by:  
**KO & ASSOCIATES, P.C.**  
Consulting Engineers  
1011 SCHAUB DR. SUITE #202  
RALEIGH, N.C. 27606  
For Division of Highways

REVISIONS						SHEET NO.
NO.	BY:	DATE:	NO.	BY:	DATE:	TOTAL SHEETS
1			3			429
2			4			429

DWG. NO. 38

PLOT: 01/28/2005 07:55:26 AM Ko & Associates, P.C.  
 FILE NAME: r:\2552aa.dwg

DRAWN BY: B.E. LANNING DATE: JAN. 2005  
CHECKED BY: J.C. KO / A.K. ORR DATE: JAN. 2005