

PLAN OF LEFT WING - W1

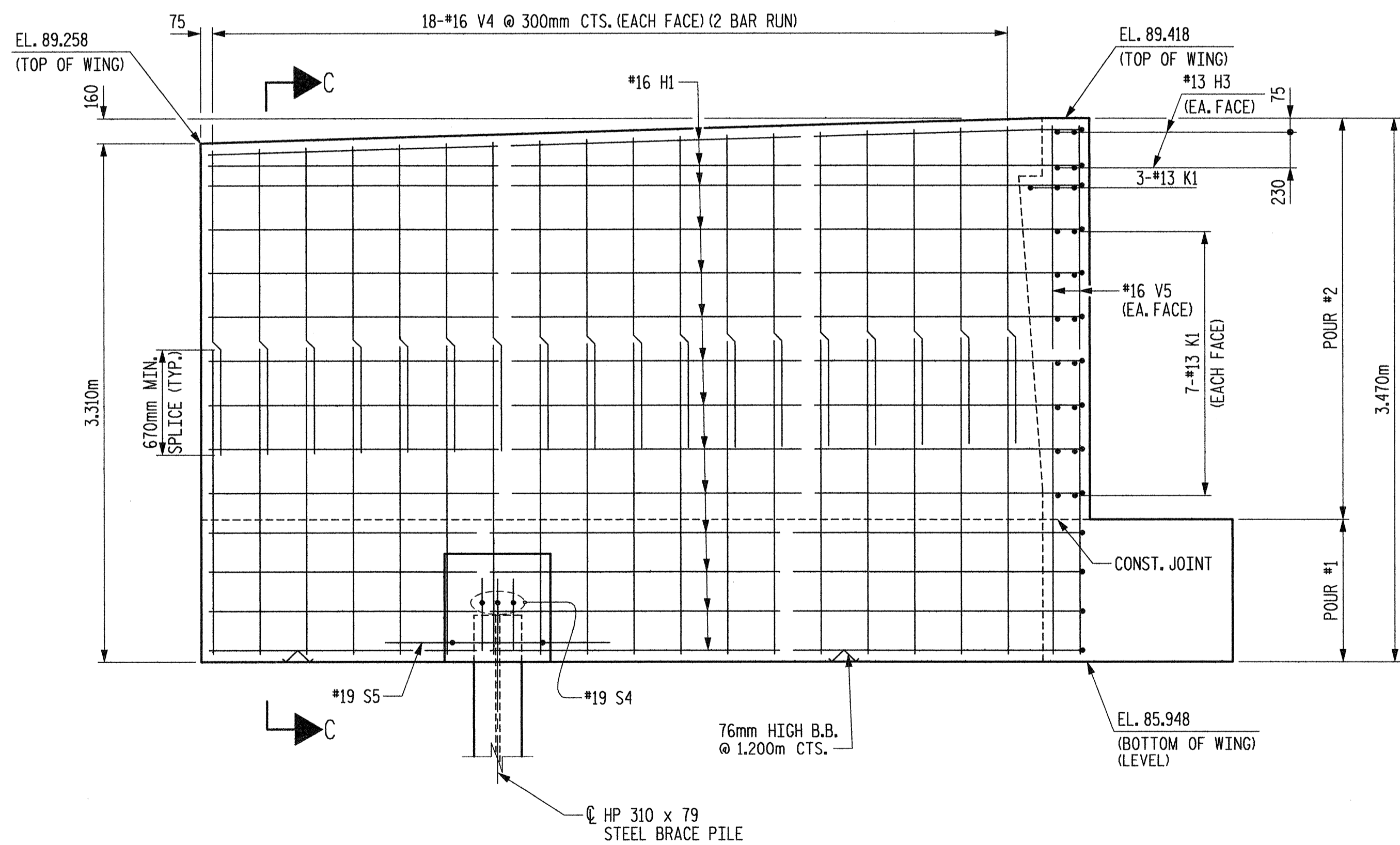

VIEW A-A

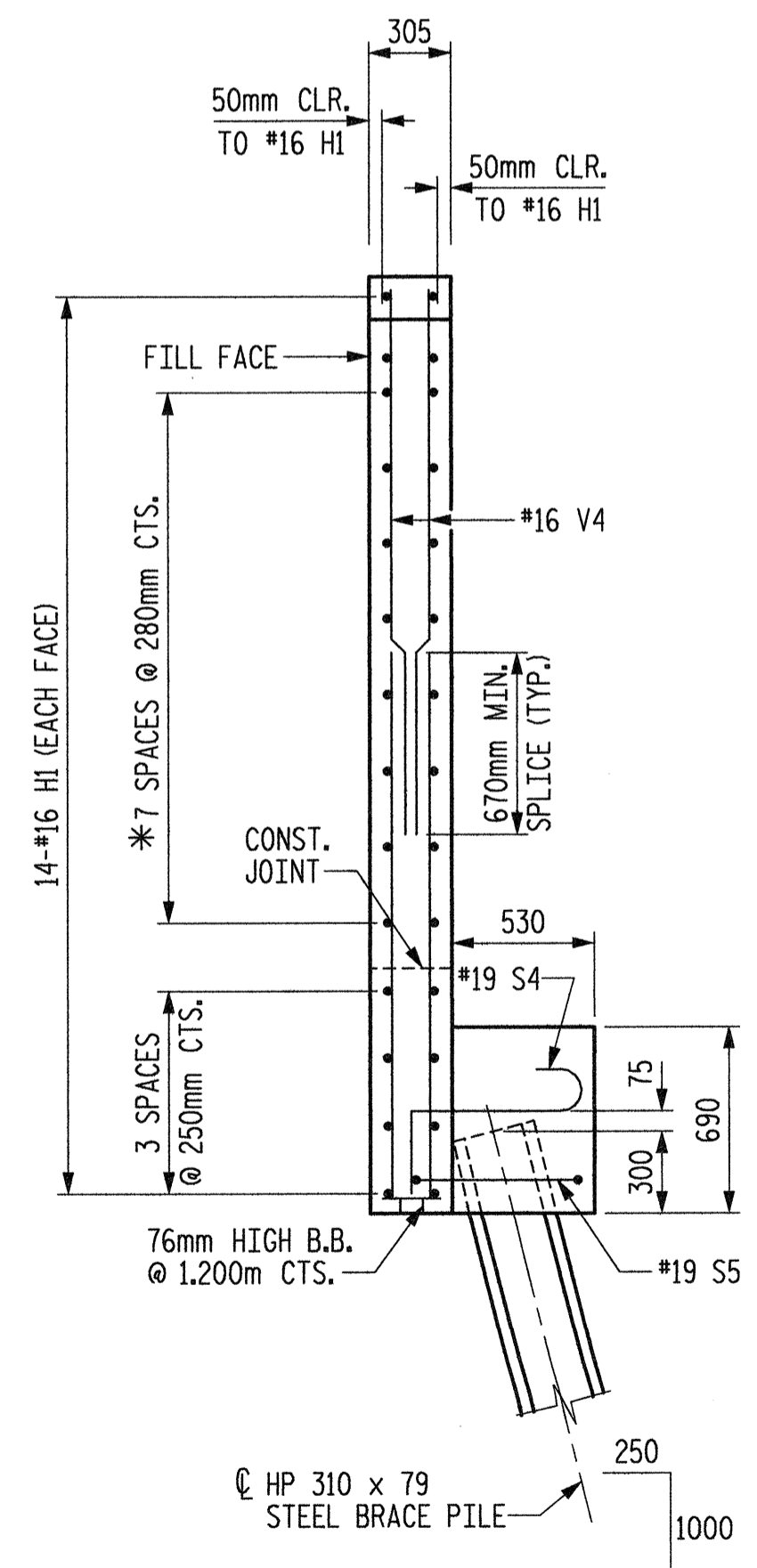

SECTION C-C

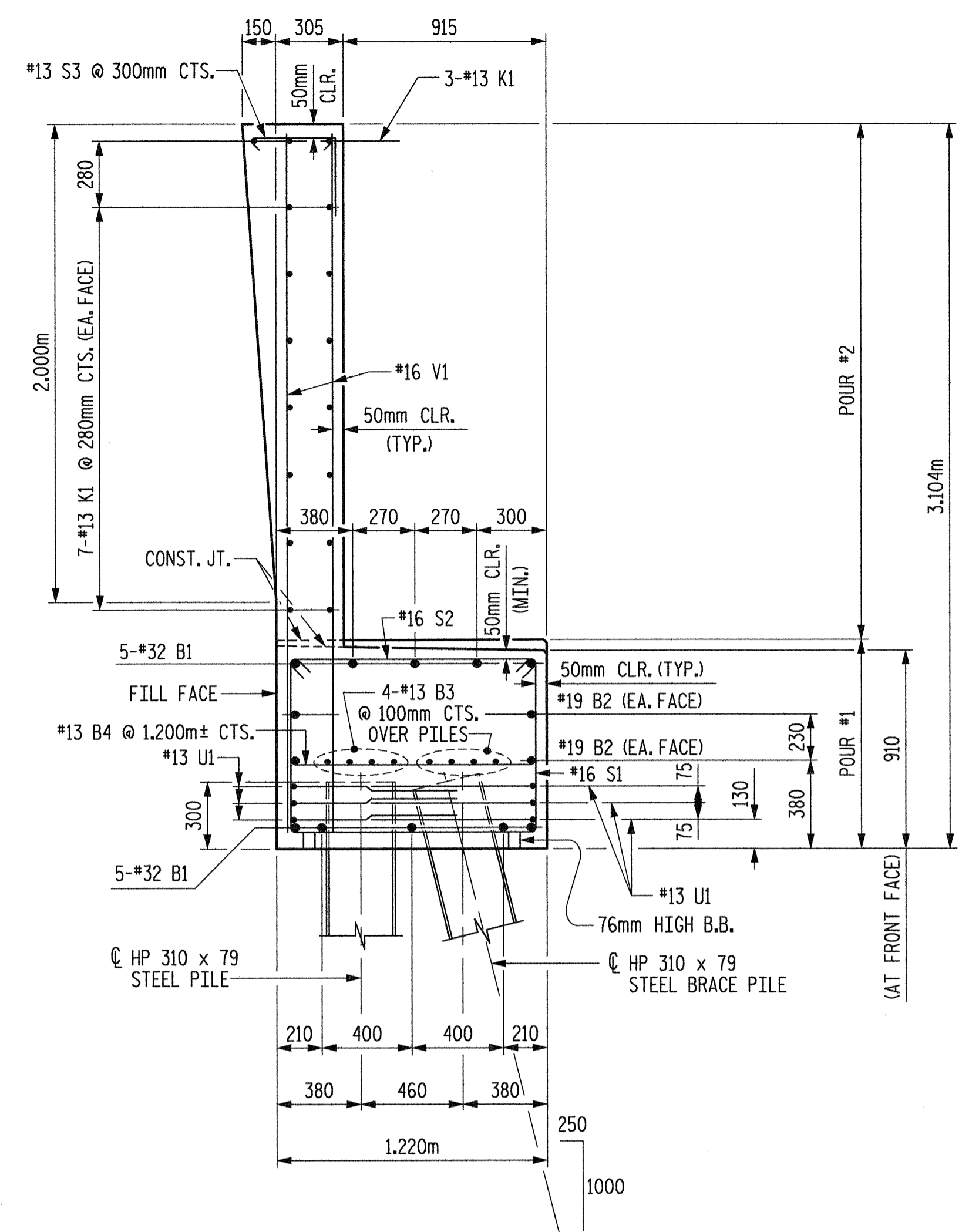

SECTION A-A

\* NOTE: MATCH "H" BARS IN THE WING TO THE #13 K1 BARS IN THE BACKWALL. "K" BARS SHOULD EXTEND FROM WING TO WING.

PROJECT NO. R-2552AA  
 WAKE-JOHNSTON COUNTY  
 STATION: 28+31.359 -I1Y1-

SHEET 2 OF 3  
 STATE OF NORTH CAROLINA  
 DEPARTMENT OF TRANSPORTATION  
 RALEIGH  
 SUBSTRUCTURE  
 END BENT #2

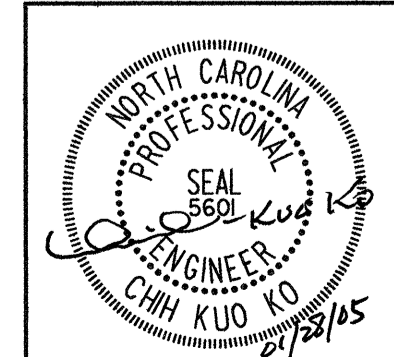
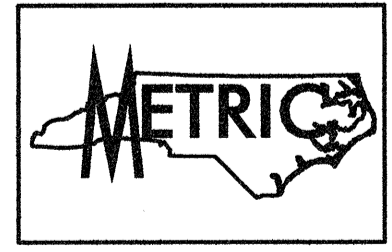

Plans prepared by:  
**KO & ASSOCIATES, P.C.**  
 Consulting Engineers  
 1011 SCHAUER DR., SUITE #202  
 RALEIGH, N.C. 27606  
 For Division of Highways

| REVISIONS |     |       |     |     |       | SHEET NO.         |
|-----------|-----|-------|-----|-----|-------|-------------------|
| NO.       | BY: | DATE: | NO. | BY: | DATE: |                   |
| 1         |     |       | 3   |     |       | 5-133             |
| 2         |     |       | 4   |     |       | TOTAL SHEETS 4129 |

DWG. NO. 50

PLOT: 01/27/2005 8:41:45 PM Ko & Associates, P.C.  
 FILE NAME: r1\2552aa\_s.dwg

DRAWN BY: B.E. LANNING DATE: JAN. 2005  
 CHECKED BY: J.C. KO / A.K. ORR DATE: JAN. 2005