

INDICATES POUR SEQUENCE AND DIRECTION

* EPOXY COATED REINFORCING STEEL

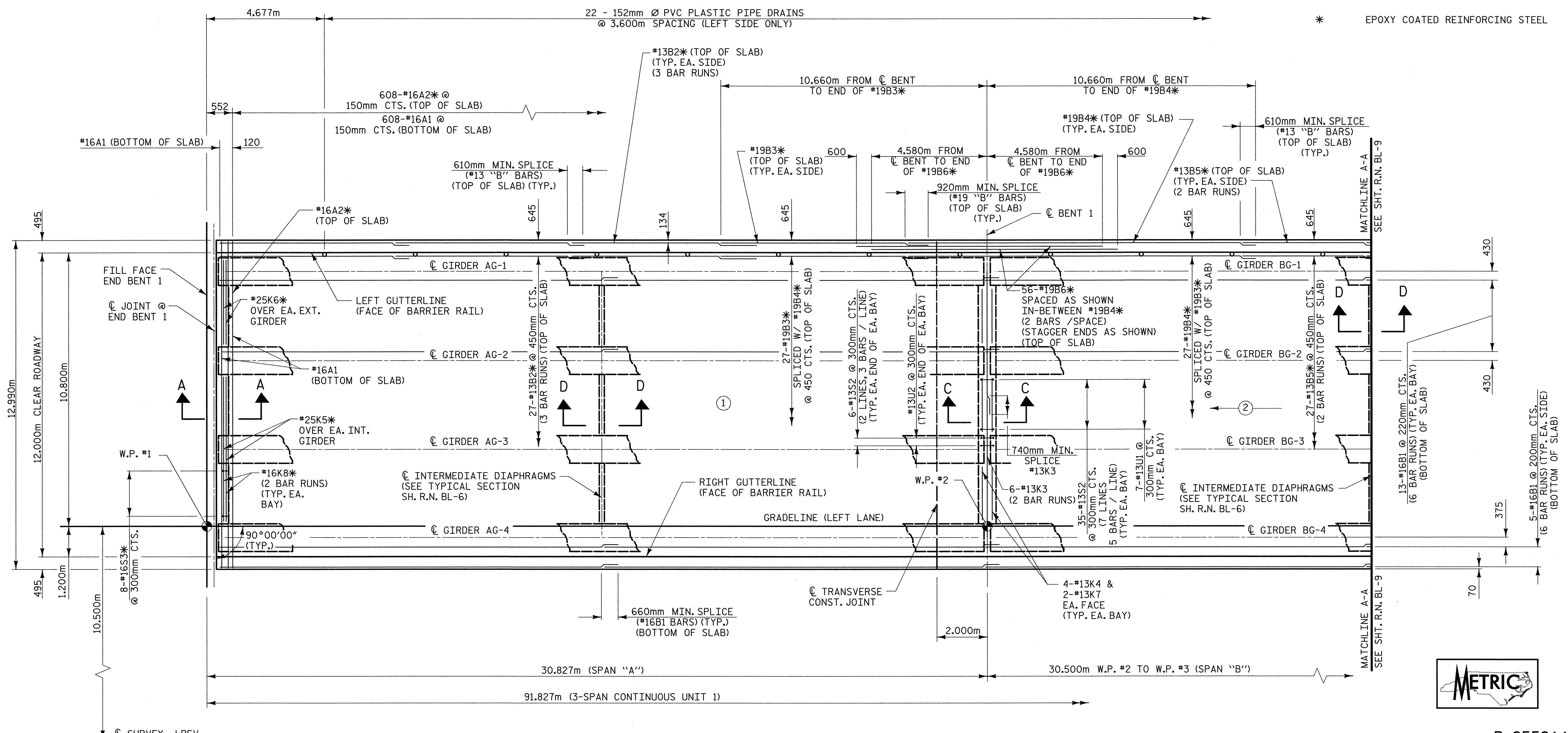

PLAN - UNIT 1

PROJECT NO. R-252AA
 WAKE - JOHNSTON COUNTY
 STATION: 14+38.000 -LREV- POT



STATE OF NORTH CAROLINA
 DEPARTMENT OF TRANSPORTATION
 RALEIGH

SUPERSTRUCTURE
 SPANS A-B
 (LEFT LANE)

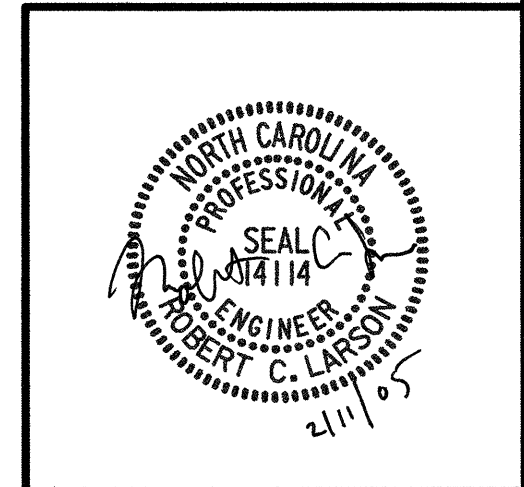

PLANS PREPARED BY:
MULKEY
 ENGINEERS & CONSULTANTS
 P.O. Box 33127
 RALEIGH, NC 27636
 (919) 851-1918 (FAX)
 WWW.MULKEYINC.COM

REVISIONS				SHEET NO.	
NO.	BY:	DATE:	NO.	BY:	DATE:
1			3		
2			4		

REFERENCE NO. BL-8

DRAWN BY: J. P. SHERMAN DATE: 6/04
 CHECKED BY: R. C. LARSON DATE: 8/04

02/04/2005 02:48:32 PM G:\p\proj\2004\213\016\2552\Structures\Site 4\Left Lane\R252AA.SD.SI.0.dgn