

AT END BENT 1

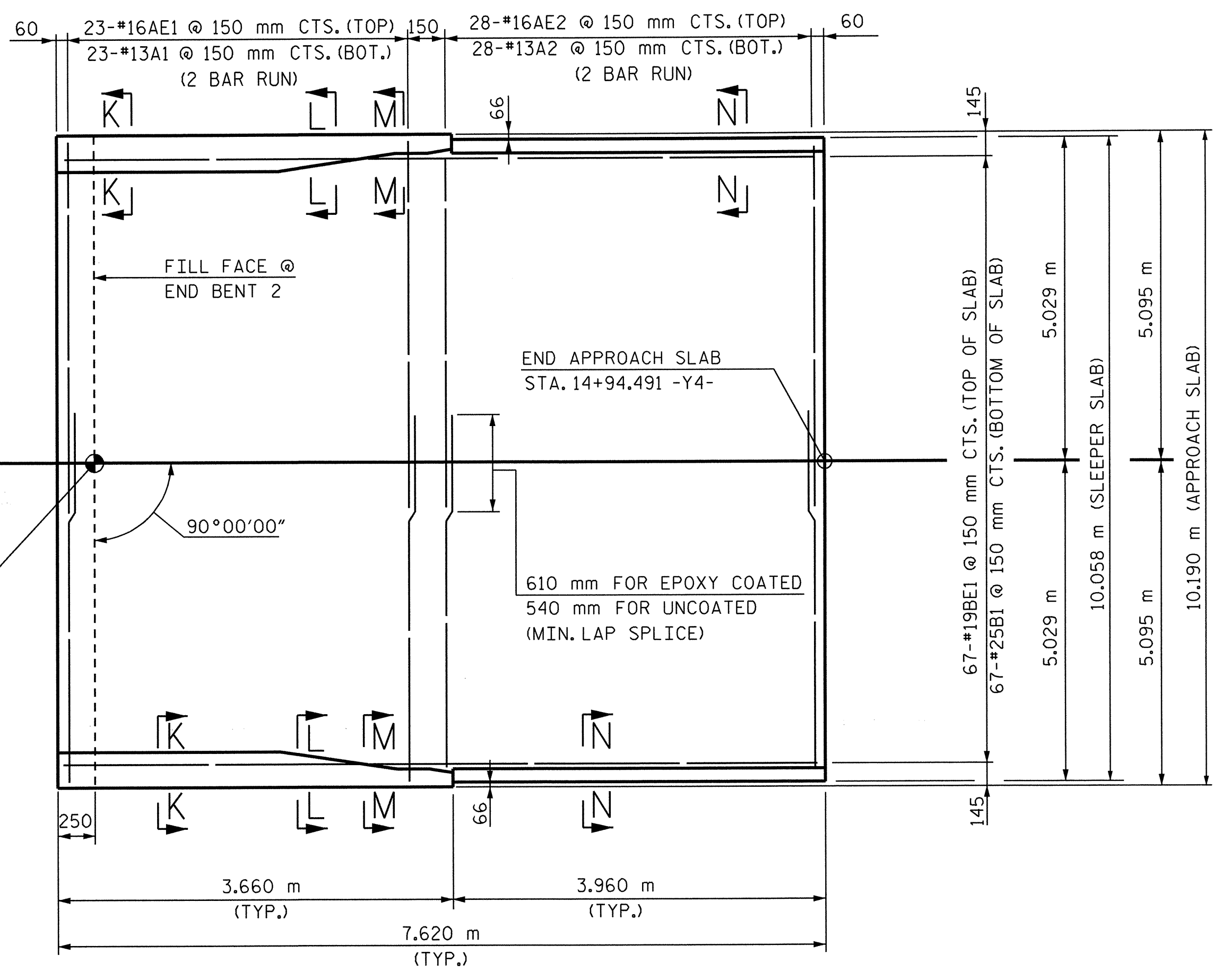

AT END BENT 2

PLAN OF APPROACH SLABS

NOTES:
 SEE SHEET 2 OF 4 FOR BARRIER RAIL DETAILS.
 SEE SHEET 3 OF 4 FOR NOTES AND BILL OF MATERIALS.
 SEE SHEET 4 OF 4 FOR SLEEPER SLAB DETAILS.

SEE EVAZOTE JOINT SEAL DETAILS ON "BRIDGE APPROACH SLAB DETAILS" SHEET, SHEET 3 OF 4.

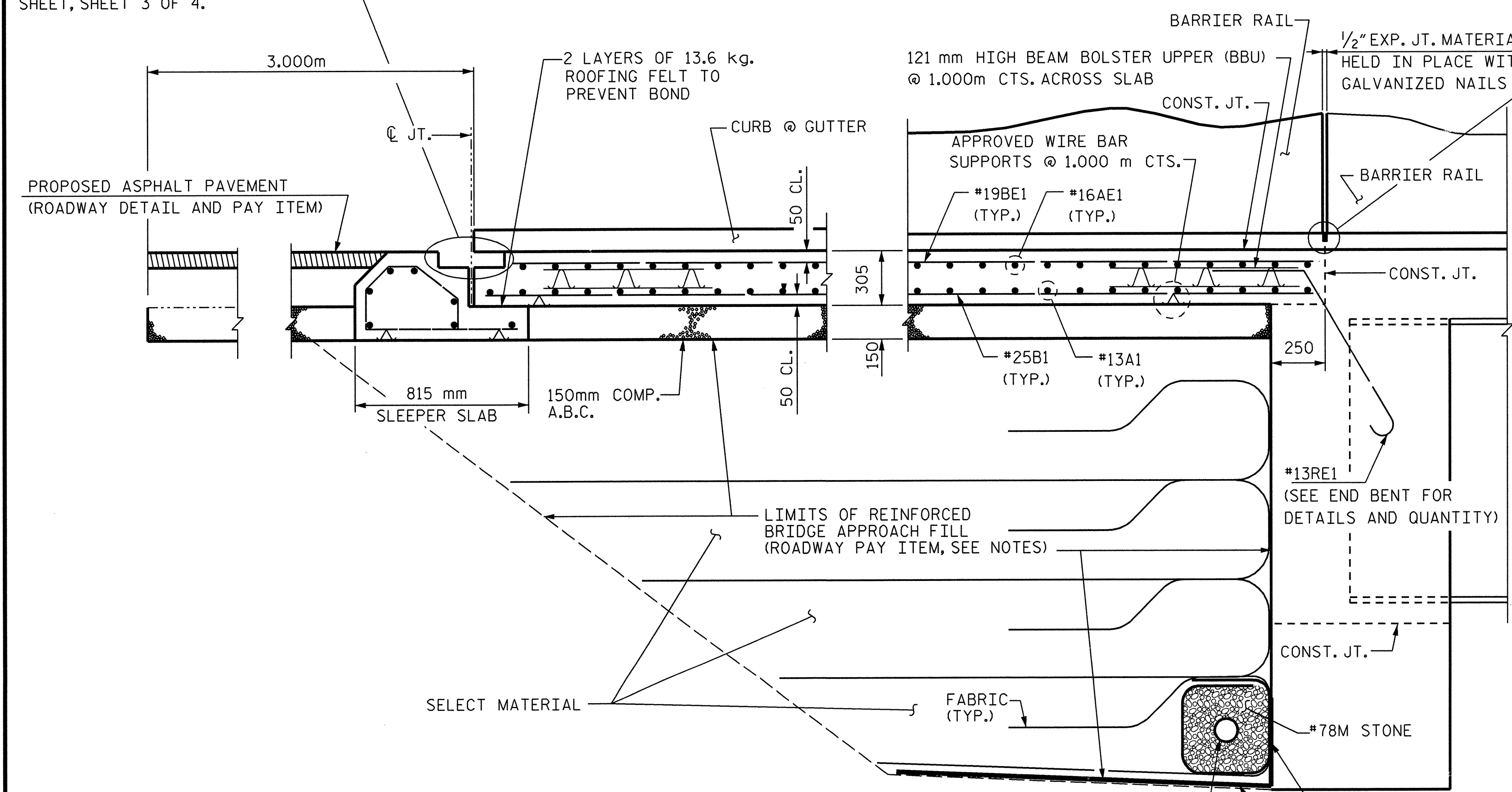

SECTION THRU SLAB

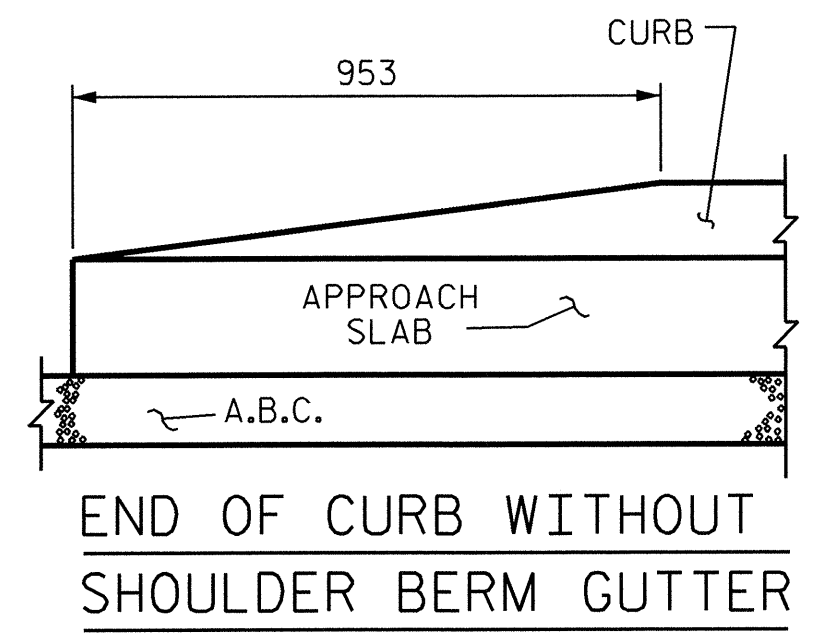
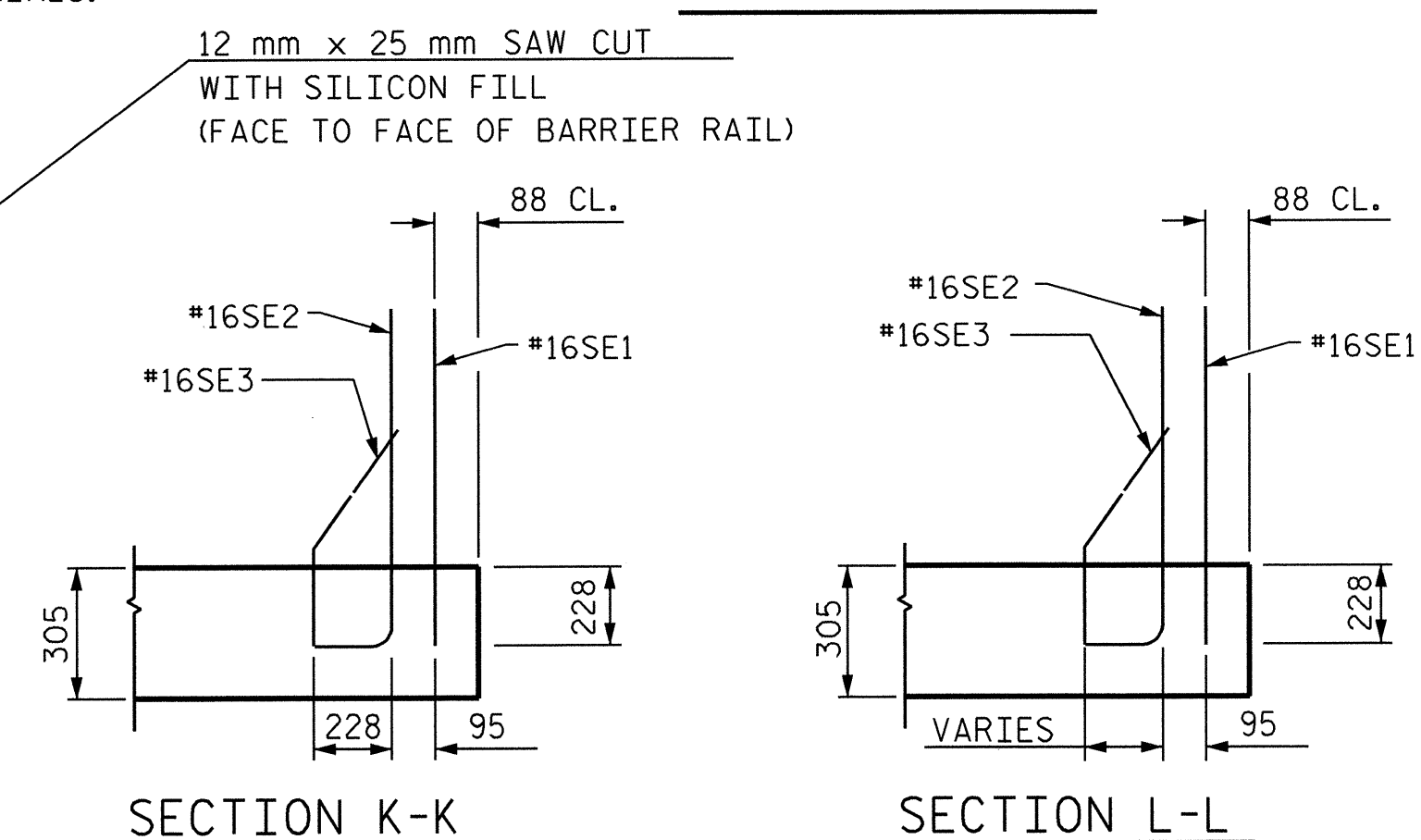

END OF CURB WITHOUT SHOULDER BERM GUTTER

PROJECT NO. R-2552AA
 WAKE / JOHNSTON COUNTY
 STATION: 27+61.028 -L- P.O.T.

SHEET 1 OF 4

STATE OF NORTH CAROLINA DEPARTMENT OF TRANSPORTATION RALEIGH		STANDARD BRIDGE APPROACH SLAB FOR RIGID PAVEMENT WITH BARRIER RAIL		JANUARY 2005																							
<table border="1"> <thead> <tr> <th colspan="2">NO.</th> <th colspan="2">BY:</th> <th colspan="2">DATE:</th> </tr> </thead> <tbody> <tr> <td>1</td> <td></td> <td></td> <td></td> <td></td> <td></td> </tr> <tr> <td>2</td> <td></td> <td></td> <td></td> <td></td> <td></td> </tr> </tbody> </table>						NO.		BY:		DATE:		1						2									
NO.		BY:		DATE:																							
1																											
2																											
<table border="1"> <thead> <tr> <th colspan="2">NO.</th> <th colspan="2">BY:</th> <th colspan="2">DATE:</th> </tr> </thead> <tbody> <tr> <td>3</td> <td></td> <td></td> <td></td> <td></td> <td></td> </tr> <tr> <td>4</td> <td></td> <td></td> <td></td> <td></td> <td></td> </tr> </tbody> </table>				NO.		BY:		DATE:		3						4						<table border="1"> <thead> <tr> <th colspan="2">SHEET NO.</th> </tr> </thead> <tbody> <tr> <td>S-254</td> <td>TOTAL SHEETS 429</td> </tr> </tbody> </table>		SHEET NO.		S-254	TOTAL SHEETS 429
NO.		BY:		DATE:																							
3																											
4																											
SHEET NO.																											
S-254	TOTAL SHEETS 429																										

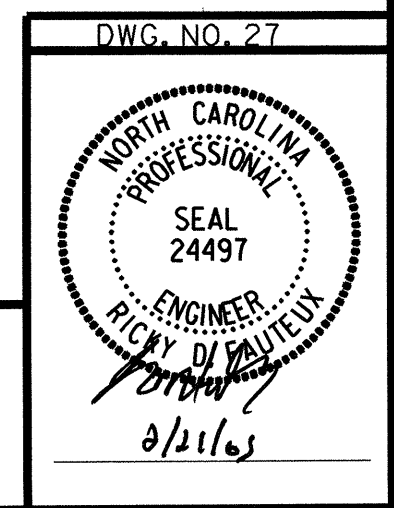

RUMMELKLEPPER & KAHL, LLP
 consulting engineers
 5800 FARINGTON PLACE - SUITE 105
 RALEIGH, NORTH CAROLINA 27609-3960

G:\COMMONS\302046\BRIDGE\SITE5\DCN\FINAL\ R-2552AA_SD_ASI_05.DGN

ASSEMBLED BY :	F.D. WEEDEN	DATE :	01/05
CHECKED BY :	R.D. FAUTEUX	DATE :	01/05
DRAWN BY :	RWW	8/01	ADDED 12/01
CHECKED BY :	LES	8/01	REV. 5/7/03 RWW/JTE