

CONTRACT: C201226 ID: R-2552AA

**CONTENTS**

LINE	STATION	PLAN	PROFILE	XSECTS
-IYI-	10+40 - 41+60	4-7,14A,15,16	-	34-48
-FLYLEREV-	10+00 - 35+14	5-9	17-20	49-69
-FLYLWREV-	10+00 - 26+77	6-9	21,22	49-60,70-71
-LPB-	10+00 - 24+01	7,8	23,24	55-67,72
-RPD-	10+00 - 17+60	8,14	25	54-57, 73-75
-LREV-	11+04 - 18+99	9,10	26	76-82
-L-	18+99 - 28+00	10-14	27,28	83-90
-YREV-	10+03 - 17+75	6,6A,6B	28,29	-
-Y2B	10+00 - 19+28	10-12	30,31	91
-Y4	12+50 - 15+95	12	32	92-95
-Y4DET-	10+40 - 13+78	12	32	92-95
-SRD-1-	10+00 - 12+68	9C	33	96-97

NOTE: SEE SHEET 2A FOR PLAN SHEET LAYOUT AT TIME OF INVESTIGATION

**STATE OF NORTH CAROLINA**  
**DEPARTMENT OF TRANSPORTATION**  
**DIVISION OF HIGHWAYS**  
**GEOTECHNICAL UNIT**

**ROADWAY**  
**SUBSURFACE INVESTIGATION**

STATE PROJ. 34459.3.7 I.D. R-2552AA F.A. PROJ. NHF-60-1(9)  
 COUNTY WAKE/JOHNSTON  
 PROJECT DESCRIPTION US 70 CLAYTON BYPASS FROM I-40  
IN WAKE COUNTY TO EAST OF SR 1525 (CORNWALLIS RD.)

**INVENTORY**

STATE	STATE PROJECT REFERENCE NO.	SHEET NO.	TOTAL SHEETS
N.C.	R-2552AA	1	97
STATE PROJ. NO.	F.A. PROJ. NO.	DESCRIPTION	
34459.1.1	NHF-60-1(9)	P.E.	
34459.2.3		R/W, UTIL.	
34459.3.7	NHF-60-1(16)	CONST.	

ALL DIMENSIONS IN THESE PLANS ARE IN METERS

**CAUTION NOTICE**

THE SUBSURFACE INFORMATION AND THE SUBSURFACE INVESTIGATION ON WHICH IT IS BASED WAS MADE FOR THE PURPOSE OF STUDY, PLANNING AND DESIGN AND NOT FOR CONSTRUCTION OR PAY PURPOSES. THE VARIOUS FIELD BORING LOGS, ROCK CORES, AND SOIL TEST DATA AVAILABLE MAY BE REVIEWED OR INSPECTED IN RALEIGH BY CONTACTING THE N.C. DEPARTMENT OF TRANSPORTATION, GEOTECHNICAL UNIT @ (919)250-4088. NEITHER THE SUBSURFACE PLANS AND REPORTS, NOR THE FIELD BORING LOGS, ROCK CORES, OR SOIL TEST DATA IS PART OF THE CONTRACT.

GENERAL SOIL AND ROCK STRATA DESCRIPTIONS AND INDICATED BOUNDARIES ARE BASED ON A GEOTECHNICAL INTERPRETATION OF ALL AVAILABLE SUBSURFACE DATA AND MAY NOT NECESSARILY REFLECT THE ACTUAL SUBSURFACE CONDITIONS BETWEEN BORINGS OR BETWEEN SAMPLED STRATA WITHIN THE BOREHOLE. THE LABORATORY SAMPLE DATA AND THE IN SITU (IN-PLACE) TEST DATA CAN BE RELIED ON ONLY TO THE DEGREE OF RELIABILITY INHERENT IN THE STANDARD TEST METHOD. THE OBSERVED WATER LEVELS OR SOIL MOISTURE CONDITIONS INDICATED IN THE SUBSURFACE INVESTIGATIONS ARE AS RECORDED AT THE TIME OF THE INVESTIGATION. THESE WATER LEVELS OR SOIL MOISTURE CONDITIONS MAY VARY CONSIDERABLY WITH TIME ACCORDING TO CLIMATIC CONDITIONS INCLUDING TEMPERATURES, PRECIPITATION AND WIND, AS WELL AS OTHER NON-CLIMATIC FACTORS.

THE BIDDER OR CONTRACTOR IS CAUTIONED THAT DETAILS SHOWN ON THE SUBSURFACE PLANS ARE PRELIMINARY ONLY AND IN MANY CASES THE FINAL DESIGN DETAILS ARE DIFFERENT. FOR BIDDING AND CONSTRUCTION PURPOSES, REFER TO THE CONSTRUCTION PLANS AND DOCUMENTS FOR FINAL DESIGN INFORMATION ON THIS PROJECT. THE DEPARTMENT DOES NOT WARRANT OR GUARANTEE THE SUFFICIENCY OR ACCURACY OF THE INVESTIGATION MADE, NOR THE INTERPRETATIONS MADE OR OPINION OF THE DEPARTMENT AS TO THE TYPE OF MATERIALS AND CONDITIONS TO BE ENCOUNTERED. THE BIDDER OR CONTRACTOR IS CAUTIONED TO MAKE SUCH INDEPENDENT SUBSURFACE INVESTIGATIONS AS HE DEEMS NECESSARY TO SATISFY HIMSELF AS TO CONDITIONS TO BE ENCOUNTERED ON THIS PROJECT. THE CONTRACTOR SHALL HAVE NO CLAIM FOR ADDITIONAL COMPENSATION OR FOR AN EXTENSION OF TIME FOR ANY REASON RESULTING FROM THE ACTUAL CONDITIONS ENCOUNTERED AT THE SITE DIFFERING FROM THOSE INDICATED IN THE SUBSURFACE INFORMATION.

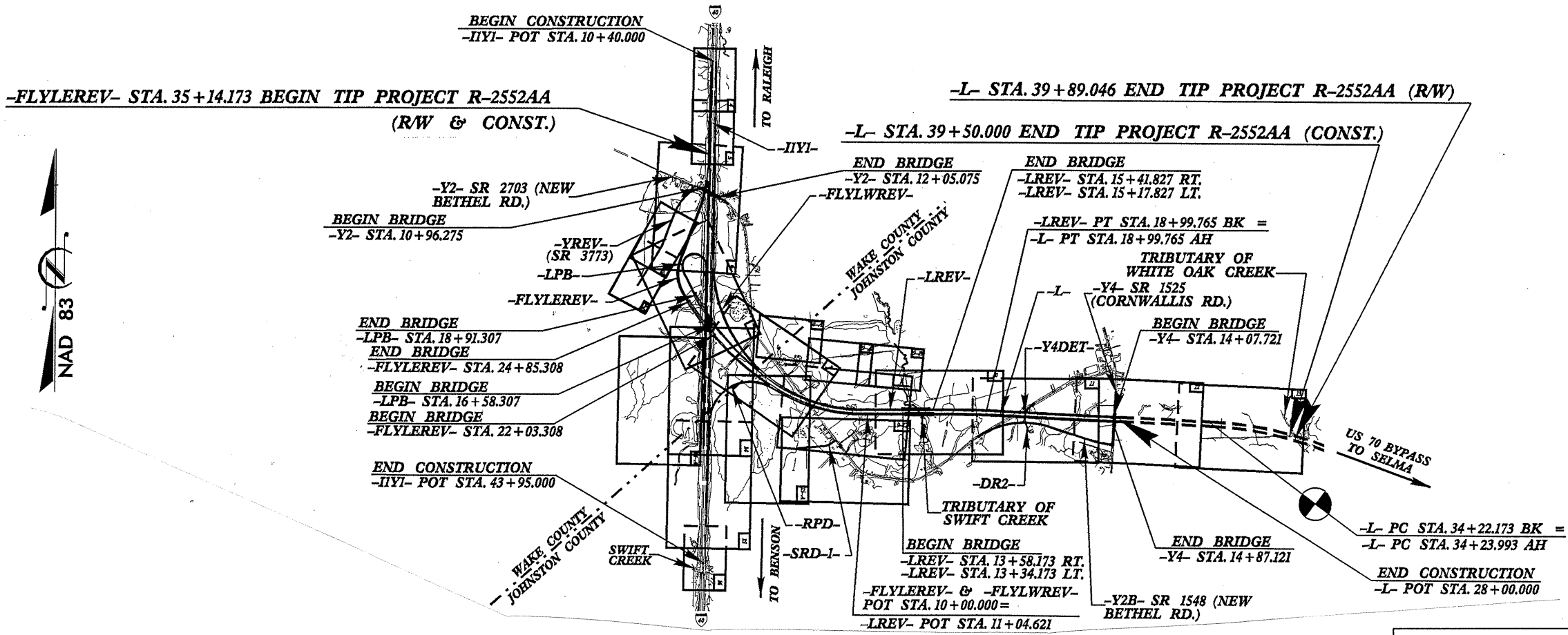

PERSONNEL  
**C. D. CZAJKA**  
**L. T. DEL GRECO**  
**D. S. TIGNOR**  
**C. L. JOHNSON**

INVESTIGATED BY **N. T. ROBERSON**  
 CHECKED BY **D. N. ARGENBRIGHT**  
 SUBMITTED BY **D. N. ARGENBRIGHT**  
 DATE **AUGUST, 2004**

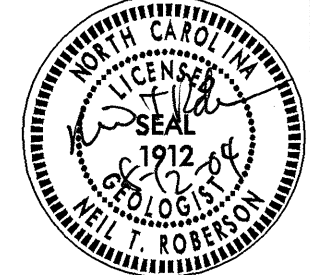

DRAWN BY: **ANK, N.T.R., C.D.C.**

NOTE - THE INFORMATION CONTAINED HEREIN IS NOT IMPLIED OR GUARANTEED BY THE N.C. DEPARTMENT OF TRANSPORTATION AS BEING ACCURATE NOR IS IT CONSIDERED TO BE PART OF THE PLANS, SPECIFICATIONS, OR CONTRACT FOR THE PROJECT.

NOTE - BY HAVING REQUESTED THIS INFORMATION THE CONTRACTOR SPECIFICALLY WAIVES ANY CLAIMS FOR INCREASED COMPENSATION OR EXTENSION OF TIME BASED ON DIFFERENCES BETWEEN THE CONDITIONS INDICATED HEREIN AND THE ACTUAL CONDITIONS AT THE PROJECT SITE.