

042597

GREENHORNE & O'MARA, INC.  
5565 CENTERVIEW DRIVE, SUITE 107  
RALEIGH, NORTH CAROLINA 27606  
(919) 851-1919

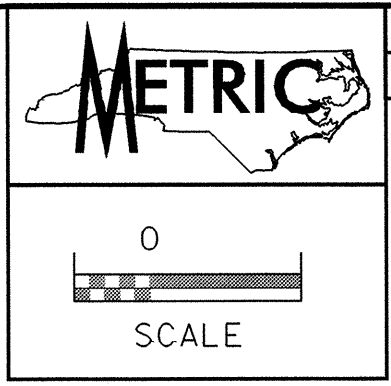

PROJECT REFERENCE NO. R-2539C SHEET NO. UO-7

### UTILITIES BY OTHERS

NOTE:  
ALL PROPOSED UTILITY WORK  
SHOWN ON THIS SHEET WILL  
BE DONE BY OTHERS

-L-	-L-
PI Sta 172+51.886	PI Sta 174+62.032
$\Delta = 10^\circ 40' 26.8''$ (LT)	$\Delta = 10^\circ 16' 30.8''$ (RT)
L = 171.395	L = 159.609
T = 85.946	T = 80.019
R = 920.000	R = 890.000
S.E. = .03	S.E. = .03
R'OFF = 39.0	R'OFF = 39.0

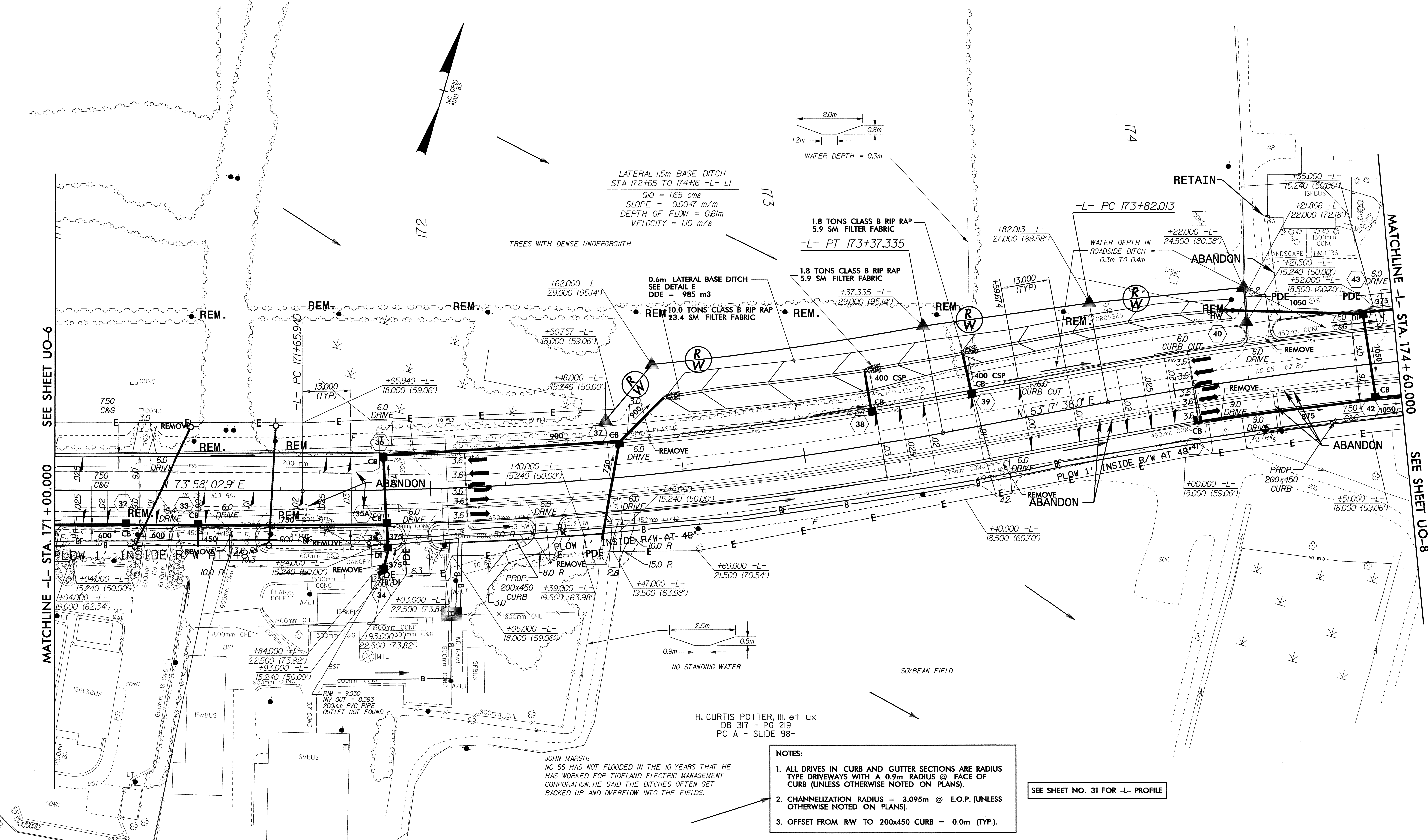
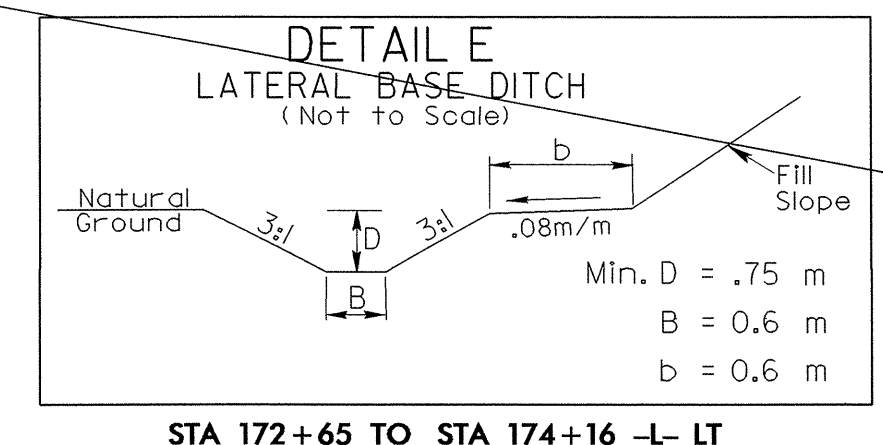

LATERAL 1.5m BASE DITCH  
STA 172+65 TO 174+16 -L- LT

Q10 = 1.65 cms  
SLOPE = 0.0047 m/m  
DEPTH OF FLOW = 0.61m  
VELOCITY = 1.10 m/s

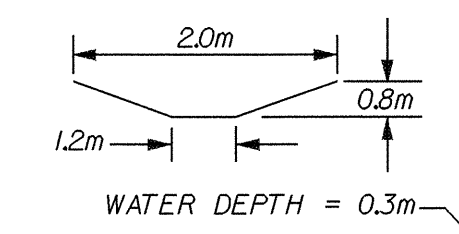

TREES WITH DENSE UNDERGROWTH

SOYBEAN FIELD

H. CURTIS POTTER, III, e+ ux  
DB 317 - PG 219  
PC A - SLIDE 98-

JOHN MARSH:  
NC 55 HAS NOT FLOODED IN THE 10 YEARS THAT HE  
HAS WORKED FOR TIDELAND ELECTRIC MANAGEMENT  
CORPORATION. HE SAID THE DITCHES OFTEN GET  
BACKED UP AND OVERFLOW INTO THE FIELDS.

- NOTES:
1. ALL DRIVES IN CURB AND GUTTER SECTIONS ARE RADIUS TYPE DRIVEWAYS WITH A 0.9m RADIUS @ FACE OF CURB (UNLESS OTHERWISE NOTED ON PLANS).
  2. CHANNELIZATION RADIUS = 3.095m @ E.O.P. (UNLESS OTHERWISE NOTED ON PLANS).
  3. OFFSET FROM RW TO 200x450 CURB = 0.0m (TYP.).

SEE SHEET NO. 31 FOR -L- PROFILE

SEE SHEET UO-6

MATCHLINE -L- STA. 171 + 00.000

MATCHLINE -L- STA. 174 + 60.000

SEE SHEET UO-8

26-OCT-2004 13:51  
R:\Utilities\2539\Drawings\UO-7.dgn