

CONTRACT: C201457 TIP PROJECT: R-2539C

STATE OF NORTH CAROLINA
DIVISION OF HIGHWAYS

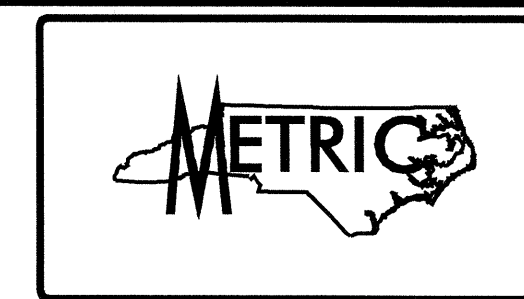

STATE	STATE PROJECT REFERENCE NO.	SHEET NO.	TOTAL SHEETS
N.C.	R-2539C		
STATE PROJ. NO.	F.A. PROJ. NO.	DESCRIPTION	
34452.1.1	STP-55(1)	P.E.	
34452.2.4	STP-55(31)	RW, UTIL.	
34452.3.7	STP-55(33)	CONSTR.	

PAMLICO COUNTY

LOCATION: NC 55 FROM EAST OF SR 1129 TO NC 304 IN BAYBORO

TYPE OF WORK: GRADING, DRAINAGE, PAVING, CURB & GUTTER, CULVERTS SIGNALS, & SIGNING

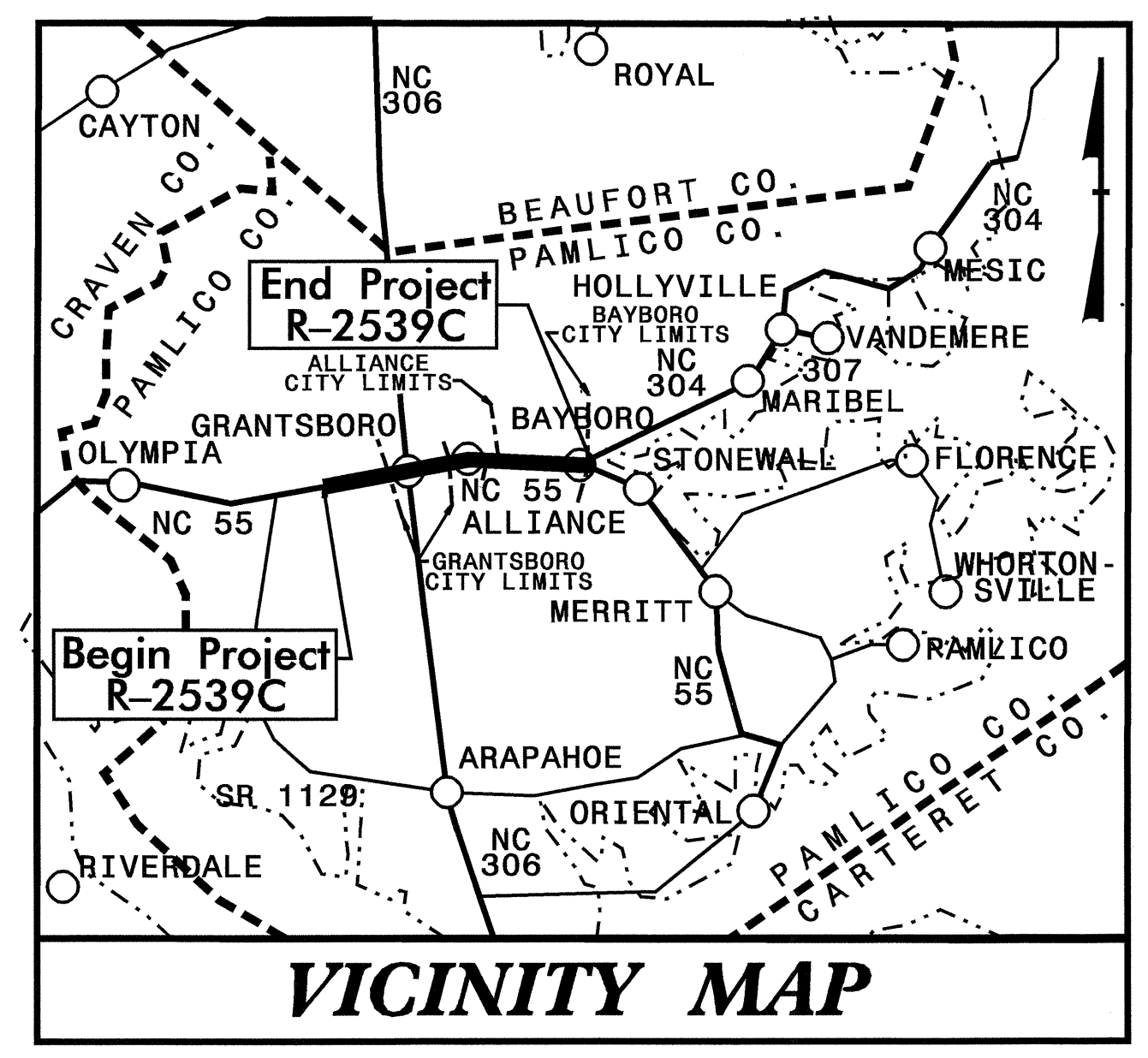

CULVERTS

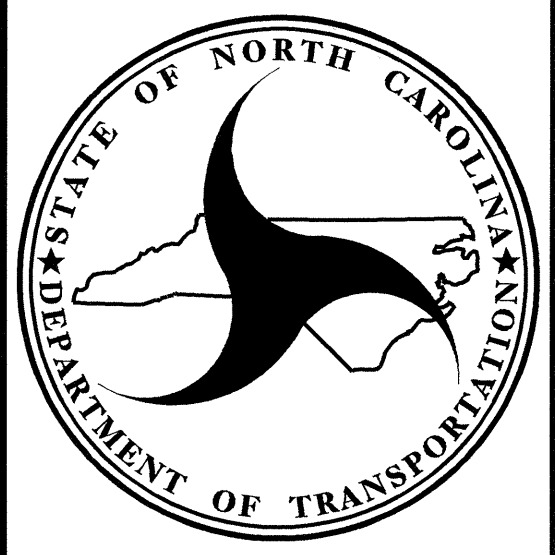
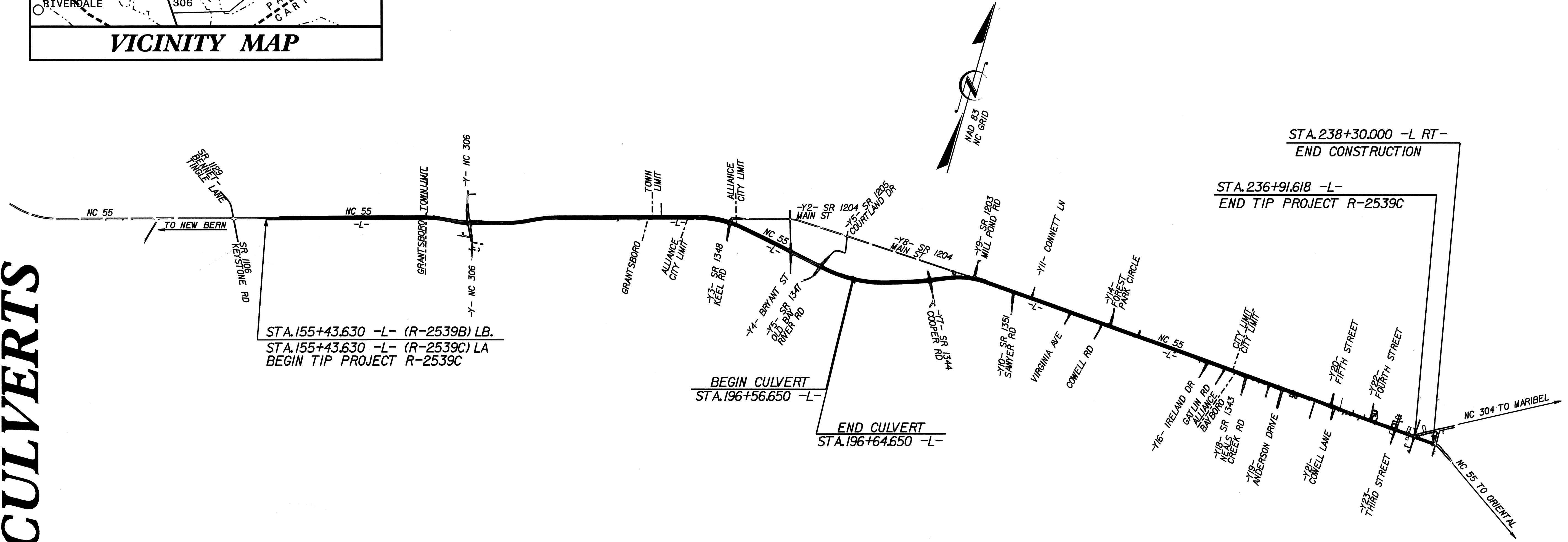

DESIGN DATA

ADT (2005) = 8,100-15,200
ADT (2025) = 12,800-24,100

DHV = 12%
D = 60% / 63%
T = 7% *

V = 100 km/h (SHOULDER SECTION)
V = 80 km/h (CURB & GUTTER SECTION)

* (TTST 2%+ DUAL 5%)

PROJECT LENGTH

LENGTH ROADWAY TIP PROJECT R-2539C = 8.140 Km
LENGTH STRUCTURE TIP PROJECT R-2539C = 0.008 Km
TOTAL LENGTH OF TIP PROJECT R-2539C = 8.148 Km

Prepared In the Office of:
DIVISION OF HIGHWAYS

2002 STANDARD SPECIFICATIONS

LETTING DATE:
MAY 17, 2005

JOHN C. FRYE, P.E.
PROJECT ENGINEER

BRIAN C. HANKS, P.E.
PROJECT DESIGN ENGINEER

STRUCTURE DESIGN UNIT
1000 BIRCH RIDGE DRIVE
RALEIGH, NC 27610

Professional Engineer Seal: Gregory R. Perrett, No. 14552, dated 10-28-04.

DIVISION OF HIGHWAYS
STATE OF NORTH CAROLINA

STATE DESIGN ENGINEER
DEPARTMENT OF TRANSPORTATION
FEDERAL HIGHWAY ADMINISTRATION

APPROVED
DIVISION ADMINISTRATOR

DATE