

20

25

30

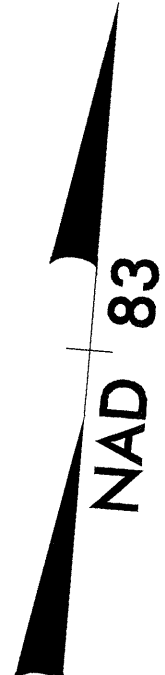
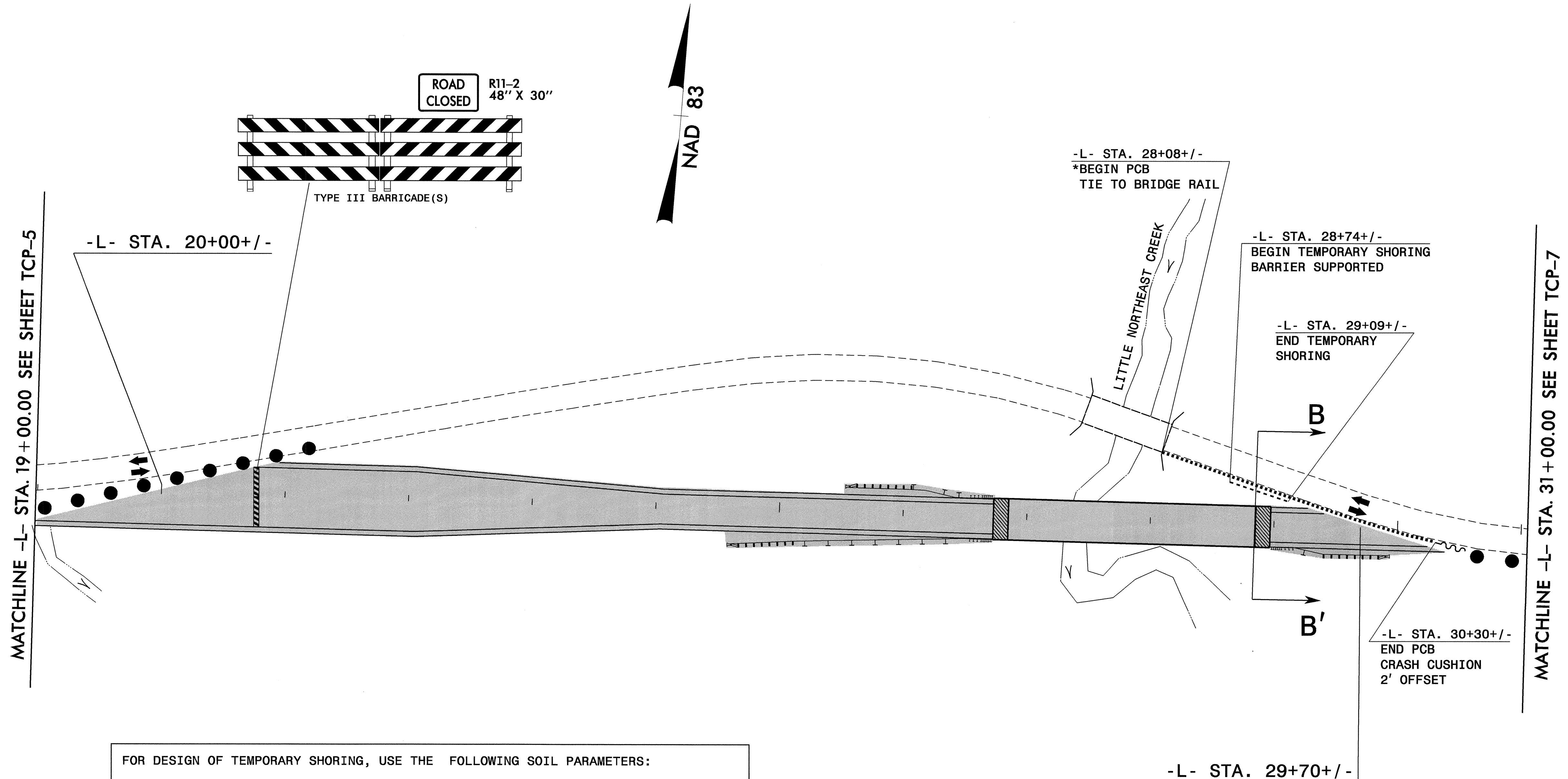

FOR DESIGN OF TEMPORARY SHORING, USE THE FOLLOWING SOIL PARAMETERS:

UNIT WEIGHT OF SOIL ABOVE WATER TABLE, $\gamma = 120$ pcf
 UNIT WEIGHT OF SOIL BELOW WATER TABLE, $\gamma' = 60$ pcf
 FRICTION ANGLE, $\phi = 30^\circ$
 COHESION, $c = 0$ psf

STANDARD SHORING IS ALLOWED.

*SEE ROADWAY PROPOSAL FOR DETAIL DRAWING, PAY ITEMS, AND QUANTITIES.

B - B'

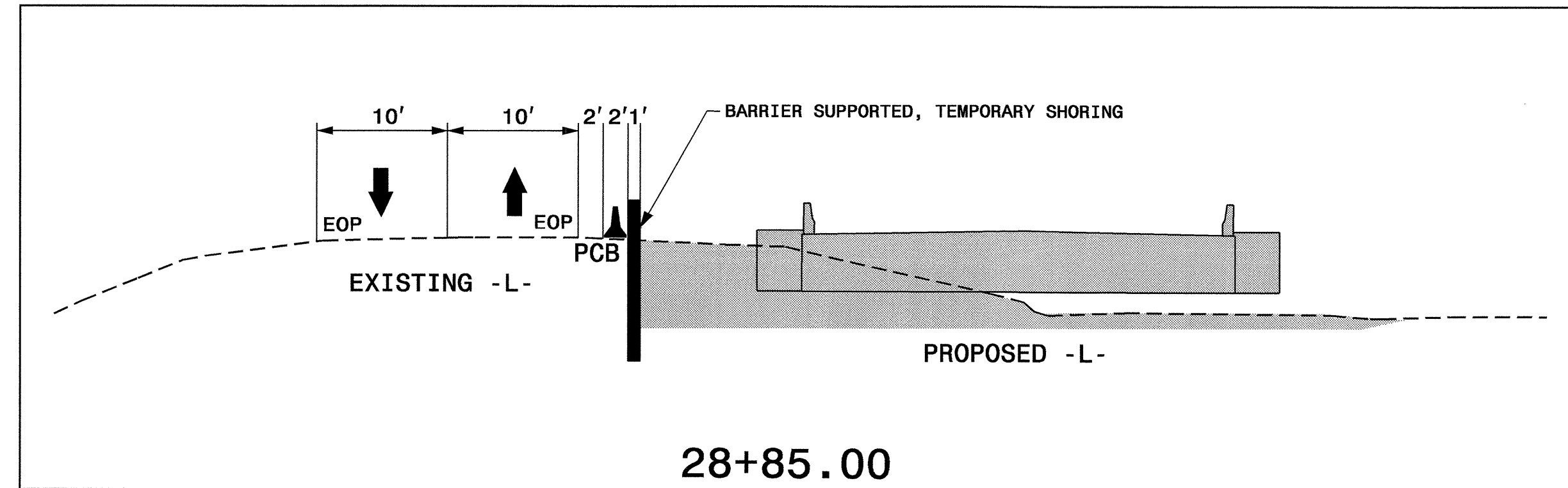

APPROVED: <i>Joseph Ischia</i> DATE: 12/7/04	DETAIL 1: PROPOSED -L- WIDENING -L- STAS. 19+00.00 TO 31+00.00		
	SCALE: NONE		
	DATE: 12/02/04		REVISIONS
	DWG. BY: CLL		
	DESIGN BY: CLL		
REVIEWED BY: JI		CADD FILE	

06-DEC-2004 16:36
 \\ets-cctf501\B3682\TCP\B3682ANDW3413TCP.DGN
 b\watson AT TET195142