

05/08/99

CONTRACT: C201465 TIP PROJECT: B-3682

CONTRACT: C201465 TIP PROJECT: W-3413

See Sheet 1-A For Index of Sheets
See Sheet 1-B For Conventional Symbols

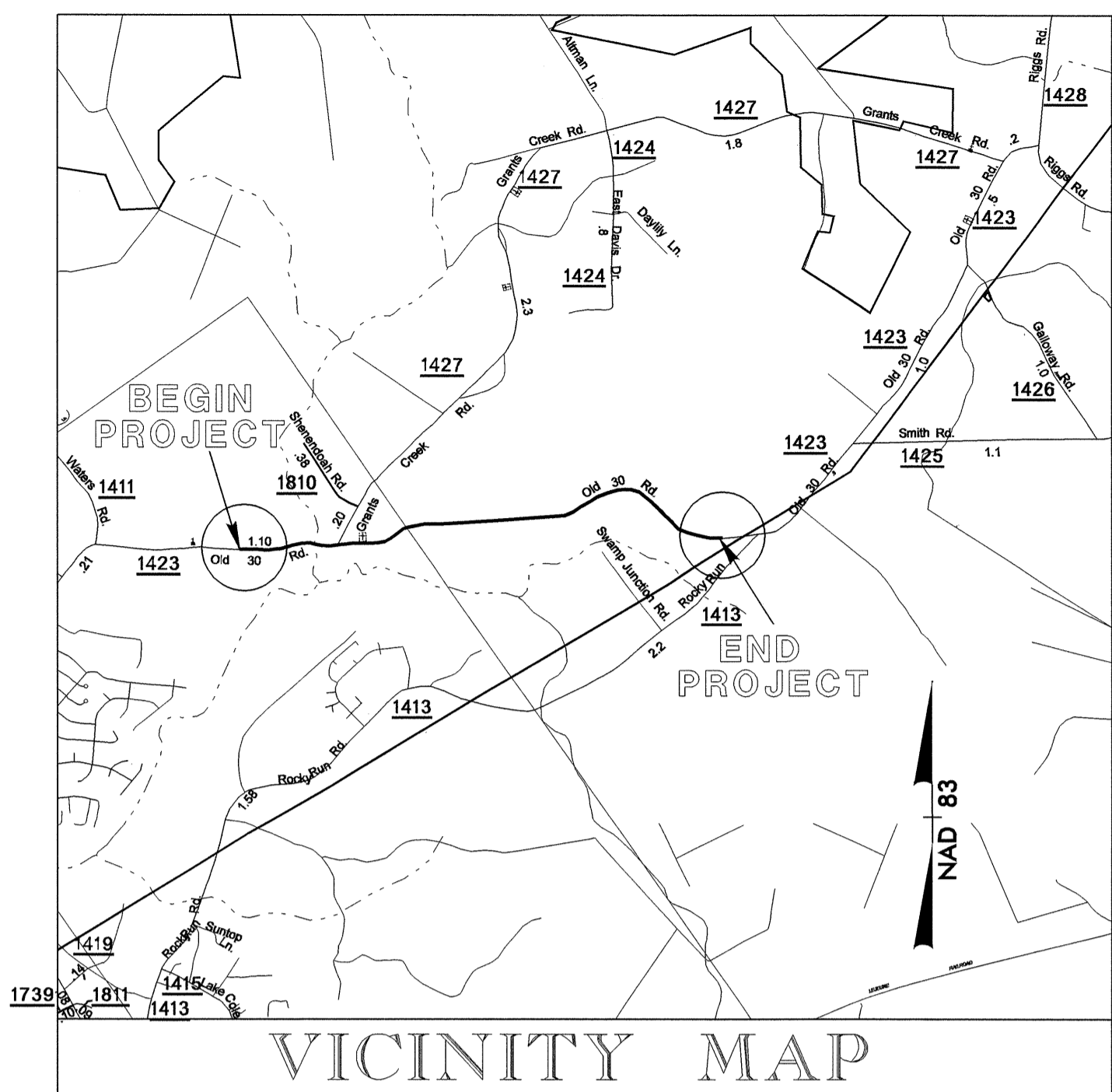

STATE OF NORTH CAROLINA DIVISION OF HIGHWAYS ONSLOW COUNTY

LOCATION: B-3682 - BRIDGE NO. 3 OVER LITTLE NORTHEAST CREEK ON SR 1423
W-3413 - SR 1423 FROM SR 1427 TO SR 1413
TYPE OF WORK: GRADING, PAVING, WIDENING, RESURFACING DRAINAGE AND STRUCTURE.

| STATE | STATE PROJECT REFERENCE NO. | SHEET NO. | TOTAL SHEETS |
|-----------------|-----------------------------|----------------|--------------|
| N.C. | B-3682 & W-3413 | 1 | |
| STATE PROJ. NO. | F.A. PROJ. NO. | DESCRIPTION | |
| 33224.1.1 | BRSTP-1423 (2) | P.E. | |
| 33224.1.1 | BRSTP-1423 (3) | ROW,UTIL. | |
| 33224.3.2 | BRSTP-1423 (5) | CONST. | |
| 35052.1.1 | STP-1423 (2) | P.E.,ROW,UTIL. | |
| 35052.3.1 | STP-1423 (2) | CONST. | |

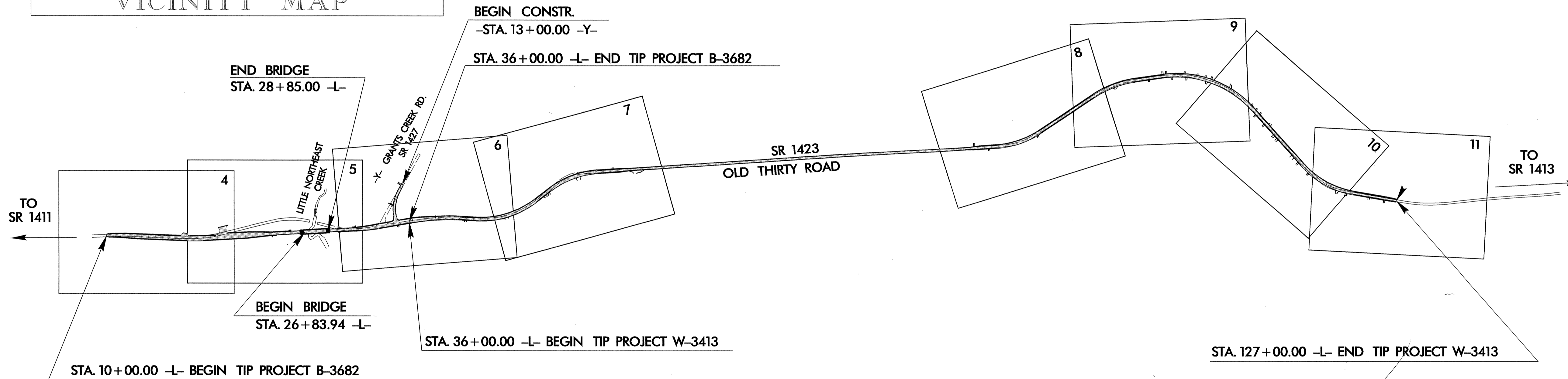

GRAPHIC SCALES

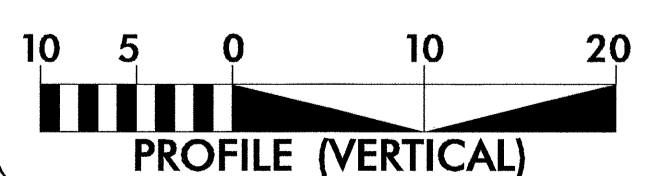
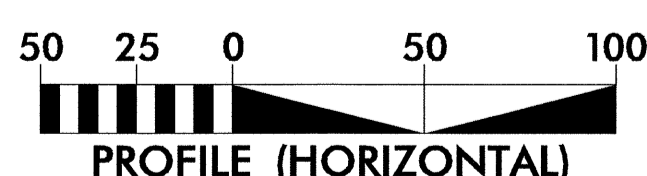
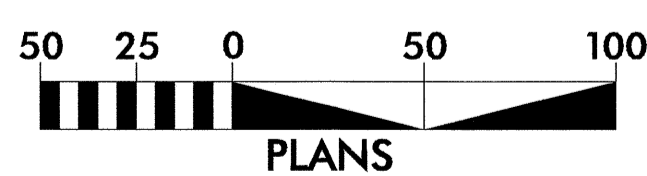

DESIGN DATA

ADT 2004 = 3,680
 ADT 2024 = 6,080
 DHV = 9 %
 D = 55 %
 T = 3 % *
 V = 50 MPH
 * TTST 1 % DUAL 2 %
 FUNC CLASS = LOCAL

PROJECT LENGTH

LENGTH ROADWAY B-3682 = 0.454 mi
 LENGTH STRUCTURE B-3682 = 0.038 mi
 TOTAL LENGTH STATE PROJECT B-3682 = 0.492 mi
 LENGTH ROADWAY W-3413 = 1.723 mi
 TOTAL LENGTH STATE PROJECT W-3413 = 1.723 mi
 TOTAL LENGTH PROJECTS B-3682 AND W-3413 = 2.215 mi

Prepared in the Office of:
DIVISION OF HIGHWAYS

1000 Birch Ridge Dr., NC, 27610

2002 STANDARD SPECIFICATIONS

RIGHT OF WAY DATE:
September 30, 2003

LETTING DATE:
MAY 17, 2005

JIMMY S. GOODNIGHT
PROJECT ENGINEER

TIM GOINS
PROJECT DESIGN ENGINEER

HYDRAULICS ENGINEER



SIGNATURE: *Max S. Price*
ROADWAY DESIGN ENGINEER

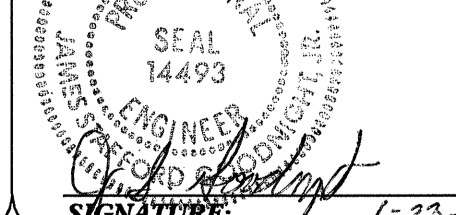

SIGNATURE: *Tim Goins*
1-23-05

DIVISION OF HIGHWAYS
STATE OF NORTH CAROLINA

Pat McMillan P.E.
STATE DESIGN ENGINEER

DEPARTMENT OF TRANSPORTATION
FEDERAL HIGHWAY ADMINISTRATION

APPROVED
DIVISION ADMINISTRATOR DATE

26-JAN-2005 15:18
C:\pwworkspace\tdgoins\rd-04occe34