

METRIC

PROJECT REFERENCE NO. R-2552B SHEET NO. 16D
 R/W SHEET NO.
 ROADWAY DESIGN ENGINEER HYDRAULICS ENGINEER
PRELIMINARY PLANS
 DO NOT USE FOR CONSTRUCTION

CONST. REV.
 R/W REV.

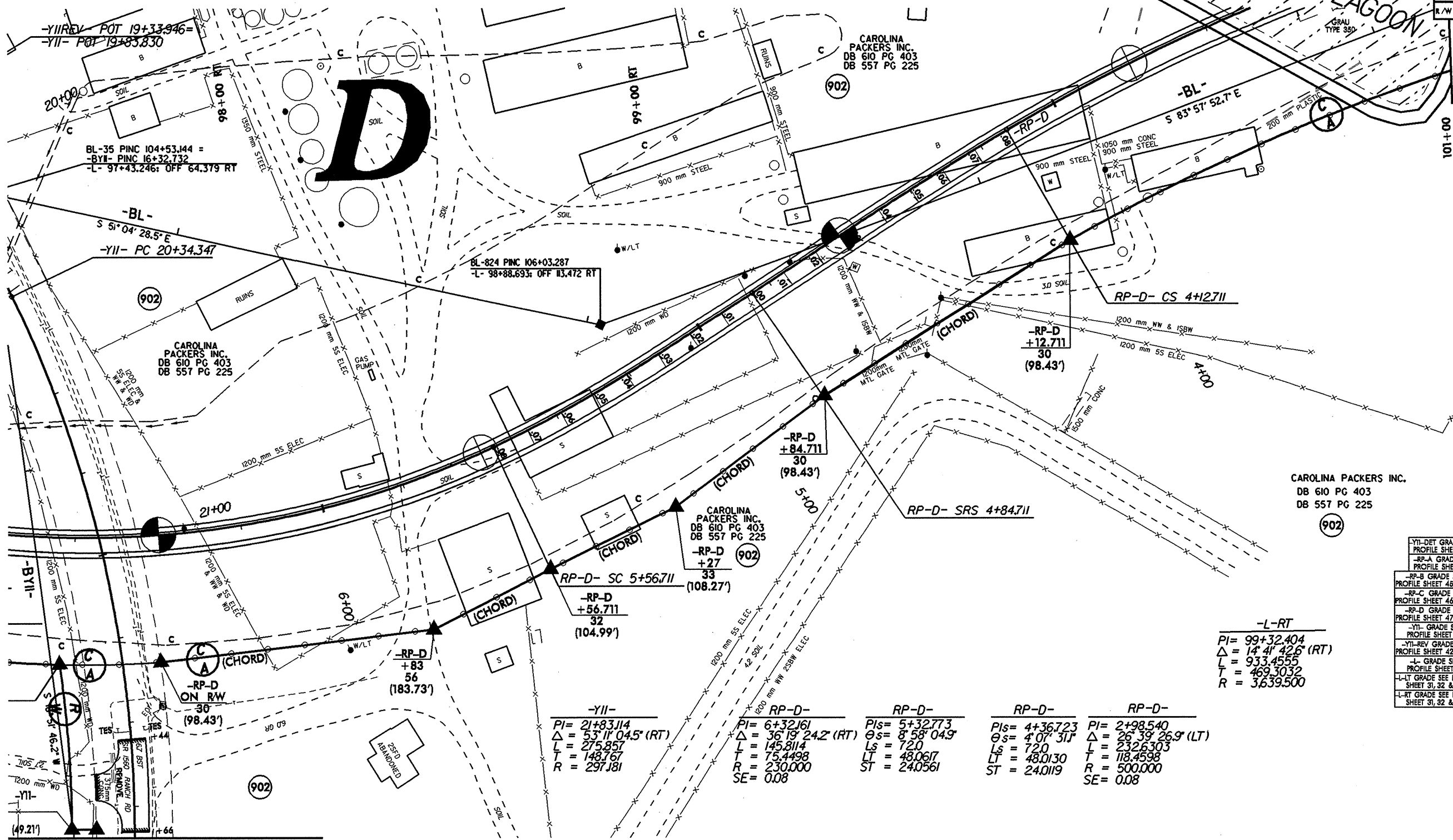

- YII-DET GRADE SEE PROFILE SHEET 44
- RP-A GRADE SEE PROFILE SHEET 45
- RP-B GRADE SEE PROFILE SHEET 45 & 46
- RP-C GRADE SEE PROFILE SHEET 46 & 47
- RP-D GRADE SEE PROFILE SHEET 47 & 48
- YII- GRADE SEE PROFILE SHEET 40
- YII-REV GRADE SEE PROFILE SHEET 42 & 43
- L- GRADE SEE PROFILE SHEET 31
- L-LT GRADE SEE PROFILE SHEET 31, 32 & 33
- L-RT GRADE SEE PROFILE SHEET 31, 32 & 33

-L-RT
 $PI = 99+32.404$
 $\Delta = 14^{\circ} 41' 42.6" (RT)$
 $L = 933.4555$
 $T = 469.3032$
 $R = 3,639.500$

<p>-YII- $PI = 21+83.114$ $\Delta = 53^{\circ} 11' 04.5" (RT)$ $L = 275.857$ $T = 148.767$ $R = 297.181$</p>	<p>RP-D- $PI = 6+32.161$ $\Delta = 36^{\circ} 19' 24.2" (RT)$ $L = 145.8114$ $T = 75.4498$ $R = 230.000$ $SE = 0.08$</p>	<p>RP-D- $PIs = 5+32.773$ $\Theta s = 8^{\circ} 58' 04.9"$ $Ls = 72.0$ $LT = 48.0617$ $ST = 24.0561$</p>	<p>RP-D- $PIs = 4+36.723$ $\Theta s = 4^{\circ} 07' 31"$ $Ls = 72.0$ $LT = 48.0130$ $ST = 24.0119$</p>	<p>RP-D- $PI = 2+98.540$ $\Delta = 26^{\circ} 39' 26.9" (LT)$ $L = 232.6303$ $T = 118.4598$ $R = 500.000$ $SE = 0.08$</p>
---	---	---	---	--

CAROLINA PACKERS INC.
 DB 610 PG 403
 DB 557 PG 225
 (902)

CAROLINA PACKERS INC.
 DB 610 PG 403
 DB 557 PG 225
 (902)

CAROLINA PACKERS INC.
 DB 610 PG 403
 DB 557 PG 225
 (902)

CAROLINA PACKERS INC.
 DB 610 PG 403
 DB 557 PG 225
 (902)

(902)