

- NOTES:
- FOR BARRIER RAIL DIMENSIONS AND REINFORCING STEEL IN BARRIER RAIL, SEE SHEET 2 OF 7.
 - FOR SPLICE LENGTH OF "A" & "C" BARS SEE SPLICE TABLE ON "STD. SUPERSTRUCTURE BILL OF MATERIAL" SHEET.
 - ARC OFFSETS ARE NEGLIGIBLE.

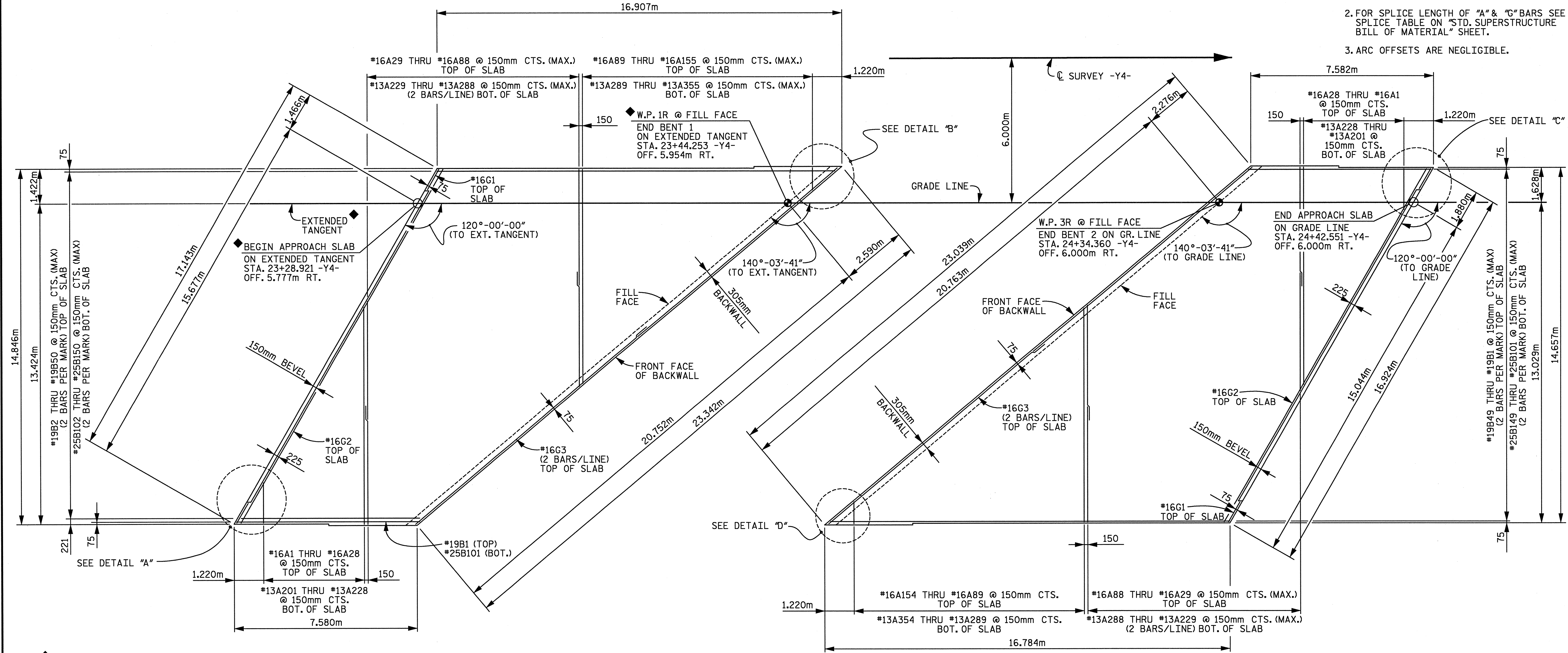

PLAN OF APPROACH SLAB @ END BENT 1

PLAN OF APPROACH SLAB @ END BENT 2

SEE SHEET TITLED "GENERAL DRAWING EXTENDED TANGENT LAYOUT" FOR DETAILS.

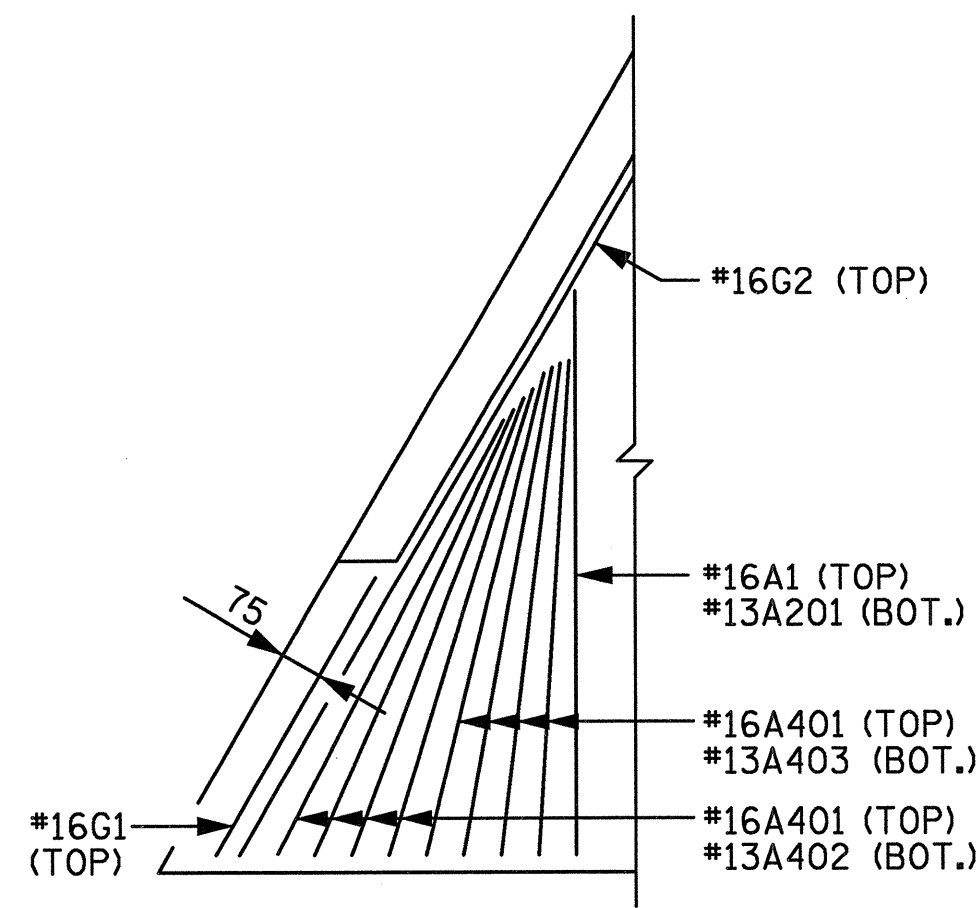

DETAIL "A"
(PLACE BARS AS SHOWN)

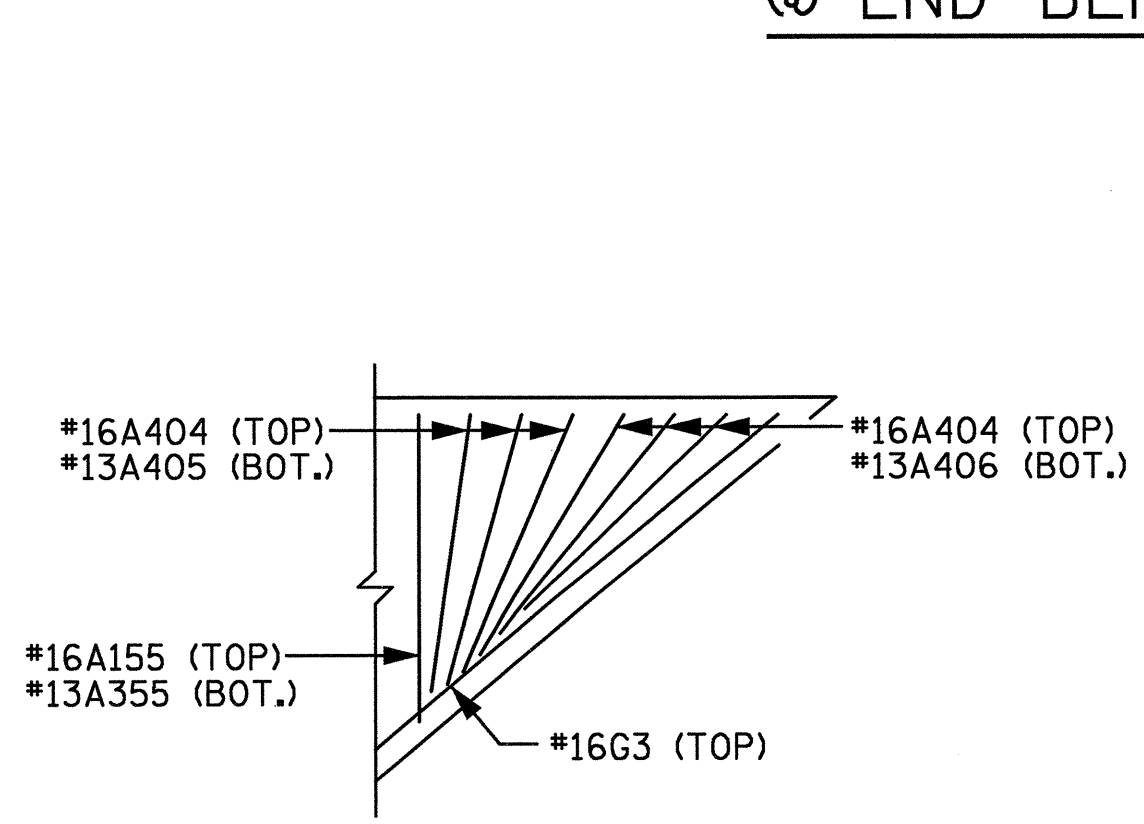

DETAIL "B"
(PLACE BARS AS SHOWN)

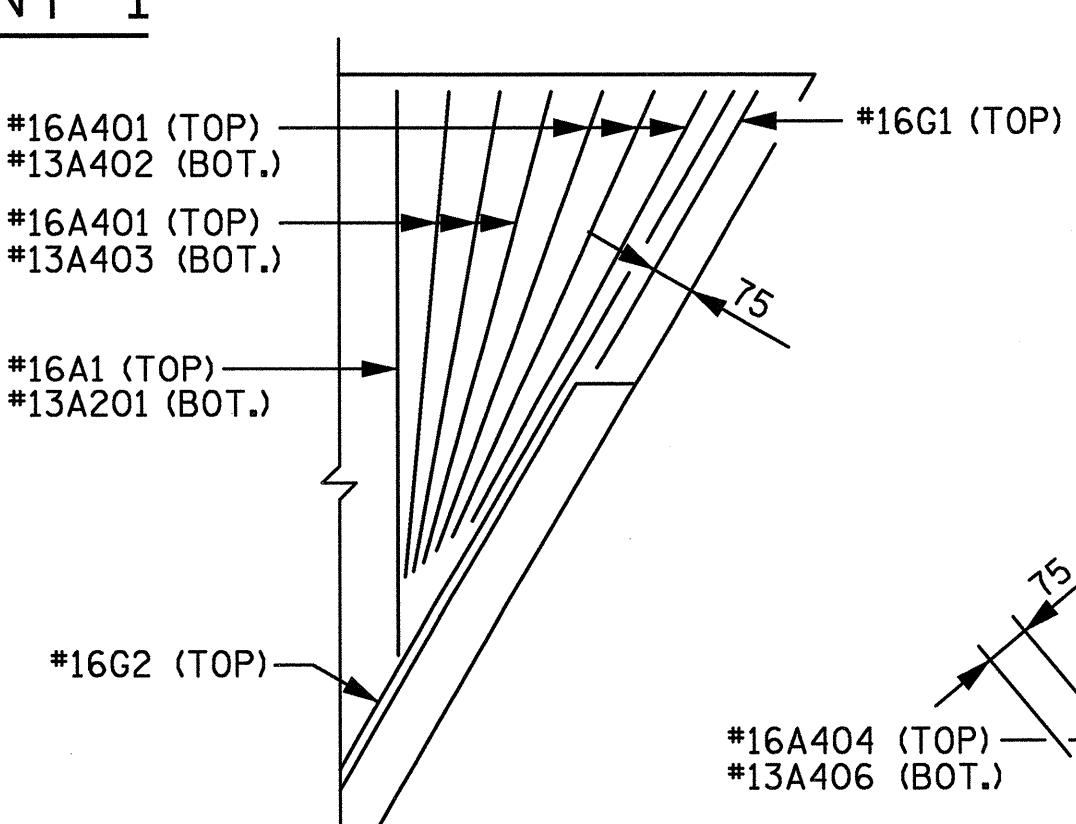

DETAIL "C"
(PLACE BARS AS SHOWN)

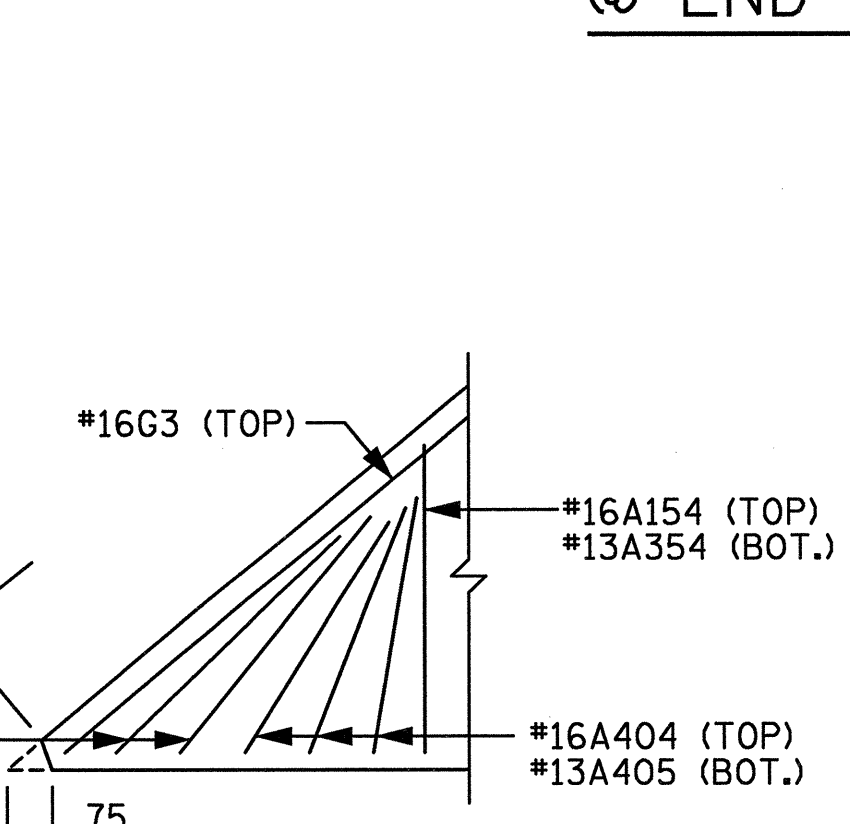

DETAIL "D"
(PLACE BARS AS SHOWN)

PROJECT No R-2552C
 JOHNSTON COUNTY
 STATION: POT 148+08.446 -L2-
 POT 23+96.446 -Y4-

SHEET 3 OF 7

NO.	BY	DATE	NO.	DATE
1			3	
2			4	

STATE OF NORTH CAROLINA
 DEPARTMENT OF TRANSPORTATION
 RALEIGH
 BRIDGE APPROACH SLAB PLAN
 -RIGHT LANE-

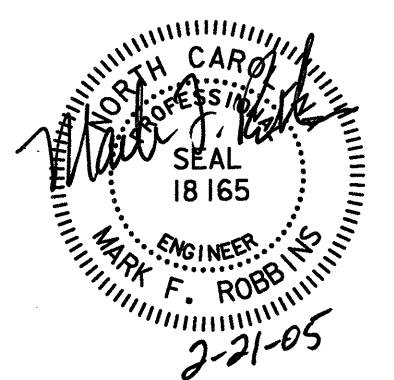

W RALPH WHITEHEAD ASSOCIATES, INC.
 CONSULTING ENGINEERS
 P.O. BOX 35624 CHARLOTTE, N.C. 28235
 DRAWN BY LGH, KPM DATE: 1-05 DWG. NO.
 CHECKED BY JTG DATE: 1-05 D-1750.34

SHEET NO. 5-391
 TOTAL SHEETS 431

02/17/2005 04:55:41 PM n:\p\proj\3109-200\ustation\struct\final\3109-200_app_slab.dgn