

02/23/2005 10:30:56 AM n:\proj\3109-300\station\struct\find\3109-300_long_chord.dgn

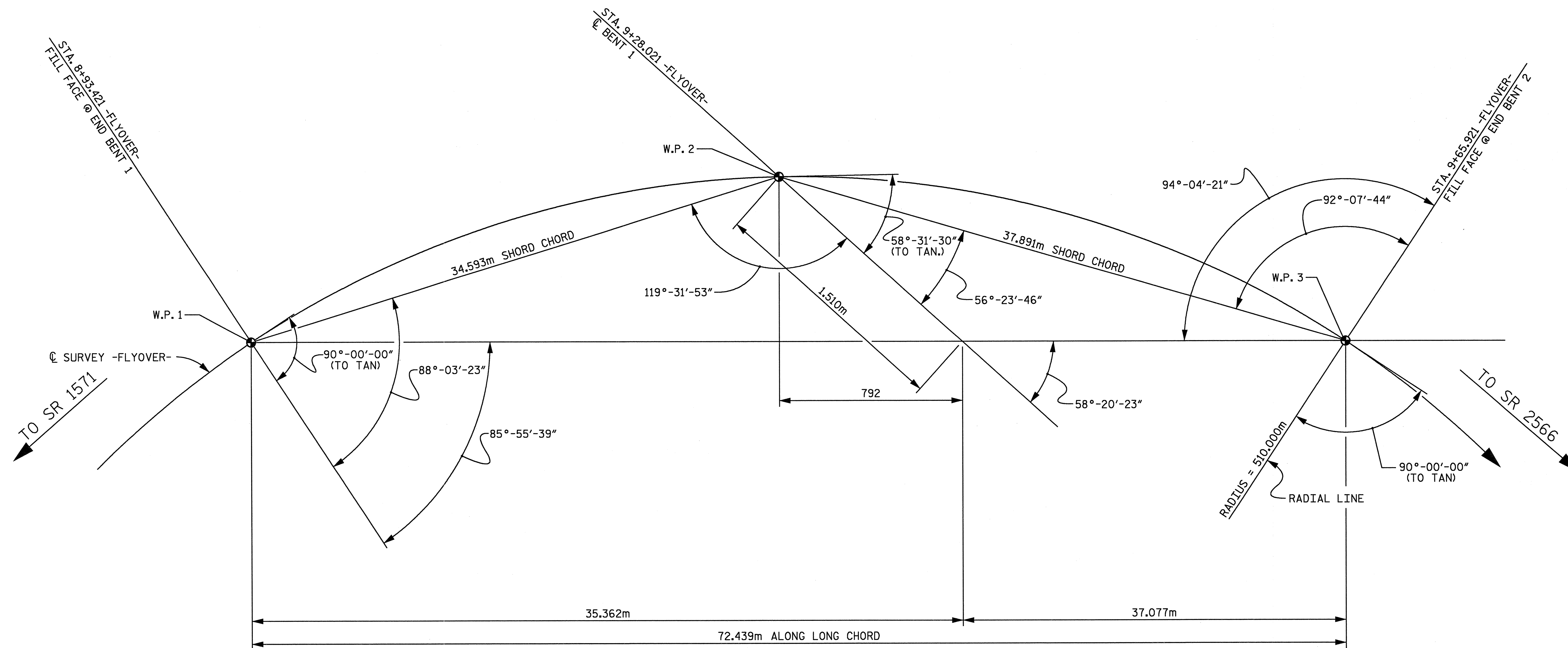

LONG CHORD LAYOUT

(NOTE : END BENTS AND BENT ARE NOT PARALLEL.)
(CURVATURE EXAGGERATED FOR CLARITY)

PROJECT No. R-2552C
JOHNSTON COUNTY
STATION: POS 16+52.599 -Y4- =
POC 9+28.021 -FLYOVER-

CURVE DATA

-FLYOVER- HORIZONTAL CURVE DATA

PIs STA.	Δ	L	LT	ST
STA. 7+67.048	3°-22'-13.2" (RT.)	60.000m	40.007m	20.007m
STA. 11+32.324	68°-11'-52.7" (RT.)	607.042m	345.283m	510.000m
STA. 14+14.090	3°-22'-13.2" (RT.)	60.000m	40.007m	20.007m

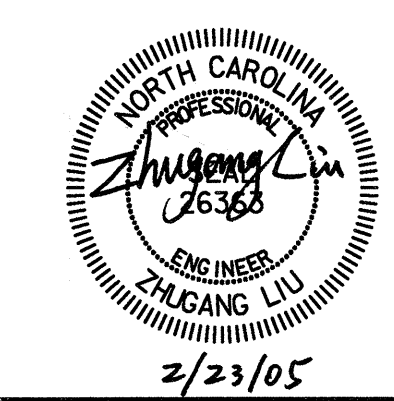
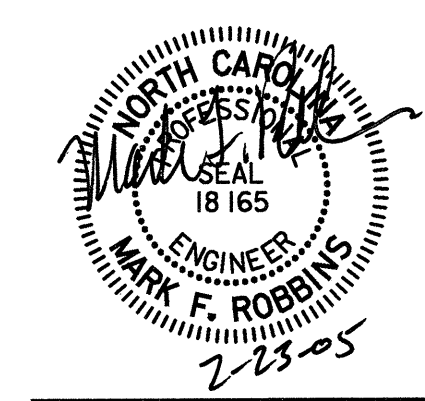

RALPH WHITEHEAD ASSOCIATES, INC.
CONSULTING ENGINEERS
P.O. BOX 35624 CHARLOTTE, N.C. 28235
DRAWN BY: WBS, LGH DATE: 8-04 DWG. NO.:
CHECKED BY: ZAL DATE: 1-05 D-1748.03

NO.	BY	DATE
1		
2		
3		
4		

STATE OF NORTH CAROLINA
DEPARTMENT OF TRANSPORTATION
RALEIGH
**GENERAL DRAWING
LONG CHORD LAYOUT**

SHEET NO. 5-398
TOTAL SHEETS 431

SHEET 3 OF 4