

NOTE: IMMEDIATELY AFTER THE CONSTRUCTION OF THE APPROACH SLAB, THE CONTRACTOR SHALL PROVIDE TEMPORARY BERM AND SLOPE DRAIN. CONTRACTOR SHALL GRADE TO PIPE INLET AND PROVIDE EROSION RESISTANT MATERIAL AS SHOWN. THE EROSION RESISTANT MATERIAL SHALL BE EITHER 1) ASPHALT PLANT MIX, TYPE 1 OR TYPE 2, MIN. 50mm DEPTH, 2) EROSION CONTROL MAT, OR 3) CONCRETE, AS DIRECTED BY THE ENGINEER. THE SLOPE DRAIN SHALL CONSIST OF A NON-PERFORATED TEMPORARY DRAINAGE PIPE, 305mm IN DIAMETER.

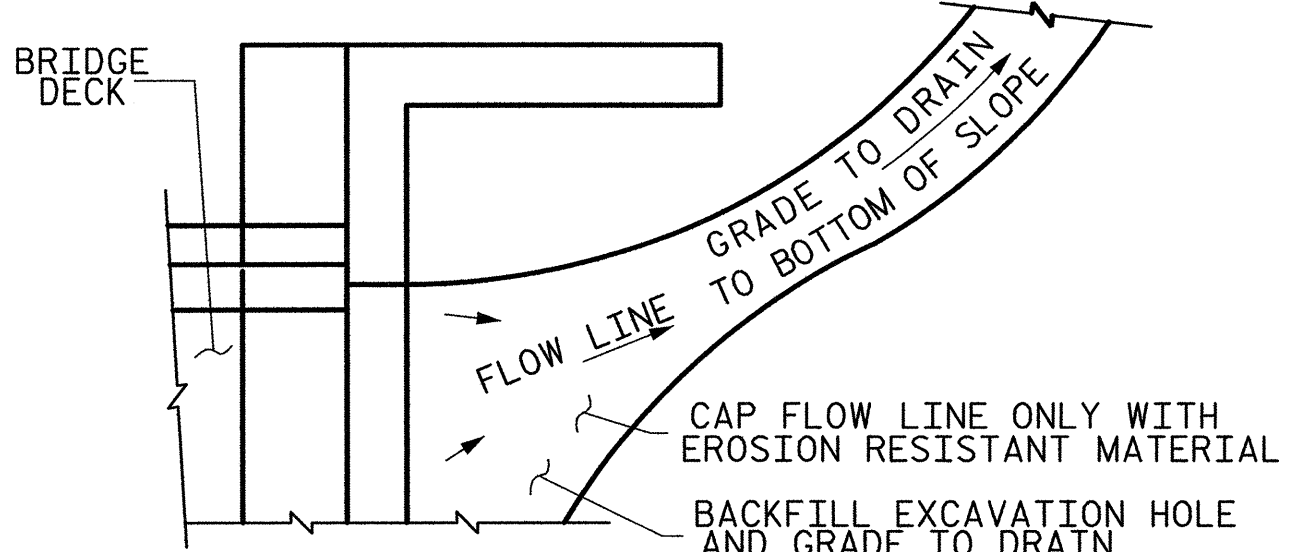

NOTE: IF THE APPROACH SLAB IS NOT CONSTRUCTED IMMEDIATELY AFTER THE BACKFILLING OF THE END BENT EXCAVATION, GRADE TO DRAIN TO THE BOTTOM OF THE SLOPE AND PROVIDE EROSION RESISTANT MATERIAL, SUCH AS FIBERGLASS ROVING OR AS DIRECTED BY THE ENGINEER TO PREVENT SOIL EROSION AND TO PROTECT THE AREA ADJACENT TO THE STRUCTURE. THE CONTRACTOR WILL BE REQUIRED TO REMOVE THESE MATERIALS PRIOR TO CONSTRUCTION OF THE APPROACH SLAB.

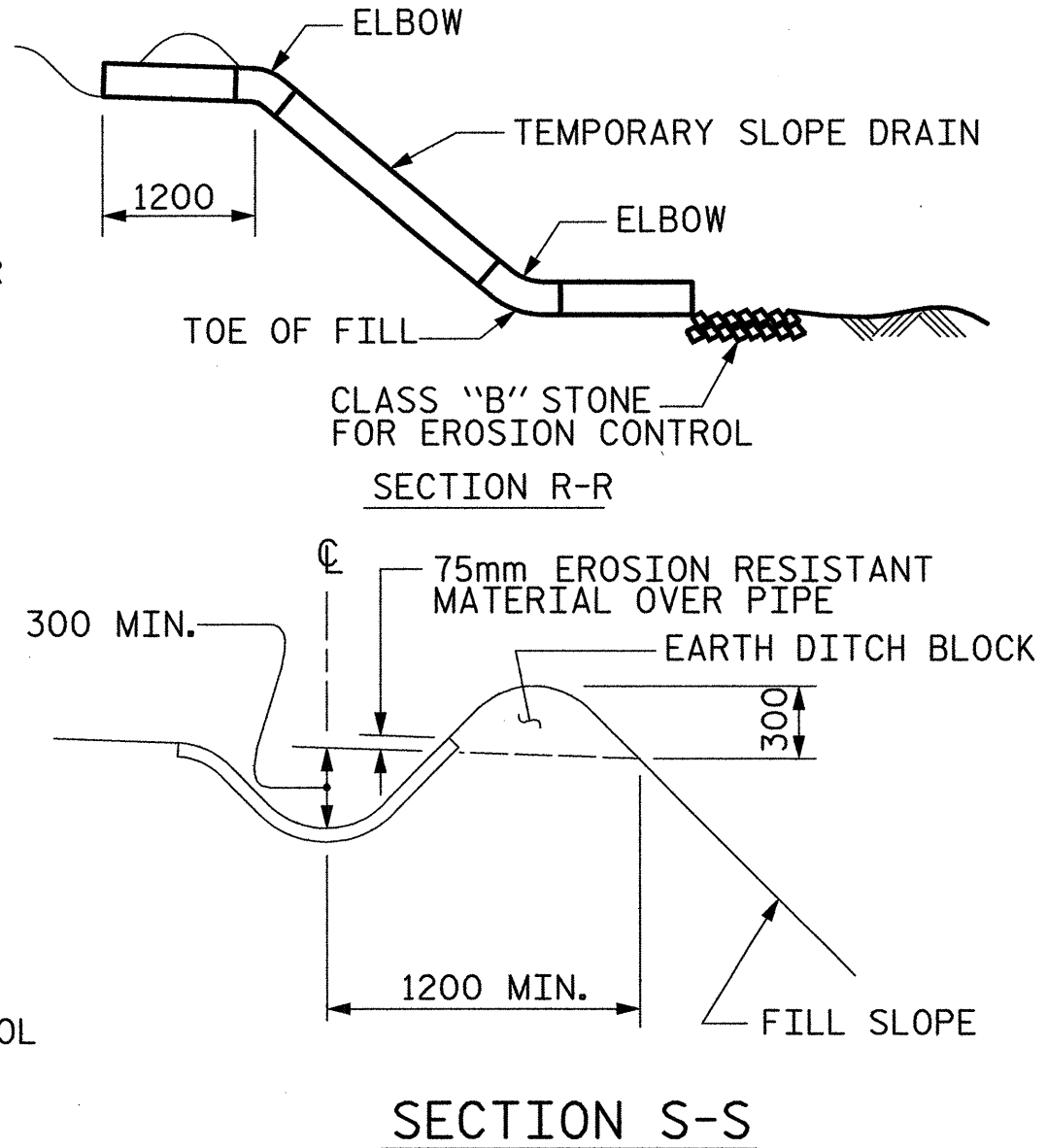
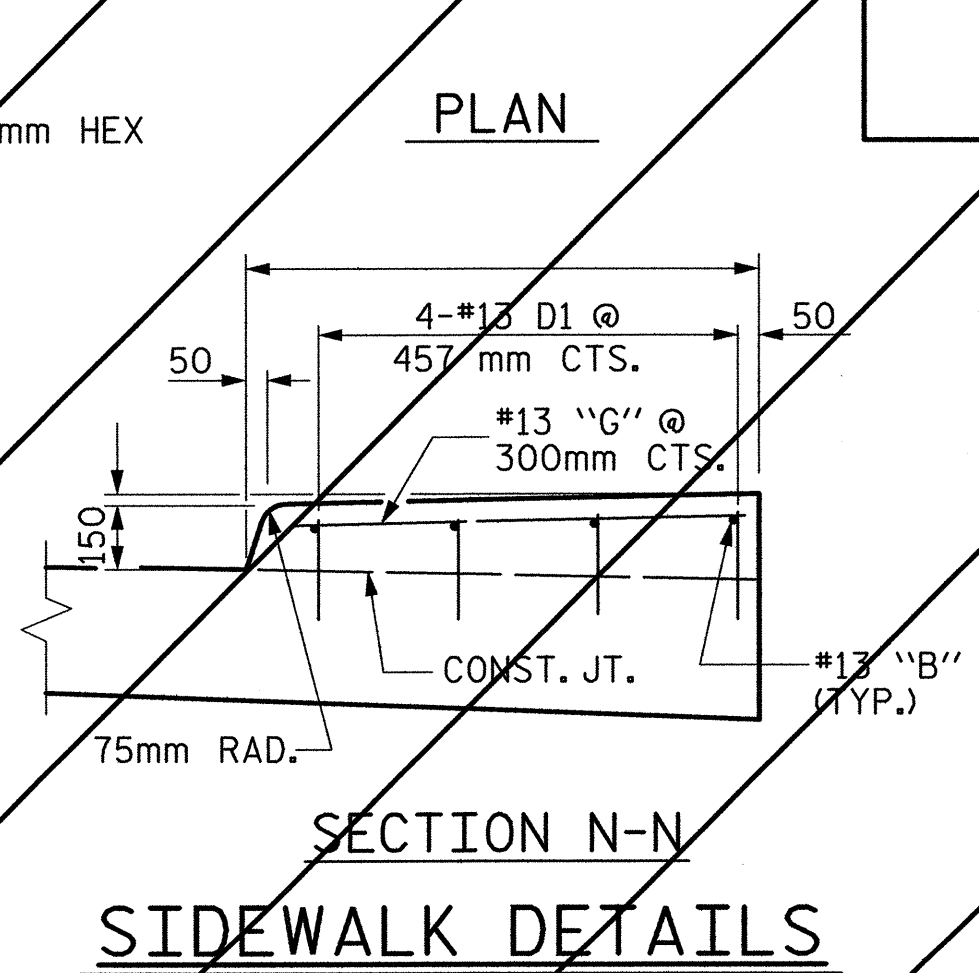

PROJECT NO. R-2552C
JOHNSTON COUNTY
STATION: 109+56.000 -L2LT- POT

SHEET 4 OF 4

STATE OF NORTH CAROLINA DEPARTMENT OF TRANSPORTATION RALEIGH		STANDARD BRIDGE APPROACH SLAB DETAILS (LEFT LANE) STD. NO. BAS10SM		SHEET NO. S-225 TOTAL SHEETS 431	
REVISIONS					
NO.	BY:	DATE:	NO.	BY:	DATE:
1			3		
2			4		

THIS STANDARD DRAWING REVIEWED & ADOPTED FOR USE AT THE REFERENCED LOCATION BY THE UNDERSIGNED:

PLANS PREPARED BY:
MULKEY
ENGINEERS & CONSULTANTS
PO BOX 33127
RALEIGH, N.C. 27636
(919) 851-1911
(919) 851-1918 (FAX)
WWW.MULKEYINC.COM

SEAL
14116
ENGINEER
ROBERT C. LARSON
2/1/05

REFERENCE NO. BL-42

02/21/2005 04:08:27 PM G:\Projects\2004\2552C\DRG-2552C\Structures\51re\1\Leff.Lone\RP2552C-SD-AS-04.dgn

ASSEMBLED BY: W. B. ALLEN DATE: 10/04
CHECKED BY: R. C. LARSON DATE: 1/05
DRAWN BY: FCJ 11/88 REV. 8/16/99 RAL/LES
CHECKED BY: ARB 11/88 REV. 10/17/00 RWW/LES
REV. 5/17/03 RWW/JTE