

BENCH MARK: #BL-5 BL STA. 118+72.347  
 144.943m RT.  
 ELEV. 69.536 NGVD 1929

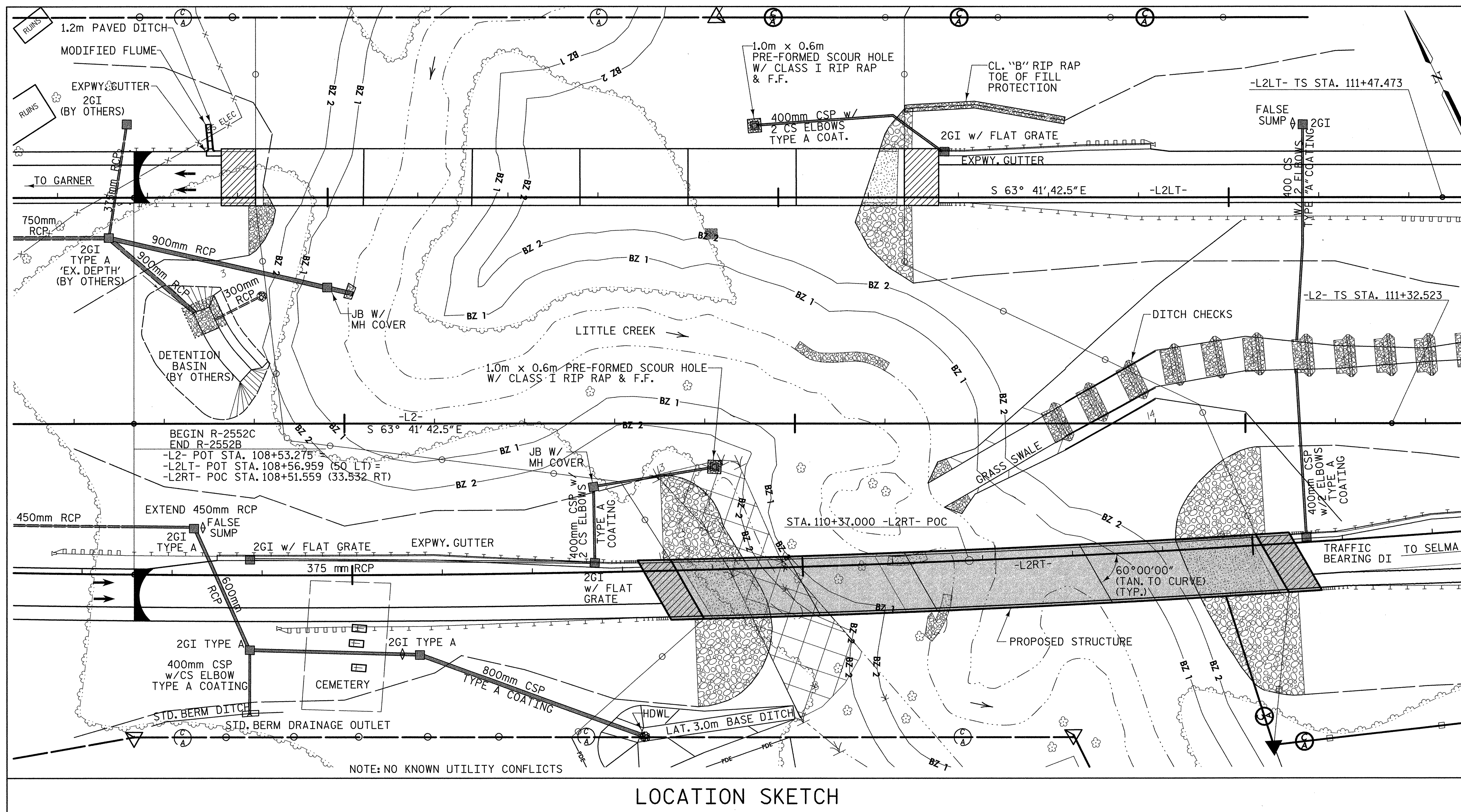

LOCATION SKETCH



PROJECT NO. R-2552C  
 JOHNSTON COUNTY  
 STATION: 110+37.000 -L2RT- POC

SHEET 4 OF 5

STATE OF NORTH CAROLINA  
 DEPARTMENT OF TRANSPORTATION  
 RALEIGH

GENERAL DRAWING FOR  
 BRIDGE ON US 70 BYPASS OVER  
 LITTLE CREEK  
 BETWEEN GARNER AND SELMA  
 (RIGHT LANE)

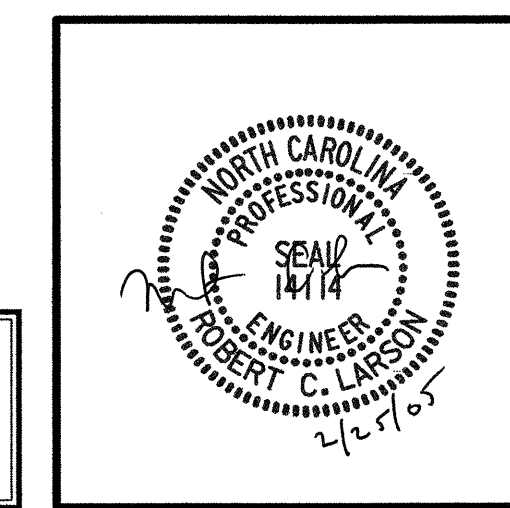

REVISIONS				SHEET NO.	
NO.	BY:	DATE:	NO.	BY:	DATE:
1			3		
2			4		

TOTAL SHEETS: 431

REFERENCE NO. BR-4

02/21/2005 07:43:26 AM G:\p\proj\2004\212\01R-2552AS\Structures\Site\Right\Lane\R2552C-SD\_02.dgn

DRAWN BY: W. B. ALLEN DATE: 6/04  
 CHECKED BY: R. C. LARSON DATE: 7/04