

CONST. REV.
R / W REV.

PROJECT REFERENCE NO. R-2552C	SHEET NO. 34
ROADWAY DESIGN ENGINEER	HYDRAULICS ENGINEER

BEGIN PROP. -L2- FOR GRADE
 -L2- STA 126+50.000 =
 -L2- STA 126+37.900 - 10.9m (L) =
 -L2- STA 126+80.325 (10.9m) H.S.
 FINISHED ELEV. = 91.47

PIPE HYDRAULIC DATA	
DRAINAGE STRUCTURE NO. 80	
DRAINAGE AREA	= 31 HA
DESIGN FREQUENCY	= 50 YRS
DESIGN DISCHARGE	= 31 CMS
DESIGN HW ELEVATION	= 87.58 M
100 YEAR DISCHARGE	= 3.6 CMS
100 YEAR HW ELEVATION	= 87.69 M
OVERTOPPING FREQUENCY	= 500 YRS
OVERTOPPING DISCHARGE	= 6.0 CMS
OVERTOPPING ELEVATION	= 89.00 M

PI = 127+14.997
 EL = 90.774 m
 VC = 90 m
 K = 124

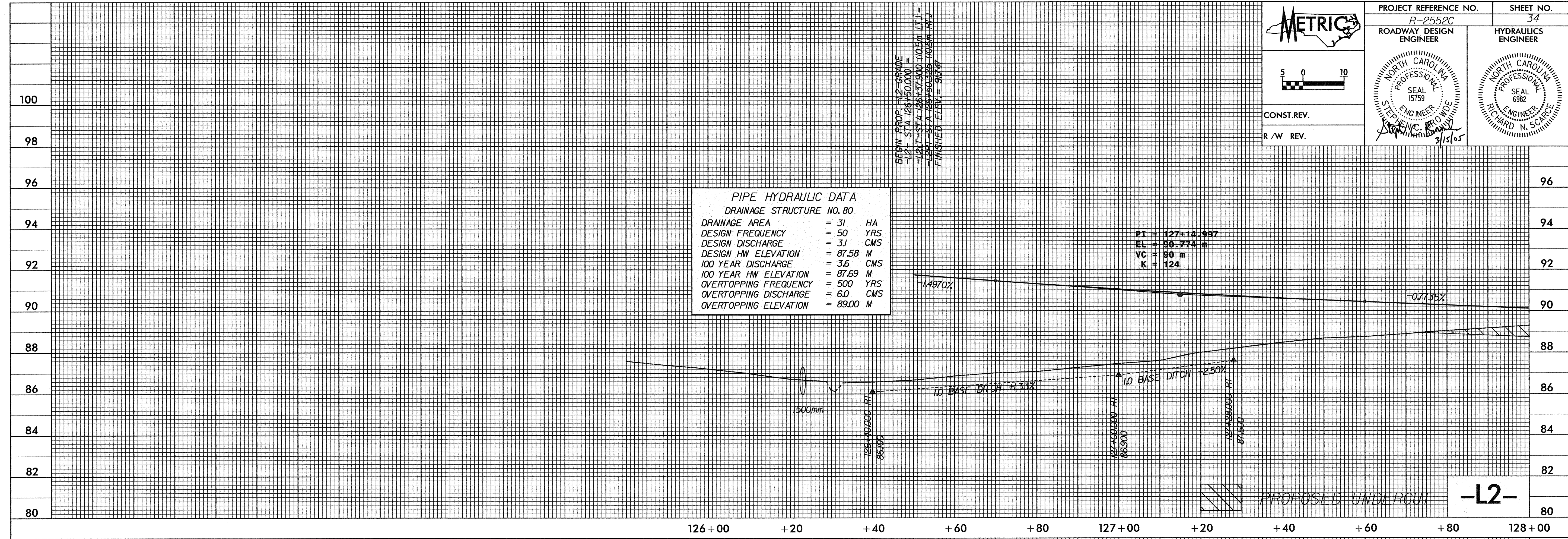

DM#BL-7 RR SPIKE DRIVEN VERICALLY
 IN BASE OF 10' HOLLY TREE
 BL STA 135 = 85.578
 120.089 RT
 ELEV. = 85.921
 N 205482.4659
 E 660854.7846

PI = 130+40.000
 EL = 88.260 m
 VC = 100 m
 K = 176

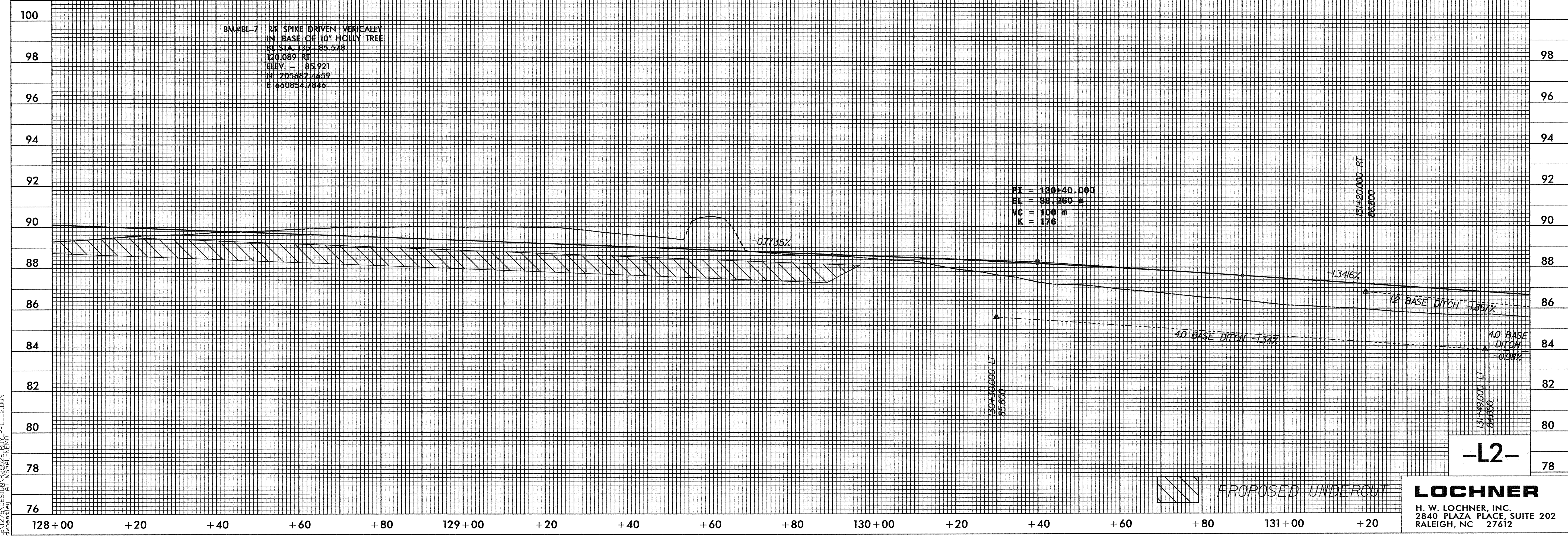

17-MAR-2005 09:51
 W:\125\DESIGN\2552C-ARDY-PFL-L2.DGN
 shreestou

LOCHNER
 H. W. LOCHNER, INC.
 2840 PLAZA PLACE, SUITE 202
 RALEIGH, NC 27612