

	PROJECT REFERENCE NO.	SHEET NO.
	R-2552B	12
	R / W SHEET NO.	
	ROADWAY DESIGN ENGINEER	HYDRAULICS ENGINEER
	CONST. REV.	
R / W REV.		

NOTE: SOIL STABILIZATION FABRIC SHALL BE USED IN LIEU OF UNDERCUT AT -L- STA. 83+00 +/- TO 85+40 +/-

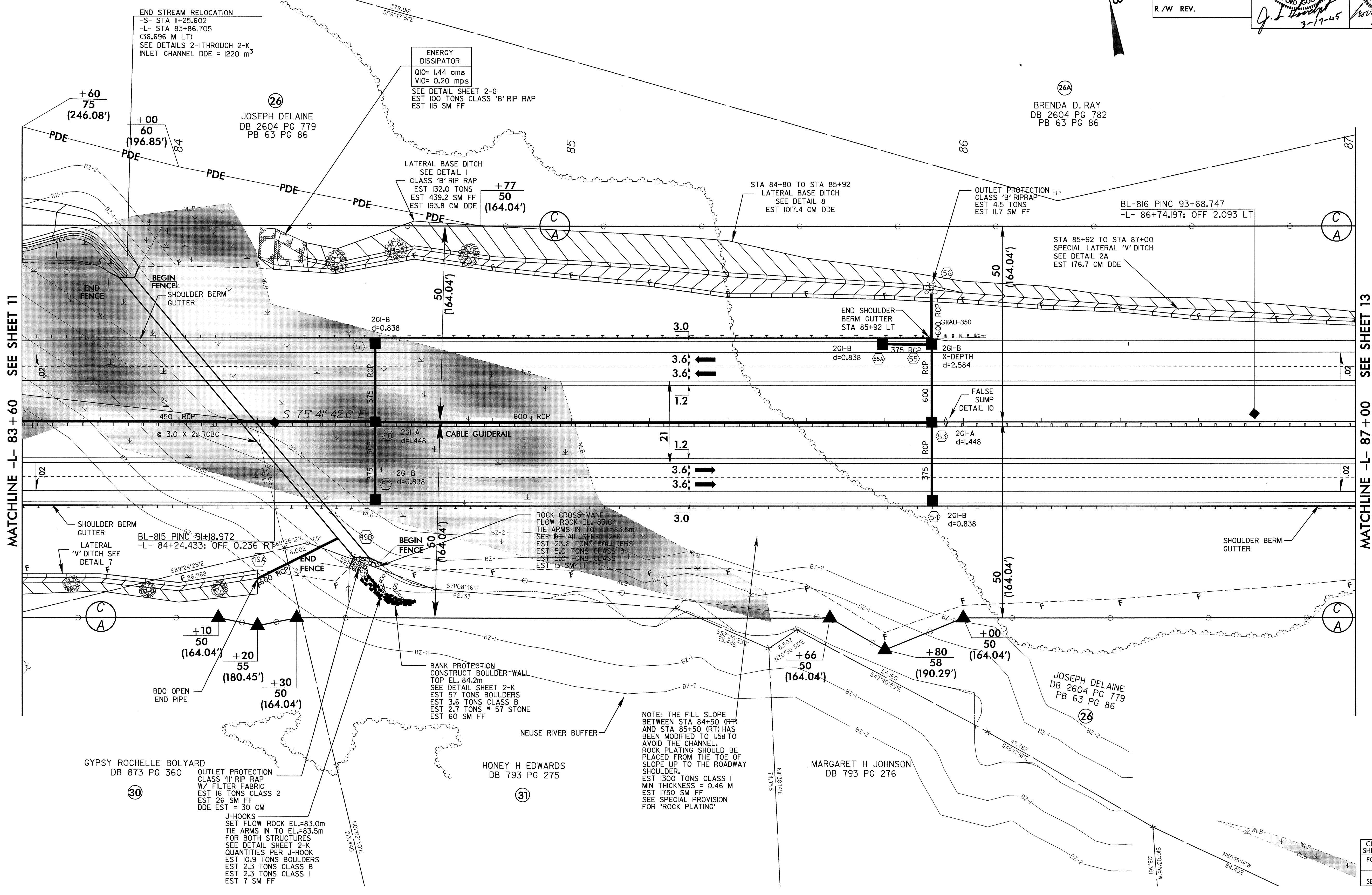

MATCHLINE -L- 83+60 SEE SHEET 11

MATCHLINE -L- 87+00 SEE SHEET 13

REVISIONS

ID-MAR-2005 10:01 2552B12.pah
MBL@schworth

CULVERT DETAILS SEE SHEETS C-1 THRU C-16
FOR DITCH DETAILS SEE SHEET 2-F
-L- ALIGNMENT SEE PROFILE 29 & 30