

N 500  
N 600  
N 700  
N 800  
N 900  
N 1000  
N 1100  
N 1200  
N 1300  
N 1400  
N 1500  
N 1600  
N 1700  
N 1800  
N 1900  
N 2000

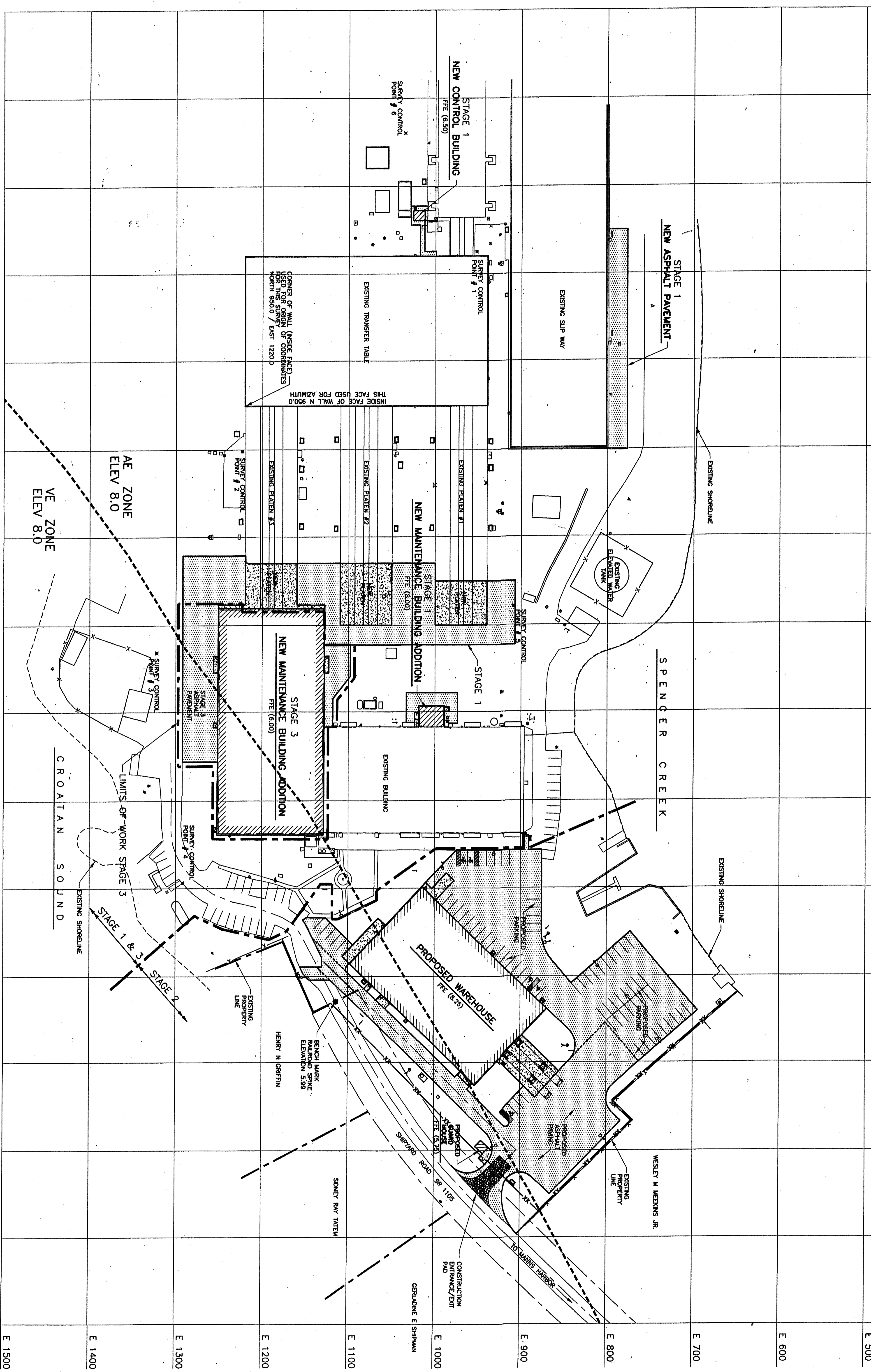

STATIONARY CONTROL POINTS

POINT	NORTHING	EASTING	ELEVATION	DESCRIPTION
1	774,931.8	952,295.2	5.81	WAG NAIL / TAG
2	1002,040.2	1223,766.3	5.99	WAG NAIL / TAG
3	1231,107.1	1322,289.0	5.52	WAG NAIL / TAG
4	1483,795.0	1291,972.0	6.80	WAG NAIL / TAG
5	1178,692.7	1008,722.8	3.44	WAG NAIL / TAG
6	659,499.0	1052,020.0	3.99	WAG NAIL / TAG

NOTE: THE CORNER OF WALL (INSIDE FACE) IS USED FOR AZIMUTH. THE CORNER OF WALL (INSIDE FACE) IS USED FOR COORDINATES. THIS FACE IS USED FOR AZIMUTH. INSIDE FACE OF WALL N 950.0 NORTH 850.0 EAST 1200.0

- GENERAL NOTES:**
- FOR LEGEND, ABBREVIATIONS AND GENERAL NOTES, SEE DRAWING C-701.
  - PARKING SUMMARY: STANDARD SPACES 73, HANDICAPPED SPACES 2, SPACES RELIEVED STANDARD SPACES 2.
  - TOTAL SPACES AFTER CONSTRUCTION: 104.
  - FEWA FLOOD ZONES TAKEN FROM DADE COUNTY PANEL 310 OF 800 COMMUNITY PANEL NUMBER 5735460310C. THIS DRAWING SHALL BE CONSIDERED PRELIMINARY - NOT FOR CONSTRUCTION UNLESS PROPERLY SIGNED AND SEALED.

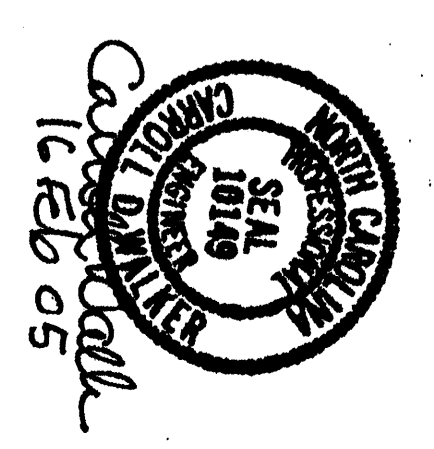
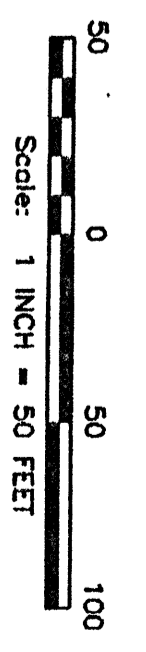

NO.	DATE	DESCRIPTION
0	16-FEB-2005	ISSUED FOR BID/CONSTRUCTION - STAGE 1 PACKAGE

DESIGNED BY	CHKD BY
H.M. SWEAT	C.D. WALKER

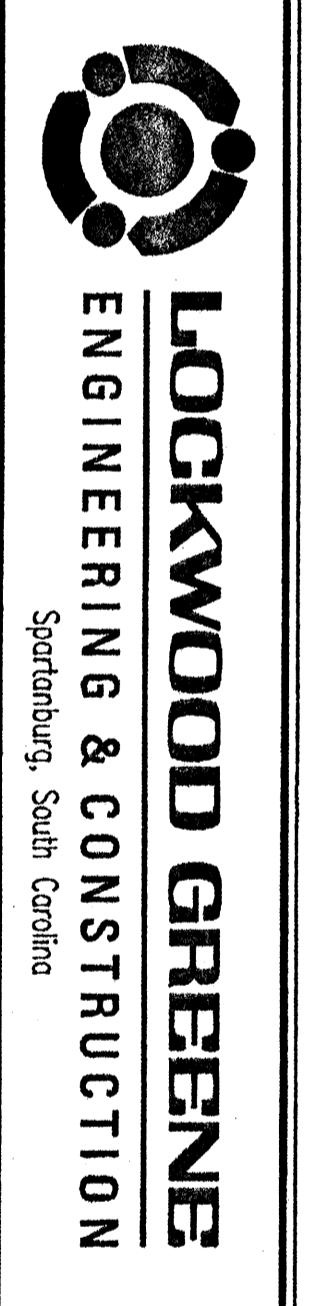

**LOCKWOOD GREENE**  
ENGINEERING & CONSTRUCTION  
Spartanburg, South Carolina

PHASE VII  
MARINE MAINTENANCE FACILITY  
NORTH CAROLINA DEPARTMENT OF TRANSPORTATION  
MANN'S HARBOR, NC

PROJECT NO.	019094.02
DATE	0
SCALE	1"=50'
DWG. NO.	C-702