

7/2/99

**NOTE:**  
PERIMETER EROSION CONTROL MEASURES SHALL BE INSTALLED DURING CLEARING AND GRUBBING PHASE.

**NOTE:**  
TEMPORARY SILT FENCE SHALL BE INSTALLED A MINIMUM OF 3 FEET FROM TOE OF FILL IN WETLAND AREAS.

**NOTE:**

1. NCDOT HAS AGREED TO THE SPECIAL COMMITMENT THAT NO IN-WATER WORK WILL BE CONDUCTED BETWEEN MARCH 31 AND SEPTEMBER 30 IN ORDER TO AVOID NEGATIVE IMPACTS TO SPawning POPULATIONS OF FISH SPECIES AT THIS PROJECT SITE.
2. SEE SHEET 2 FOR ROCK PLATING DETAIL.
3. SEE SHEET 28 FOR UNDERCUT LIMITS AND DETAIL.
4. ANY RELOCATION OF EXISTING UTILITIES WILL BE ACCOMPLISHED BY OTHERS.
5. UNDERCUT LIMITS SHOULD NOT EXTEND BEYOND THE PROJECT TEMPORARY CONSTRUCTION EASEMENT LIMITS.

PROJECT REFERENCE NO. B-3445		SHEET NO. EC-3'CONST.4	
RW SHEET NO.		HYDRAULICS ENGINEER	
ROADWAY DESIGN ENGINEER			

UNITED STATES DEPARTMENT OF THE INTERIOR  
FISH AND WILDLIFE SERVICE  
DB 96 PG 228  
MB 2 PG41

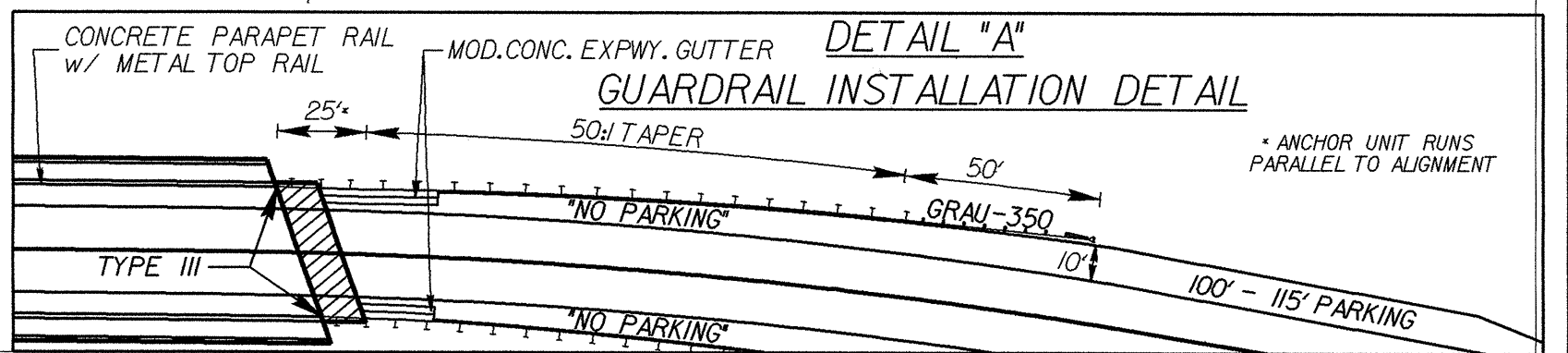
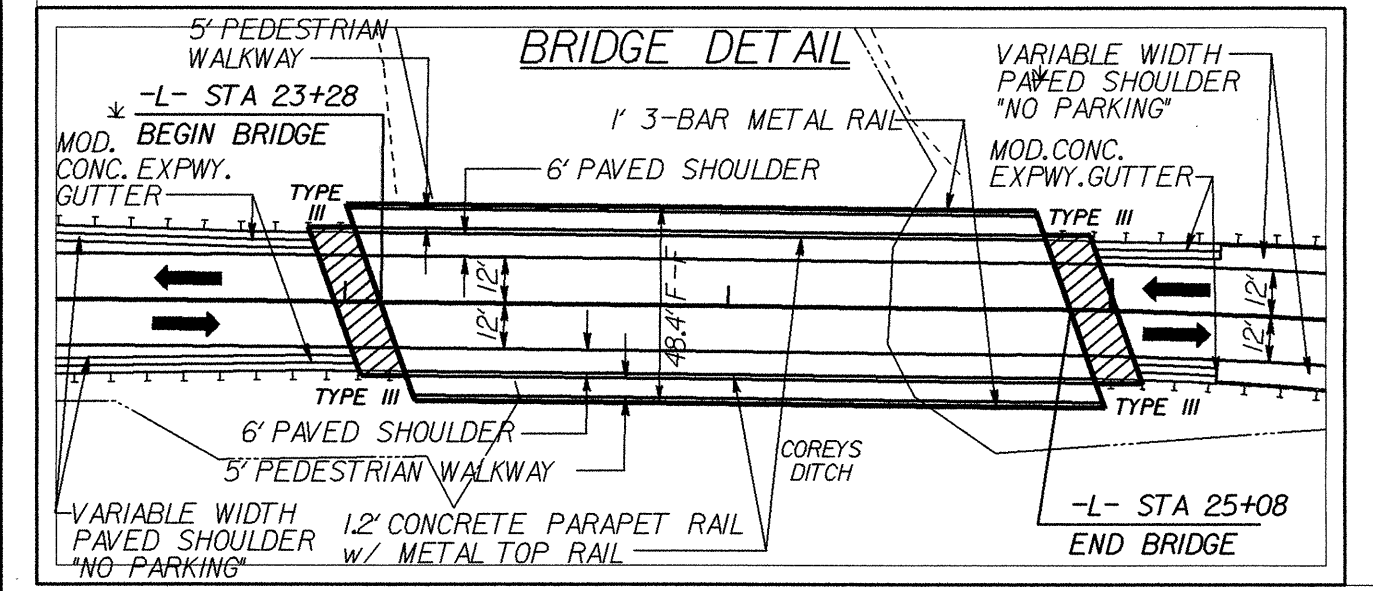
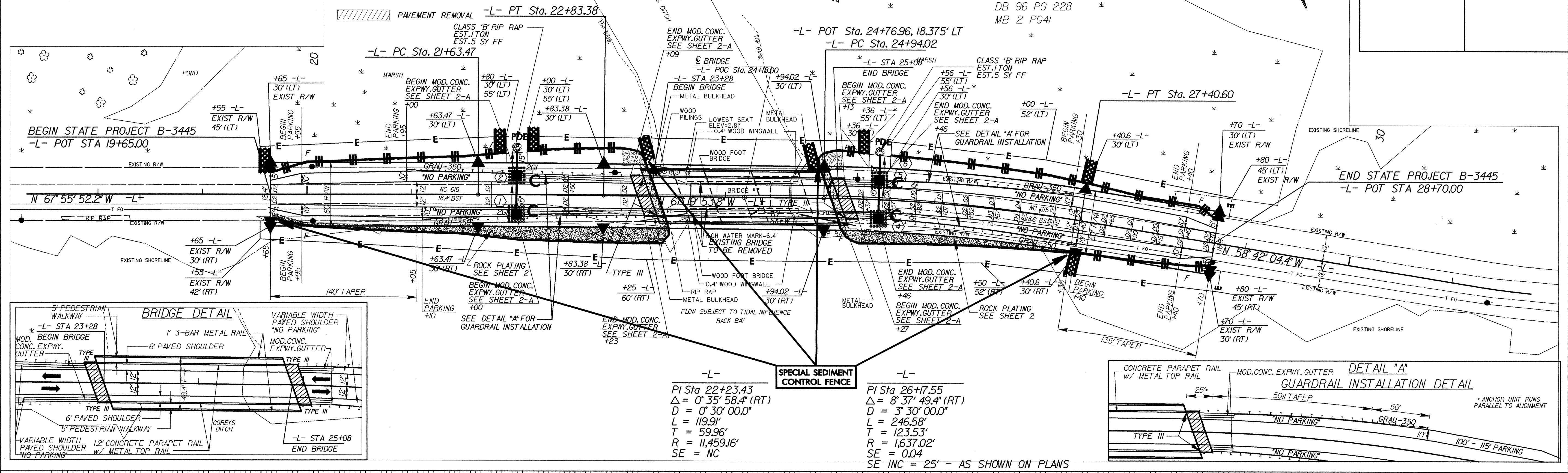

**SPECIAL SEDIMENT CONTROL FENCE**

**PI Sta 22+23.43**  
 $\Delta = 0^\circ 35' 58.4''$  (RT)  
 $D = 0^\circ 30' 00.0''$   
 $L = 119.91'$   
 $T = 59.96'$   
 $R = 11,459.16'$   
 $SE = NC$

**PI Sta 26+17.55**  
 $\Delta = 8^\circ 37' 49.4''$  (RT)  
 $D = 3^\circ 30' 00.0''$   
 $L = 246.58'$   
 $T = 123.53'$   
 $R = 1,637.02'$   
 $SE = 0.04$   
 $SE INC = 25' - AS SHOWN ON PLANS$

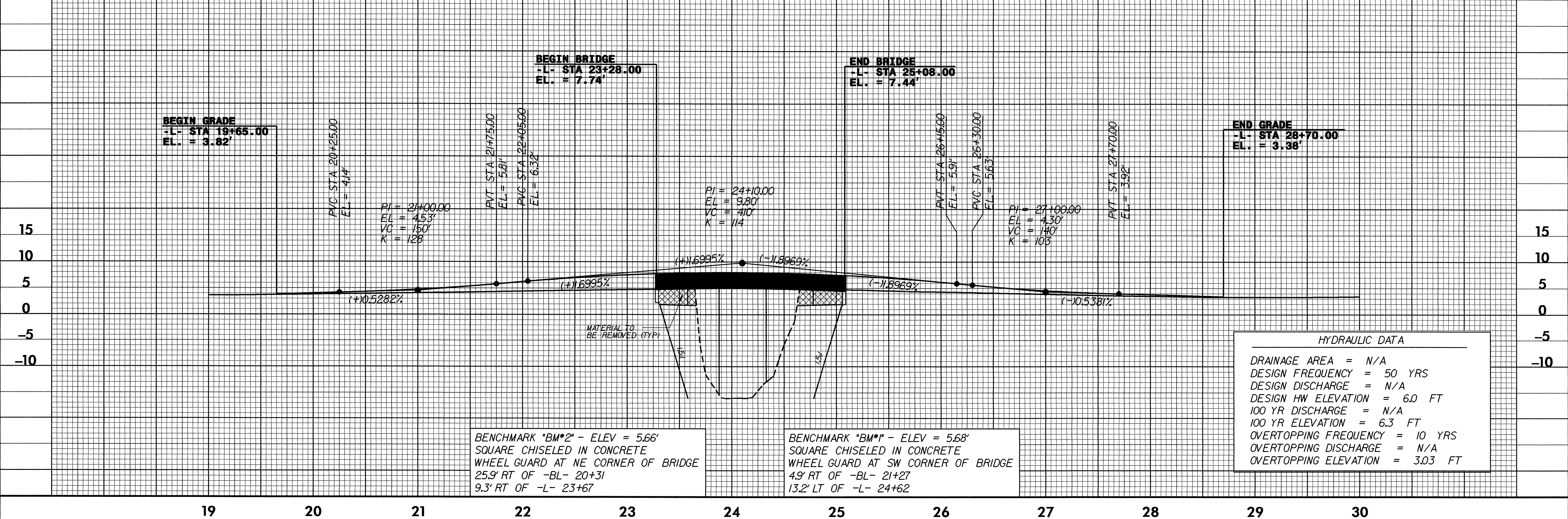

**HYDRAULIC DATA**

DRAINAGE AREA	= N/A
DESIGN FREQUENCY	= 50 YRS
DESIGN DISCHARGE	= N/A
DESIGN HW ELEVATION	= 6.0 FT
100 YR DISCHARGE	= N/A
100 YR ELEVATION	= 6.3 FT
OVERTOPPING FREQUENCY	= 10 YRS
OVERTOPPING DISCHARGE	= N/A
OVERTOPPING ELEVATION	= 3.03 FT

\$\$\$\$\$USERNAME\$\$\$\$\$