

See Sheet 1-A For Index of Sheets  
See Sheet 1-B For Conventional Symbols

STATE OF NORTH CAROLINA  
DIVISION OF HIGHWAYS

**ASHE COUNTY**

LOCATION: **BRIDGE NO. 113 OVER SOUTH FORK NEW RIVER  
ON SR 1179**

TYPE OF WORK: **GRADING, DRAINAGE, PAVING AND STRUCTURE**

STATE	STATE PROJECT REFERENCE NO.	SHEET NO.	TOTAL SHEETS
N.C.	B-2905	2A	14
STATE PROJ. NO.	F.A. PROJ. NO.	DESCRIPTION	
8.2711301	BRZ-1179(1)	PE	

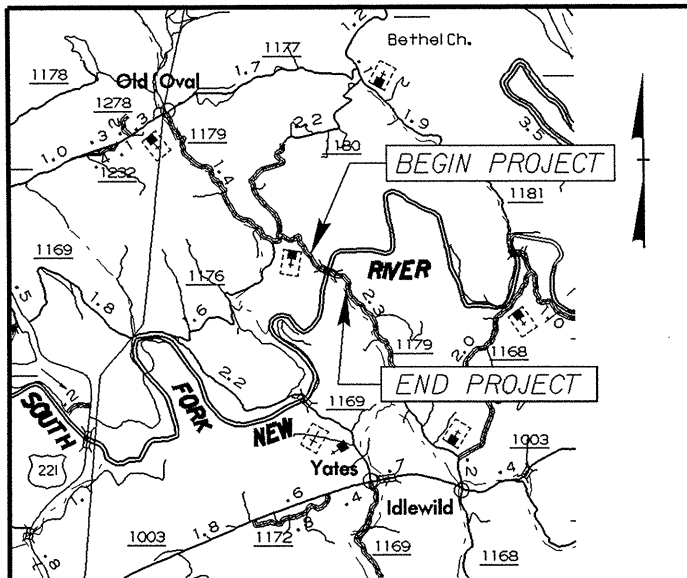

VICINITY MAP

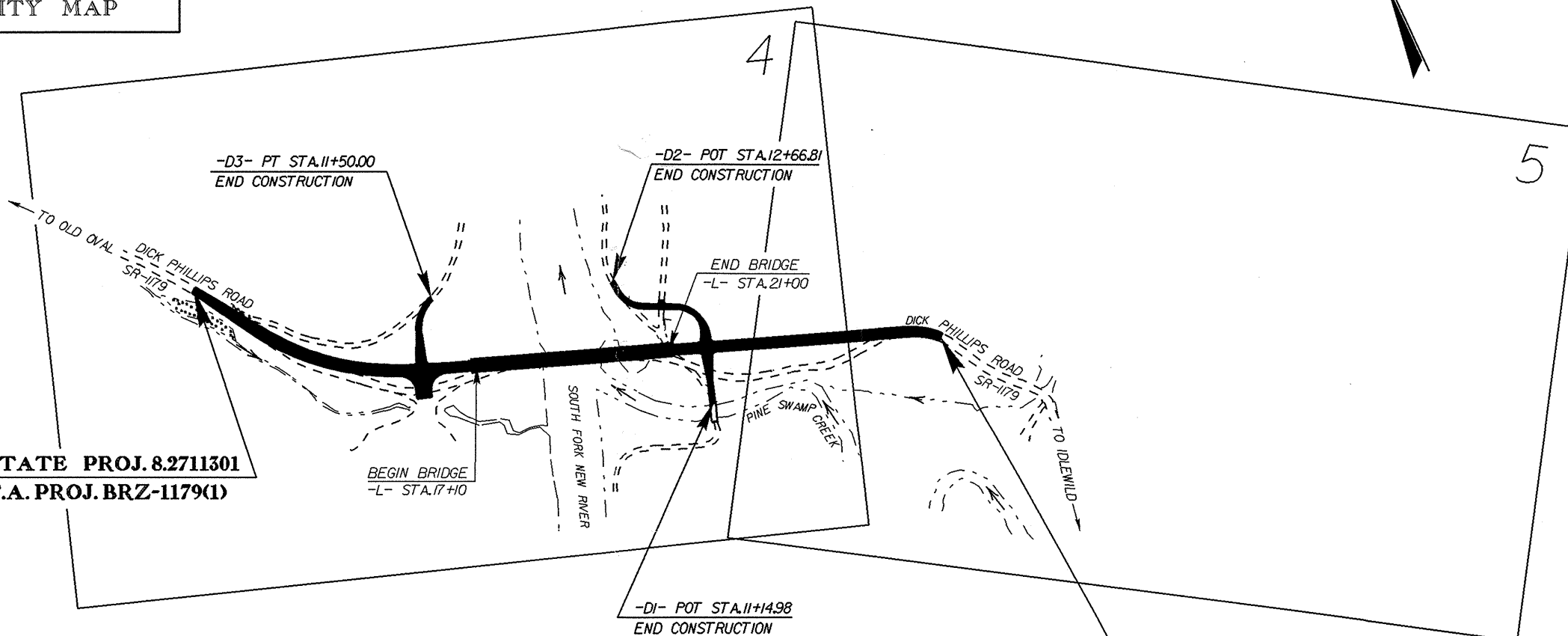
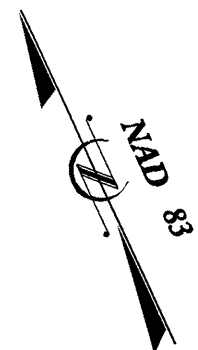

-L- STA. 11+00 BEGIN STATE PROJ. 8.2711301  
-L- STA. 11+00 BEGIN F.A. PROJ. BRZ-1179(1)

-L- STA. 26+50 END STATE PROJ. 8.2711301  
-L- STA. 26+50 END F.A. PROJ. BRZ-1179(1)

NOTE: CLEARING ON THIS PROJECT SHALL BE PERFORMED TO THE LIMITS ESTABLISHED BY METHOD II.

**PROJECT: 8.2711301 B-2905**

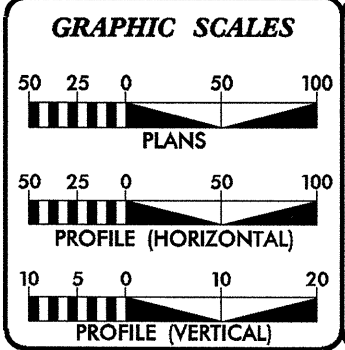

**DESIGN DATA**

ADT 1999 = 222	-----
ADT 2020 = 300	-----
DHV = 10 %	
D = 60 %	
T = 3 % *	
V = 30 MPH **	

\*\* DESIGN EXCEPTION REQ'D.  
\* TTST .1% DUAL .2%

**PROJECT LENGTH**

LENGTH ROADWAY F.A. PROJ. BRZ-1179(1) = 0.220 mile
LENGTH STRUCTURE F.A. PROJ. BRZ-1179(1) = 0.074 mile
TOTAL LENGTH STATE PROJECT 8.2711301 = 0.294 mile

Prepared in the Office of:  
**DIVISION OF HIGHWAYS**  
1000 Birch Ridge Dr.  
Raleigh, NC 27610

1995 STANDARD SPECIFICATIONS

RIGHT OF WAY DATE: DECEMBER 17, 1999	DEWAYNE L. SYKES, P.E. PROJECT ENGINEER
LETTING DATE: DECEMBER 20, 2000	MICHAEL W. LITTLE, P.E. PROJECT DESIGN ENGINEER

**HYDRAULICS ENGINEER**

SIGNATURE: \_\_\_\_\_ P.E.

ROADWAY DESIGN ENGINEER

PRELIMINARY PLANS  
DO NOT USE FOR CONSTRUCTION

INCOMPLETE PLANS  
DO NOT USE FOR CONSTRUCTION

SIGNATURE: \_\_\_\_\_ P.E.

**DIVISION OF HIGHWAYS  
STATE OF NORTH CAROLINA**

STATE DESIGN ENGINEER P.E.

DEPARTMENT OF TRANSPORTATION  
FEDERAL HIGHWAY ADMINISTRATION

APPROVED  
DIVISION ADMINISTRATOR DATE