

**CONTRACT: C201202 T.I.P. PROJECT: B-3922**

See Sheet 1-A For Index of Sheets  
See Sheet 1-B For Conventional Symbols

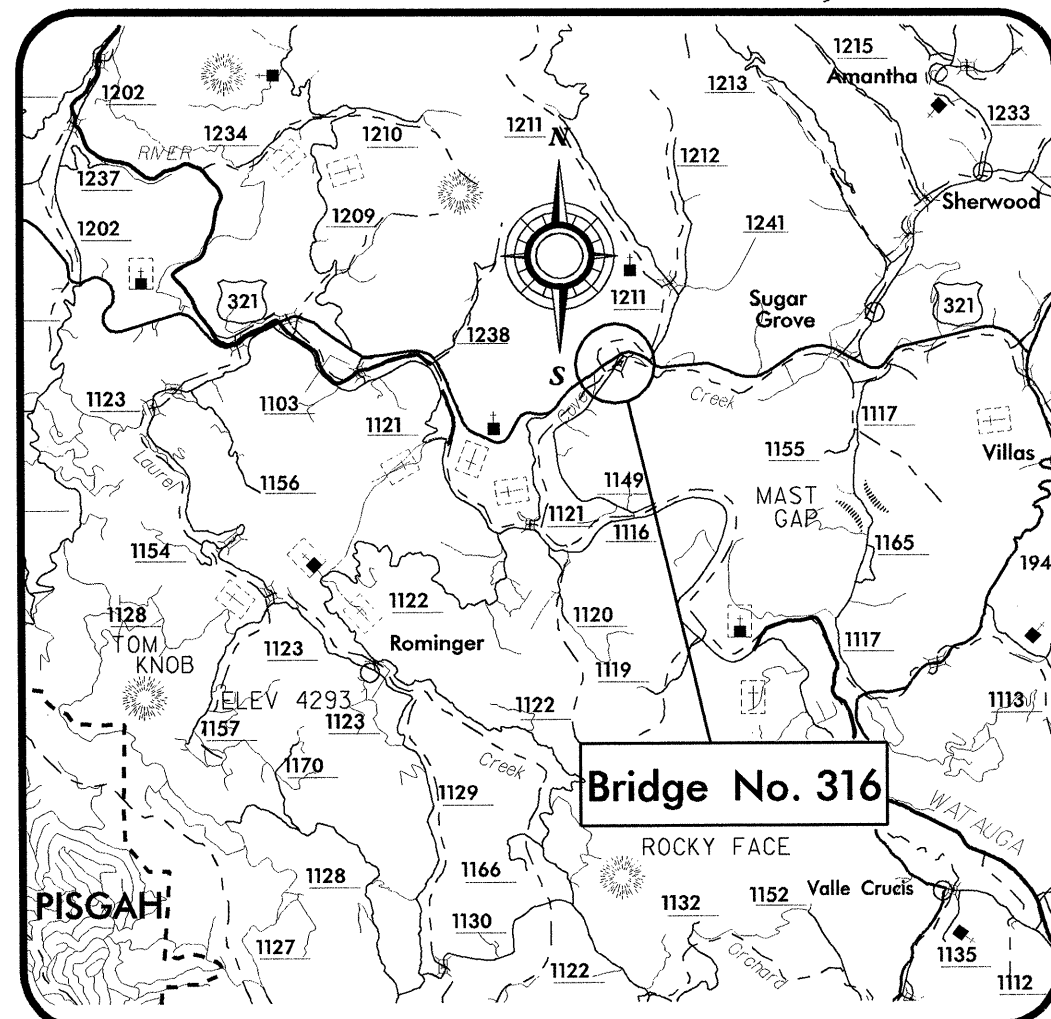

**VICINITY MAP**

STATE OF NORTH CAROLINA  
DIVISION OF HIGHWAYS

**WATAUGA COUNTY**

**LOCATION:** Bridge No. 316 over Cove Creek  
on SR 1149 (Howard Edmisten Road)

**TYPE OF WORK:** GRADING, PAVING, DRAINAGE & STRUCTURE

STATE	STATE PROJECT REFERENCE NO.	SHEET NO.	TOTAL SHEETS
N.C.	B-3922	1	
STATE PROJ. NO.	F. A. PROJ. NO.	DESCRIPTION	
33356.1.1	BRZ-1149(3)	PE	
33356.2.2	BRZ-1149(3)	RW, UTIL.	
33356.3.1	BRZ-1149(3)	CONSTRUCTION	

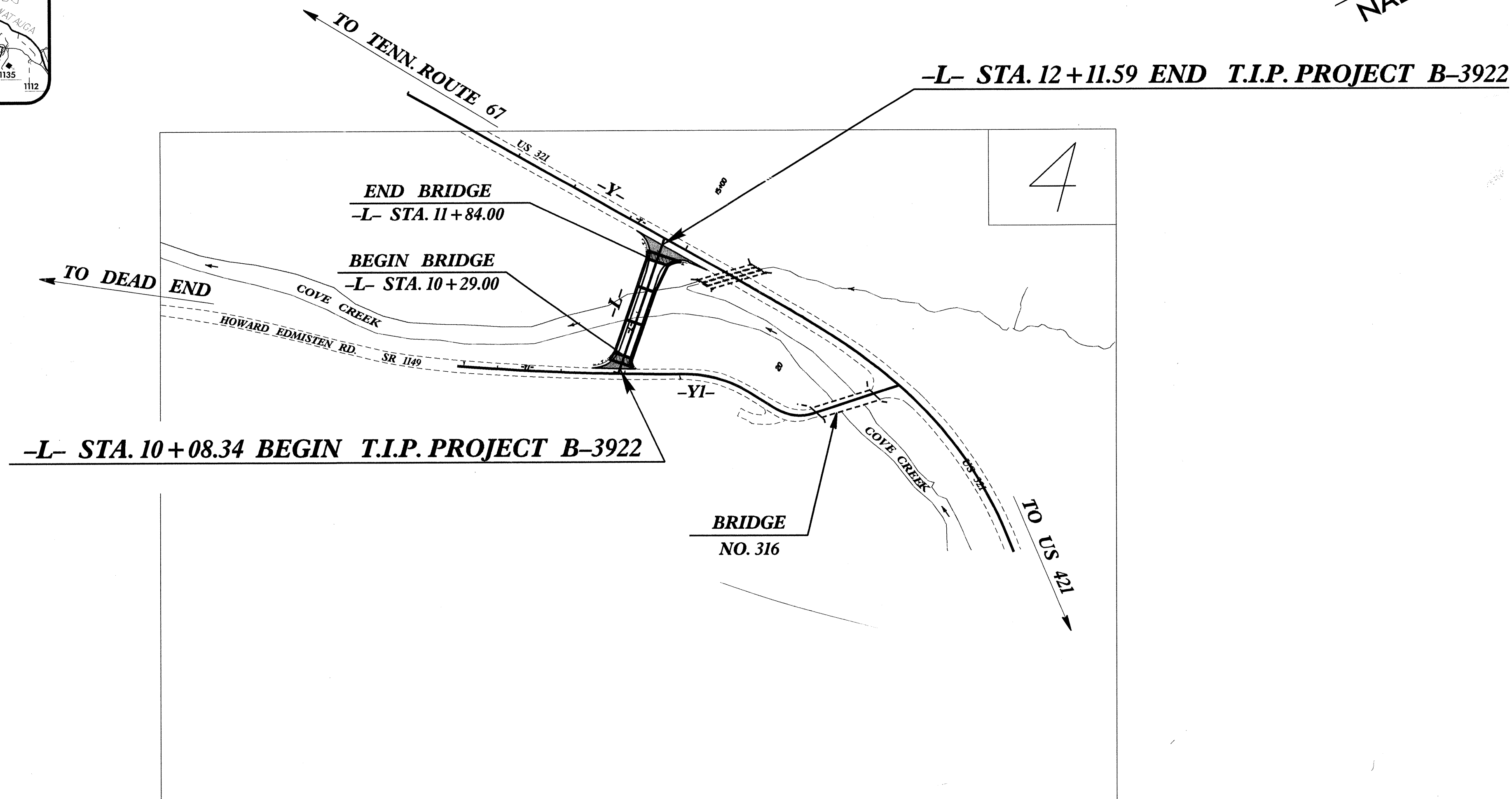
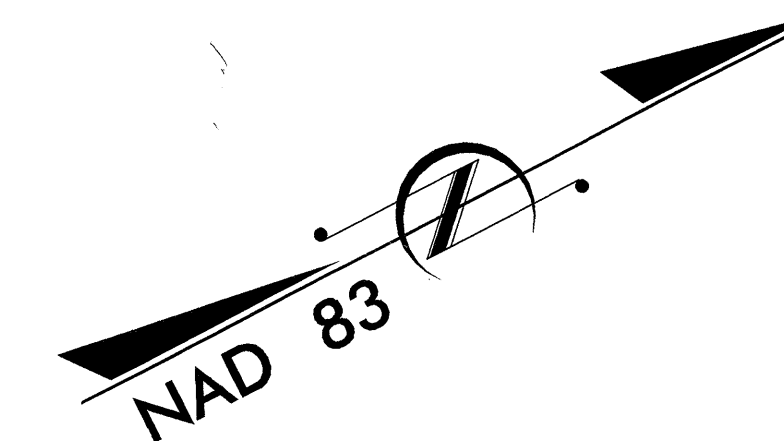

**GRAPHIC SCALES**

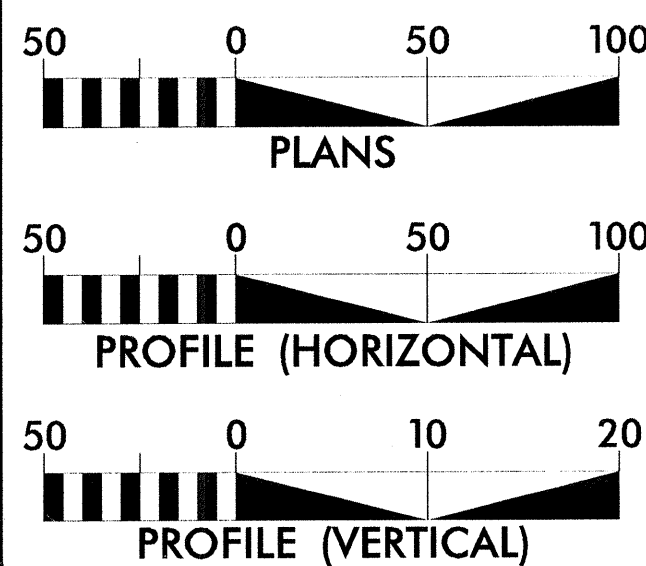

**DESIGN DATA**

ADT 2005 = 340  
ADT 2025 = 600  
DHV = 15 %  
D = 60 %  
\* T = 3 %  
V = 30 MPH  
\* (1 % TTST & 2 % DUAL)

**PROJECT LENGTH**

Length Roadway T.I.P. Project B-3922 ..... 0.009 mi.  
Length Structure T.I.P. Project B-3922 ..... 0.029 mi.  
TOTAL LENGTH T.I.P. Project B-3922 ..... 0.038 mi.



PLANS PREPARED BY :  
RUMMEL, KLEPPER & KAHL, LLP  
consulting engineers  
5800 FARINGDON PLACE, SUITE 105  
RALEIGH, NORTH CAROLINA 27609  
(919) 876-9560  
FOR

2002 STANDARD SPECIFICATIONS  
RIGHT OF WAY DATE:  
April 27, 2004  
LETTING DATE:  
April 19, 2005

Michael T. Merritt, P.E.  
PROJECT ENGINEER  
Ana M. Passman, P.E.  
PROJECT DESIGN ENGINEER

NCDOT CONTACT: Teresa Bruton, P.E.  
Project Engineer-Roadway Design

**HYDRAULICS ENGINEER**

*[Signature]*  
SIGNATURE: ANA M. PASSMAN  
1/18/05

**ROADWAY DESIGN ENGINEER**

*[Signature]*  
SIGNATURE: ANA M. PASSMAN  
1/18/05

**DIVISION OF HIGHWAYS  
STATE OF NORTH CAROLINA**

*[Signature]*  
STATE DESIGN ENGINEER

DEPARTMENT OF TRANSPORTATION  
FEDERAL HIGHWAY ADMINISTRATION

APPROVED  
DIVISION ADMINISTRATOR  
DATE