

END VIEW

2" MIN. CONCRETE COVER FROM END OF CAP REQUIRED FOR ALL #4U1 AND #4U2 BARS.

#4U1 AND #4U2 BARS MAY BE SHIFTED UP TO 2" TO CLEAR "B" BARS.

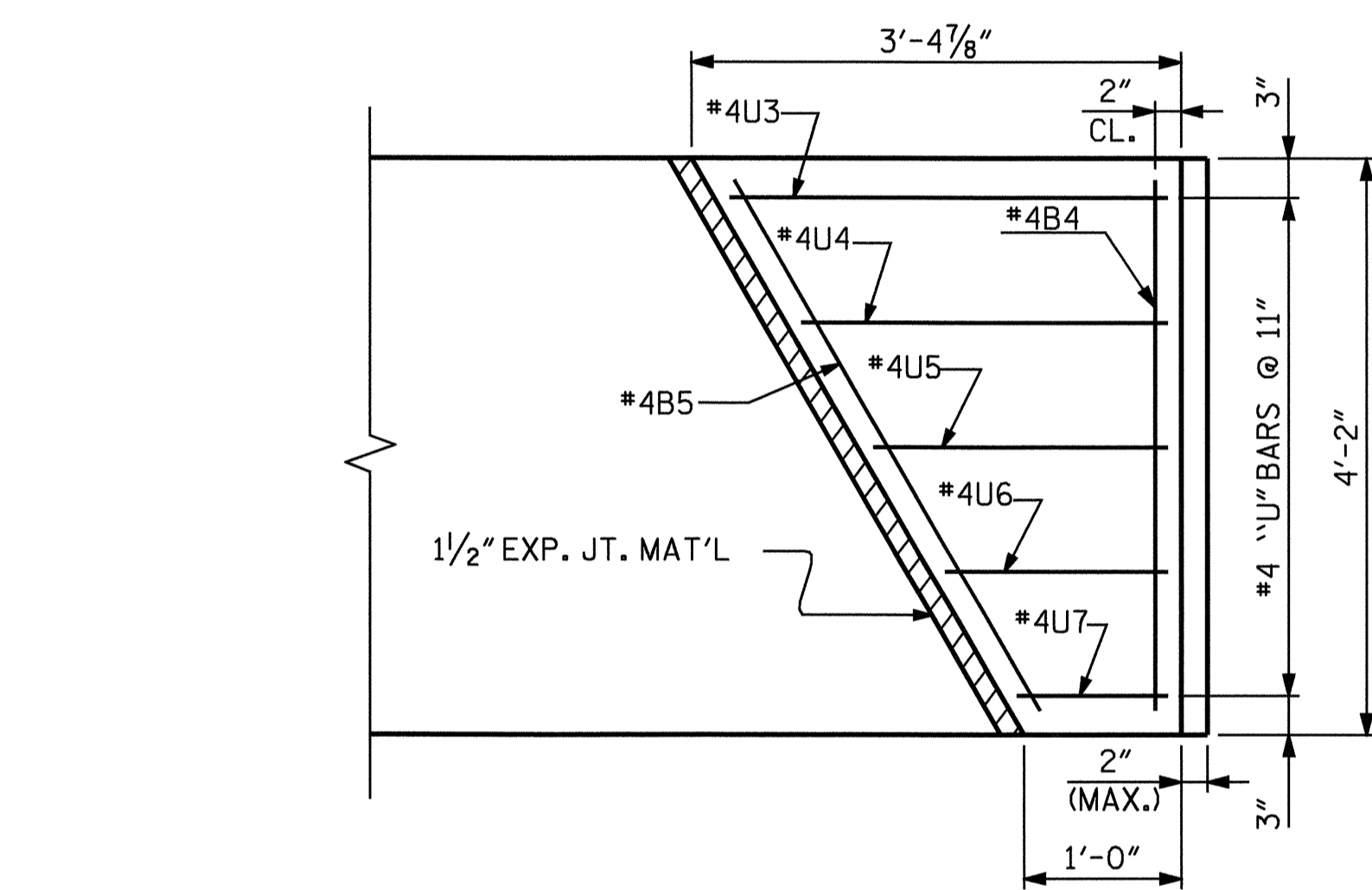

LATERAL GUIDE DETAIL

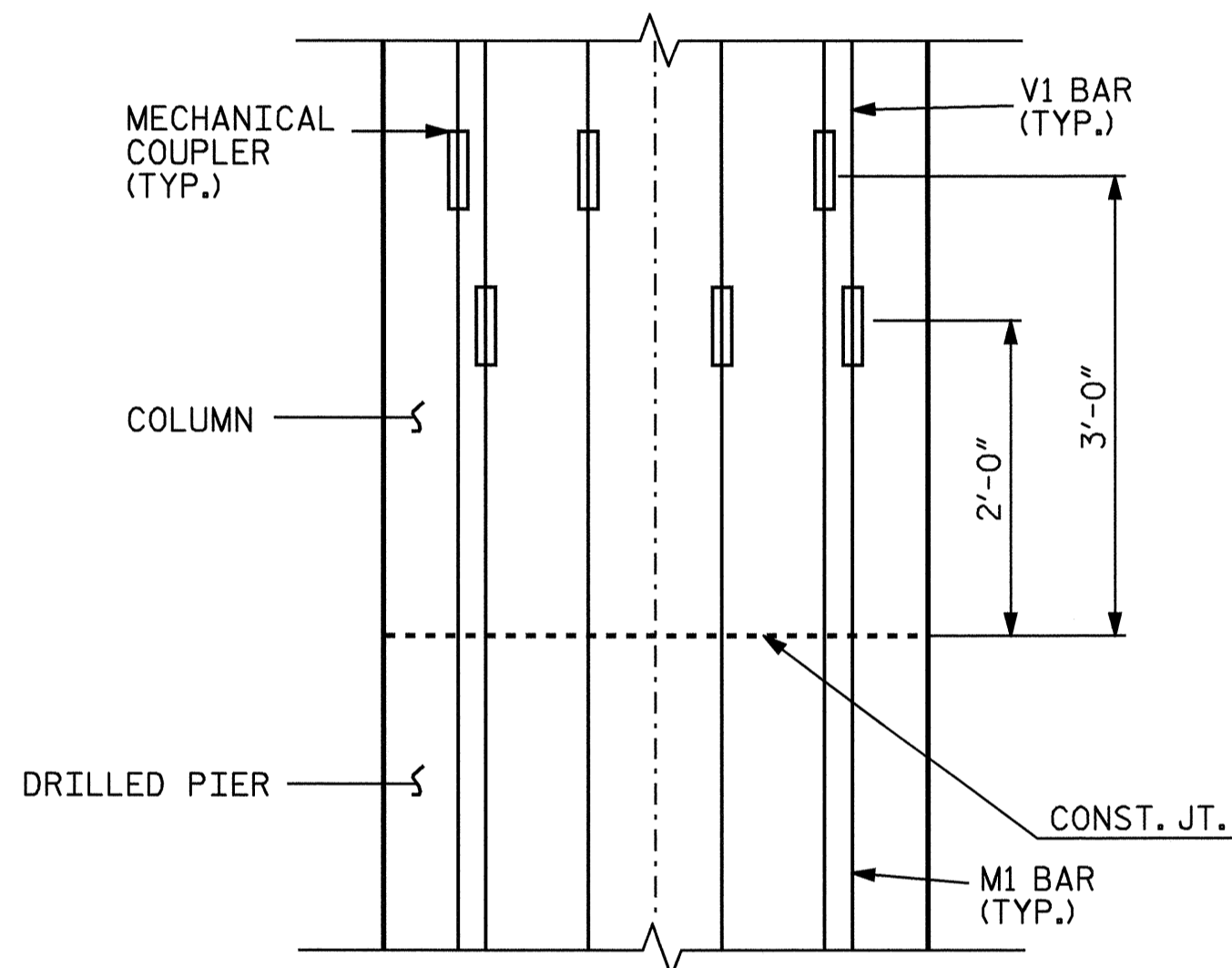

DETAIL 'A'

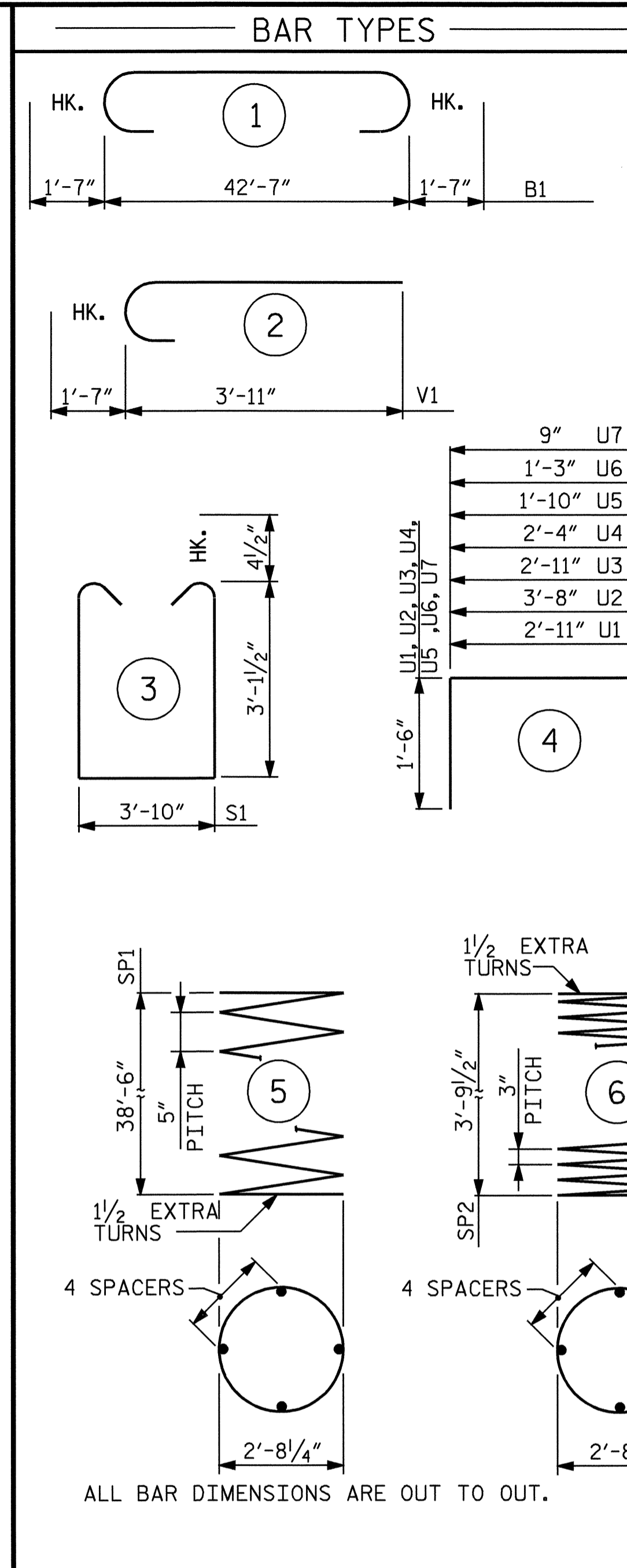

ALL BAR DIMENSIONS ARE OUT TO OUT.

BILL OF MATERIAL

BENT #2

BAR	NO.	SIZE	TYPE	LENGTH	WEIGHT
B1	6	#9	1	45'-9"	933
B2	4	#5	STR.	42'-9"	178
B3	6	#9	STR.	42'-9"	872
B4	2	#4	STR.	3'-10"	5
B5	2	#4	STR.	4'-5"	6
D1	44	#6	STR.	1'-6"	99
M1	33	#9	STR.	44'-6"	4993
S1	56	#4	3	10'-10"	405
U1	6	#4	4	5'-11"	24
U2	6	#4	4	6'-8"	27
U3	2	#4	4	5'-11"	8
U4	2	#4	4	5'-4"	7
U5	2	#4	4	4'-10"	6
U6	2	#4	4	4'-3"	6
U7	2	#4	4	3'-9"	5
V1	33	#9	2	5'-6"	617
REINFORCING STEEL (LBS.)					8191
SP-1	3	*	5	793'-3"	2482
SP-2	3	**	6	140'-3"	281
SPIRAL REINFORCING STEEL (LBS.)					2763

CLASS A CONCRETE		
POUR #2 (COLUMNS)		4.1 C.Y.
POUR #3 (CAP)		23.3 C.Y.
POUR #4 (LATERAL GUIDES)		0.3 C.Y.
TOTAL		27.7 C.Y.

DRILLED PIERS

DRILLED PIER CONCRETE (CU. YARDS)	
POUR #1 (DRILLED PIERS)	41.7 C.Y.
3'-6" Ø DRILLED PIERS IN SOIL	99 FT.
3'-6" Ø DRILLED PIERS NOT IN SOIL	18 FT.
SPT TESTING	2 EACH
SID INSPECTION	2 EACH
CROSSHOLE SONIC LOGGING	1 EACH
CSL TUBES	498 FT.

* THE SP-1 SPIRAL REINFORCING STEEL SHALL BE W31 OR D-31 COLD DRAWN WIRE OR #5 PLAIN OR DEFORMED BAR.

** THE SP-2 SPIRAL REINFORCING STEEL SHALL BE W20 OR D-20 COLD DRAWN WIRE OR #4 PLAIN OR DEFORMED BAR.

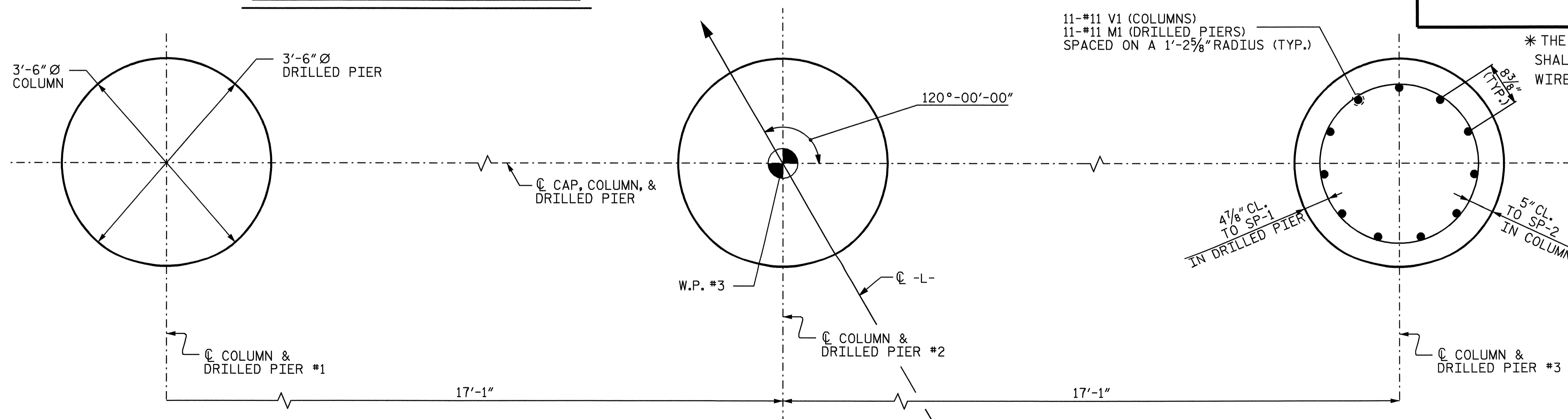

PLAN OF COLUMNS AND DRILLED PIERS

ALL COLUMNS AND DRILLED PIERS ARE IDENTICAL

DRAWN BY: A. COLE DATE: 12/20/04
 CHECKED BY: A. SORSENGINH DATE: 1/4/05

07-MAR-2005 08:50
 W:\squad\ABASIC\B4260\acole\Microstation\B-4260_sd_B*.01.dgn
 adavenport

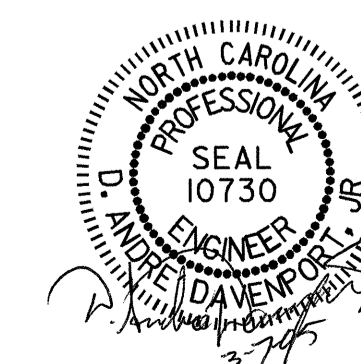

PROJECT NO. B-4260
 RUTHERFORD COUNTY
 STATION: 16+23.47 -L-

SHEET 2 OF 2

STATE OF NORTH CAROLINA
 DEPARTMENT OF TRANSPORTATION
 RALEIGH

SUBSTRUCTURE
 BENT #2

REVISIONS						SHEET NO.	
NO.	BY:	DATE:	NO.	BY:	DATE:	S-15	
1			3			TOTAL SHEETS 22	
2			4				