

KCI Associates of North Carolina, P.A.
 RALEIGH OFFICE
 ENGINEERS • PLANNERS • ECOLOGISTS
 SUITE 200, LANDMARK CENTER I
 4601 SIX FORKS RD.
 RALEIGH, N.C. 27609-5210
 (919) 783-9214

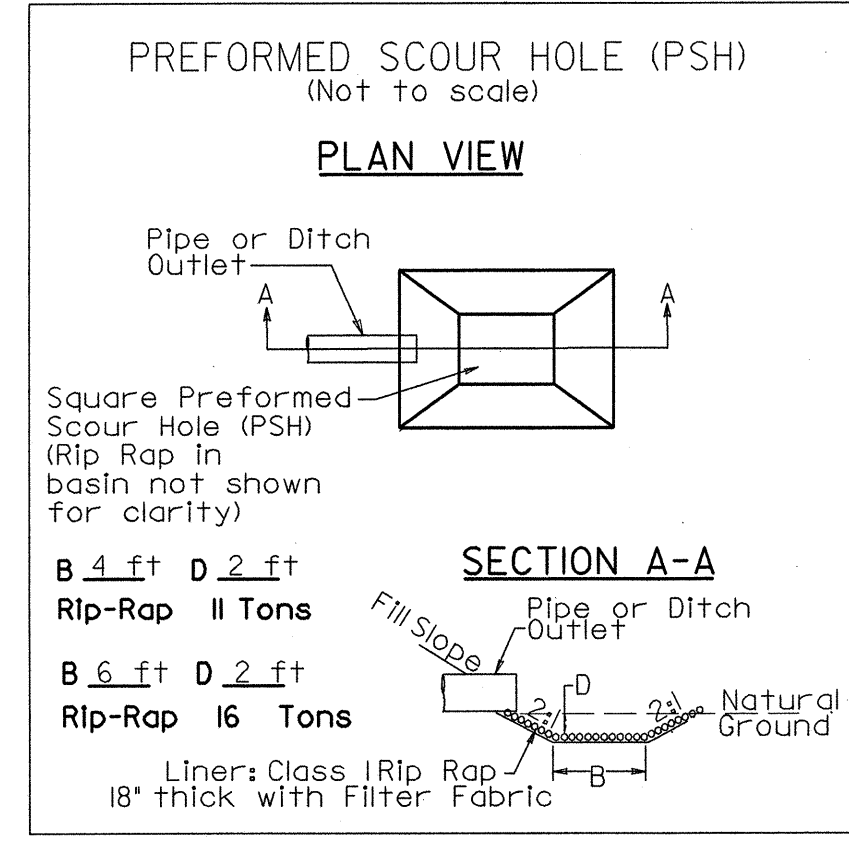

STATION 13+30 LT.
 STATION 15+57 LT.

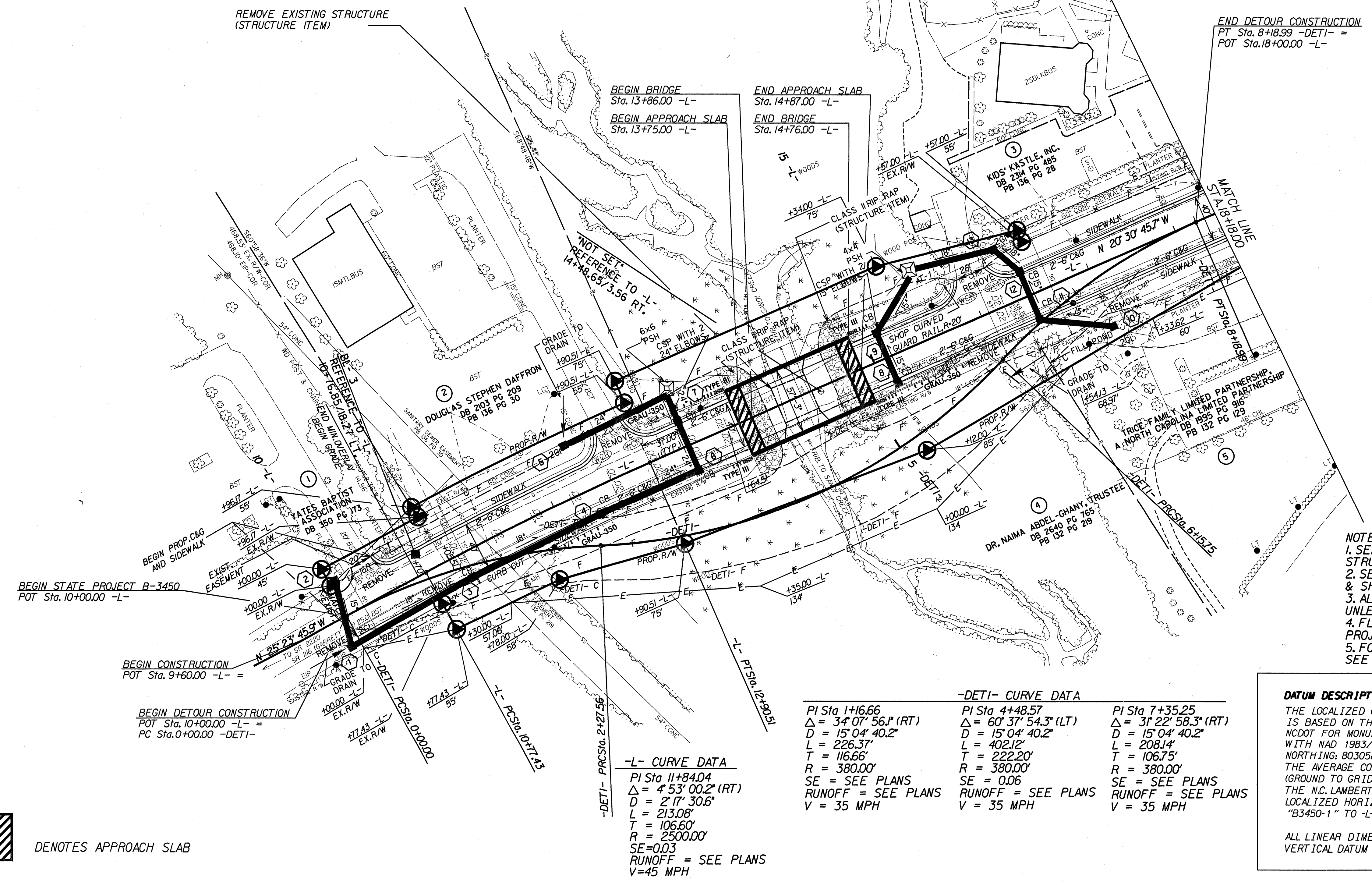
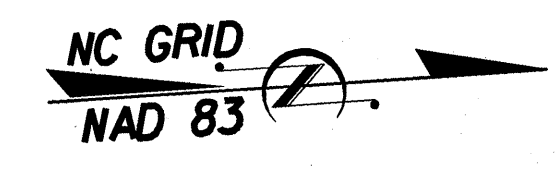
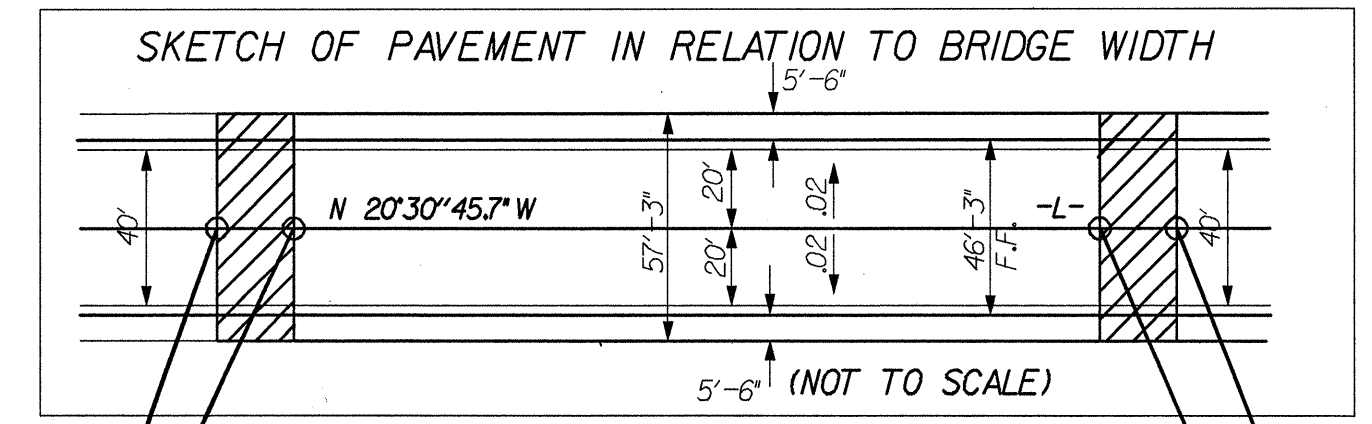

-L- CURVE DATA

PI Sta 11+84.04
 $\Delta = 4' 53'' 00.2''$ (RT)
 D = 2' 17' 30.6"
 L = 213.08'
 T = 106.60'
 R = 2500.00'
 SE = 0.03
 RUNOFF = SEE PLANS
 V = 45 MPH

-DETI- CURVE DATA

PI Sta 1+16.66 $\Delta = 34' 07'' 56.1''$ (RT) D = 15' 04' 40.2" L = 226.37' T = 116.66' R = 380.00' SE = SEE PLANS RUNOFF = SEE PLANS V = 35 MPH	PI Sta 4+48.57 $\Delta = 60' 37'' 54.3''$ (LT) D = 15' 04' 40.2" L = 402.12' T = 222.20' R = 380.00' SE = 0.06 RUNOFF = SEE PLANS V = 35 MPH	PI Sta 7+35.25 $\Delta = 31' 22'' 58.3''$ (RT) D = 15' 04' 40.2" L = 208.14' T = 106.75' R = 380.00' SE = SEE PLANS RUNOFF = SEE PLANS V = 35 MPH
---	--	---

NOTES:

- SEE SHEETS S-1 THRU S-24 FOR STRUCTURE PLANS.
- SEE SHEET 6 FOR -L- GRADE & PROFILE & SHEET 7 FOR -DETI- GRADE & PROFILE.
- ALL PROPOSED DRIVEWAY RADII 25 FT UNLESS OTHERWISE SHOWN.
- FLAT GRATES TO BE USED ON ENTIRE PROJECT.
- FOR ACCURATE APPROACH SLAB LOCATIONS SEE STRUCTURE PLAN SHEETS S-23 AND S-24.

DATUM DESCRIPTION

THE LOCALIZED COORDINATE SYSTEM DEVELOPED FOR THIS PROJECT IS BASED ON THE STATE PLANE COORDINATES ESTABLISHED BY NCDOT FOR MONUMENT "B3450-1" WITH NAD 1983/95 STATE PLANE GRID COORDINATES OF NORTHING: 803058.6063(11) EASTING: 2007856.2841(11) THE AVERAGE COMBINED GRID FACTOR USED ON THIS PROJECT (GROUND TO GRID) IS: 0.99994845

THE N.C. LAMBERT GRID BEARING AND LOCALIZED HORIZONTAL DISTANCE FROM "B3450-1" TO -L- STATION 10+00.00 IS N 20°11'06" W, 968.50'

ALL LINEAR DIMENSIONS ARE LOCALIZED HORIZONTAL DISTANCES VERTICAL DATUM USED IS NAVD 88



REVISIONS