

CONTRACT: C201456 TIP PROJECT: B-3808

STATE OF NORTH CAROLINA
DIVISION OF HIGHWAYS

AVERY COUNTY

**LOCATION: BRIDGE NO. 58 OVER HENSON CREEK
ON SR 1126 (HENSON CREEK ROAD)**

TYPE OF WORK: PAVING, GRADING, DRAINAGE, AND STRUCTURE

STATE	STATE PROJECT REFERENCE NO.	SHEET NO.	TOTAL SHEETS
N.C.	B-3808		
STATE PROJ. NO.	F.A. PROJ. NO.	DESCRIPTION	
33263.1.1	BRZ-1126(2)	PE	
33263.2.1	BRZ-1126(2)	RW, UTL	
33263.3.2	BRZ-1126(4)	CONST	

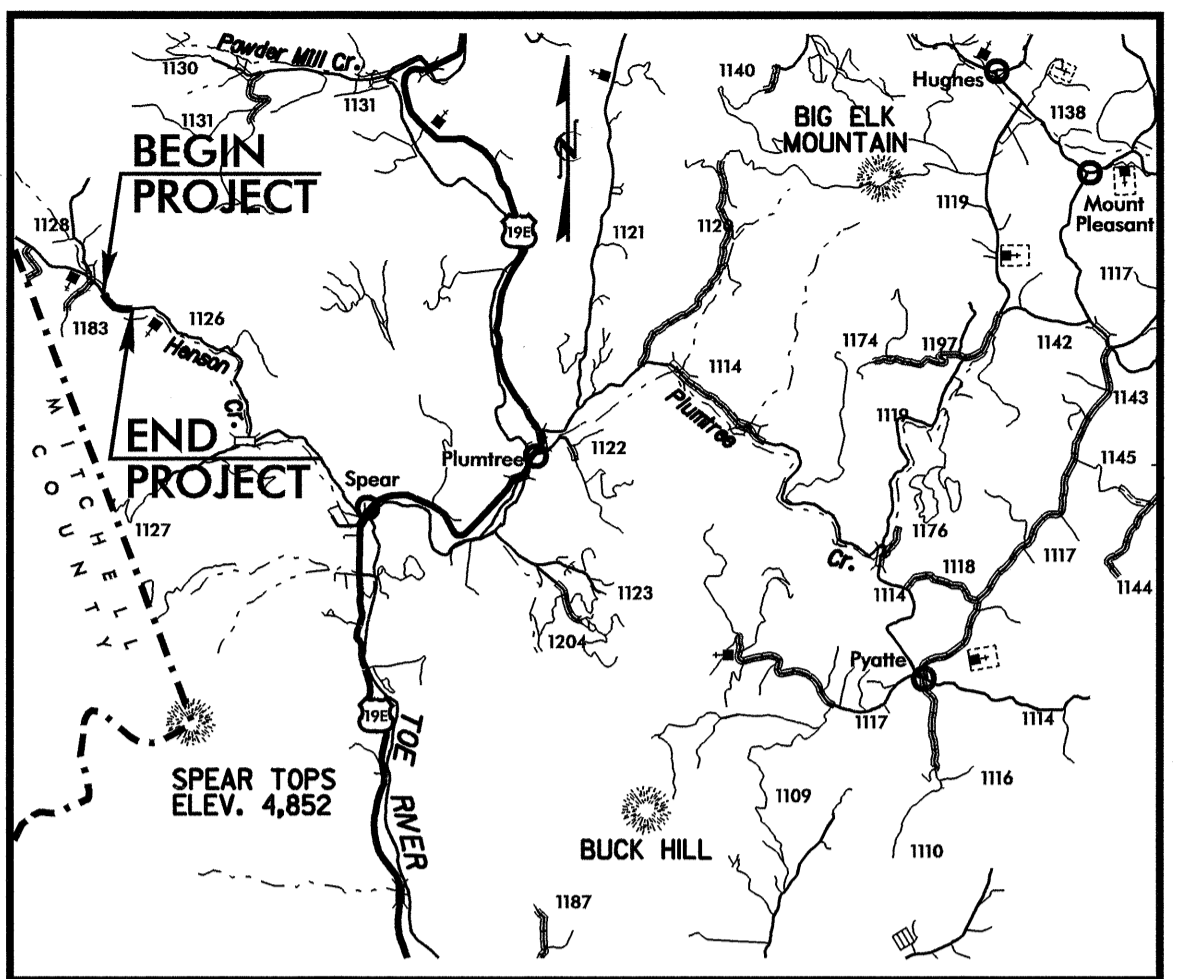

VICINITY MAP

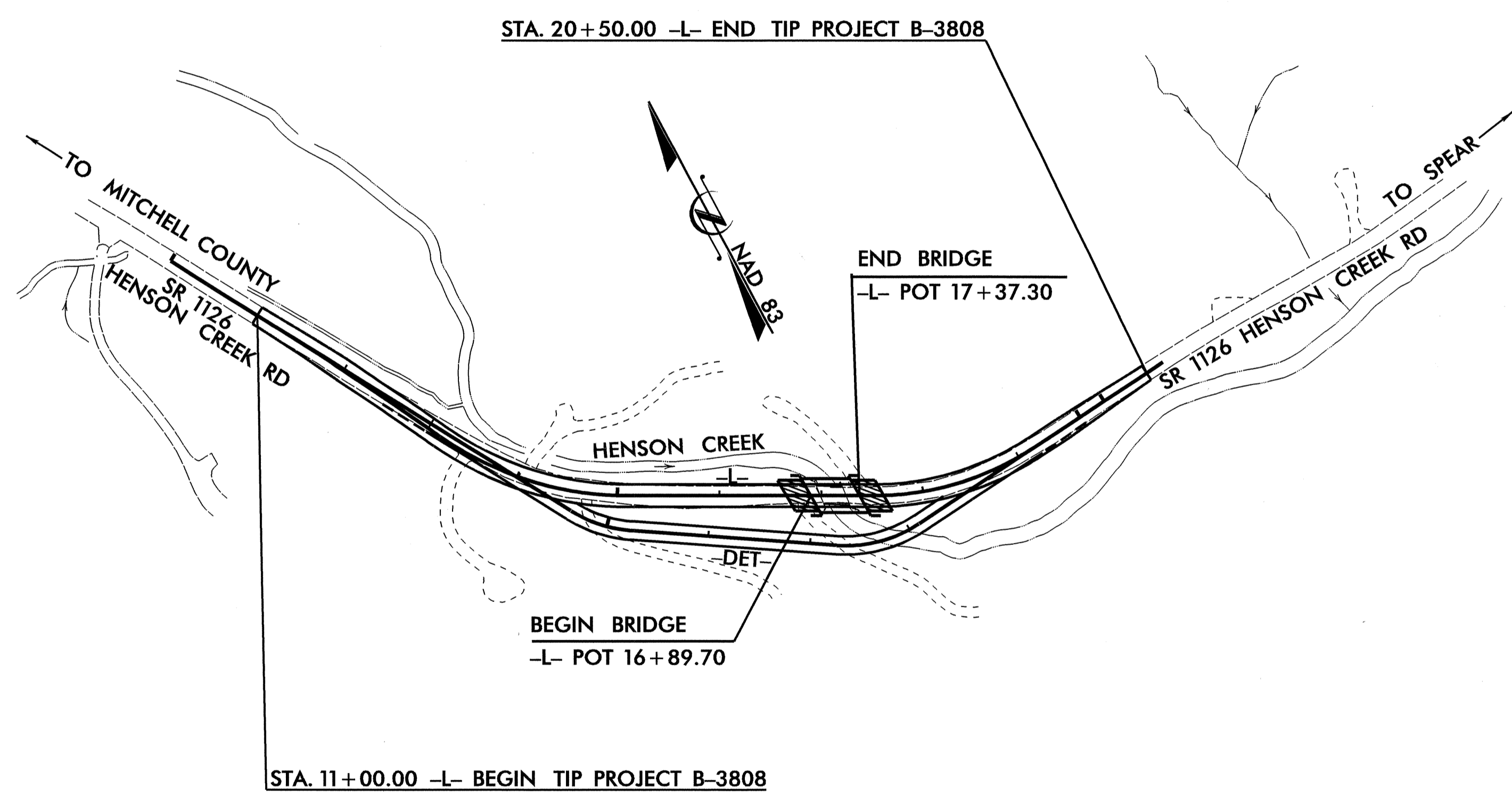

STRUCTURE

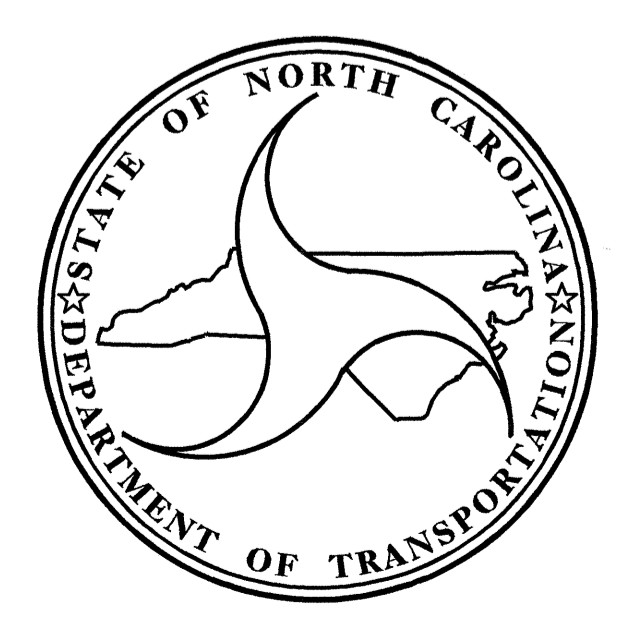

DESIGN DATA

ADT 2003 = 550
ADT 2025 = 700
DHV = 20 %
D = 60 %
T = 3 % *
V = 30 MPH
* TTST 1 % DUAL 2 %
FUNC CLASS = LOCAL
** DESIGN EXCEPTION For DESIGN SPEED (30 MPH)

PROJECT LENGTH

LENGTH ROADWAY TIP PROJECT B-3808 = 0.171 MILE
LENGTH STRUCTURE TIP PROJECT B-3808 = 0.009 MILE
TOTAL LENGTH TIP PROJECT B-3808 = 0.180 MILE

Prepared in the Office of:
DIVISION OF HIGHWAYS

2002 STANDARD SPECIFICATIONS

R. M. GIROLAMI, PE
DESIGN ENGINEER

L. E. SUTTON, PE
PROJECT DESIGN ENGINEER

LETTING DATE:
APRIL 19, 2005

STRUCTURE DESIGN UNIT
1000 BIRCH RIDGE DR.
RALEIGH, NC. 27610

Gregory R. Perfetti
12.29.04

DIVISION OF HIGHWAYS
STATE OF NORTH CAROLINA

STATE DESIGN ENGINEER

DEPARTMENT OF TRANSPORTATION
FEDERAL HIGHWAY ADMINISTRATION

APPROVED
DIVISION ADMINISTRATOR

DATE