

BILL OF MATERIAL													
APPROACH SLAB @ END BENT No. 1													
BAR	NO.	SIZE	TYPE	LENGTH	WEIGHT	BAR	NO.	SIZE	TYPE	LENGTH	WEIGHT		
* A1	47	5	STR	42'-6"	2083	B7	17	8	STR	25'-1"	1139		
A2	94	4	STR	22'-4"	1402	B8	17	8	STR	25'-6"	1157		
						B9	17	8	STR	25'-11"	1176		
* A101	1	5	STR	42'-7"	44	B10	17	8	STR	26'-4"	1195		
* A102	1	5	STR	36'-0"	38	* B11	1	5	3	6'-4"	7		
* A103	1	5	STR	29'-5"	31	* B12	1	5	3	6'-5"	7		
* A104	1	5	STR	23'-0"	24	* B13	7	5	STR	11'-5"	83		
* A105	1	5	STR	16'-8"	17	* B14	7	5	STR	11'-8"	85		
* A106	1	5	STR	10'-5"	11								
* A107	1	5	STR	4'-3"	4	* G1	1	5	STR	43'-0"	45		
A201	2	4	STR	22'-2"	30	* S1	56	5	STR	3'-3"	190		
A202	2	4	STR	18'-11"	25	* S2	40	5	1	4'-1"	170		
A203	1	4	STR	29'-5"	20	* S3	20	5	2	2'-3"	47		
A204	1	4	STR	23'-0"	15								
A205	1	4	STR	16'-8"	11	REINFORCING STEEL = 7300 LBS							
A206	1	4	STR	10'-5"	7	* EPOXY COATED REINF. STEEL = 6088 LBS							
A207	1	4	STR	4'-3"	3	CLASS AA CONCRETE BREAKDOWN:							
						POUR 1 SLAB & CURB C.Y. 42.2							
* B1	17	6	STR	24'-3"	619	POUR 2 RAIL C.Y. 2.4							
* B2	17	6	STR	24'-8"	630	CLASS AA CONCRETE C.Y. 44.6							
* B3	17	6	STR	25'-1"	640								
* B4	17	6	STR	25'-6"	651								
* B5	17	6	STR	25'-11"	662								
B6	17	8	STR	24'-8"	1120								

\* DENOTES EPOXY COATED REINFORCING STEEL

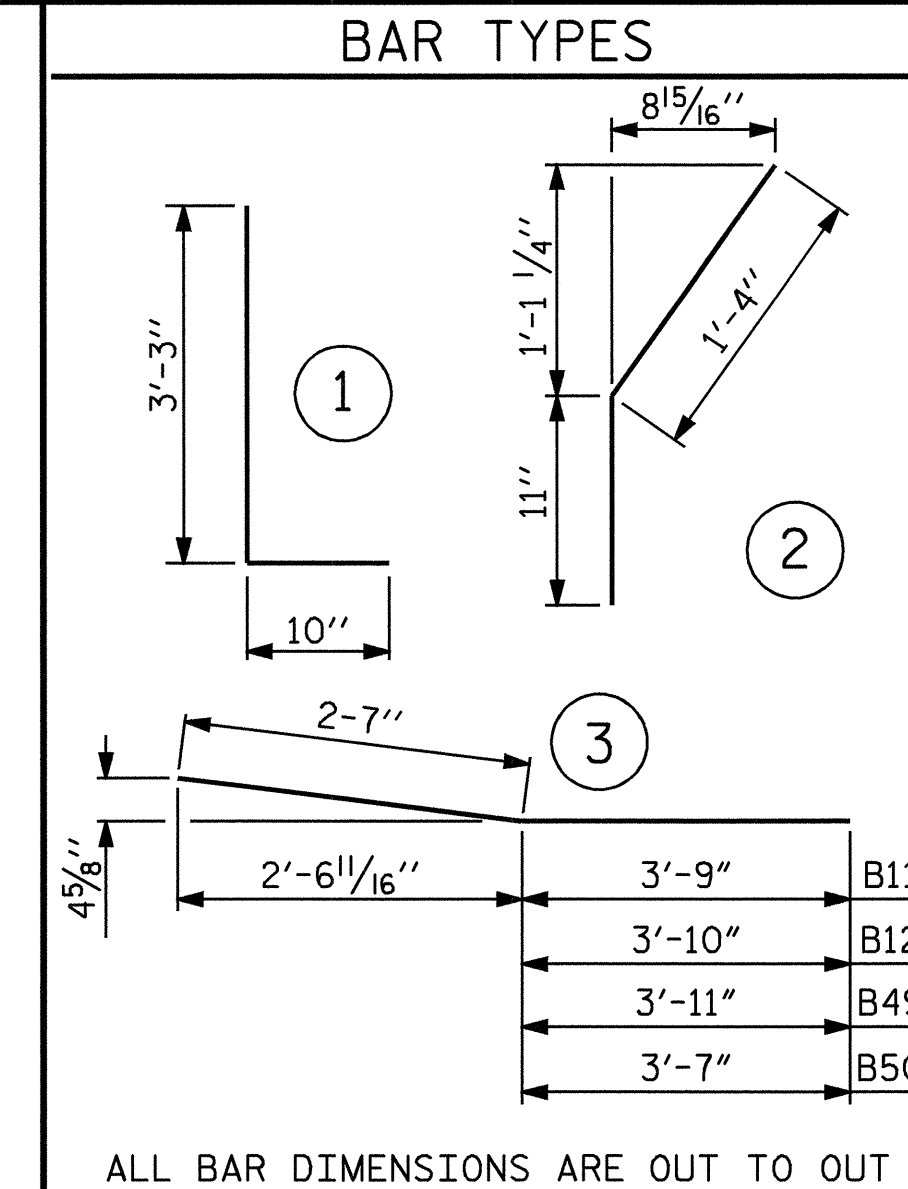

BILL OF MATERIAL											
APPROACH SLAB @ END BENT No. 2											
BAR	NO.	SIZE	TYPE	LENGTH	WEIGHT	BAR	NO.	SIZE	TYPE	LENGTH	WEIGHT
* A1	50	5	STR	42'-6"	2216	* B17	5	6	STR	26'-0"	195
A2	100	4	STR	22'-4"	1492	* B18	5	6	STR	26'-9"	201
						* B19	5	6	STR	27'-7"	207
* A108	1	5	STR	41'-11"	44	* B20	5	6	STR	28'-4"	213
* A109	1	5	STR	40'-5"	42	* B21	5	6	STR	29'-1"	218
* A110	1	5	STR	38'-8"	40	* B22	5	6	STR	29'-11"	225
* A111	1	5	STR	36'-11"	39	* B23	5	6	STR	30'-9"	230
* A112	1	5	STR	35'-2"	37	* B24	5	6	STR	31'-6"	237
* A113	1	5	STR	33'-5"	35	* B25	5	6	STR	32'-2"	242
* A114	1	5	STR	31'-8"	33	* B26	5	6	STR	33'-0"	248
* A115	1	5	STR	29'-11"	31	* B27	5	6	STR	33'-9"	253
* A116	1	5	STR	28'-2"	29	* B28	5	6	STR	34'-8"	260
* A117	1	5	STR	26'-5"	28	* B29	5	6	STR	35'-5"	266
* A118	1	5	STR	24'-7"	26	* B30	5	6	STR	36'-2"	272
* A119	1	5	STR	22'-10"	24	* B31	5	6	STR	37'-0"	278
* A120	1	5	STR	21'-0"	22						
* A121	1	5	STR	19'-2"	20	B32	5	8	STR	24'-10"	332
* A122	1	5	STR	17'-5"	18	B33	5	8	STR	25'-7"	342
* A123	1	5	STR	15'-7"	16	B34	5	8	STR	26'-5"	353
* A124	1	5	STR	13'-9"	14	B35	5	8	STR	27'-2"	363
* A125	1	5	STR	11'-11"	12	B36	5	8	STR	28'-0"	374
* A126	1	5	STR	10'-0"	10	B37	5	8	STR	28'-9"	384
* A127	1	5	STR	8'-2"	9	B38	5	8	STR	29'-6"	394
* A128	1	5	STR	6'-4"	7	B39	5	8	STR	30'-4"	405
* A129	1	5	STR	4'-5"	5	B40	5	8	STR	31'-1"	415
* A130	1	5	STR	2'-7"	3	B41	5	8	STR	31'-11"	426
						B42	5	8	STR	32'-8"	436
A208	2	4	STR	21'-10"	29	B43	5	8	STR	33'-6"	447
A209	2	4	STR	21'-1"	28	B44	5	8	STR	34'-3"	457
A210	2	4	STR	20'-3"	27	B45	5	8	STR	35'-1"	468
A211	2	4	STR	19'-4"	26	B46	5	8	STR	35'-10"	478
A212	2	4	STR	18'-6"	25	B47	5	8	STR	36'-7"	488
A213	2	4	STR	17'-8"	24	B48	5	8	STR	37'-5"	500
A214	2	4	STR	16'-9"	22						
A215	1	4	STR	29'-11"	20	* B49	1	5	3	6'-6"	7
A216	1	4	STR	28'-2"	19	* B50	1	5	3	6'-2"	6
A217	1	4	STR	26'-5"	18	* B51	7	5	STR	11'-8"	85
A218	1	4	STR	24'-7"	16	* B52	7	5	STR	11'-6"	84
A219	1	4	STR	22'-10"	15						
A220	1	4	STR	21'-0"	14	* G2	1	5	STR	44'-6"	46
A221	1	4	STR	19'-2"	13						
A222	1	4	STR	17'-5"	12	* S1	56	5	STR	3'-3"	190
A223	1	4	STR	15'-7"	10	* S2	40	5	1	4'-1"	170
A224	1	4	STR	13'-9"	9	* S3	20	5	2	2'-3"	47
A225	1	4	STR	11'-11"	8						
A226	1	4	STR	10'-0"	7	REINFORCING STEEL = 8910 LBS					
A227	1	4	STR	8'-2"	5	* EPOXY COATED REINF. STEEL = 7312 LBS					
A228	1	4	STR	6'-4"	4	CLASS AA CONCRETE BREAKDOWN:					
A229	1	4	STR	4'-5"	3	POUR 1 SLAB & CURB C.Y. 51.4					
A230	1	4	STR	2'-7"	2	POUR 2 RAIL C.Y. 2.4					
						CLASS AA CONCRETE C.Y. 53.8					
* B15	5	6	STR	24'-5"	183						
* B16	5	6	STR	25'-2"	189						

\* DENOTES EPOXY COATED REINFORCING STEEL

ELASTOMERIC CONCRETE	
END BENT No.	ELASTOMERIC CONCRETE (CU. FT.) ▲
1	8.1
2	8.1
TOTAL	16.2

▲ BASED ON THE MINIMUM BLOCKOUT SHOWN.

PROJECT NO. B-3694  
ROCKINGHAM COUNTY  
 STATION: 17+27.50 -L-

SHEET 5 OF 5

STATE OF NORTH CAROLINA  
 DEPARTMENT OF TRANSPORTATION  
 RALEIGH

BRIDGE APPROACH  
 SLAB BILL OF MATERIAL

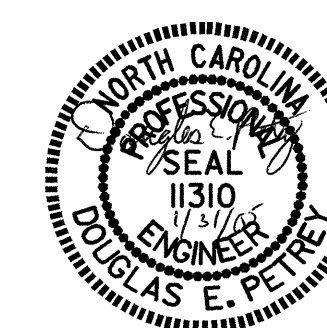

REVISIONS						SHEET NO.
NO.	BY:	DATE:	NO.	BY:	DATE:	S-33
1			3			TOTAL SHEETS 36
2			4			

DRAWN BY : A. V. ROYAL DATE : 8/04  
 CHECKED BY : P. C. BREWER DATE : 6-16-04