

TIP PROJECT: B-3682

CONTRACT: C201182

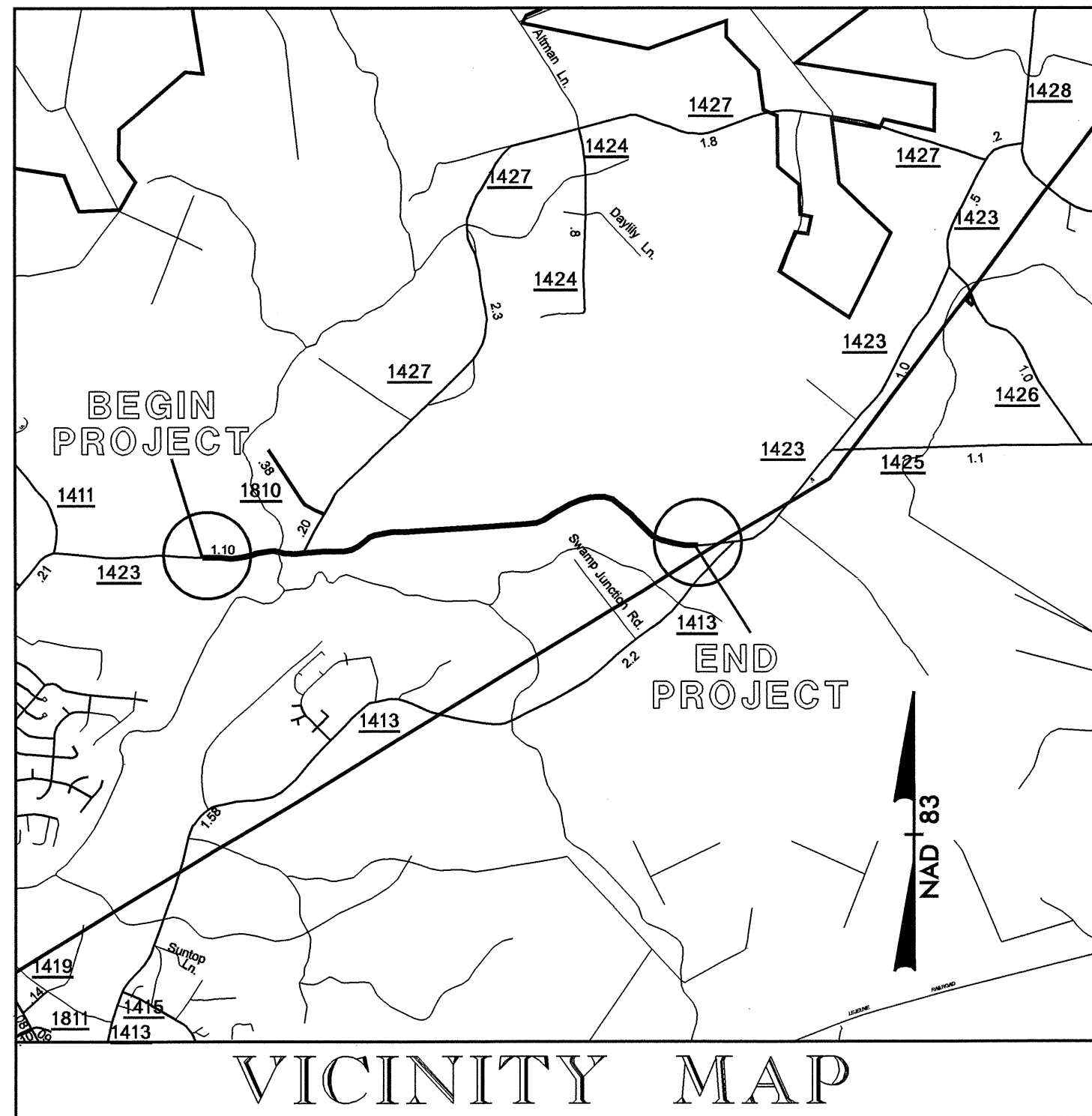

STATE OF NORTH CAROLINA
DIVISION OF HIGHWAYS
ONSLOW COUNTY

LOCATION: BRIDGE No. 3 OVER LITTLE NORTHEAST CREEK ON SR 1423
**TYPE OF WORK: GRADING, PAVING, WIDENING, RESURFACING,
DRAINAGE, STRUCTURE AND STRUCTURE REMOVAL**

STATE	STATE PROJECT REFERENCE NO.	SHEET NO.	TOTAL SHEETS
N.C.	B-3682		
STATE PROJ. NO.	F.A. PROJ. NO.	DESCRIPTION	
33224.1.1	BRSTP-1423(2)	PE	
33224.1.1	BRSTP-1423(3)	ROW	
33224.3.2	BRSTP-1423(5)	CONSTRUCTION	

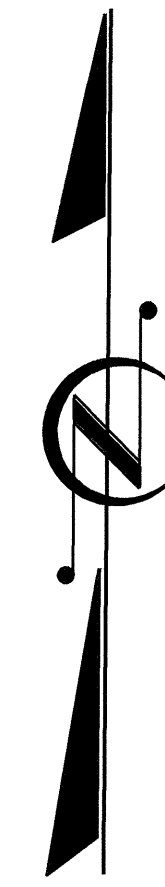

STRUCTURE

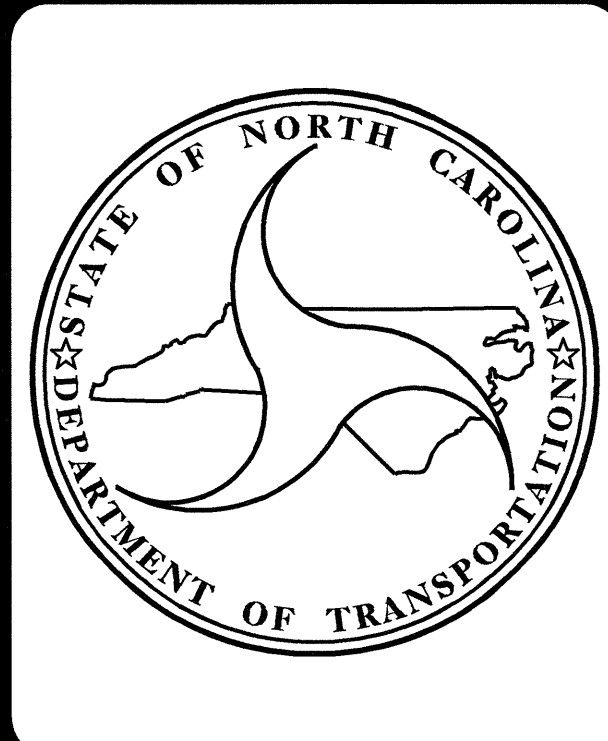
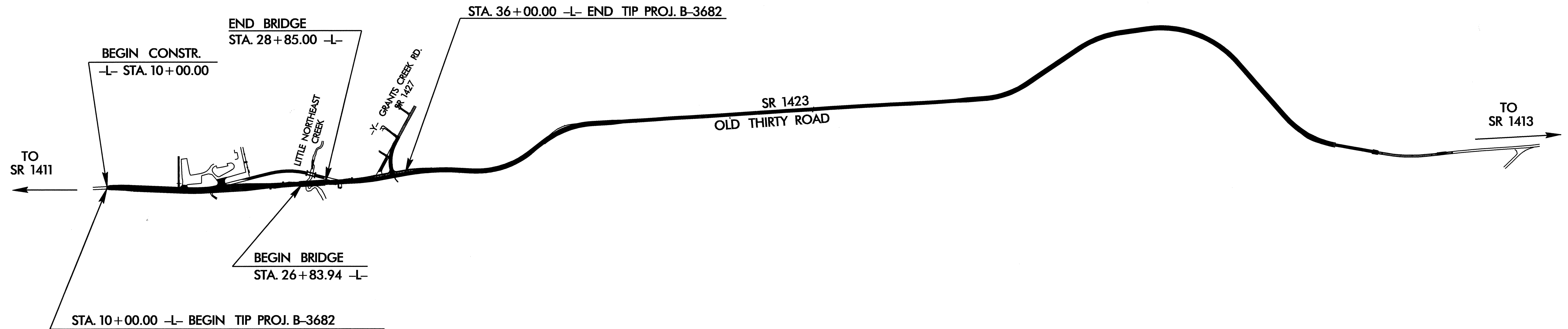

DESIGN DATA

ADT 2004 =	3,680
ADT 2024 =	6,080
DHV =	9 %
D =	55 %
T =	3 % *
V =	50 MPH
* TTST 1 %	DUAL 2 %
FUNC CLASS =	LOCAL

PROJECT LENGTH

LENGTH ROADWAY TIP PROJECT B-3682	=	0.454 mi
LENGTH STRUCTURE TIP PROJECT B-3682	=	0.038 mi
TOTAL LENGTH TIP PROJECT B-3682	=	0.492 mi

Prepared in the Office of:
**DEPARTMENT OF TRANSPORTATION
DIVISION OF HIGHWAYS**
1000 Birch Ridge Drive, Raleigh, N. C. 27610

2002 STANDARD SPECIFICATIONS

LETTING DATE : <u>MARCH 15, 2005</u>	<u>B.S. COX, P.E.</u> <small>PROJECT ENGINEER</small> <hr/> <u>D.E. PETREY, P.E.</u> <small>PROJECT DESIGN ENGINEER</small>
------------------------------------------------	--------------------------------------------------------------------------------------------------------------------------------------

STRUCTURE DESIGN

Gregory R. Perpetti
1.28.05

DIVISION OF HIGHWAYS
STATE OF NORTH CAROLINA

P.E.
STATE HIGHWAY ENGINEER - DESIGN
**DEPARTMENT OF TRANSPORTATION
FEDERAL HIGHWAY ADMINISTRATION**

APPROVED FOR
DIVISION ADMINISTRATOR DATE