

PROJECT REFERENCE NO. B-3682 & W-3413	SHEET NO. EC-17/CONST.10
RW SHEET NO.	
ROADWAY DESIGN ENGINEER	HYDRAULICS ENGINEER

NOTE:
TEMPORARY SILT FENCE SHALL BE INSTALLED A MINIMUM OF 3 FEET FROM TOE OF FILL IN WETLAND AREAS

-L-
PI Sta 107+89.82
Δ = 56° 48' 37.6" (RT)
D = 6' 30' 00.0"
L = 874.0'
T = 476.7'
R = 881.47'
SE = 0.08 FT/FT
RO = 200'

-L-
PI Sta 120+77.27
Δ = 38° 25' 59.7" (LT)
D = 7' 30' 00.0"
L = 512.44'
T = 266.28'
R = 763.94'
SE = 0.08 FT/FT
RO = 200'

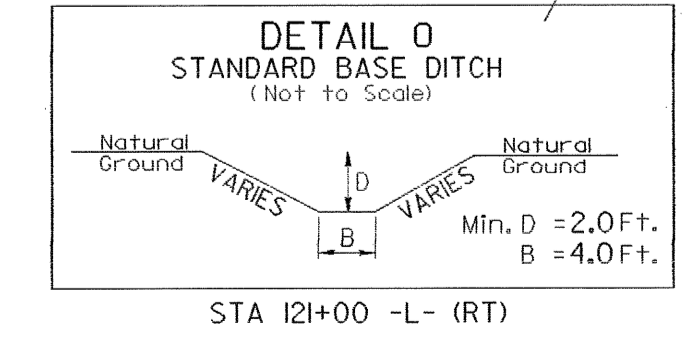
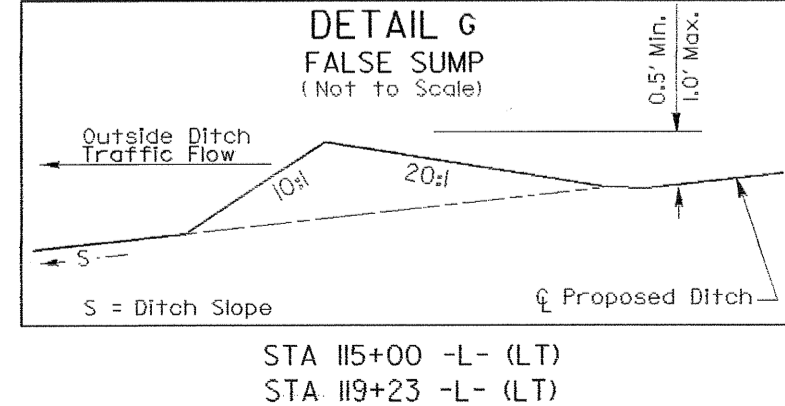
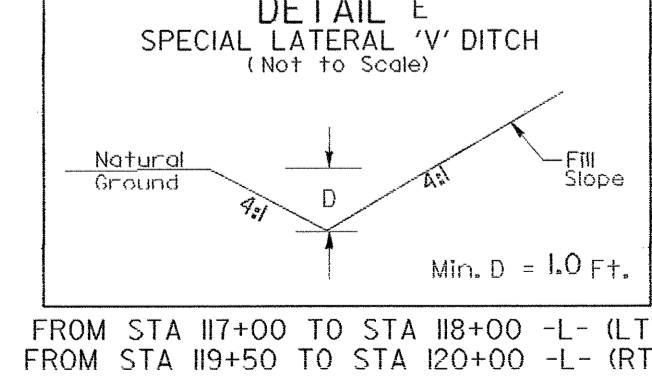
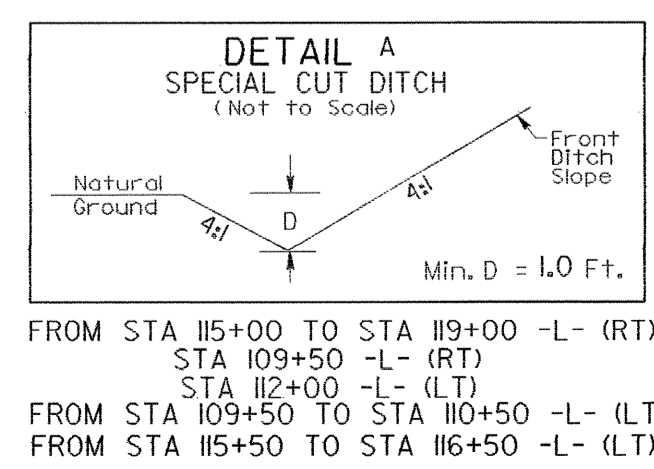
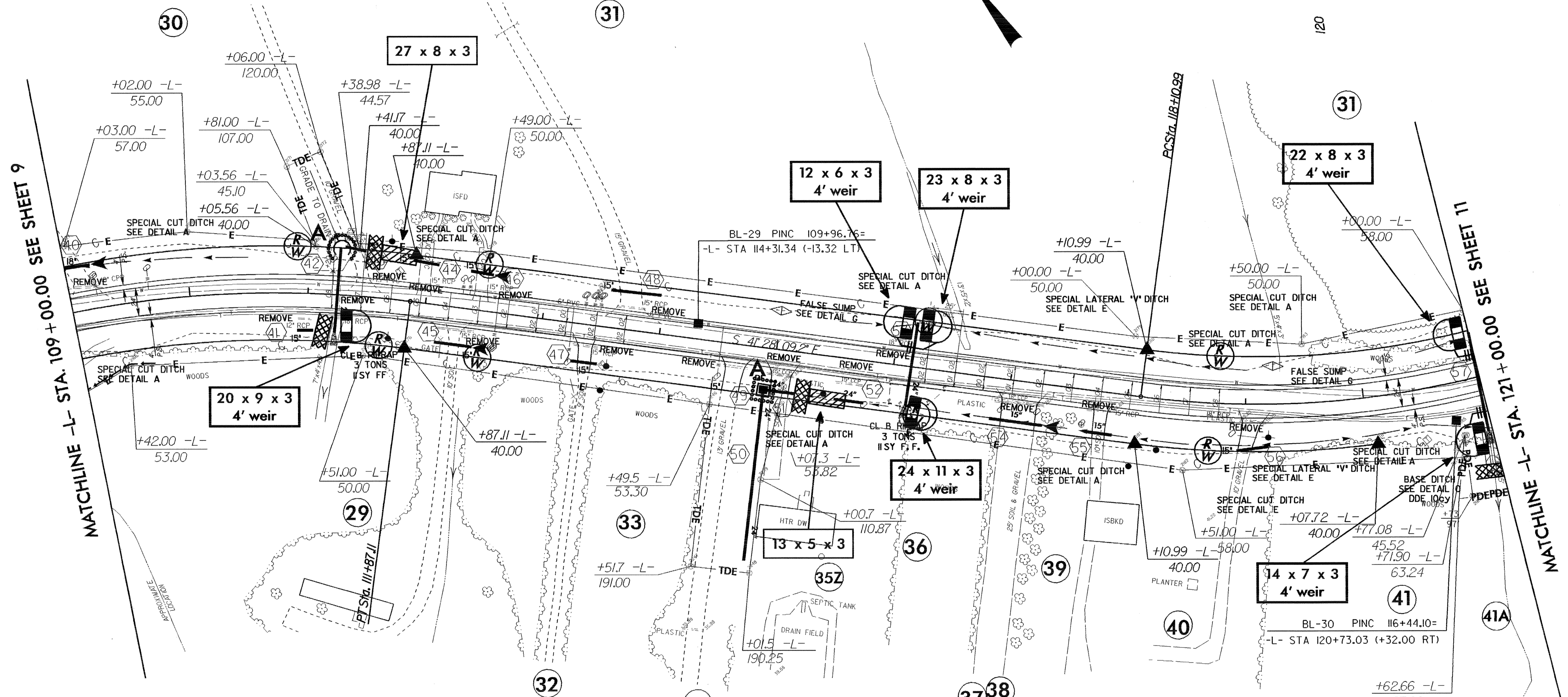
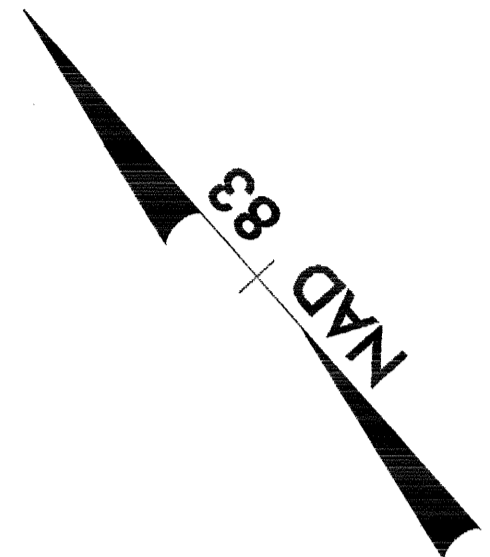

See Sheet 15 for -L- Profile

Q9-F3-2005 16:22
 S:\proj\vip\proj\3682\ec\17\const\10\psh
 10/17/99 10:41:00