

STATE	STATE PROJECT REFERENCE NO.	SHEET NO.	TOTAL SHEETS
N.C.	B-3496	EC-5	
STATE PROJ. NO.	F.A. PROJ. NO.	DESCRIPTION	

## PLANTING DETAILS

### DIBBLE PLANTING METHOD USING THE KBC PLANTING BAR

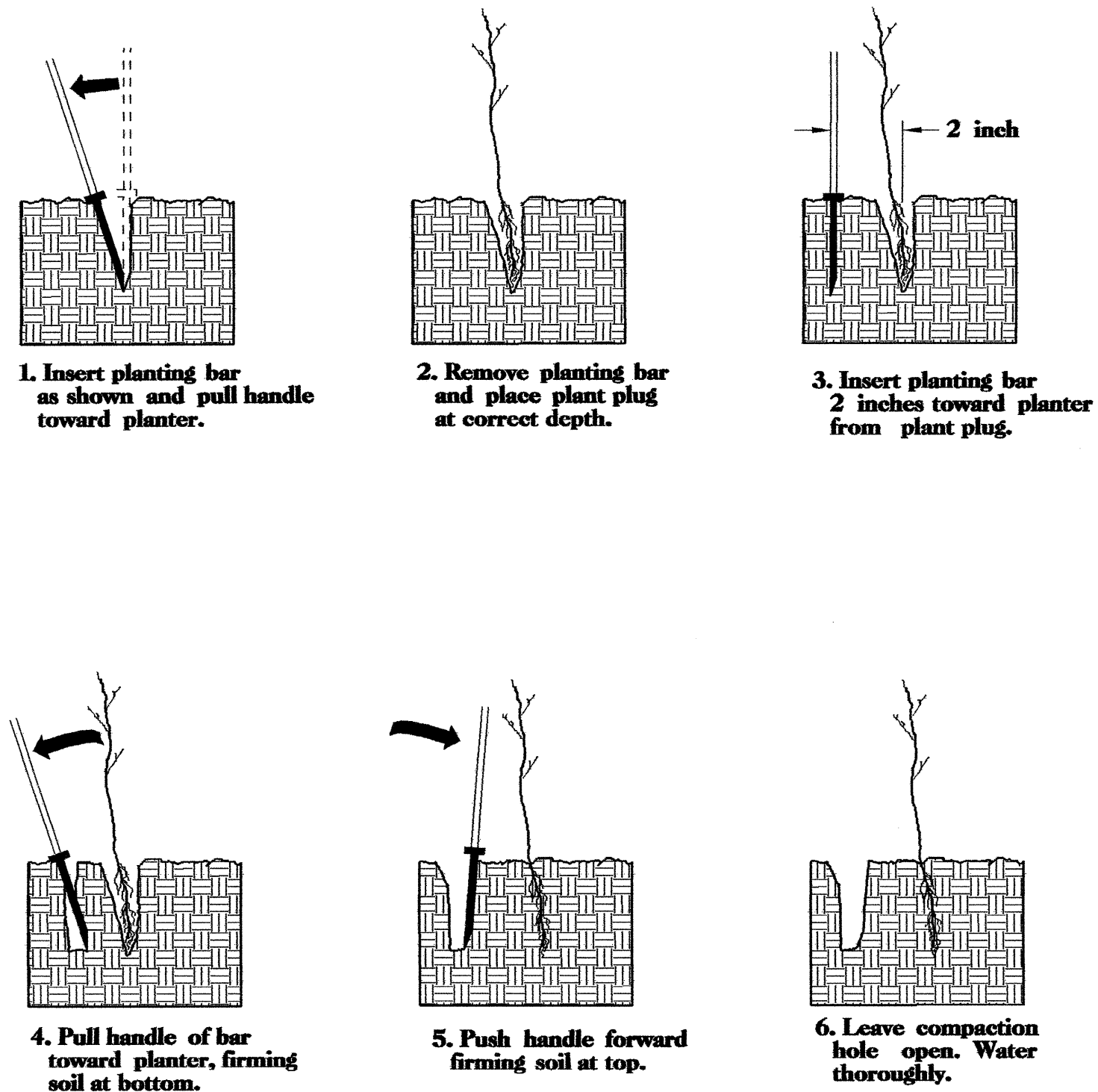

### PLANTING NOTES:

**PLANTING BAG**  
During planting, plant plugs shall be kept in a moist canvas bag or similar container to prevent the root systems from drying.

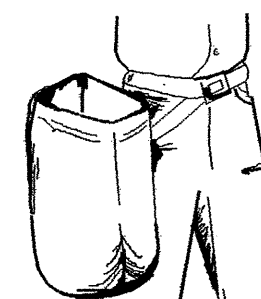

**KBC PLANTING BAR**  
Planting bar shall have a blade with a triangular cross section, and shall be 12 inches long, 4 inches wide and 1 inch thick at center.



## WETLAND GRASS PLANTING

- WETLAND GRASS SPECIES SHALL BE PLANTED 2 FT. TO 4 FT. ON CENTER, RANDOM SPACING, AVERAGING 3 FT. ON CENTER, APPROXIMATELY 4840 PLANTS PER ACRE.

### WETLAND GRASS PLANTING

MIXTURE, TYPE, SIZE, AND FURNISH SHALL CONFORM TO THE FOLLOWING:

100% SPARTINA ALTERNIFLORA SALT MARSH CORDGRASS 2 in PEAT POT

## WETLAND GRASS PLANTING DETAIL SHEET

N.C.D.O.T. - ROADSIDE ENVIRONMENTAL UNIT