

**DATUM DESCRIPTION**

THE LOCALIZED COORDINATE SYSTEM DEVELOPED FOR THIS PROJECT IS BASED ON THE STATE PLANE COORDINATES ESTABLISHED BY NCDOT FOR MONUMENT "GPS B-3182-1" WITH HARN-NAD 83/95 STATE PLANE GRID COORDINATES OF NORTHING: 904664.103(Ft) EASTING: 231080.687(Ft) THE AVERAGE COMBINED GRID FACTOR USED ON THIS PROJECT (GROUND TO GRID) IS: 1.0001358 THE N.C. LAMBERT GRID BEARING AND LOCALIZED HORIZONTAL GROUND DISTANCE FROM "B-3182-1" TO L STATION 10+00.00 IS N 4° 28' 40.0" W 1,153.57(Ft) ALL LINEAR DIMENSIONS ARE LOCALIZED HORIZONTAL DISTANCES VERTICAL DATUM USED IS NAVD 88

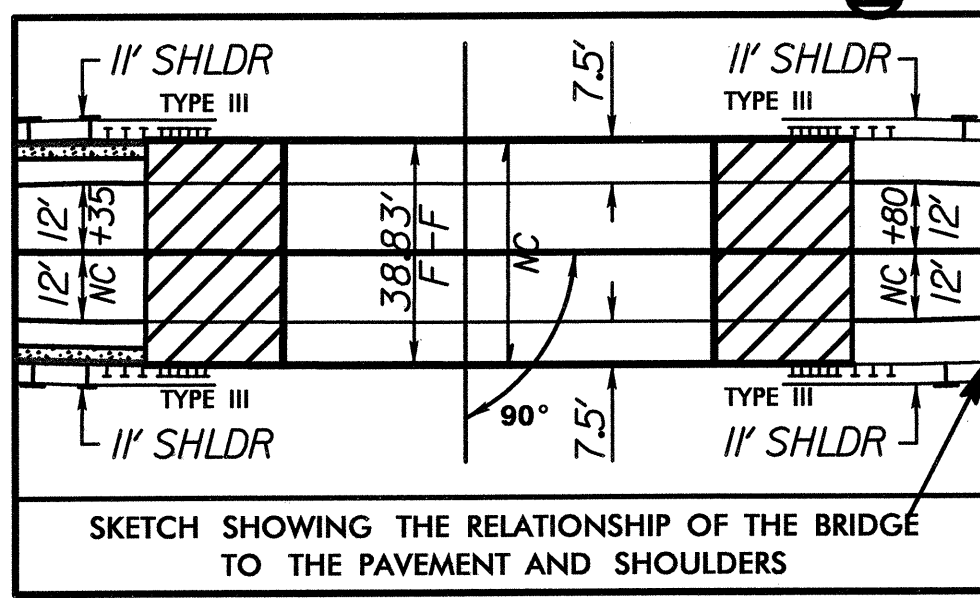
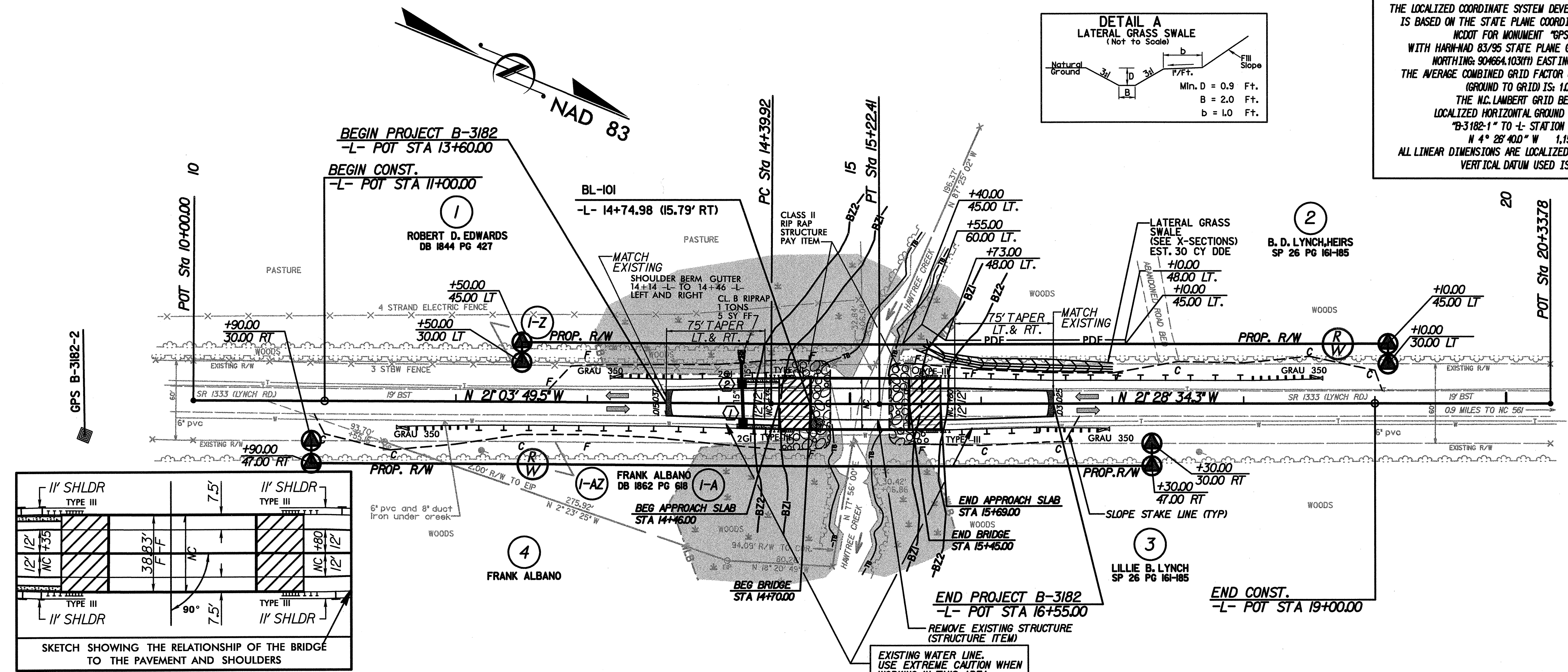
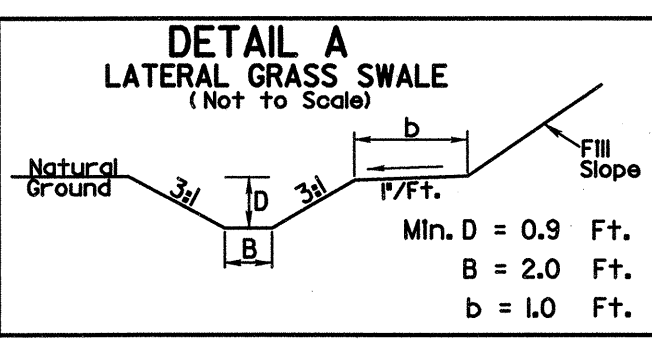

-L-  
PI Sta 14+81J6  
Δ = 0' 24' 44.8" (LT)  
D = 0' 30' 00.0"  
L = 82.49'  
T = 41.24'  
R = 11,459J6'  
SE = NC  
DS = 60 MPH

SEE SHEETS S1 THRU S19 FOR STRUCTURE PLANS

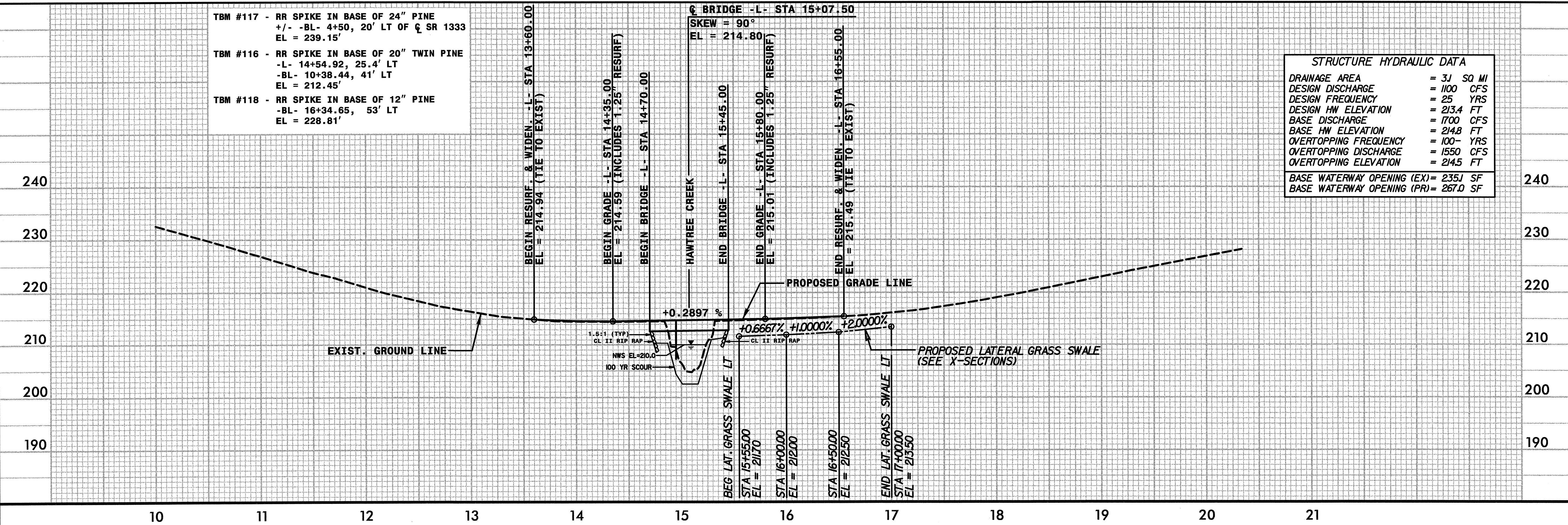

- TBM #117 - RR SPIKE IN BASE OF 24" PINE +/- -BL- 4+50, 20' LT OF C SR 1333 EL = 239.15'
- TBM #116 - RR SPIKE IN BASE OF 20" TWIN PINE -L- 14+54.92, 25.4' LT -BL- 10+38.44, 41' LT EL = 212.45'
- TBM #118 - RR SPIKE IN BASE OF 12" PINE -BL- 16+34.65, 53' LT EL = 228.81'

8/17/99  
BUCK ENGINEERING  
1/2/2005  
Buckey P-o, N-3182, RDY\_PSH\_04.DGN