

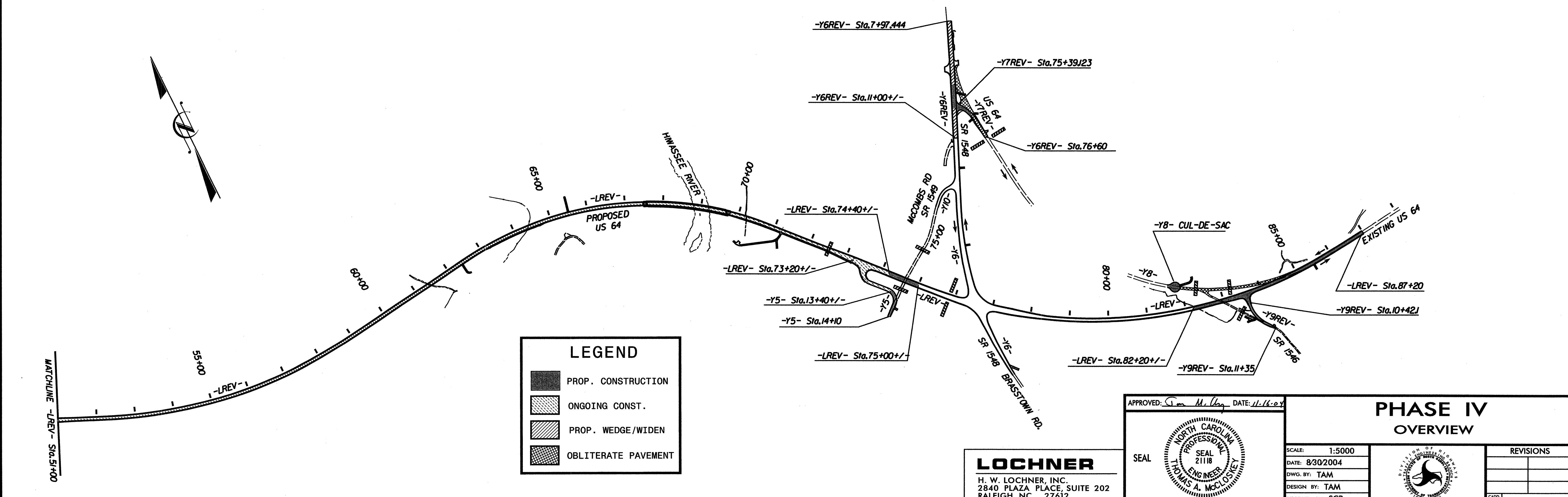

# PHASE IV

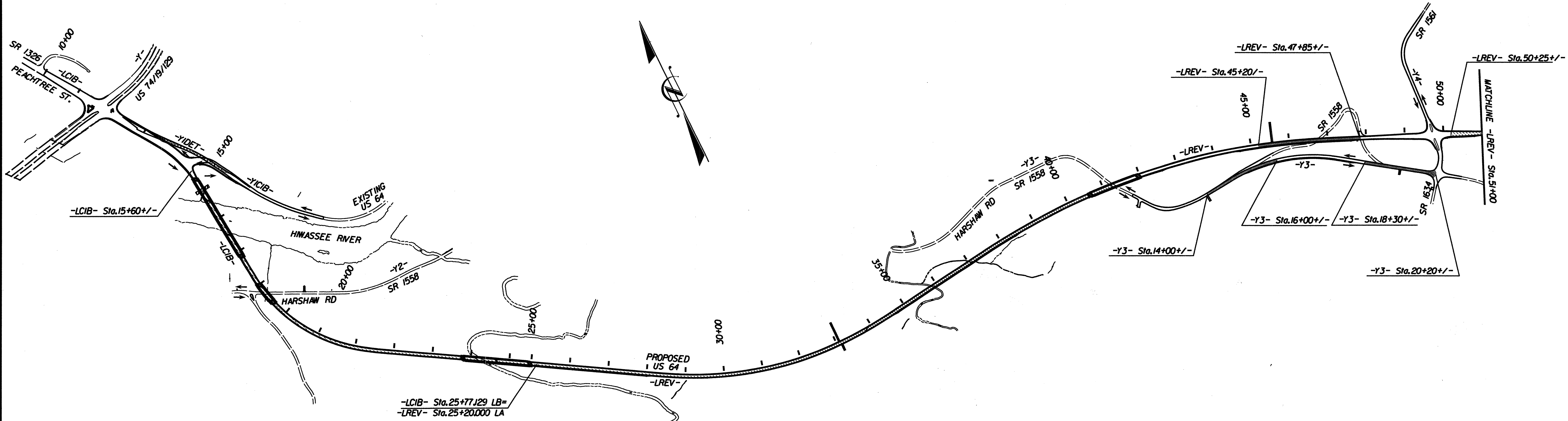

**LEGEND**

- PROP. CONSTRUCTION
- ONGOING CONST.
- PROP. WEDGE/WIDEN
- OBLITERATE PAVEMENT

**LOCHNER**  
 H. W. LOCHNER, INC.  
 2840 PLAZA PLACE, SUITE 202  
 RALEIGH, NC 27612

APPROVED: *Tom M. Gog* DATE: 11.16.04

SEAL  
 NORTH CAROLINA  
 PROFESSIONAL  
 ENGINEER  
 21118  
 THOMAS A. MCCLOSKEY

**PHASE IV OVERVIEW**

SCALE: 1:5000  
 DATE: 8/30/2004  
 DWG. BY: TAM  
 DESIGN BY: TAM  
 REVIEWED BY: SCB

REVISIONS