

-Y6REV-1-Y6-  
PI Sta 15+22.685  
 $\Delta = 31' 16" 34.5" (LT)$   
 $L = 474.910$   
 $T = 243.533$   
 $R = 870.000$   
 $Se = 0.05$   
 $Ro = AS SHOWN$   
 $DS = 100 \text{ km/h}$

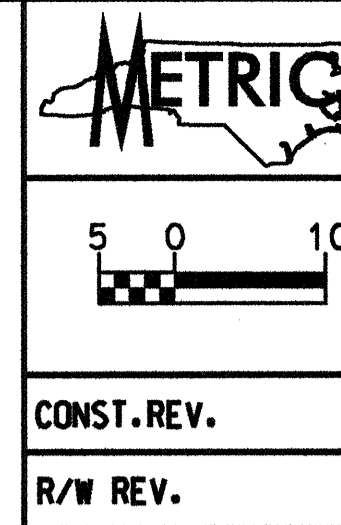

PROJECT REFERENCE NO. R-977A SHEET NO. 22  
HIGHWAY DESIGN ENGINEER SEAL 15759  
HYDRAULICS ENGINEER SEAL 20731  
DILLARD McCOMBS  
CONST. REV.  
R/W REV.

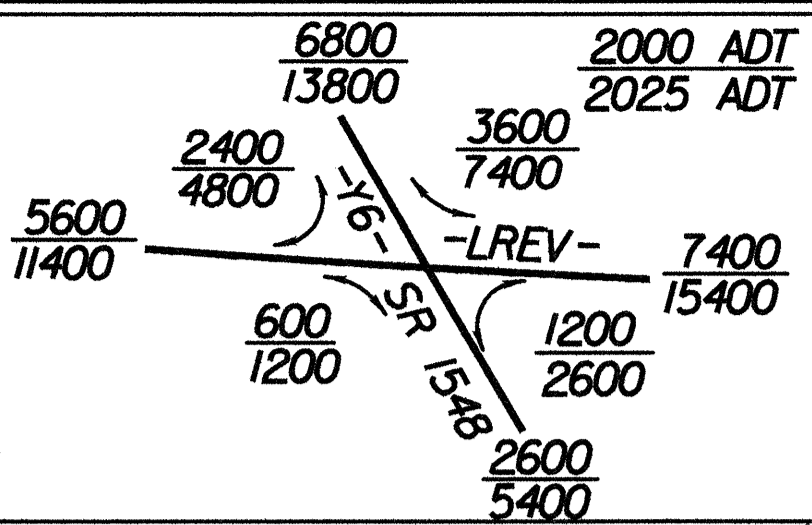
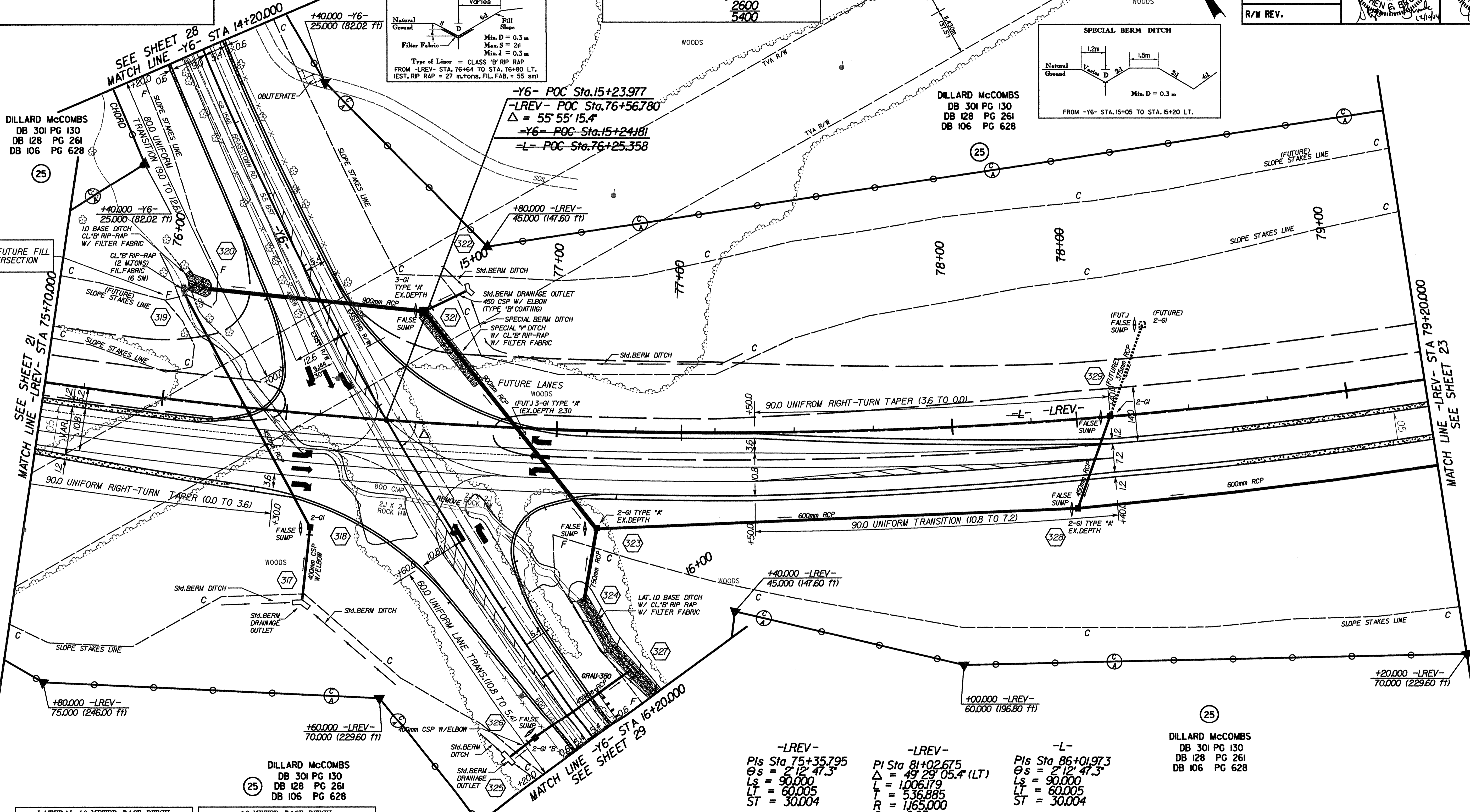
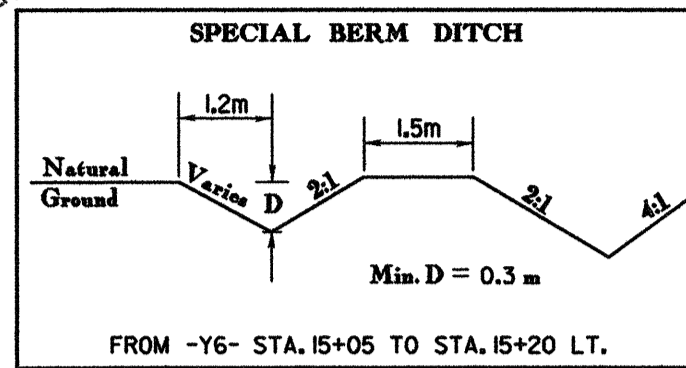
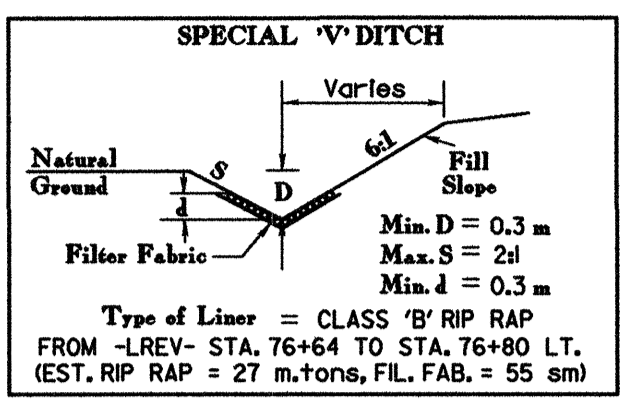

NOTE: GRADE FUTURE FILL AT INTERSECTION

DILLARD McCOMBS  
DB 301 PG 130  
DB 128 PG 261  
DB 106 PG 628

-Y6- POC Sta.15+23.977  
-LREV- POC Sta.76+56.780  
 $\Delta = 55' 55" 15.4"$   
-Y6- POC Sta.15+24.181  
-L- POC Sta.76+25.358

DILLARD McCOMBS  
DB 301 PG 130  
DB 128 PG 261  
DB 106 PG 628

DILLARD McCOMBS  
DB 301 PG 130  
DB 128 PG 261  
DB 106 PG 628

DILLARD McCOMBS  
DB 301 PG 130  
DB 128 PG 261  
DB 106 PG 628

-LREV-  
Pis Sta 75+35.795  
 $\theta s = 1' 28" 47.3"$   
 $Ls = 90.000$   
 $LT = 60.005$   
 $ST = 30.004$

-LREV-  
PI Sta 81+02.675  
 $\Delta = 49' 29" 05.4" (LT)$   
 $L = 1,006.179$   
 $T = 536.885$   
 $R = 1,165.000$   
 $Se = 0.05$   
 $DS = 105 \text{ km/h}$

-L-  
Pis Sta 86+01.973  
 $\theta s = 1' 28" 47.3"$   
 $Ls = 90.000$   
 $LT = 60.005$   
 $ST = 30.004$

-L-  
Pis Sta 74+99.317  
 $\theta s = 1' 28" 31.5"$   
 $Ls = 60.000$   
 $LT = 49.001$   
 $ST = 20.001$

-L-  
PI Sta 80+74.497  
 $\Delta = 50' 57" 36.9" (LT)$   
 $L = 1,036.179$   
 $T = 555.181$   
 $R = 1,165.000$

-L-  
Pis Sta 85+75.496  
 $\theta s = 1' 28" 31.5"$   
 $Ls = 60.000$   
 $LT = 49.001$   
 $ST = 20.001$

SEE SHEET 47 FOR -LREV- PROFILE  
SEE SHEET 57 FOR -Y6- PROFILE  
SEE PROFILES FOR DITCH GRADES  
SEE SHEET 2-H FOR INTERSECTION DETAILS

**LOCHNER**  
H. W. LOCHNER, INC.  
2840 PLAZA PLACE, SUITE 202  
RALEIGH, NC 27612

