

REVISIONS

~~-L-~~ PIs Sta 23+03.455
~~Os = 2° 42' 24.8"~~
~~Ls = 60.000~~
~~LT = 40.005~~
~~ST = 20.004~~

~~-L-~~ PIs Sta 24+60.631
~~Δ = 24° 22' 51.4" (LT)~~
~~L = 270.210~~
~~T = 737.181~~
~~R = 635.000~~

~~-L-~~ PIs Sta 26+13.664
~~Os = 2° 42' 24.8"~~
~~Ls = 60.000~~
~~LT = 40.005~~
~~ST = 20.004~~

~~-LREV-~~ PIs Sta 20+64.354
~~Os = 7° 15' 09.5"~~
~~Ls = 100.000~~
~~LT = 66.723~~
~~ST = 33.384~~

~~-LREV-~~ PIs Sta 21+69.856
~~Δ = 20° 43' 25.6" (LT)~~
~~L = 142.871~~
~~T = 72.225~~
~~R = 395.000~~
~~DS = 100 km/h~~

~~-LREV-~~ PIs Sta 28+62.544
~~Os = 2° 56' 47.9"~~
~~Ls = 90.000~~
~~LT = 60.008~~
~~ST = 30.008~~

METRIC

5 0 10

CONST. REV.

R/W REV.

PROJECT REFERENCE NO. R-977A	SHEET NO. 8
HIGHWAY DESIGN ENGINEER	HYDRAULICS ENGINEER

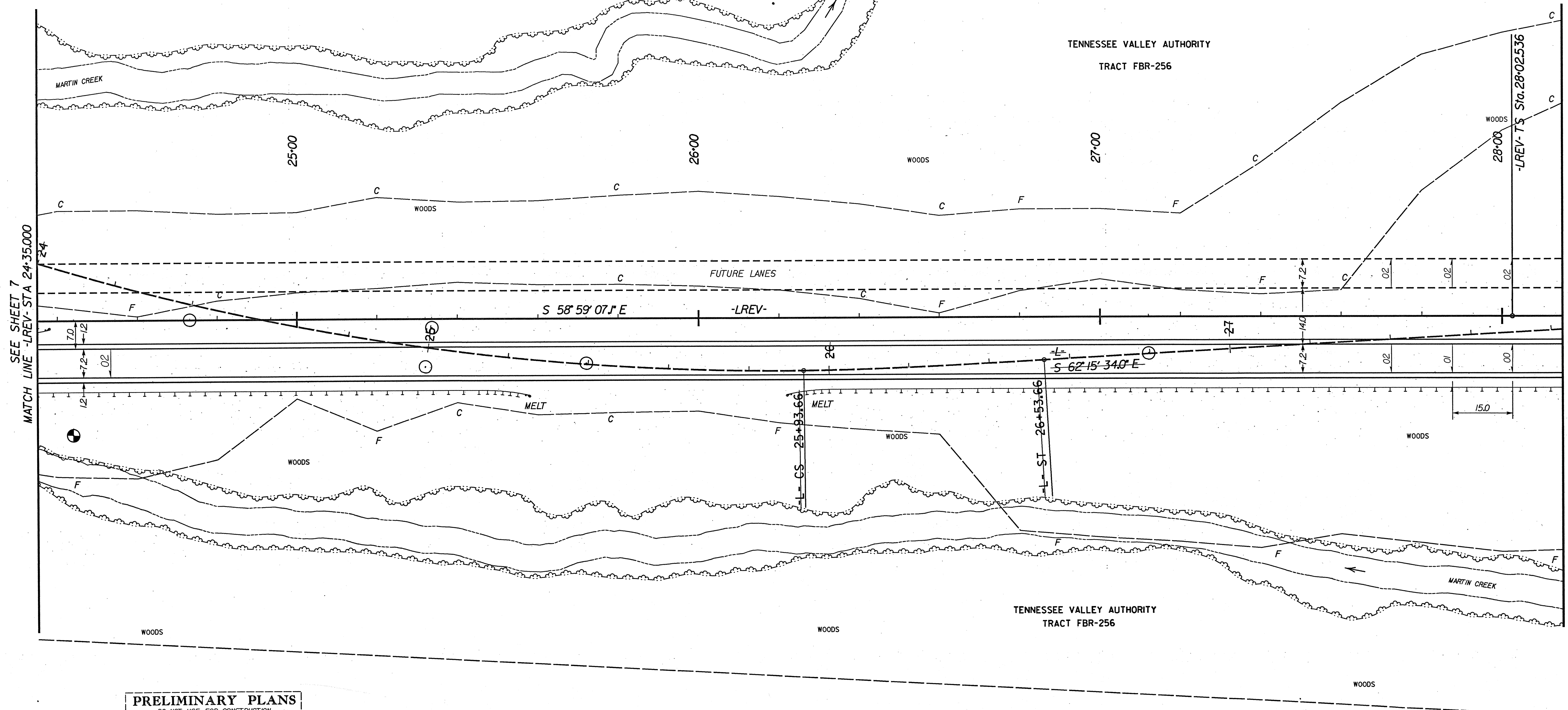

PRELIMINARY PLANS
 DO NOT USE FOR CONSTRUCTION

INCOMPLETE PLANS
 DO NOT USE FOR R/W ACQUISITION

SEE SHEET 34 FOR -LREV- PROFILES

LOCHNER

H.W. LOCHNER, INC.
 3725 NATIONAL DRIVE, SUITE 123
 RALEIGH, NC 27612