

SECTION E-E (PARTS 4 & 5B)

THERE ARE 90 C4 BARS IN SECTION OF BARREL  
NOTE : #13 K1 BARS SPA. @ 600mm ALONG CULVERT LENGTH

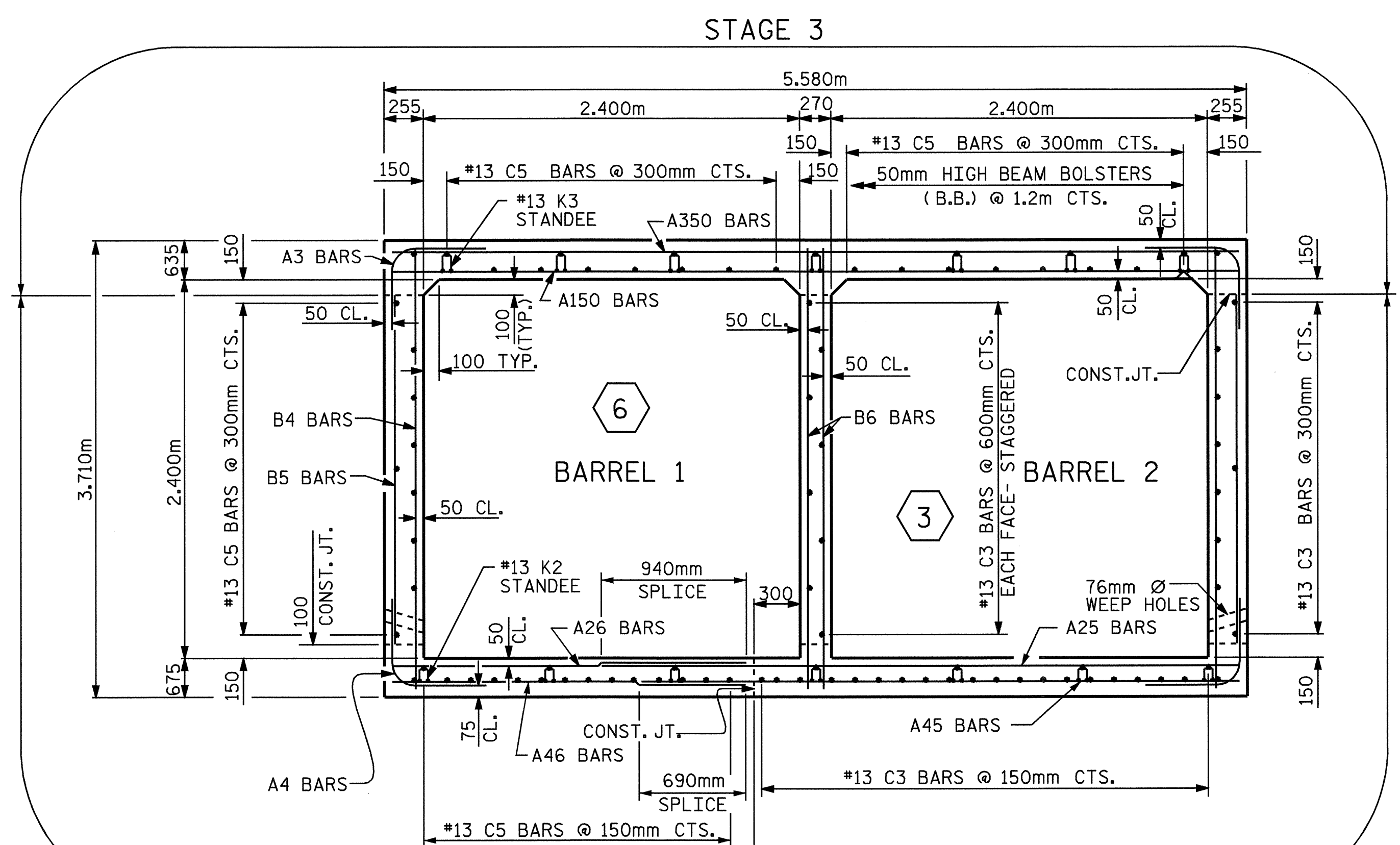

SECTION C-C (PARTS 3 & 6)

THERE ARE 90 #13 "C" BARS IN SECTION OF BARREL  
NOTE : #13 "K" BARS SPA. @ 600mm ALONG CULVERT LENGTH

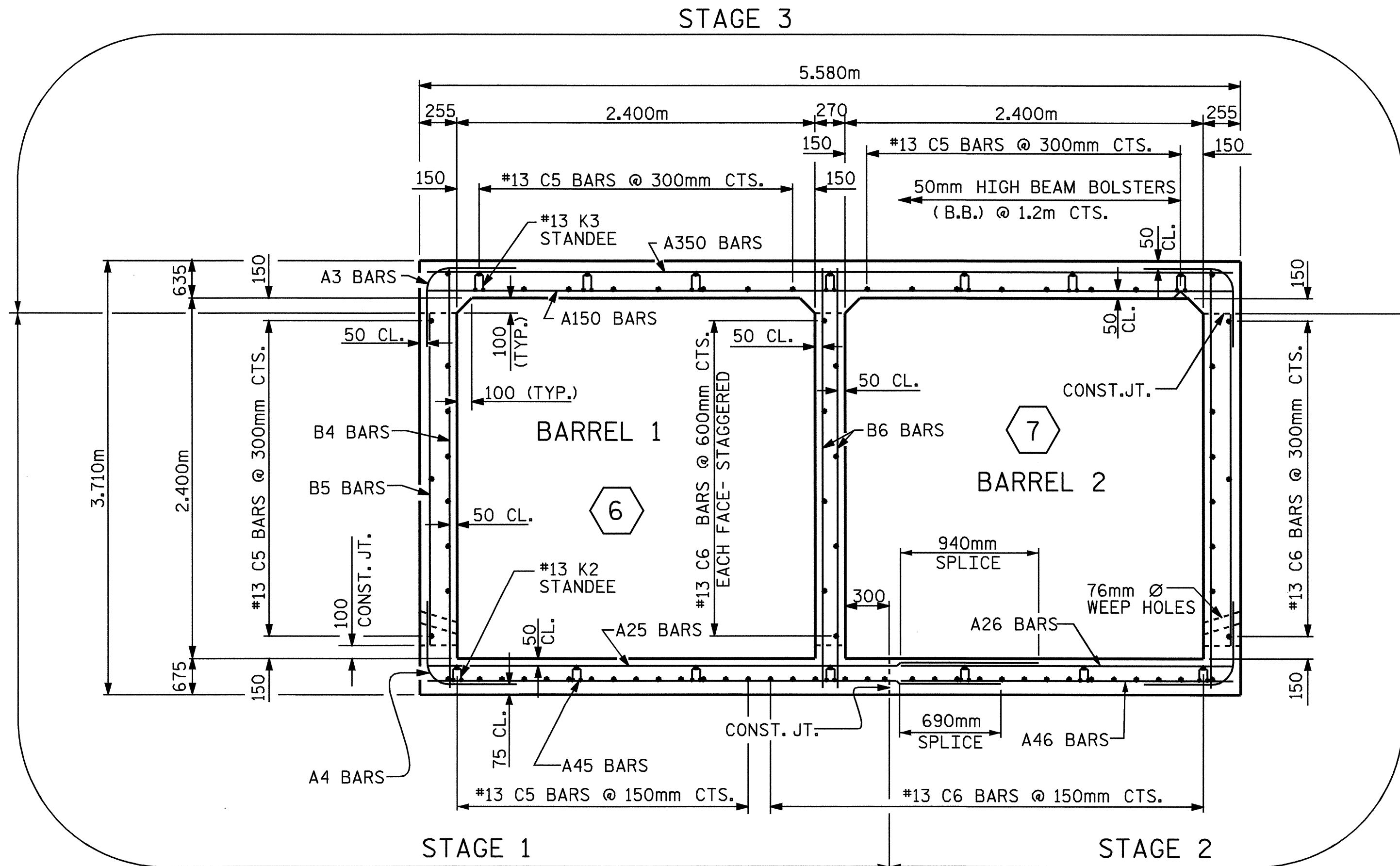

SECTION D-D (PARTS 6 & 7)

THERE ARE 90 #13 "C" BARS IN SECTION OF BARREL  
NOTE : #13 "K" BARS SPA. @ 600mm ALONG CULVERT LENGTH

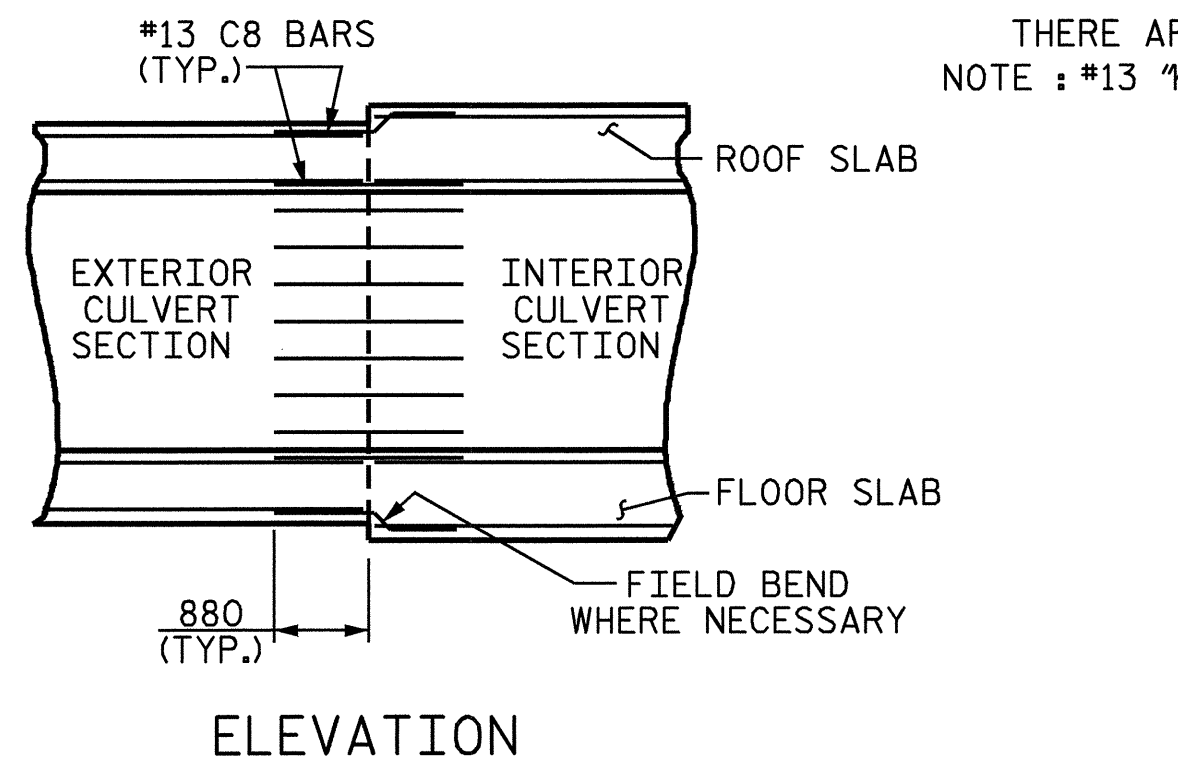

ELEVATION

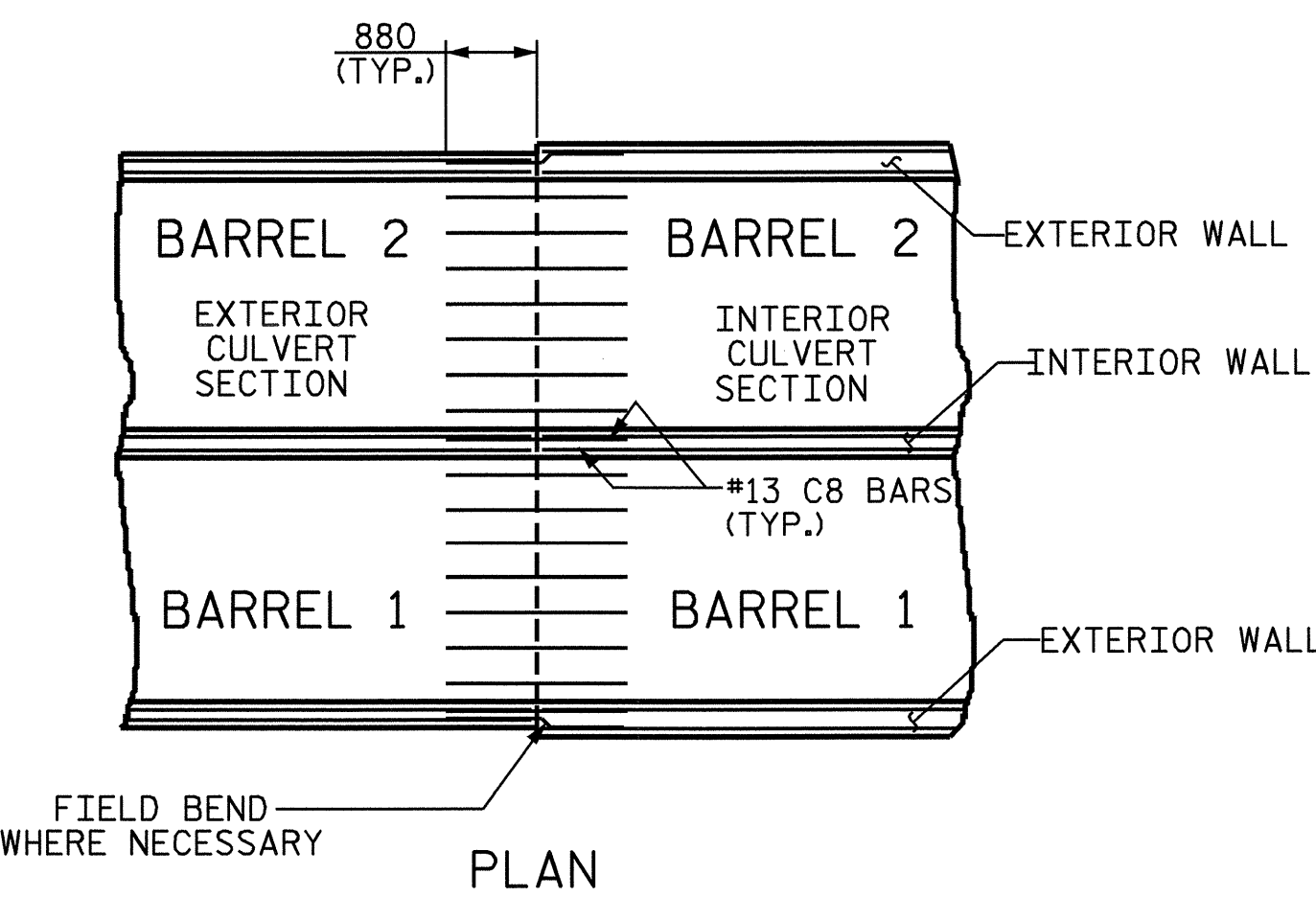

PLAN

DETAIL SHOWING TYPICAL PLACEMENT OF #13 C8 BARS BETWEEN BARREL PARTS

PROJECT NO. R-0977A  
CHEROKEE COUNTY  
STATION: 35+18.000-LREV-

SHEET 7 OF 14

STATE OF NORTH CAROLINA  
DEPARTMENT OF TRANSPORTATION  
RALEIGH  
DOUBLE  
2.400m X 2.400m  
CONCRETE BOX CULVERT  
84° SKEW

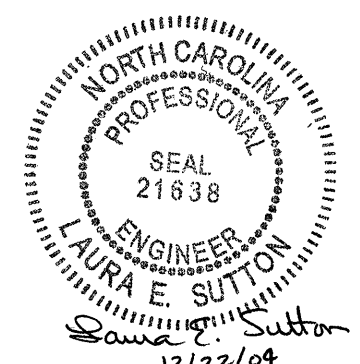

REVISIONS				SHEET NO.	
NO.	BY:	DATE:	NO.	BY:	DATE:
1			3		
2			4		

DRAWN BY : V.X. NGUYEN DATE : 9/17/97  
CHECKED BY : B.N. BARODAWALA DATE : 9/04